



***Annual Report for 2024
as presented at the
Annual Parochial Church Meeting
28th April 2025***



St Christopher's Parish Office
Springfield Road, Birmingham, B13 9NY
Tel: 0121 325 5342
Email: stchristopherschurch@hotmail.co.uk
www.stchristopherspringfield.org.uk

Welcome to the St Christopher's Annual Report for the year ending December 2024

The Reports

INTRODUCTION.....	3
Links with Other Organisation.....	4
FROM THE VICARAGE	5
WORSHIP.....	7
PASTORAL CARE	8
Anna Chaplaincy	9
CHILDREN & YOUTH.....	11
MISSION	13
Parish Missioner	14
Seedlings.....	16
The Environment	18
THE SPRINGFIELD PROJECT	21
CHURCH GOVERNMENT & ADMINISTRATION.....	22
Churchwardens	22
PCC Secretary	23
Safeguarding.....	24
Electoral Roll.....	25
Treasurer	26
FINANCIAL REPORT	27
Independent Examiner's Report	28
Statement of Financial Activities.....	30
Balance Sheet	31
Notes to the Accounts.....	32
Detailed Statement of Financial Activities	34
KEY INFORMATION ON THE ST CHRISTOPHER'S, SPRINGFIELD PCC CHARITY	40
Membership of the PCC	40
Governing Documents for the PCC	41

INTRODUCTION

St Christopher's Church, Springfield is located at the junction of Woodlands Road and Springfield Road in South-East Birmingham about 3 miles from the city centre. It is part of the Diocese of Birmingham within the Church of England.

Aim and Purposes

The PCC has the responsibility of co-operating with the vicar in promoting within the parish the whole mission of the church, pastoral, evangelistic, social and ecumenical. The PCC is a registered charity (Charity no. 1151491). Further information about the charity and its trustees can be found in the section of this report headed Key Information on the St Christopher's PCC Charity.

The PCC is also responsible for the maintenance of the church building and fabric. It also owns and uses the Springfield Centre which adjoins the church building; however the maintenance of this building is the responsibility of the Springfield Project.

Objectives and Activities

The PCC is committed to enabling as many people as possible to worship at our church and to become part of our community at St Christopher's. In order to do so it has developed the following vision statement for St Christopher's which it uses to guide its decisions.

Our Vision Statement – We want to be...

- A fellowship that worships God from the heart, displaying the power of the Holy Spirit amongst us to heal, enlighten and transform.
- A loving community where genuine acceptance and deep relationships enable everyone's well-being and continual growth.
- A people responding to Jesus' call to love our neighbours, seeking to understand, serve and partner with our local community.
- A place of caring for, equipping and discipling people in all that life brings.
- A church committed to sharing the good news of Jesus.
- A congregation of all ages that supports our children and young people as they grow and develop; and encourages them to live out their faith in church and the wider community.
- A fellowship that values our diversity, and where our rich variety is reflected in leadership roles.
- A fellowship that stands with Christian sisters and brothers throughout the world, praying for the nations, supporting our mission partners, and working for peace, justice and the protections of God's creation.

The PCC has adopted the strapline '***Growing together in Christ***' to summarise this vision in a more memorable form. At a recent away-day, the PCC decided to focus on the first three of these points over the coming year and have come up with an action plan to implement this.

When planning their activities, the PCC has considered the Charity Commission guidance on public benefit and, in particular, the specific guidance on charities for the advancement of religion. The PCC therefore seeks to enable ordinary people to live out their faith as part of the parish community through:

- Worship and prayer; learning about the Gospel and developing their knowledge and trust in Jesus;
- Provision of pastoral care for people living in the local area;
- Supporting missionary work in the local area;
- Supporting overseas missionaries involved in Christian mission;
- Providing services to the local community, particularly for local families and children in conjunction with the Springfield Project.

More information on all these activities can be found in the other sections of this report.

Links with other local churches:

St Christopher's has good relationships with several local churches, both Anglican and non-Anglican. However, we are now in a recognised 'Oversight Area' with St Edmund's Tyseley and therefore seek to work together with St Edmund's, sharing resources for mission and ministry as much as possible. St Christopher's is also a member of the Yardley and Solihull deanery within Birmingham Diocese, which represents around 30 churches in South East Birmingham and Solihull.

Links with Other Charities:

The Springfield Project (www.springfieldproject.org.uk) is a charity that is closely connected to St Christopher's. Although it is a separate charity (Charity no. 1134977) with its own trustees, it was founded by St Christopher's, is located in the church buildings, and its activities are closely co-ordinated with those of the Church. Therefore, a short report on its activities is included in this report, although a Trustees Report for the Springfield Project is also available by contacting info@springfieldproject.org.uk

St Christopher's also has close links with the Feast (www.thefeast.org.uk), a charity that brings together teenagers from different faiths and cultures to build friendships, explore faith and change lives.

St Christopher's is delighted to host an 'Anna Chaplain' and to support this ministry as part of the wider network of Anna Chaplaincy facilitated by the Bible Reading Fellowship (www.annachaplaincy.org.uk). A report outlining the work of our Anna Chaplain, Debbie Gurling, is included in this report.

St Christopher's is a supporter of Open Doors an organisation which helps persecuted Christians across the world (www.opendoorsuk.org). We do this through prayer, giving and keeping informed about the situation of Christians in areas of the world where their faith makes them vulnerable to attack and persecution.

FROM THE VICARAGE...

Clearly every year is important, but 2024 has certainly been a significant year for St Christopher's. We began the year in the midst of our reordering project with Ernst and the team working faithfully to complete on time in March. As I said last year, I am so grateful to



Jericho Construction and to BHB Architects for their work in overseeing and delivering the project with such sensitivity, professionalism and dedication. As I think everyone knows Ernst went above and beyond what could ever have been reasonably expected of him and he was (and is!) an absolute star. Can I also say a huge thank you to everyone who helped in

any way with putting church back together again after the work. There were so many small but crucial jobs which needed doing – cleaning, sorting, finding new homes for the things we needed, getting rid of things we didn't and generally setting our space up again to use week by week. THANK YOU to everyone who rolled up their sleeves and took part in all this. It was a joy to celebrate at the end of this process in March and then to have our formal opening in June when we welcomed Bishop David to St Christopher's for the first time to rededicate our space to the glory of God.



As well as this joy, it has continued to be a pleasure for me to work with such a wonderful staff team – Lucy our Parish Administrator, Kam our Parish Missioner, Debbie our Anna Chaplain and Rebecca our Under 18s Ministry Facilitator. We are blessed to have such a team! However, there have been changes, as at the end of 2024 Rebecca stood down from her post. Rebecca took this role on just before the Covid pandemic hit and has led our children's work through this and many other challenges over the last five years. She established good working practices and provided a strong foundation on which those who volunteer in our children and youth work can flourish. I am so grateful to her for her quiet professionalism, determination and good humour – we miss her a lot!



Other highlights of 2024 included our PCC away day in January when Sarah Smith led us in thinking how best to implement our vision statement. This has enabled our PCC to focus its efforts on key priorities. Through the year, it has been so encouraging to see people developing their faith and skills for ministry, especially Janet who completed the diocesan Way of Discipleship course and Gaby and Meike who completed the Children's Pathway

Training. David Hartley has also continued his reader training and begun to exercise his ministry alongside Philippa and Fiona. We were also able to collect for our local foodbank and for the Christmas toy distribution across the city. In November we were able to rejoice with Kevin Holland as he was confirmed at Knowle Parish Church and in December we had our breakfast and Christingle and the joyful countdown to Christmas began. At our carol service this year I think we had our best ever choir under the masterful leadership of our patient and ever-encouraging Margaret Gordon.



There has of course also been sadness this year, as several individuals and families within our church have encountered illness, loss and grief. It has been my privilege to officiate at the funerals of Michael Roper-Hall, William Langston and Josie Bullard, and of course other funerals have taken place elsewhere. We send our love and prayers to everyone who has experienced the pain of bereavement over this last year.

In concluding may I take this opportunity to thank those with whom I've been privileged to work over the last year. As I've mentioned it is a joy to be part of our wonderful staff team with Lucy, Kam, Debbie and Rebecca. We are also extremely blessed to have Tim as our Springfield Project Chair overseeing this key part of our shared life, especially in the midst of the perpetual state of crisis which is our City Council. Thank you too to Curt as our tireless and ever-cheerful site manager. Thank you to our two wonderful churchwardens – Messrs Smith and Smith. They complement one another superbly and we are so blessed by their skills and commitment. Thanks too to our PCC who oversee our day-to-day life as well as working towards our strategic priorities. Thank you to Helen Cremins who stood down after many years as PCC Secretary but has kindly stayed on to be our 'inclusion champion.' Thank you to everyone who leads and helps at Seedlings, Super Stars, Jaffa, Frog, Hot Chocolate Café, Blast and Real. To everyone who makes and serves teas and coffees, reads and prays in our services, to our musicians, singers, preachers, prayer ministry members, PA & IT operators, service leaders, small group leaders, those who stack chairs and clear up toys, who bake cakes, bring food, clear up food, tidy up books, wash up, sweep, mop, wipe and clean...THANK YOU! The Lord sees everything we do in His name and every act offered up to Him becomes an offering in which He surely delights and an expression of what it means to be the body of Christ.



"Now to him who is able to do immeasurably more than all we ask or imagine, according to his power that is at work within us, to him be glory in the church and in Christ Jesus throughout all generations, for ever and ever! Amen." Ephesians 3:20-21

Tom Thomas
Vicar



WORSHIP REPORT



Shout to the Lord our God and King for he is Worthy to be Praised

I give thanks to the Lord our God for another year in which we have been able to worship him through song without fear or persecution.

My thanks go out to all those involved in making this happen. This includes all our worship leaders and groups, service leaders, PA and Zoom operators. None of this would be possible without the servant hearts of all those involved. Our vicar Tom with his organisational skills is instrumental in making this run smoothly.

We have continued to use ISing worship in aiding our worship which in a time with limited musicians has been a valuable resource.

My heartfelt thanks go out to all who volunteered to take part in our Christmas Carol service last year which once again was a great success!

As we continue to learn more about God's grace and compassion, I pray that as a congregation we continue to shine a light in the darkness.

Amen

Margaret Gordon, April 2025

PASTORAL CARE

Pastoral care continues to mean a mixture of things at St Christopher's. We have the fundamental ongoing concern of individual members of our church for one another, seeking to 'look out' for each other and support our ongoing wellbeing in faith and life. There are also moments when people may have been missing from church for a while and then Tom, Debbie or Kam might be asked or reminded to visit or contact them. Then there are our small groups which meet in different ways and at different times, with varying degrees of regularity:

- Women's breakfast and men's breakfast – meeting roughly once a month
- The Lent course – meeting for 5-6 weeks during Lent
- 2 Homegroups which met weekly during term-time in 2024, but may now take a break while new patterns emerge
- The prayer and study group which meets on a Tuesday morning after our prayer meeting during term-time
- Asian Fellowship which meets on a Monday morning during term-time
- The Place of Welcome on a Thursday lunchtime during term-time (a shared activity with the Springfield Project)
- WhatsApp groups which help people stay in touch
- Prayer ministry offered each week in church
- Shared meals and other open celebrations at church.

Clearly there are ways we can improve and there will always be moments when we do not get this right and people feel unnoticed or even forgotten. I hope these are the exceptions, but we must be aware of this danger in our church life. However, I hope that on the whole every person can find some way (or ways) of being connected and feeling valued at St Christopher's. As Alex Nance put it last year:

"One of the wonderful things about St Christopher's is that we thrive on the informal pastoral care we provide for each other - choosing to meet up in the week, or chatting after the service with a hot drink. You don't need to join something organised to be an important part of the way we look after each other here! Our Vision Statement says that we want St Christopher's to be "a loving community where genuine acceptance and deep relationships enable everyone's well-being and continual growth", and we all have a part in building this together."

May God grant that we all do this and do it better and better!

Tom Thomas, April 2025



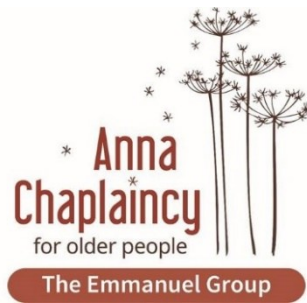

“They will still bear fruit in old age; they will stay fresh and green” Psalm 92:14.

This ministry has certainly continued to see older people, as being the ones who encourage and minister, as well as being the ones to be encouraged and ministered to!

Last year, I continued to visit seniors in the parishes of St Christophers, St Johns and St Edmunds on Sundays, and was faithfully assisted during the weekdays, by Jean Gethen and Dot Pooler. Between the 3 of us, as well as visiting people in their own homes, we were also able to visit seniors with connections to our churches, in Edgbaston (Edgbaston Care Home), Acock’s Green (Arden Lodge), and Moseley (Barkat House), as well as at least 2 others. Unfortunately, Debbie Ducille was no longer able to supervise me in this, due to her increasing commitments as Ministry Lead for Anna Chaplaincy nationally. Alison Roper-Hall however, kindly agreed to step in as practice supervisor, whilst Tom as the one who manages the finances, kindly agreed to also manage my reporting of absences. David Harrison as Warden of Commissioned Pastoral Care Teams, has remained as my chaplaincy mentor.

The number of people aged over 70 with whom we have connection, remains at an intermittent 50.

In April, I was joined by David Hartley, and Sue Green to do an accessibility audit of St Christophers. I felt that if church was a place that was accessible and welcoming to older people, then it would become the start of making it more welcoming to other groups, who were also differently abled. Findings were taken to the P.C.C, from which a steering group was formed, to address issues, such as lighting, signage, sound, and others.

In the summer, I went to the Botanical Gardens with St Johns, which was included a small group of over 70’s, and gave me an opportunity to get to know some people that are not normally visited. Seniors have told me the summer period, can be a difficult time of the year, so I decided to address this by having a couple of summer groups at Springfield Centre in August. Whilst the groups were creative in nature (painted rocks, and cards etc), the main aim was to have fellowship at a time when most people were away, and groups closed for the summer. This also gave people an opportunity to have conversations, especially whilst having a packed lunch together, which became as important as the activities. During this summer period, we also were visited by representatives from the Henry Smith Charity, who have been funding this ministry for the past 5 years. They were able to conduct interviews with various people who have been involved in the ministry, including recipients of visits, and they were able to see a part of Sparkhill, to put the ministry into context.

At the beginning of September, Joy Holt a long-standing member and leader at St Johns church died. I had the privilege of spending time with her and her husband Geoff, the day her diagnosis was confirmed, and on one other occasion afterwards, as a joint visit with Debbie Ducille. Because of the enormous impact of Joy’s death, on everyone at St John’s,

but particularly the seniors, who had known her for the longest time, I focussed my Sundays there for 2 months, until after her funeral, when the vicar of St John's Toby, had returned from Sabbatical. The funeral was well attended from all over the country and was joined online from people all over the world. The Sunday after Joy's funeral, I spoke at an intergenerational service at St John's, which was also celebrating Black History Month. This saw the young people of the church, interviewing seniors about how their lives and challenges experienced.

In October I was given permission by the Area Dean Tony Rindl, to give communion by extension. This enabled me to give communion to someone who was end of life at home, and to someone else in a care home.

Towards the end of the year, a steering group made of the vicars of St Christopher's, St Edmunds, and St John's, met together to review the past 5 years of Anna Chaplaincy ministry in their parishes.

In December 2024 – Dick Graham a previous member of Warwick Road Methodist church, but who then settled with St Johns, died, after a being terminally ill with cancer for 2 years. I had the privilege of being able to minister to him nearly every week during this time, and was soon joined by others including Toby, to make it a weekly service.

At the end of January 2025, the last person to be commissioned as an Anna Chaplain in Birmingham – Christine Miles, died of cancer. Debbie Ducille and I were able to visit Christine for the last time, just before Christmas, and jointly attended her funeral in February.

In March 2025, Jean West, sister of one of my Anna Friends Dot Pooler died, so Dot stepped back as a volunteer.

Whilst there have been many sombre times, as we have 'mourned with those who mourned', and as we have walked through valleys with people. However, those times during the past year have paled into insignificance when compared to the joy and blessing that our times with people has brought.



Debbie Gurling, , April 2025

Anna Chaplain

CHILDREN & YOUTH

This year we helped over 50 children under 18 to meet and follow Jesus and have fun together. More than 28 supported and trained volunteers carried this out, and in the process learned more about following Jesus and having fun themselves. There were 198 sessions on Sundays and Wednesdays this year!

Super Stars



(under-5s) 9 children are registered: 2- 6 attend the group without parents. A WhatsApp group helps us to share news and blessings. We tell a short Bible story, with a linked craft and prayer and lots of play. 8 volunteers deliver this group.

Highlight: Meike and Gabby studying hard to become Commissioned Children's Leaders: they really enjoyed their project 'God created me wonderful' - well done you two!



JAFFA



Jesus a Friend for All

(5-9s) 6 children registered: attendance varies from 2-8! We



sing, play a game, learn from the Bible and have good discussion, while making something together and pray. 4 volunteers run this group.

Highlight: Learning new songs, the kindness they show to each other

FROG



Forever Reliant on God

(9-14s) 12 registered in this age group: 2-10 attending. Leaders use

Energize materials for fun games, Bible study and prayerful response activities to help everyone explore God's love for us. 8 volunteers lead and support FROG.

Highlight: seeing the group grow in prayer and care for each other, their spiritual insight and enjoying donuts!

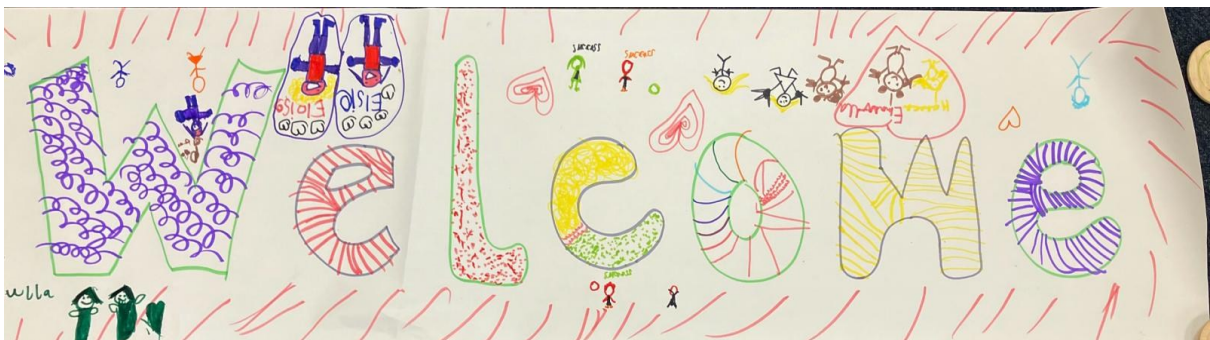

Hot Choc Café

(15+) 6 registered: up to 8 attend. We leave the main Sunday Service early once a month to enjoy sweet treats, discuss the sermon and pray together, with Sam Quarton and Fiona Cross-Sudworth leading most of the time. During other Sundays they are encouraged to get involved in services by volunteering in to build relationships with the wider church family and grow skills. 3 volunteers regularly facilitate.

Highlight: chocolate fingers, of course!



(mid-week, school years 6-9) 12 registered: 11 regulars



Building Lives Around Solid Truth

come to have a BLAST. We offer big and small games, craft, free snacks, and have Focus Time to allow Jesus to challenge us about the choices we make at school and home. 2 volunteers have helped Tom and Rebecca run this group.

Highlight: Our Fireworks Party - 82 people having fun!



(mid-week, school years 10-13) Up to 6 young people join BLAST's snack and games time, followed by in-depth Bible study and discussion. Tom and I have led , with guests visiting from The Feast every term. 3 volunteers support this currently all-female group.



Highlight: Seeing 5 friends 'graduate' into adult life this year

Lots happened in 2024! As well as these groups meeting weekly and monthly, We had a New Year roller-skating trip with no broken bones, a summer barbecue in the sunshine, Fireworks Party with hot dogs and Christmas Parties. Thank you so much to the dedicated, enthusiastic, energetic and creative volunteers who made all this happen, especially for their hard work when I was on sick leave for 3 months during the summer term.

Thank you especially to my Advisory Group, summoned willingly whenever I needed to talk out ideas or issues, for guiding and supporting me and bringing objective wisdom when necessary. Thanks also to my diocesan-provided mentor, Kate Day, who has laughed and cried with me all the way through. And to Parish Mission Support, especially Emma Sargeant, for your wonderful ideas, training opportunities (see my Commissioning Service photo), refreshing retreats and invaluable networking contacts: you're brilliant!

As I step down at the end of 2024, I think back over the last 5+ years and marvel at God's great faithfulness to me, the children we have the privilege of welcoming into church, and the adults supporting this work with their time, interest, kindness and prayer and finances. I look forward to seeing what adventures come with the next step in St Christopher's Children's and Youth Work...



Rebecca Slater, Under-18s Ministry Facilitator

MISSION

As a church we are honoured to support mission both at home and overseas. At home we continue to rejoice in the weekly witness of Seedlings, with its shared identity within St Christopher's and our Springfield Project. These sessions during term-time continue to offer friendship, support and love to local families as well as people who come from further afield who appreciate our open-access approach. Our home mission over recent years has also been augmented by our Place of Welcome running on Thursdays in term-time, begun first by Tina Brogan, then led by Seema Boyes and now by Fiona Hinds and her wonderful team. It again has proved a simple but high-quality way for local people to come into the building, receive the gift of a hot meal and share in friendship, conversation and advice on a range of different issues. Both these activities show that our doors are open, and we remain committed to offering love in tangible and helpful ways to our community.

Our overseas mission is focused on supporting our mission partners and praying for the church through Open Doors. We are honoured to continue to support Liz and Sameh Khalil, the Watson family and Rachel Smith in their different contexts, which is done through prayer and information, and financial support for Liz and Sameh and for Luke and Margaret. It is so good to be reminded how God is at work in other people and other places. I am also grateful to Lawrence Beyer who keeps us up to date with the issues Open Doors asks us to pray for. Although this is often difficult to hear, it reminds us that however difficult it may be at times to be a Christian in Sparkhill, so many of our brothers and sisters around the world experience risk and danger for their faith which are at an entirely different level. Praise God for their resilience and strength of faith!

Financially, we try to match our desire to support mission through our giving. Our aim each year is to give roughly 10% of our planned giving away to this part of church life. We do this through a gift of £3000 to Seedlings, paying the utility and room costs for Seedlings and Place of Welcome, monthly support for Liz and Sameh and Luke and Margaret and occasional one-off collections for societies such as Tear Fund or the Children's Society.

I am very grateful to Mike Smith who, as well as his churchwarden responsibilities, heads-up our Mission Committee and is brilliant and asking what we are doing for outreach and witness (actually doing and not just talking about doing!) Finally, it almost goes without saying that the key expression of our mission as a church fellowship is the witness of each of us in our daily lives. The way believers speak, act and interact with others and the world around us is fundamental to what it means to proclaim Christ. Due to this, there is a wonderful sense in which we are all experts at mission and can point people to Jesus every day (and often without saying a word).

Tom Thomas

Parish Missioner

Overview of My Work – an example of the challenges, opportunities and joys

During my mission work, I had the privilege of supporting a Muslim woman who struggled with deep-seated trust issues. She found it difficult to rely even on her own children, which made it challenging for her to accept help or guidance from others. Through patience, understanding, and faith, I was able to build a strong and trusting relationship with her, allowing her to open and share her struggles.

Not long after establishing this trust, she was diagnosed with cancer. However, she was in complete denial about her condition and refused to believe the diagnosis. This led her to reject any form of medical intervention, putting her life at great risk. The situation was heartbreaking, as she needed urgent care but was unwilling to accept it.

Recognizing the depth of the situation, I, along with her family, turned to prayer to Jesus, seeking divine intervention. Through continued support, reassurance, and the grace of God, her heart softened. She finally accepted that she needed medical treatment to survive. Encouraged by the prayers and love surrounding her, she agreed to undergo the necessary operation.

The surgery was successful, and today, she is a cancer survivor. This journey has been a testament to the power of faith, persistence, and the impact of compassionate outreach. It has reinforced my belief that trust, prayer, and genuine care can break through even the most difficult barriers.

This experience has strengthened my mission work, teaching me the importance of patience and unwavering faith. It has also highlighted the role of interfaith understanding and the power of love and support from Jesus I am grateful to have been part of this journey and will continue to serve with dedication, knowing that God's grace is always at work.

Asian fellowship

Since the start of this year, we have been meeting again on a Monday morning to dig deep into the Bible and to understand the Gods word better.

During our recent meetings I had the privilege of sharing the passage from Mark 1, focusing on the beginning of Jesus' ministry, His baptism, and His calling of the first disciples. We reflected on how Jesus' call to "Follow me" is an invitation to transformation and purpose.

The group found the passage both encouraging and inspiring, especially in seeing how ordinary people—like fishermen—were called to follow Jesus and become part of His mission. This led to a meaningful discussion on how God calls each of us, no matter our background, and how we can respond in faith.

As a result of this session, many expressed a newfound eagerness to read the Gospel more deeply and understand Jesus' teachings for themselves. Each one has even shared their own



thoughts on the gospel and have led the meetings. My passion is to see each one grow in confidence and some are now able to encourage others in studying the Word - praise God.

It has been a powerful moment of spiritual growth, and we look forward to continuing this journey together, equipping one another to share the Gospel with confidence and joy.

A Story of Strength and Freedom when praying and trusting in Jesus

In 2015, I met a woman during a Seedlings session when she came with her young daughter. As we got to know each other, she confided in me about her controlled and fearful home life, expressing that she felt trapped and unsure of what to do. I could deeply relate, as I was in a similar situation at the time. I shared my understanding with her, but unlike me, she wasn't ready to leave.

As the years went on, she continued attending with her daughter, but when her child turned four, she stopped coming to the group. I began praying for her, trusting that in time she would find the strength to make a change. Every so often, she would message me, saying she had "had enough," but fear kept holding her back.

Then, after ten years, she finally reached out and said, "I need help. Help me get out." I supported her, guided her to the right resources, and even went with her to the council. She was placed in emergency refuge, and now, seven months later, she is still there safe, rebuilding her life, and incredibly grateful that she finally took that step. Her story is a powerful reminder that freedom sometimes takes time, but when the moment comes, having the right support makes all the difference. I learnt that prayer perseverance is so important when in ministry.

1 to 1 ministry

Every day, I meet people facing uncertainty, fear, and struggle—the vulnerable, the overlooked, the ones searching for hope. Some come with heavy burdens: a mother escaping abuse, a young person lost in addiction, an elderly woman with no one to turn to. Others are caught in systems they don't understand—hospitals, job centres, legal battles—feeling powerless and unheard.

I listen. I pray. I stand with them in their hardest moments, offering guidance, encouragement, and the hope of Jesus. Sometimes, that means finding the right support—a solicitor, a doctor, a counsellor. Other times, it's simply being present, reminding them they are not alone. Through relationship, prayer, and faith, I walk alongside them, watching as light begins to break through their darkness. Some take small steps toward healing; others find the courage to rebuild their lives. No matter their journey, I am there—to listen, to guide, to believe with them for a better future.

Seedlings

During a Seedlings session, if I feel led to minister and pray for a family then I offer them a 1to1 session and support them and I always offer prayer, and most of the times I introduce them to our vicar and that strengthens the trust of the women as they are always grateful of prayer. Recently we have had a rise in children with additional needs and are trying to offer them the extra days to attend Seedlings, so that both parent and child can be supported by us.



Kam Kaur – April 2025



Return to church

We returned to the church in April 2024. The seedlings team worked hard to sort our equipment and set up a new setup in our newly organised church.

Seedlings continue to hold three weekly sessions during term time on Tuesday, Wednesday, and Thursday. The children and families enjoy activities inside and outside and the shared singing session is always popular. Our aim is to ensure everyone that comes to seedlings feel welcomed and loved.

Most of our families are from the local area however we have had families come from Solihull and king standing it's a very popular service that we provide. We also serve families that have been referred to us by Family support Springfield.

We then have the privilege to serve those families in more depth by trying to understand what further support the child may need and how can we help make a difference in that child's life while they are attending seedlings. One of the ways in which we can support the child is by offering more than one session.

We not only want to see the child that comes to Seedlings flourish but also support the parents by giving information to them if they have any concerns regards to their child or themselves. What we also do is that we refer families to family support Springfield Project, if we feel that this parent needs further support for their well-being, we then encourage parents to speak to someone if they are worried and signpost them to the right service.

During the year we celebrate Mother's Day Father's Day, and many more celebrations like Easter and Christmas. During these events we have party food and make special cards for our families. We also share the story of Easter and have a nativity at Christmas, where our little children dress up and have fun, and share the love of Jesus.



Leaders

Since September, I have taken on the role of Seedlings Coordinator and am enjoying the position and learning a great deal. While it has been challenging, it has also been a joy. Caroline Minchin leads the sessions on Tuesday and supports me a lot. I lead on Wednesday, and Lucy Emo and Rachel Alcock on Thursday. We are a fantastic team, further supported by Claire Freeman, the Mini Springers Nursery Manager. We all are passionate to serve and make a difference the the lives of these children and families.

Volunteers

Each team has a minimum of 3 volunteers. Most community volunteers are gaining experience and confidence to support them in the future. We also have a couple of retired church volunteers, but we would love to have more members of our church get involved. Everyone has a shared passion for our work and a commitment to all the children and their families.

Numbers of families

We have welcomed 370 families since September and regularly have approximately 75 families over the week. More new families arrive each week, and we are returning to pre-COVID numbers.

We at Seedlings try our best to support every family. Most of our families are from a multi faith community and English is not their first language, its beneficial to be able to speak different languages.

Not long ago we had a health promotion person come in and spoke with parents individually and explained how they can access their GP and dentist. That was helpful as many parents said she explained well to them and showed them how to go online and access appointments.

Feedback

Our families really value the seedling sessions, and this is reflected in our conversations and the more official feedback they give us.

What does Seedlings do well?	They orgnised the play areas really well and clean. All the staff is really helpful. They try to interact with kids so nicley it's really good.
------------------------------	---

Kam Kaur – April 2025
Seedlings Co-ordinator

The Environment – Caring for God’s creation

Contribution to PCC AGM report covering Jan-Dec 2024

The environment – Caring for God’s creation

Caring for Gods creation is one of the five marks of mission set out by the Anglian Church and recognised by many other denominations.

We continue to work on the actions for improvement identified in our eco-church action plan as we move from ‘Silver’ to ‘Gold’ status. Simon Slater the designated Eco Church coordinator by the PCC, has continued to provide updates to the church council and worked with other members of the congregation.

Eco church Working Group

This is the second year of the group Simon has set up to help support his role in progressing the Eco church action plan. The group consists of Tom as vicar to help with the church building actions, and Hannah Greenwood, using her environmental expertise and her role on the Springfield Project Board as the environmental champion.

The group has met three times in the year, but progress has been slow due to waiting for the building work at the church to finish and Simon starting a new job away from Birmingham. The focus has been to update the church website with our Eco church journey and to reapply to Eco church to hopefully gain ‘Gold’ status. Simon has agreed to continue to be the Eco Church coordinator until the latest award application is assessed.

Land Management Plan

As part of the application for ‘Gold’ we were required to pull together our existing wildlife survey and practice into one document called a ‘land management plan’. This reflects the current management of the different parts of our site by our site manager (Curt), the nursery staff for the nursery area, Tom and church working parties. After the application process, we may may want to revisit this plan to check if any further updates are needed.

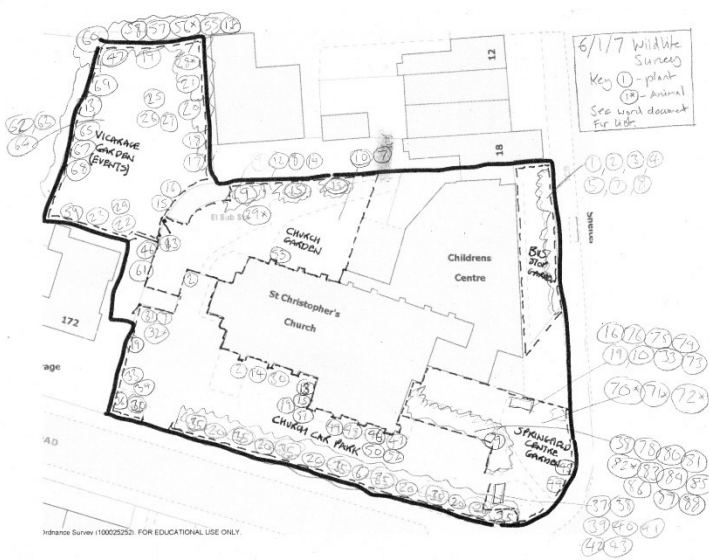

Website update

A summary of our Eco Church journey is now on the church website. Now the building work is complete a further posterior communication within the church building is required to remind the congregation of the action we are taking across our teaching, worship, buildings, discipleship, and community.

<https://www.stchristophersspringfield.org.uk/about-us/ecochurch/>

Deanery Group

Simon has continued to act as the parish environment representative and has attended several in person or online meetings hosted by the Deanery to share good practice or to provide updates on the 2030 net zero roadmap. Tom has also had a visit from Diocesan Low Carbon Officer.

Application for Gold Eco Church Status

The criteria have been updated since we applied 4 years ago and were awarded 'Silver'. Since then, we have worked on areas identified as requiring further improvement.

- We have conducted a Wildlife Survey of our site and produced a Land Management Plan
- We have conducted energy audits for the church building, begun switching to more electric heaters, and completing the switch to LED lighting. We have also moved to Church of England approved 'green tariffs' for our electricity and gas. This has made the building 'net zero' in terms of harmful greenhouse gases.
- We have also conducted energy audits for the Vicarage and Springfield Centre (which as they are not under the ownership or operation of the PCC are outside the scope of Eco Church).
- We have provided more opportunities for the congregation to engage with discipleship issues around caring for creation through a lent group, resources, and themed church services.

Our application on the updated criteria scored 'Gold' in December 2024, but it now needs to be externally assessed, and an in person or online meeting to be held in the Spring.

Plans for 2024

After application process for Gold Award has been completed:

Finalise new Eco Church Working Group action plan to include:

- Revisit Land Management Plan to check if any updates are needed and agree overall responsibility for the coordination and communication of the plan
- Revisit priority energy audit actions for the vicarage, church and Springfield Centre and agree who is responsible for progressing
- Revisit shared service agreement between Church and Springfield Project on use of church and centre to ensure consistency around environment in areas such as procurement and waste
- Repeat delivery of lent environmental discipleship course carried out 3 years ago

- Agree how to support Springfield and ecobirmingham sustainability support for local community activities in the year.

After explaining workplan and role for 2025, seek to recruit a new Eco Church coordinator to lead the working group.

Simon Slater, Eco Church coordinator

On behalf of the Eco Church Working Group

December 2024



THE SPRINGFIELD PROJECT

As the Chair of the Project, I am learning a particular lesson of faith. It seems like every year things appear really tough, and then somehow, a bit like disciples picking up the left-overs after the feeding of 5000, there is evidence of abundance!!

- 1 Costs go up
- 2 Our main contract with Birmingham City Council always seems insecure

Last year I wrote:

“Amazingly, or not so amazingly if you factor in a loving provider God, the past year has been a good one financially.”

Despite the fact that we have had to cut some of the things we used to do, like the Food Pantry that we handed over to Narthex, our core work continues effectively and there has been lots of encouraging new activity.

This year we said a sad goodbye to Rachel, our Children’s worker who returned to the U.S., but it is our children’s work that has been really encouraging. The project’s work with making our area a Child Friendly Neighbourhood has developed well, helping to grow our partnerships, helping us to listen to young people and extending what we do for the local environment.

So, again, please join us in thanking God for His provision and faithfulness...and pray that we might make the most of the opportunities the project gives us to appropriately tell our story of knowing the source of hope and love in a hurting world. The Board has developed with four new members, three of whom have significantly lowered the average age of the Board and all of whom strengthen our connections with the communities we serve.

I am hugely grateful for the work of the Board and hope you will take this opportunity to thank God for them.

Tim Boyes – April 2025
Chair

CHURCH GOVERNMENT & ADMINISTRATION

Churchwardens Report

After all the activity with the building project last year, this year has been a time for us to adapt to our new facilities and to continue our life of worship and service together. It has been great to see how the building work has started to shape our times together, with the main table being used for communion now that we have access for all to it, space for people to sit and chat at the end of the service and good kitchen facilities and storage that make the space honouring to God and welcoming for all who come in.

As church wardens we have been encouraged by seeing the increased numbers of people helping in different ways on a Sunday whether that's serving refreshments, doing the IT, leading children's groups, improving displays and helping clear away the chairs. All these are important parts of our worship and we want to say a big thank you to everyone who helps. There is always more to do so if you would like to join in with any of these tasks just ask.

During the year numbers at the 9am service have continued to be between 6 and 10, whilst this is a small number it is a meaningful and important service and an integral part of the life of St Christophers. Numbers at the 10:45 average between 75-80 which includes children as well as adults and we continue to be blessed by having members from many different countries and backgrounds, a small picture of God's Kingdom.

We continue to look at whether the building is in good order and fit for purpose and, following an assessment by David Hartley and his team we are looking at improving the accessibility of the building with automatic doors and improved lighting. Hopefully, these will start to be done this year.

Andrew Smith and Mike Smith

April 2025



Church Council (PCC) Report

The Parochial Church Council (PCC) has an important role to play in the leadership of St Christopher's. It has the ultimate responsibility for managing the church finances and deciding the strategic direction of the church. It also supports and oversees the activities of the church and encourages those leading the activities. PCC members are also the trustees of the charity that manages the church assets and income. Once PCC minutes have been agreed, church members can request a copy from Tom.

Since the last AGM on 29th April 2024, the PCC has met 6 times, usually in the Prayer Room here at St Christopher's, and including a Saturday Away Day at St Catherine's Blackwell. All meetings have been well attended, not just quorate. Helen Cremins is still on PCC, but has relinquished her role as secretary after many years of faithful and highly efficient service. We are grateful to Lucy Emo for ably taking on this task.

Our Agenda follows consideration of our church life and how we position ourselves looking 'In', 'Out' and 'Up'. We also attend to matters of Governance, including safeguarding, finance and the Diocese.

'In' considers items related to us as a church community, in ministry and fellowship.

'Out' considers aspects of our mission, including our relationship with mission partners, the Springfield Project, Seedlings, our community and neighbours.

'Up' considers our relationship directly with God in all aspects of Worship.

We adjust the sequence on the agenda to make sure all aspects are attended to fairly.

Each meeting had a particular focus amongst other agenda items discussed:

10th June 2024 we focused on Inclusion and Accessibility. Debbie Gurling gave a report and recommendations on aspects of Accessibility (hearing, lighting, entrance doors). Helen Cremins is our Inclusion Lead.

15th July 2024 we focused on Discipleship led by Guy Donnegan-Cross. Alex, Jen and Catriona agreed to collate a list for information of St Christopher's Small Groups and Networks currently running or planned.

16th September 2024 we decided our focus on Social Justice issues this year would be local and linked with the Springfield Project fostering a Child Friendly Neighbourhood.

4th November 2024 we discussed with Rebecca Slater's help how to proceed with our Children's Ministry after her departure from the role at the end of 2024.

1st February 2025 was our Away Day when with Sarah Smith facilitating, we revisited our Vision for 'Growing Together in Christ', considering priorities, and refocusing for the coming year.

10th March 2025 We reviewed our contributions to the Away Day, which had been drawn up as an Action Plan by Tom, Smeee and Sarah. We also reviewed our prospective status with a Gold Award as an Eco Church with a report from Simon Slater. (see <https://www.stchristophersspringfield.org.uk/about-us/ecochurch/>)

We enjoy lively discussions at these meetings and appreciate the contributions that all PCC members make towards our decisions. We thank everyone for giving up their time to attend the meetings and for the work they do between times.

Alison Roper-Hall, Lay Chair of the PCC, April 2025

Safeguarding

Over the last year we have all been reminded of the tragedy of failings in safeguarding across our denomination. When the Makin review was published in November 2024 it described not only the abuse suffered by many victims at the hands of John Smyth, but a culture of denial and cover-up in many parts of the church, particularly amongst senior and experienced clergy. It resulted in the resignation of the Archbishop of Canterbury and investigations into other senior figures. It is a timely reminder of where we have failed in the past and how important it is to do everything we can to keep people safe in the present.

Against this backdrop, it is encouraging that safeguarding has become much more centralised and rigorous across Church of England Birmingham, with a set of requirements for those holding most posts (paid and voluntary) in a parish church. We are delighted that the safeguarding team at diocesan level is strong and you can speak with them on the phone at most times: 0121 4260407 or 07342993844. Their rigorous guidelines help us with the process of “safer recruitment” and now mean that most people in a volunteer role at St Christopher’s will need to complete an application form, DBS application, and complete two online courses – Basic Safeguarding Awareness and Safeguarding Foundations. In addition, PCC members and Churchwardens are requested to complete a third unit called Raising Awareness Of Domestic Abuse. Once completed, these courses are renewable after three years. There is also an online diocesan ‘Safeguarding Dashboard’ which we are asked to keep up to date. Help with this would be much appreciated.

We are blessed that Rebecca Slater and Lucy Emo have overseen the process of DBS applications for our church over the last year. Lucy has very kindly stepped-up to do this role in the absence of an Under-18s Minister, but I know she is looking forward to sharing it out again! We can also draw on the expertise of Claudia Gordon, our Parish Safeguarding Coordinator as together we seek to keep children and vulnerable adults safe in our church. Further details of policies and procedures can be found on our website (stchristopherspringfield.org.uk) or on the CofE Birmingham’s website (cofebirmingham.com).

However, as I’m sure you are aware, safeguarding is everyone’s responsibility so if you ever see or hear anything that gives you cause for concern, please remember these simple steps:

1. Receive what the person is saying
2. Reassure the person that it’s good they are telling you
3. Record (write down) what you have seen or heard as soon as possible without adding or leaving anything out, sign and date it
4. Report it to either Claudia or Tom (and give them your record)
5. Breathe easy – your job is done!

Claudia’s experience is invaluable in discerning what should then be passed on to the diocese or the police and what is simply behaviour we should be aware of and monitor. We want to be calmly vigilant and tread a healthy line between naivety on one hand and paranoia on the other with the goal of keeping everyone safe.



**Safeguarding is
Everyone's
Responsibility**

Electoral Roll

Within the Church of England, the Electoral Roll is a list of all the lay members of the church. All baptised Christians over 16, who regularly worship at St Christopher’s, or who live in the parish are entitled to be on the Electoral Roll. These church members are then those entitled to attend and vote at the APCM (Annual Parochial Church Meeting) and stand for election to the Church Council (PCC).

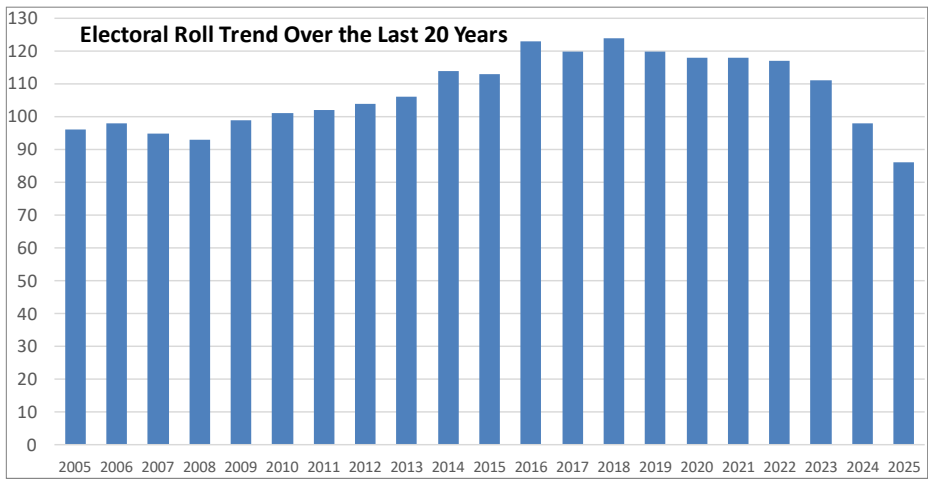

This year we have been asked according to the Church’s rules to produce a new roll. This means that all members are removed from the roll and asked to sign-up again. A new roll is produced every 5 years. On other

years we only add new members and remove old members who we know have left. The Church of England does this to ensure that the roll is as accurate as possible. It ensures that old members who are no longer attending or no longer want to be on the roll are removed.

The roll in 2024 had 100 members on it. The new roll has 86 members on it. The change in numbers reflects a change in attendance since 2020 when a new roll was last produced. A number of people who were on the roll from 2020 to 2024 are no longer regularly attending St Christopher’s and have not asked to be put on the new roll. However, although the overall total on the roll has reduced, 10 new members were added to the roll this year.

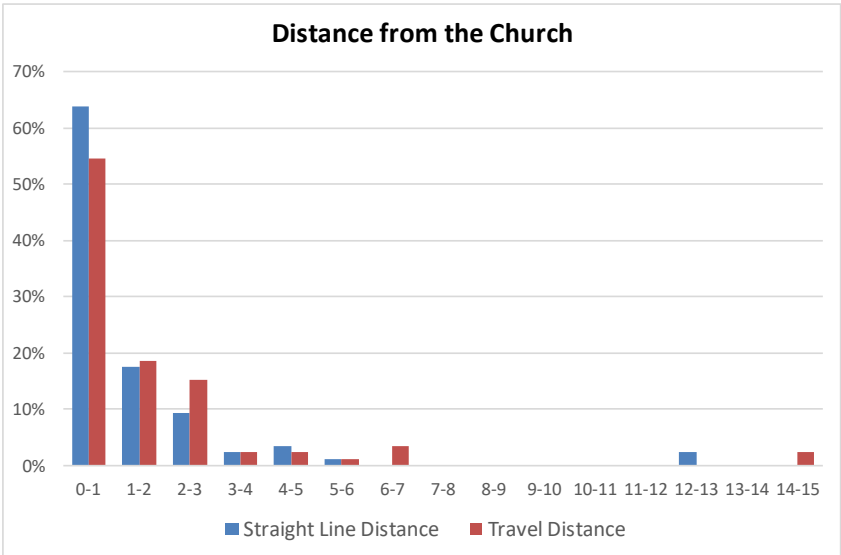

The change in membership has reduced slightly the proportion of members who live in the parish from 44% to 40%. However, the parish covers a relatively small area of just 24 streets, with a population of only 8,000, so it is possible to live 500 metres from the Church, but not live in the parish. Church members generally live close to the church with over 55% living within 1 mile and 73% living within 2 miles travel distance of the church building.

Mike Lenton – April 2025, Church Electoral Roll Officer

Treasurer's Report

The financial statements as presented here for the Year Ending 2024 (1st Jan to 31st Dec 2024) shows a cash balance (equity) calculated at £49,037.26. When compared to the previous financial year figure of (£81,407.59), this gives a reduction of £32,370.33 (40%). This reduction can be understood and seen as a reflection from the 2024 annual profit and loss statement. The total income (receipts) for 2024 was calculated at £271,931.89 with the total expense (payments) at £304,302.22, equating to a recorded loss of £32,370.33 for the year.

The above was mainly attributed by the cost of the Church Re-ordering work that commenced in September 2023, which was completed during March 2024 by the assigned contractor firm. In the year 2023 in order to keep and maintain the cash flow afloat, kind generous donations were received from the congregation as well as grants from various trusts towards the build-up and pre-planning phases/work for the re-ordering work. And during the start of 2024, to further help and facilitate this building work a loan from the Birmingham Diocese was received, along with further grants and fund from a kind legacy donation of an estate. This fund was the first instalment, with the second and final instalment yet to be received by the Church shortly in due course subject to the finalisation of the sale of the estate. This along with other grants that also were received in 2024 helped with the Church's financial cash flow in order to meet the relatively high building costs along with meeting the normal and general costs that were involved in the running of the Church. As a brief overview, some of the financial gains and losses that were noted are briefly indicated below:

Receipts

Areas that saw a decrease are:

- Total Other Church Grants (not for building re-ordering) £5,710 (19%)
- Youth Worker Fund £2,161 (28%)
- Income from Use of Church £3,564 (44%)
- Bank Interest £1417 (49%)

Areas that saw an increase are:

- Total Planned Giving £15,546 (23%)
- Total One-off Donations/Re-ordering Grants £24,132 (19%)

Payments

Areas that saw a decrease are:

- Common Fund £13,092 (25%)
- Total Charitable Giving £2,744 (22%)

Areas that saw an increase are:

- Total Outreach Activity £2,555 (8%)
- Repairs and New Building Work £5,918 (3.5%)
- Weddings and Funerals £1,386 (100%)

I take this opportunity to thank Lucy Emo the Church Financial Administrator for her administrative and record keeping duties and Tom Thomas for his support and help.

Steven Taggar – PCC Treasurer

THE PAROCHIAL CHURCH COUNCIL OF THE ECCLESIASTICAL PARISH OF ST
CHRISTOPHER'S SPRINGFIELD

Charity No. 1151491

Financial Accounts

31 December 2024

Independent Examiners Report
Independent Examiner's Report to the trustees of THE PAROCHIAL CHURCH COUNCIL OF THE
ECCLESIASTICAL PARISH OF ST CHRISTOPHER'S SPRINGFIELD

I report to the trustees on my examination of the financial statements of THE PAROCHIAL CHURCH COUNCIL OF THE ECCLESIASTICAL PARISH OF ST CHRISTOPHER'S SPRINGFIELD for the year ended 31 December 2024.

Responsibilities and basis of report

As the charity's trustees you are responsible for the preparation of the financial statements in accordance with the requirements of the Charities Act 2011 ('the Act').

I report in respect of my examination of the charity's financial statements carried out under section 145 of the 2011 Act and in carrying out my examination I have followed all the applicable Directions given by the Charity Commission under section 145(5)(b) of the Act.

Independent examiner's statement

I have completed my examination. I can confirm that no material matters have come to my attention in connection with the examination giving me cause to believe that in any material respect:

- the accounting records were not kept in respect of the charity as required by section 130 of the Act; or
- the financial statements do not accord with those records; or
- the financial statements do not comply with the applicable requirements concerning the form and content of financial statements set out in the Charities (Accounts and Reports) Regulations 2008 other than any requirement that the financial statements give a 'true and fair' view which is not a matter considered as part of an independent examination.

I have no concerns and have come across no other matters in connection with the examination to which attention should be drawn in this report in order to enable a proper understanding of the financial statements to be reached.



Andy Hopkins
BVSC
Latham House
33-34 Paradise Street
Birmingham

B1 2AJ
28 April 2025

Statement of Financial Activities
for the year ended 31 December 2024

		Unrestricted funds 2024 £	Restricted funds 2024 £	Total funds 2024 £	Total funds 2023 £
	Notes				
Income and endowments from:					
Donations and legacies	3	129,080	91,696	220,776	271,252
Charitable activities	4	5,664	-	5,664	8,765
Investments	5	1,492	-	1,492	2,909
Total		136,236	91,696	227,932	282,926
Expenditure on:					
Charitable activities	6	149,554	32,047	181,601	183,350
Other	7	66,221	59,649	125,870	138,031
Total		215,775	91,696	307,471	321,381
Net gains on investments		-	-	-	-
Net expenditure	8	(79,539)	0	(79,539)	(38,455)
Transfers between funds		-	-	-	-
Net expenditure before other gains/(losses)		(79,539)	0	(79,539)	(38,455)
Other gains and losses					
Net movement in funds		(79,539)	0	(79,539)	(38,455)
Reconciliation of funds:					
Total funds brought forward		83,616	-	83,616	122,071
Total funds carried forward		4,077	0	4,077	83,616

THE PAROCHIAL CHURCH COUNCIL OF THE ECCLESIASTICAL PARISH OF ST CHRISTOPHER'S SPRINGFIELD

Balance Sheet
at 31 December 2024

Charity No. 1151491		2024 £	2023 £
Current assets			
Cash at bank and in hand		49,037	83,616
		<u>49,037</u>	<u>83,616</u>
Creditors: Amount falling due within one year	10	(44,960)	-
Net current assets		<u>4,077</u>	<u>83,616</u>
Total assets less current liabilities		<u>4,077</u>	<u>83,616</u>
Net assets excluding pension asset or liability		<u>4,077</u>	<u>83,616</u>
Total net assets		<u><u>4,077</u></u>	<u><u>83,616</u></u>
The funds of the charity			
Restricted funds	11		
Restricted income funds		0	-
		<u>0</u>	<u>-</u>
Unrestricted funds	11		
General funds		4,077	83,616
		<u>4,077</u>	<u>83,616</u>
Reserves	11		
Total funds		<u><u>4,077</u></u>	<u><u>83,616</u></u>

Approved by the trustees on 20 May 2025

And signed on their behalf by:



T. Thomas
Trustee
20 May 2025

Notes to the Accounts
for the year ended 31 December 2024

1 Accounting policies

Basis of preparation

The financial statements have been prepared in accordance with Statement of Recommended Practice: Accounting and Reporting by Charities preparing their accounts in accordance with the Financial Reporting Standard applicable in the UK and Republic of Ireland (FRS 102) issued on 16 July 2014 and the Financial Reporting Standard applicable in the United Kingdom and Republic of Ireland (FRS 102) and the Charities Act 2011.

Change in basis of accounting or to previous accounts

The church ordinarily prepares accounts on a receipts and payments basis. Income in excess of £250,000 this year has required the production of accruals accounts. As this is not expected to be an ongoing situation, no item has been capitalised to the balance sheet.

Fund accounting

Unrestricted funds	These are available for use at the discretion of the trustees in furtherance of the general objects of the charity.
Designated funds	These are unrestricted funds earmarked by the trustees for particular purposes.
Restricted funds	These are available for use subject to restrictions imposed by the donor or through terms of an appeal.

Income

Recognition of income	Income is included in the Statement of Financial Activities (SoFA) when the charity becomes entitled to, and virtually certain to receive, the income and the amount of the income can be measured with sufficient reliability.
-----------------------	---

Income with related expenditure	Where income has related expenditure the income and related expenditure is reported gross in the SoFA.
---------------------------------	--

Donations and legacies	Voluntary income received by way of grants, donations and gifts is included in the the SoFA when receivable and only when the Charity has unconditional entitlement to the income.
------------------------	--

Volunteer help	The value of any volunteer help received is not included in the accounts.
----------------	---

Investment income	This is included in the accounts when receivable.
-------------------	---

Notes to the Accounts

Expenditure

Recognition of expenditure	Expenditure is recognised on an accruals basis. Expenditure includes any VAT which cannot be fully recovered, and is reported as part of the expenditure to which it relates.
Expenditure on raising funds	These comprise the costs associated with attracting voluntary income, fundraising trading costs and investment management costs.
Expenditure on charitable activities	These comprise the costs incurred by the Charity in the delivery of its activities and services in the furtherance of its objects, including the making of grants and governance costs.
Governance costs	These include those costs associated with meeting the constitutional and statutory requirements of the Charity, including any audit/independent examination fees, costs linked to the strategic management of the Charity, together with a share of other administration costs.
Other expenditure	These are support costs not allocated to a particular activity.

Taxation

The charity is exempt from tax on its charitable activities.

Tangible fixed assets and depreciation

Consecrated and benefice property is not included in the accounts in accordance with section 10 of the Charities Act.

Trade and other debtors

Trade and other debtors are recognised at the settlement amount due after any trade discount offered. Prepayments are valued at the amount prepaid net of any trade discounts due.

Cash and cash equivalents

Cash and cash equivalents comprise cash at bank and on hand, demand deposits with banks and other short-term highly liquid investments with original maturities of three months or less and bank overdrafts. In the statement of financial position, bank overdrafts are shown within borrowings or current liabilities. In the Statement of Cash Flows, cash and cash equivalents are shown net of bank overdrafts that are repayable on demand and form an integral part of the company's cash management.

Trade and other creditors

Short term creditors are measured at the transaction price. Other creditors and provisions are recognised where the charity has a present obligation resulting from a past event that will probably result in the transfer of funds to a third party and the amount due to settle the obligation can be measured or estimated reliably. Creditors and provisions are normally recognised at their settlement amount after allowing for any trade discounts due.

Pension costs

The charity operates a defined contribution plan for its employees. A defined contribution plan is a pension plan under which the charity pays fixed contributions into a separate entity. Once the contributions have been paid the charity has no further payments obligations. The contributions are recognised as expenses when they fall due. Amounts not paid are shown in accruals in the balance sheet. The assets of the plan are held separately from the charity in independently administered funds.

Notes to the Accounts

Receipt of donated goods, facilities and services

All donated goods, facilities and services received are recognised within incoming resources and expenditure at an estimate of the value to the charity.

2 Statement of Financial Activities - prior year

	Unrestricted funds 2023 £	Restricted funds 2023 £	Total funds 2023 £
Income and endowments from:			
Donations and legacies	107,085	164,167	271,252
Charitable activities	8,764	-	8,764
Investments	2,909	-	2,909
Total	118,759	164,167	282,925
Expenditure on:			
Charitable activities	180,640	2,810	183,450
Other	86,734	51,196	137,930
Total	267,374	54,006	321,380
Net income	(148,615)	110,161	(38,455)
Transfers between funds	110,160	(110,160)	-
Net income before other gains/(losses)	(38,455)	0	(38,455)
Other gains and losses:			
Net movement in funds	(38,455)	0	(38,455)
Reconciliation of funds:			
Total funds brought forward	122,071	-	122,071
Total funds carried forward	83,616	0	83,617

3 Income from donations and legacies

	Unrestricted £	Restricted £	Total 2024 £	Total 2023 £
Planned Giving	83,684	5,569	89,253	75,868
One-Off and Open Plate Donations	2,646	61,327	63,973	127,261
Gift Aid Recovered	-	-	-	37,613
Grants	42,750	24,800	67,550	30,510
	129,080	91,696	220,776	271,252

Notes to the Accounts

4 Income from charitable activities

	Unrestricted	Total 2024	Total 2023
	£	£	£
Fees for Weddings and Funerals	1,036	1,036	573
Income from Use of Church	4,628	4,628	8,192
	<u>5,664</u>	<u>5,664</u>	<u>8,765</u>

5 Income from investments

	Unrestricted	Total 2024	Total 2023
	£	£	£
Bank Interest	1,492	1,492	2,909
	<u>1,492</u>	<u>1,492</u>	<u>2,909</u>

6 Expenditure on charitable activities

	Unrestricted	Restricted	Total 2024	Total 2023
	£	£	£	£
<i>Expenditure on charitable activities</i>				
Church Running Costs	148,169	29,066	177,235	180,248
Costs of Weddings and Funerals	1,386	-	1,386	-
Outreach Activity	0	2,005	2,005	1,393
Youth Work Costs	0	975	975	1,809
<i>Governance costs</i>	-	-	-	(100)
	<u>149,554</u>	<u>32,047</u>	<u>181,601</u>	<u>183,350</u>

7 Other expenditure

	Unrestricted	Restricted	Total 2024	Total 2023
	£	£	£	£
Common Fund	39,276	-	39,276	52,368
Charitable Giving	9,513	-	9,513	12,257
Employee costs	-	59,649	59,649	56,396
Premises costs	11,411	-	11,411	12,483
General administrative costs	5,061	-	5,061	4,527
Legal and professional costs	960	-	960	-
	<u>66,221</u>	<u>59,649</u>	<u>125,870</u>	<u>138,031</u>

Notes to the Accounts

8 Net expenditure before transfers

	2024	2023
	£	£
This is stated after charging:		
Independent Examiner's fee	480	-
Other fees paid to the auditor or independent examiner	480	-

9 Staff costs

	2024	2023
Salaries and wages	56,949	54,878
Pension costs	2,700	1,518
	<u>59,649</u>	<u>56,396</u>

No employee received emoluments in excess of £60,000.

The average monthly number of full time equivalent employees during the year was as follows:

	2024 Number	2023 Number
Church running	1	1
Outreach Work	2	2
Youth work	1	1
	<u>4</u>	<u>4</u>

The charity runs a defined contributions pension scheme which is administered by a third party.

10 Creditors:

amounts falling due within one year

	2024	2023
	£	£
Other loans	44,000	-
Accruals	960	-
	<u>44,960</u>	<u>-</u>

Notes to the Accounts
11 Movement in funds

	At 1 January 2024	Incoming resources (including other gains/losses) £	Resources expended £	At 31 December 2024 £
Restricted funds:				
Restricted income funds:				
	-	91,696	(91,696)	0
<i>Total</i>	<u>-</u>	<u>91,696</u>	<u>(91,696)</u>	<u>0</u>
Unrestricted funds:				
General funds	83,616	136,236	(215,775)	4,077
Total funds	<u>83,616</u>	<u>227,932</u>	<u>(307,471)</u>	<u>4,077</u>

12 Analysis of net assets between funds

	Unrestricted funds £	Total £
Net current assets	4,077	4,077
	<u>4,077</u>	<u>4,077</u>

13 Reconciliation of net debt

	At 1 January 2024 £	Cash flows £	At 31 December 2024 £
Cash and cash equivalents	83,616	(34,579)	49,037
	<u>83,616</u>	<u>(34,579)</u>	<u>49,037</u>
Borrowings	-	(44,000)	(44,000)
	<u>-</u>	<u>(44,000)</u>	<u>(44,000)</u>
Net debt	<u>83,616</u>	<u>(78,579)</u>	<u>5,037</u>

Notes to the Accounts
14 Commitments

Operating lease commitments

Annual commitments under non-cancellable operating leases are as follows:

	2024	2024	2023	2023
	Land and	Other	Land and	Other
	buildings		buildings	
	£	£	£	£
Operating leases with expiry date:				

Pension commitments

	2024	2023
	£	£
The pension cost charge to the charity amounted to:	<u>2,700</u>	<u>1,518</u>

THE PAROCHIAL CHURCH COUNCIL OF THE ECCLESIASTICAL PARISH OF ST CHRISTOPHER'S SPRINGFIELD

Detailed Statement of Financial Activities
for the year ended 31 December 2024

	Unrestricted funds 2024 £	Restricted funds 2024 £	Total funds 2024 £	Total funds 2023 £
Income and endowments from:				
Donations and legacies				
Planned Giving	83,684	5,569	89,253	75,868
One-Off and Open Plate Donations	2,646	61,327	63,973	127,261
Gift Aid Recovered	-	-	-	37,613
Grants	42,750	24,800	67,550	30,510
	<u>129,080</u>	<u>91,696</u>	<u>220,776</u>	<u>271,252</u>
Charitable activities				
Fees for Weddings and Funerals	1,036	-	1,036	573
Income from Use of Church	4,628	-	4,628	8,192
	<u>5,664</u>	<u>-</u>	<u>5,664</u>	<u>8,765</u>
Investments				
Bank Interest	1,492	-	1,492	2,909
	<u>1,492</u>	<u>-</u>	<u>1,492</u>	<u>2,909</u>
Total income and endowments	136,236	91,696	227,932	282,926
Expenditure on:				
Charitable activities				
Church Running Costs	148,169	29,066	177,235	180,248
Costs of Weddings and Funerals	1,386	-	1,386	-
Outreach Activity	0	2,005	2,005	1,393
Youth Work Costs	0	975	975	1,809
	<u>149,554</u>	<u>32,047</u>	<u>181,601</u>	<u>183,450</u>
Governance costs				
	-	-	-	(100)
	<u>-</u>	<u>-</u>	<u>-</u>	<u>(100)</u>
Total of expenditure on charitable activities	149,554	32,047	181,601	183,350
Other expenditure				
Common Fund	39,276	-	39,276	52,368
Charitable Giving	9,513	-	9,513	12,257
	<u>48,789</u>	<u>-</u>	<u>48,789</u>	<u>64,625</u>
Employee costs				
Salaries/wages	-	56,949	56,949	54,878
Pension costs	-	2,700	2,700	1,518
	<u>-</u>	<u>59,649</u>	<u>59,649</u>	<u>56,396</u>
Premises costs				
Light, heat and power	11,411	-	11,411	12,483
	<u>11,411</u>	<u>-</u>	<u>11,411</u>	<u>12,483</u>

THE PAROCHIAL CHURCH COUNCIL OF THE ECCLESIASTICAL PARISH OF ST CHRISTOPHER'S SPRINGFIELD

Detailed Statement of Financial Activities

General administrative costs, including depreciation and amortisation				
General insurances	2,477	-	2,477	2,570
Sundry expenses	2,584	-	2,584	1,957
	<u>5,061</u>	<u>-</u>	<u>5,061</u>	<u>4,527</u>
Legal and professional costs				
Audit/Independent examination fees	480	-	480	-
Accountancy and bookkeeping	480	-	480	-
	<u>960</u>	<u>-</u>	<u>960</u>	<u>-</u>
Total of expenditure of other costs	<u>66,221</u>	<u>59,649</u>	<u>125,870</u>	<u>138,031</u>
Total expenditure	215,775	91,696	307,471	321,381
Net gains on investments	-	-	-	-
	<u>(79,539)</u>	<u>0</u>	<u>(79,539)</u>	<u>(38,455)</u>
Net expenditure				
Transfers between funds	-	-	-	-
Net expenditure before other gains/(losses)	<u>(79,539)</u>	<u>0</u>	<u>(79,539)</u>	<u>(38,455)</u>
Other Gains	-	-	-	-
	<u>(79,539)</u>	<u>0</u>	<u>(79,539)</u>	<u>(38,455)</u>
Net movement in funds				
Reconciliation of funds:				
Total funds brought forward	83,616	-	83,616	122,071
Total funds carried forward	<u>4,077</u>	<u>0</u>	<u>4,077</u>	<u>83,616</u>

KEY INFORMATION ON THE ST CHRISTOPHER'S SPRINGFIELD PCC CHARITY

The St Christopher's Springfield PCC is a body corporate (PCC Powers Measure 1956, Church Representation Rules 2011) and a registered charity. The Charity Registration number is: 1151491. The registered name of the charity is: The Parochial Church Council of The Ecclesiastical Parish of St Christopher's Springfield although it is commonly called St Christopher's Springfield PCC.

Membership of the PCC

The Members of the PCC are the Trustees of the St Christopher's Springfield PCC. PCC Members are generally elected at the Annual Parochial Church Council Meeting (APCM) usually for a period of three years.

PCC Membership

During 2024 the following people served as members of the PCC:

Clergy:

Tom Thomas (Vicar)

Churchwarden(s):

Andrew Smith
Mike Smith

Deanery Synod Representatives:

Alex Nance (elected 2024)

Elected members:

Philippa Grimes	(elected 2022)
Catriona Heatherington	(re-elected 2022)
Steven Taggar	(re-elected 2022)
David Hartley	(elected 2023)
Jen Tustain	(elected 2023)
Phil Grimes	(elected 2023)
Helen Cremins	(re-elected 2024)
Alex Nance	(PCC Member until APCM 2024*)
Alison Roper-Hall	(re-elected 2024)

*Members were elected at the APCM on 29th April 2024.

PCC Officers:

Chair	Tom Thomas
Vice-Chair	Alison Roper-Hall
Secretary	Helen Cremins (to APCM 2024*) Lucy Emo (from APCM 2024*)
Treasurer	Steven Taggar
Electoral Roll Officer	Mike Lenton
Stewardship Secretary	Margaret Gordon

Although the Vicar is the Chair of the PCC as defined by the Church Representation Rules, it is the practice at St Christopher's for meetings to be chaired by a lay member of the PCC i.e. the Vice-Chair.

Governing Documents for the PCC:

As part of the Church of England the PCC follows the agreement between The Church of England and the Charity Commission that for all PCCs the "Governing Documents" for the charity will be:

1. The Parochial Church Councils (Powers) Measure 1956 as amended
2. The Church Representation Rules (contained in Schedule to the Synodical Government Measure 1969 as amended).

The PCC Powers Measure defines the powers of a PCC It states that the principal function, or purpose, of the PCC as "promoting in the parish the whole mission of the Church". The full text of the PCC Powers Measure in its currently amended form can be found on the [legislation.gov.uk](http://www.legislation.gov.uk) database at: www.legislation.gov.uk/ukcm/Eliz2/4-5/3/contents The Church Representation Rules define how members are elected to the PCC, the rules for the Electoral Roll and how PCC Officers are appointed. The full text of the Church Representation Rules in its currently amended form can be found on the [legislation.gov.uk](http://www.legislation.gov.uk) database at: www.legislation.gov.uk/ukcm/1969/2/schedule/3



