





Building Trust international is a  
registered charity in England & Wales  
1142338

Building Trust international  
International House  
45-55 Commerical St  
London, E1 6BD

[www.buildingtrustinternational.org](http://www.buildingtrustinternational.org)  
Tel: +447715283054

Welcome

Image: The Gentry Hub

Who we are

Founder's Thoughts

Activities

Financial

Thanks & Media



# Welcome

**The Trustees of Building Trust international are delighted to present our Annual Report for 2022 - 2023.**

During this year, we continued to deliver further educational buildings to communities in need around the world. We continued the construction of MOVINGschool 007 - Morning School on the Thai Burma border. This school opened in August 2022 and offers a safe, colourful space for over 200 children to learn within.

We are able to continue to work on these projects through our partnership with Kanallan, a philanthropic consultancy working with independent humanitarian projects around the world.

The winning design from the HERPLACE design competition continues to be built in Nepal which when finished will be a safe, modern building that will serve tens of thousands of deeply underprivileged girls for decades to come.

We were also pleased to work with Creative Generation in Cambodia to deliver a temporary pavilion made from bamboo with local students in Phnom Penh.

## Key Aims:

- Sustainable design
- Humanitarian architecture
- Awareness raising
- Community involvement
- Aid relief
- Vocational training
- Skills Sharing
- Promote natural materials
- Education
- Create a global community
- Positive social impact

Our work is possible due to the strong well established connections we have with local partners on the ground. Working with architects, engineers, contractors, students and volunteers we are able to continue to grow sustainable design projects helping thousands of communities in need.

During 2023, we look forward to delivering further projects and continue our work in both South East Asia and around the world.

Many Thanks,  
The Trustees April 2023  
(We have complied with the duty in section 4 of the Charities Act 2006 to have due regard to public benefit guidance published by the Commission.)





# Who we are

Building Trust International was founded in June 2011 with the core aim to provide design and architectural assistance to existing charities, individuals and communities in need.

An important aim at Building Trust international is to set-up international stations throughout the world led by local volunteers. We connect with individuals and give them the ownership of finding local projects which are in need of design support.

Our stations reach across the globe from Spain and Brazil, the UK to USA. We thank the individual volunteers in these countries who work tirelessly to promote our charitable work to their local communities.

## Charity Structure:

A team of international volunteer engineers, designers, architects, accountants, landscape architects and more make up our enthusiastic, hardworking team. Local knowledge is key to finding sustainable local solutions, we hope to continue to build upon these relationships as we grow and deliver more projects. Creating a stronger network of like-minded caring professionals and students that can learn from one another and share resources.

## TRUSTEES

Toby Maclean - Founder of Allt  
Lorna Bains - Founder, Vilo Consulting  
Will Postle - Development Director at Design + Industry  
Jude Sellen Cole - Founder of Impact Wellbeing





# Founder's Thoughts



Louise Cole worked as an industrial designer for one of the world's leading toy companies before becoming one of the founding members of Building Trust.

*"It is incredible that over 10 years ago we first stepped foot in Mae Sot and agreed to deliver the first MOVINGschools project. This year it has been amazing to work with the same contractors in the town and return to some of the first school projects working with the local Head Teachers to create new classrooms and playgrounds for their students. I hope we can keep connecting these communities with funding and design many more schools for decades to come"*

L Cole, Co-Founder

## Our Objectives:

To relieve the charitable needs of communities affected by ill health, poverty, war or other disaster in such ways that the Trustees see fit particularly but not exclusively by the provision of:

I) New responses to ill health, conservation, poverty, war or other disaster through design

II) The establishment of architectural projects

III) Education in construction methods and sustainable design principles

One of the ways in which we have carried out our objectives this year is through the continuance of the MOVINGschools project in Mae Sot, Thailand. After 10 years we have been able to deliver 7 schools with more being built. These buildings care for migrant and refugee communities and provide a safe space for teaching to take place.

By working on an art installation in Cambodia we were able educate in local construction methods whilst using locally sourced bamboo fishing baskets to create a beautiful, powerful eye catching structure. Which once used for the installation was then given to a local community to be used again.

We continue to believe **design can be used as a tool for positive social change.**

## Year Successes:

- **1000+** new members
- **5** new **schools**
- **1** conservation **build**
- **2** community **projects**





# MOVINGschools





# MOVINGschools

## An update from MOVINGschools in Thailand

In 2012, the Building Trust team along with local contractors Ironwood and a team of international volunteers constructed the first MOVINGschools project, the winning design from the successful School4Burma design challenge. The school was built with the ability to be de-constructed and moved if needed.

The project has been a success with the original school being carefully moved to a new site In May 2017.

Since then a new nursery space was built to replace an unsafe building for children in need on the Thai/ Burma border. The classrooms are now in full use and students have been enjoying playing football in the school courtyard and taking lessons from monks and their head teacher.

It is great to see the projects fully operational with hundreds of children and their families benefiting from this project.

Through strong collaborations with local partners Building Trust are able to provide much needed educational spaces for communities in need.



Students from MOVINGschool 001 play football



Students play in school garden



Monk teaches at MOVINGschool 006



Lunch time at MOVINGschool 006





# MOVINGschool 007





# MOVINGschool 007

**A brand new colourful school bringing education to over 200 children on the Thai/Burma border.**

The latest MOVINGschool project called Morning School, which is the largest to date, provides multiple classrooms over two floors to children in need. The groundworks took place in March 2022 with the build completed in August 2022.

The MOVINGschools project continues to provide safe learning environments for migrant and refugee communities in Mae Sot, Thailand. Through our partnership with Kanallan and Indigo Children's Fund we have been able to raise the funds needed for the construction of this fantastic new school.

The colourful doorways and bright hallways create an inviting school environment. It was great to be working alongside the local building team Ironwood again to develop a further MOVINGschools project. Like MOVINGschool 001 the structure is made from steel columns which can be easily taken down if needed and moved to a new site. The building also makes use of wooden facades to offer shading in the classrooms and both local bricks for floor tiling and wood.



Students in corridor of their new school



Exterior of school



Internal corridor with bright door panels



Exterior view

**Location** - Mae Sot, Thailand  
**Project Cost** - £82,000  
**Project Partners** - Kanallan  
**Design Team** - cole+partners and Ironwood  
**Project Sponsors** - Kanallan + Indigo Children's Fund  
**Duration** - March - Aug 22





# Love Learning Centre





# Love Learning Centre

A much needed new school project using adobe on the Thailand border.

Building Trust were asked to help to renovate a migrant learning centre on the Thai/Myanmar border.

Initial consultations were held with the school community and a design was finalised and model created to talk through with the Head Teacher and staff.

The Love Learning Centre design uses the sustainable design building technique of using adobe bricks to create the classroom walls. The earthen blocks are produced manually and then left to dry in the sun. Once dried they can be used to build a simple wall structure.

The school will open in June 2023 and will be a safe space for hundreds of children. This is a much needed school due to many families fleeing the war in Myanmar.

***“As a new academic year begins in Thailand, schools for Myanmar migrants are being overwhelmed by surging numbers of families fleeing the post-coup conflict in Myanmar and trying to provide an education to their children. Young would-be pupils have even been found left on some schools’ doorsteps.”***

*From article ‘Migrant schools in Thailand overwhelmed by post-coup arrivals’*

*JUNE 6, 2023 Frontier Myanmar*



Adobe bricks dry in the sun



Local contractors work on site



Model of the school design



Model of the school design

**Location** - Mae Sot, Thailand

**Project Cost** - £22000

**Project Partners** - Kanallan

**Design Team** - Ben Child, Building Trust and Ironwood

**Project Sponsors** - Kanallan + Indigo Children's Fund

**Duration** - March - June 23





# New Road





# New Road

## Reconnecting with a school community from MOVINGSchool 003.

Building Trust aim to maintain strong relationships with the projects we build. After a site visit to a previous school project, the Building Trust team learned the need for a new school building for the community at New Road on the outskirts of Mae Ramat, Thailand.

Through close communication with the school committee and initial design consultations, we were able to design a new school building for over 500 students. Due to COVID, the current school had closed but the teaching staff at New Road continued to work relentlessly teaching their students in make shift classrooms under houses and in local streets.

It was with this knowledge that a new school building was greatly needed, funding was raised and a new school is currently under construction using local contractors and the Ironwood team.

Working alongside Kanallan and Indigo Children's Fund we will be able to create a large, safe school building for the local community. The build uses a steel frame along with locally sourced bamboo.

We cannot wait to see this project completed at the end of 2023.



Render showing exterior of school



Foundations



Contractors lay floor



Digging foundations

**Location** - Mae Ramat, Thailand

**Project Cost** - £75000

**Project Partners** - Kanallan Design Team

-cole+partners, Ben Child BTi and Ironwood

**Project Sponsors** - Kanallan and Indigo Children's Fund

**Duration** - April 23 - due to open November 23

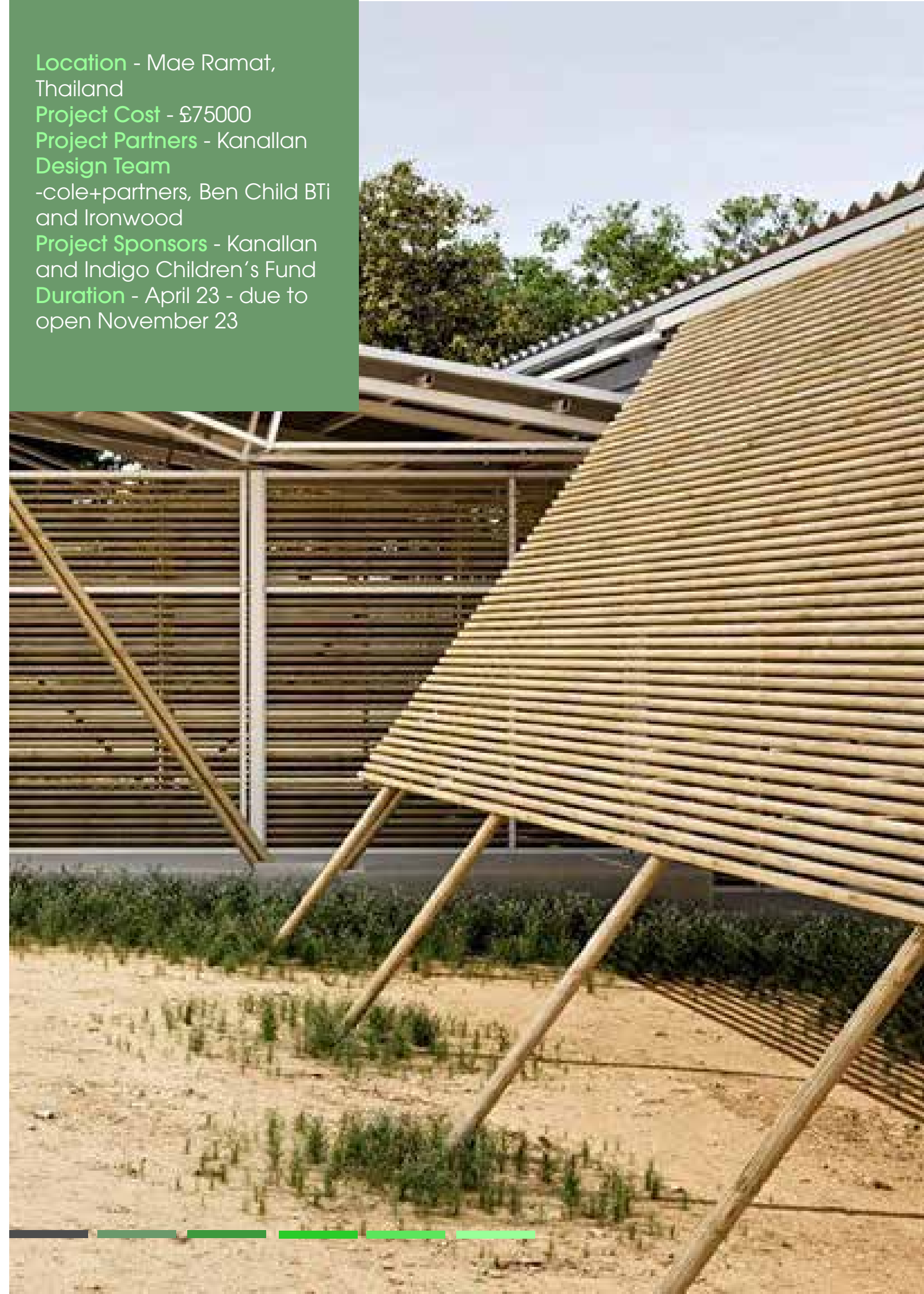



# Street Urchin





# Street Urchin

## Under The Canopy is an exciting new annual temporary pavilion design challenge.

The challenge highlights sustainable design and shines a spotlight on natural materials and low impact architecture. The collaboration of artists, designers, weaving communities and non profits created an architectural installation of more than 500 bamboo baskets named Street Urchin. These baskets created a curving canopy that nestled into a public space near the Friends Futures Factory and the Royal Palace in Phnom Penh, Cambodia. Curling around a large tree, the baskets contributed to the bumpy envelope and gave the pavilion an appearance of its sea creature name sake.

The design team headed up by young designer Noun Songty with support from Cole + Partners and Building Trust international were inspired by Cambodia's rich and ancient basketry. The humble bamboo chicken coop design brought together designers, weavers, artists and students of architecture. The arrangement of the baskets formed a new and contemporary canopy which were assembled in just one week. This provided a temporary space in the courtyard inviting the public to enjoy events and community gatherings under its dappled shade and innovative design.



Construction of bamboo baskets



Entry to canopy - Image by Tyta Art

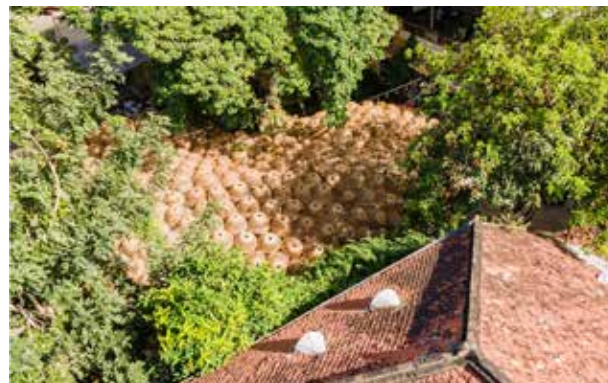

Street Urchin from above - Image by Tyta Art



Final construction - Image by Noun Songty

**Location** - Phnom Penh, Cambodia  
**Project Cost** - n/a  
**Project Partners** - Creative Generation  
**Design Team** - cole+partners and Noun Songty  
**Project Sponsors** - Creative Generation  
**Duration** - November 2022





HER Place





# HER Place

## HER Place Women's empowerment centre takes shape in Nepal.

In May 2021, the winners of the "HER PLACE" design challenge were announced as Dikshya Poudyal and Dibyaswor Lamichhane. The design was selected out of proposals from more than 20 countries. The local jury members praised the winning design for its careful sensitivity to local culture, uniqueness and inclusive approach to design.

We are very pleased to update the progression of the HER Place project which is currently on site in Nepal. The centre broke ground in March 2022 and is due to be completed this year.

The new centre will improve access to healthcare, education and recreation that unfortunately many young women lack from an early age through to womanhood.

The creation of the centre will strengthen an existing outreach and mentor program being provided by Kanallan and the local charity Jagriti Child and Youth Concern Nepal.

We are really looking forward to seeing this project complete and being used in 2023 and beyond.

Photos by Kanallan



Design by Dikshya POUDYAL + Dibyaswor LAMICHHANE



Brick work



HERPlace begins to take shape



Laying bricks

**Location** - Devachuli, Nepal  
**Project Cost** - \$300,000 est  
**Project Partners** - Kanallan and Jagriti Child and Youth Concern Nepal  
**Design Team** - Dikshya Poudyal & Dibyaswor Lamichhane  
**Duration** - March 2022 - ongoing

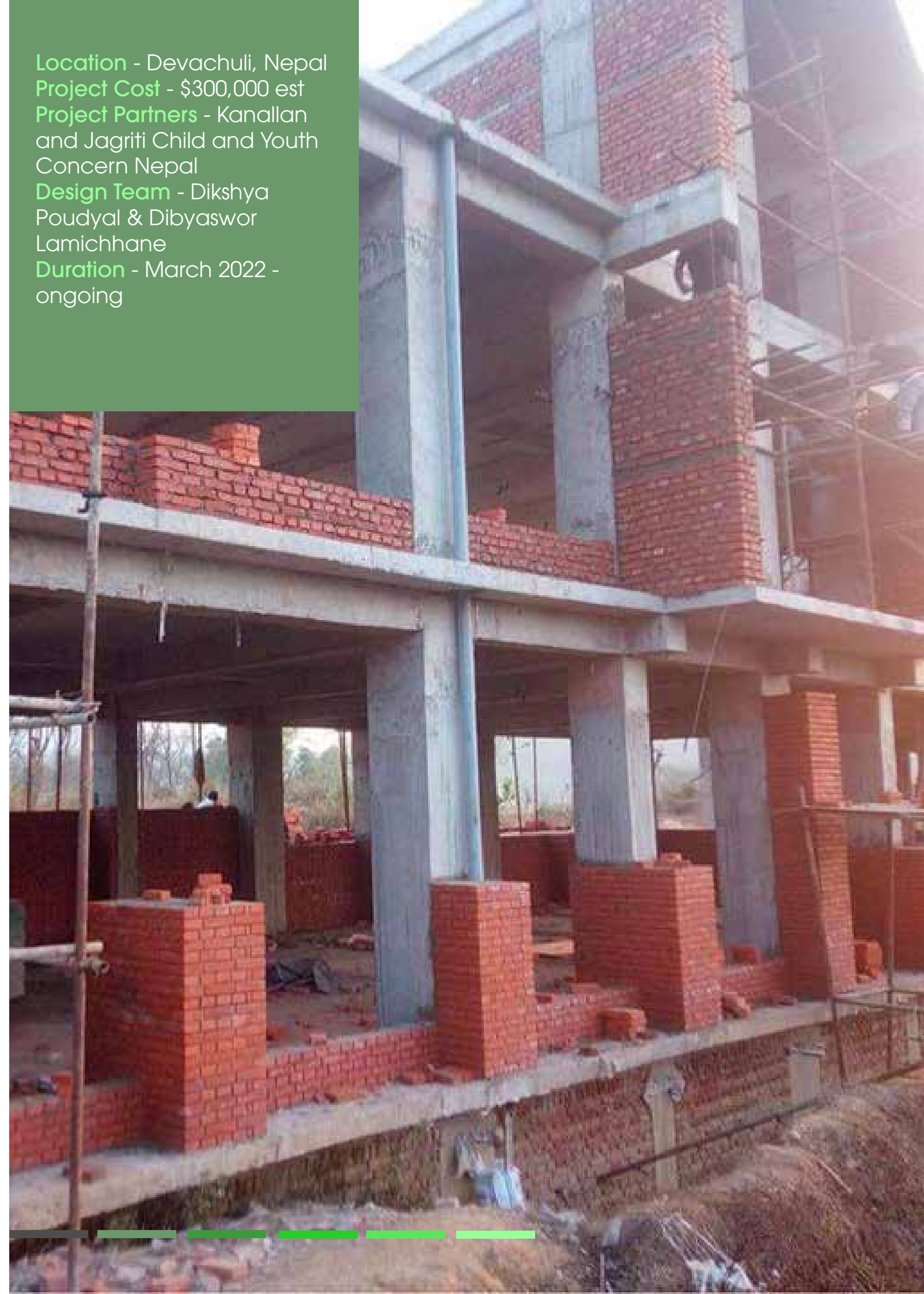



# Cambodian Learning Centres

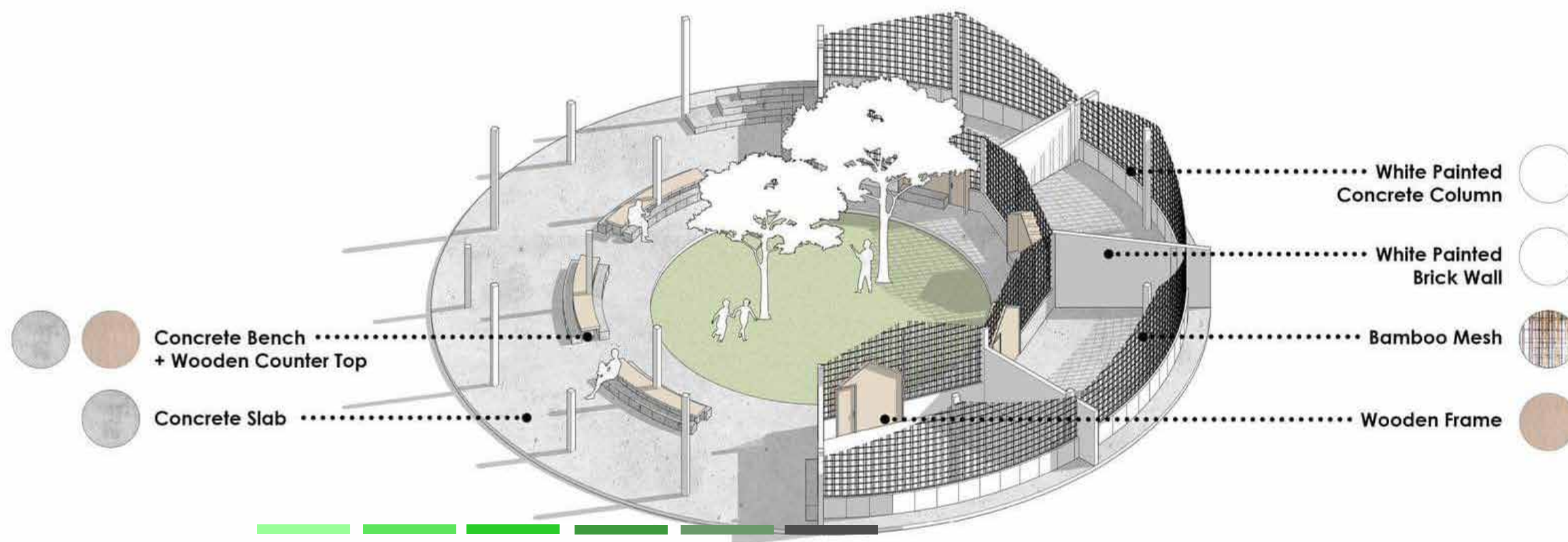
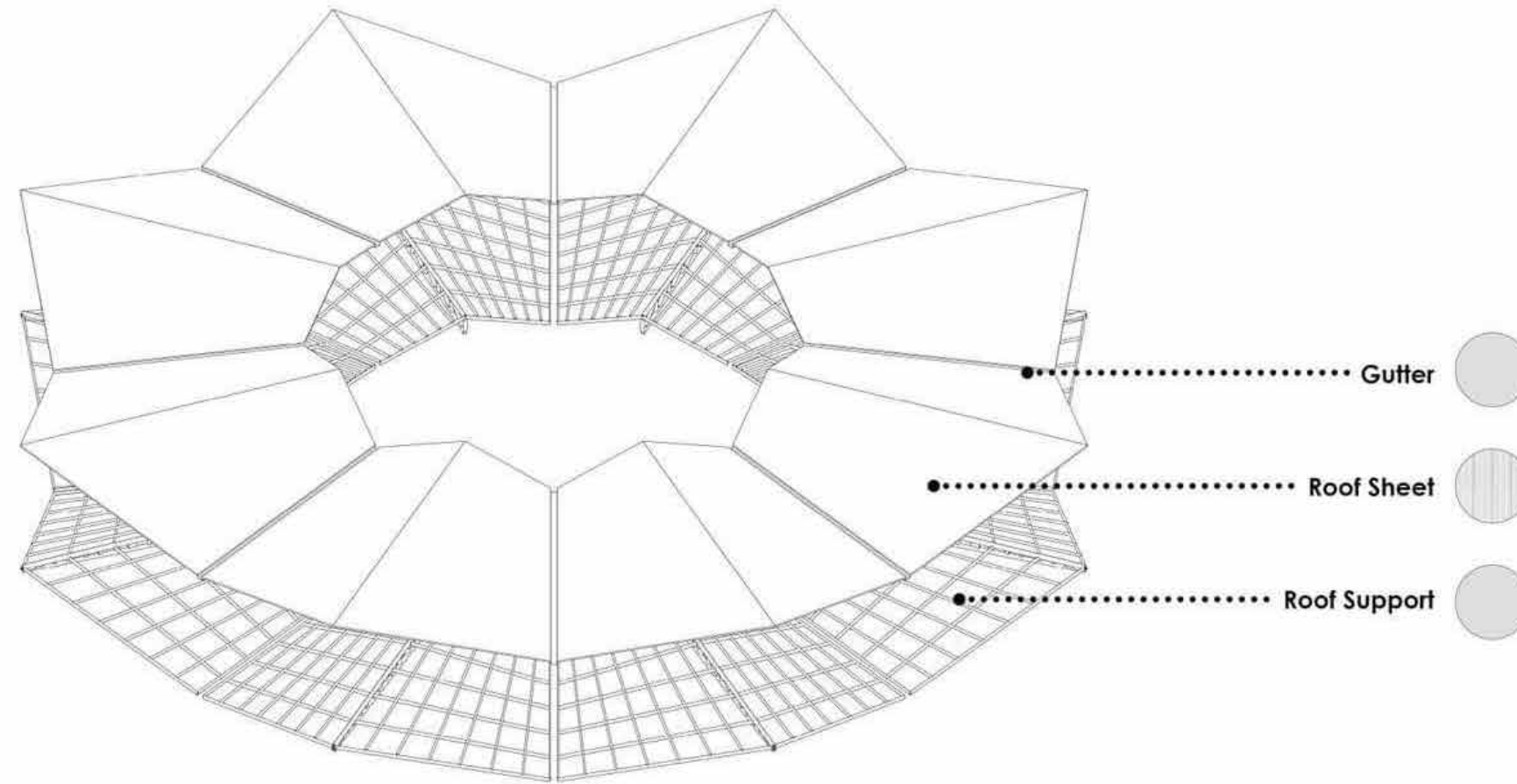



## Exciting new school project to be created in Kulen National Park Cambodia.

Building Trust were asked to design a number of new school buildings for communities in need in rural Cambodia in 2022. Following on from multiple community consultations, the school designs were finalised and are now under construction.

Located within a protected forest the design is the result of work with the community, teachers, the conservation NGO WCS Cambodia, Kulen Outreach and Kanallan.

One school design located at Popel will provide a circular educational space offering an aesthetical design whilst also providing students with a safe, well ventilated spaces with multiple classrooms and shaded spaces for learning.

We really look forward to seeing this school completed in 2023 and giving this community a much needed new school building.



Ground breaking day ceremony at Popel



Foundation work begins at Popel

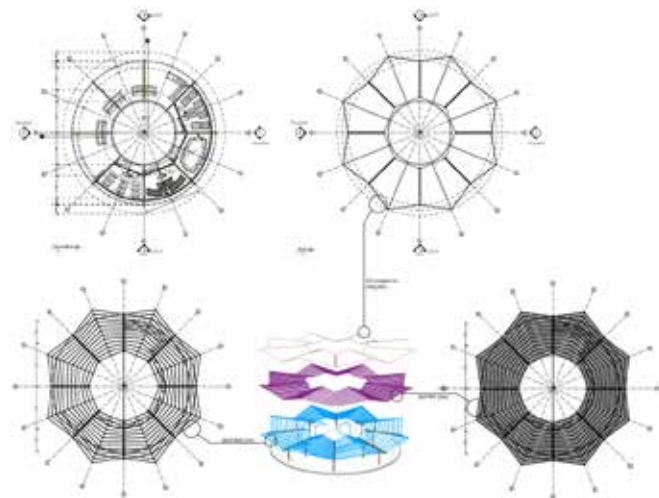

Drawing set for Popel

**Location** - Kulen National Park, Cambodia  
**Project Cost** - £120000  
**Project Partners** - Schools, WCS, Department of Education, Kanallan, KM Engineering  
**Design Team** - cole+partners  
**Project Sponsors** - Kanallan + Indigo Children's Fund, Kulen Outreach  
**Duration** - February 23 - ongoing

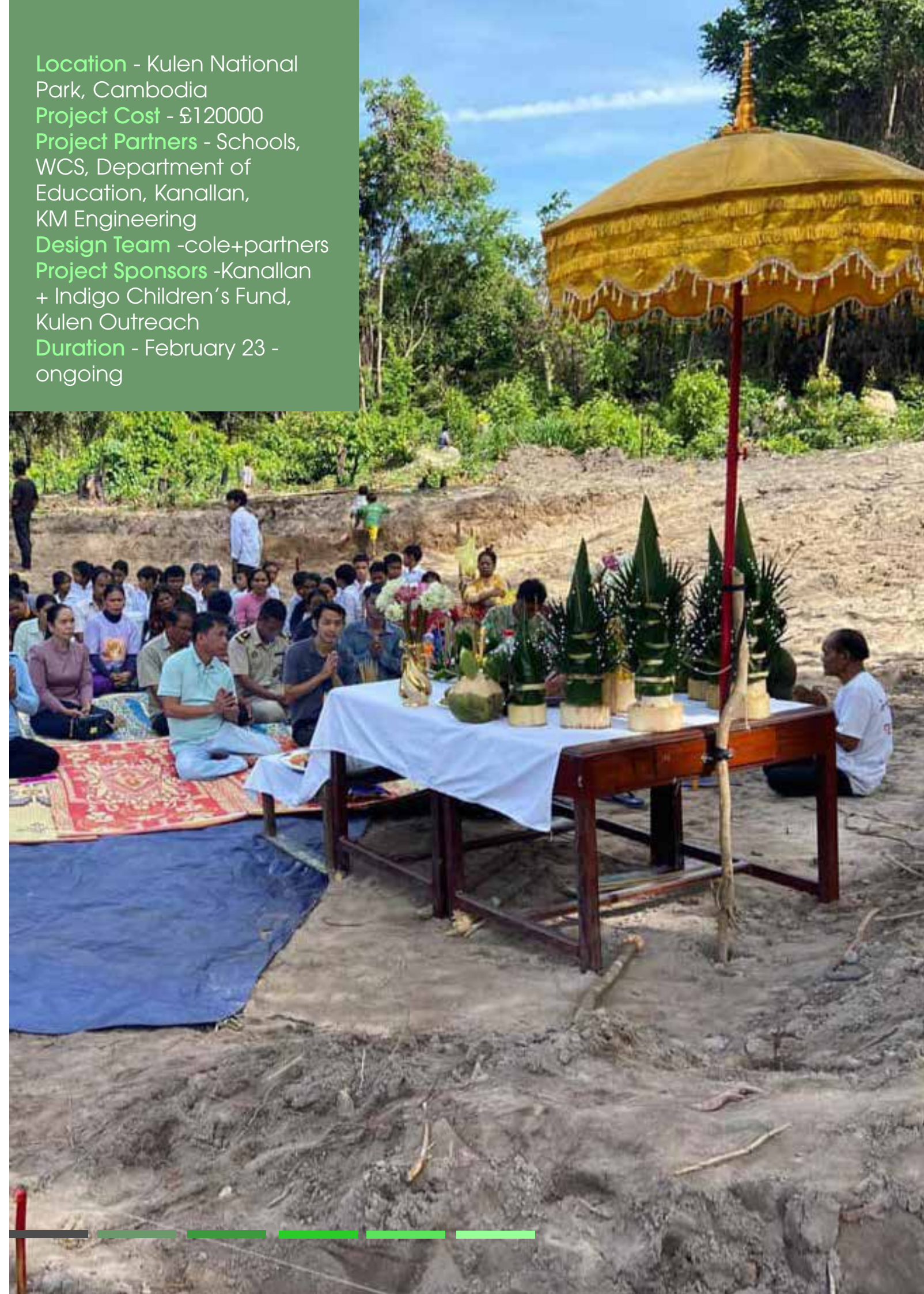



# Cambodian Learning Centres





# Learning centres

An exciting new educational building project in collaboration with conservation organisations to assist protected wildlife areas in Cambodia using decommissioned shipping containers.

Through a series of community workshops in 3 villages, Building Trust were able to look at the design for new classrooms for rural schools in Cambodia.

The aim was to review existing facilities look at increasing capacity and find more sustainable methods of construction utilising locally available materials and improving internal comfort for students and teachers.

During 2022 to 2023 construction began on the 'Out of the Box' school project. Located within a protected forest, the prefab design is the result of work with the community, teachers, the conservation NGO WCS Cambodia and Kanallan to design and install a school prototype that does not take or use natural resources from the local protected forest, providing a clean off grid set of two classrooms and a small multimedia lab/office.

We are looking forward to bringing these designs to life in 2023.



Shipping containers are brought to site



Construction begins

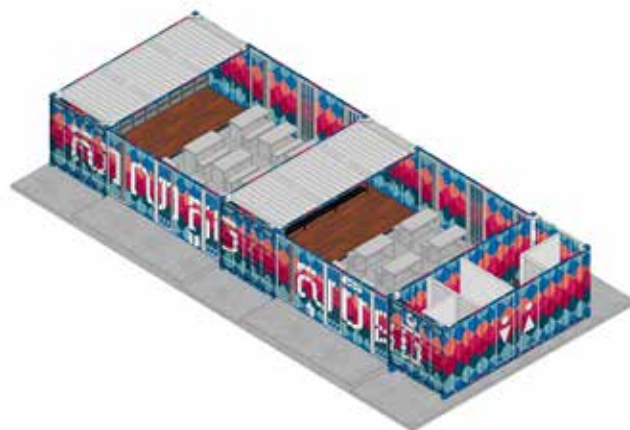

Render of new learning centre

**Location** - Preah Vihear, Cambodia

**Project Cost** -£120000

**Project Partners** - Schools, WCS Cambodia, Department of Education, Kanallan, KM Engineering

**Design Team** -cole+partners

**Project Sponsors** -Kanallan and Indigo Children's Fund

**Duration** - February 23 - ongoing

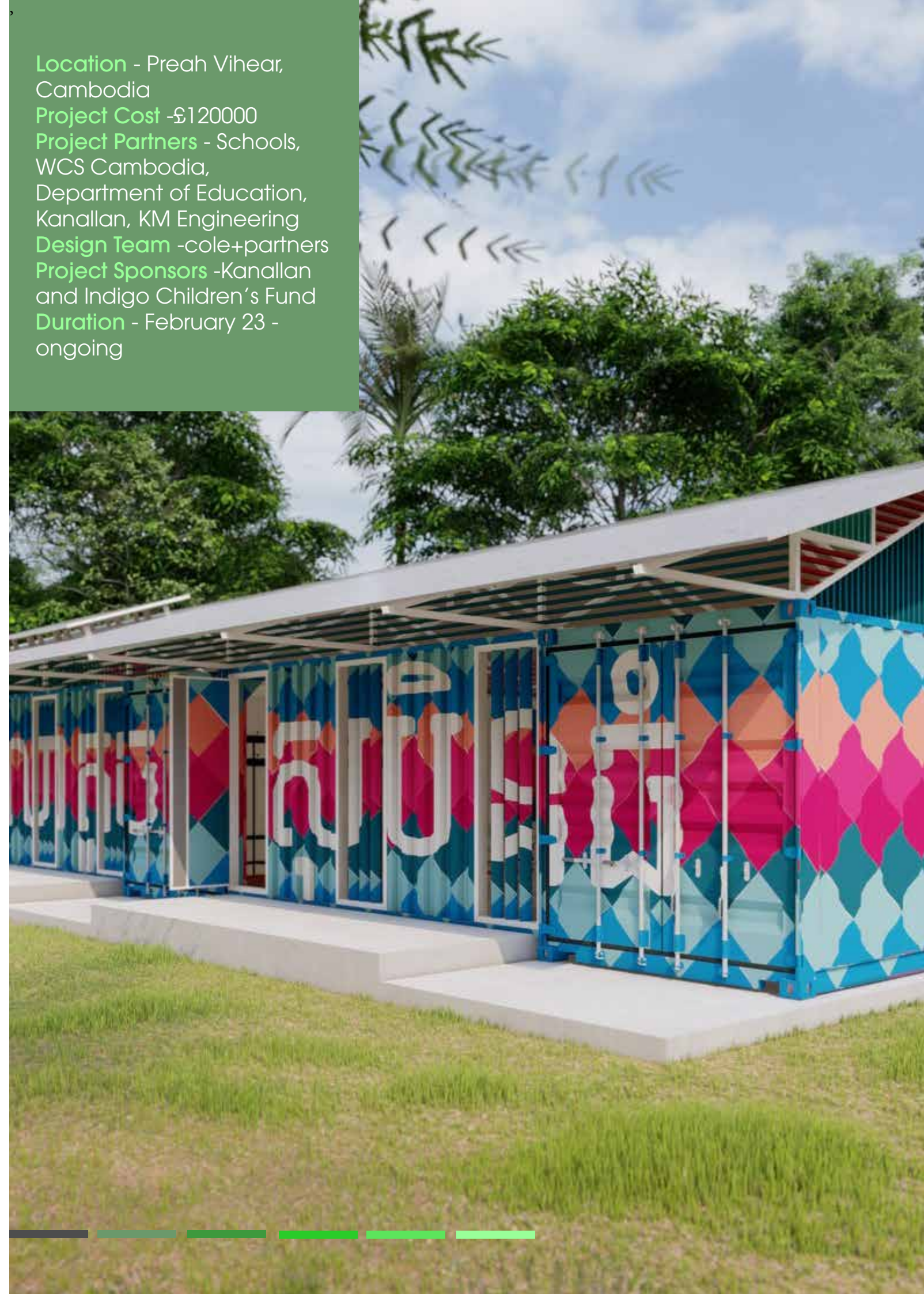



# Laos Base Camp





# Laos Base Camp

## An exciting new conservation project in Laos.

We are very pleased to help with a conservation education centre in Laos that has been coined the base camp. Situated just outside of Luang Prabang the building sits within the wildlife sanctuary run and managed by Free the Bears.

An organisation who we are lucky to have collaborated with for a decade. The charitable wildlife organisation works to end the exploitation of threatened bear species and supports the protection of bears in the wild. We were asked to design a building to provide a much needed base for visiting professionals to stay and study the wildlife and explore ways to protect the wildlife of Laos and the surrounding area.



Inside Laos Base Camp



Overhanging roof to give shade and protection



Space for visitors to rest



Exterior of Laos Base Camp

**Location** - Luang Prabang, Laos  
**Project Cost** - tbc  
**Project Partners** - Free the Bears and Laos Department of Forestry  
**Design Team** -cole+partners  
**Project Sponsors** -Free the Bears  
**Duration** - Oct 22 - ongoing

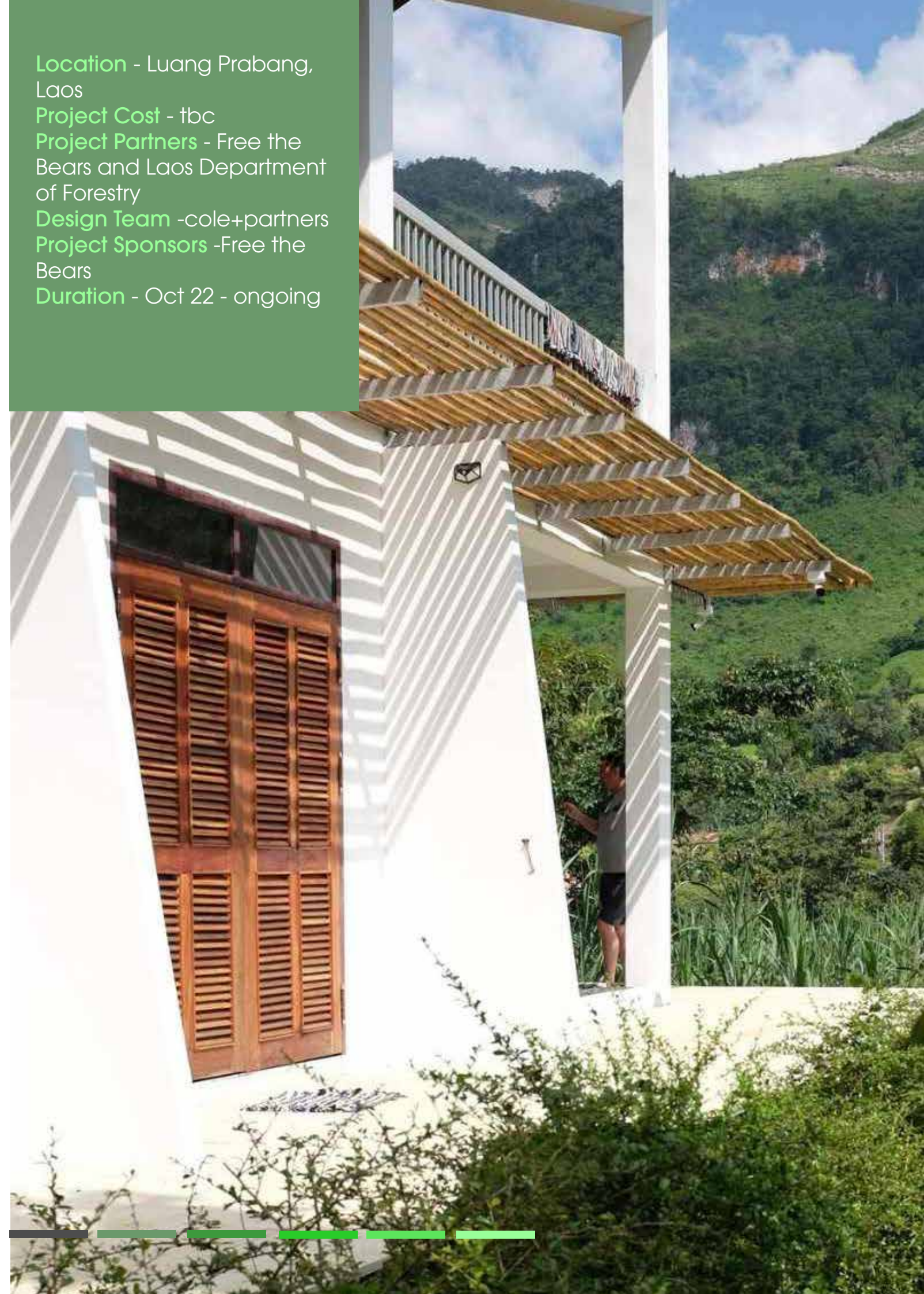



# Kulen Academy Phase 3





# Kulen Academy

**We continue our collaboration with Kulen Outreach to design phase 3 of Kulen Academy.**

Kulen Outreach provides access to quality education to children and youth in rural, Northern Cambodia. Their model works alongside the Cambodian Public School System, helping students at the primary level through job placement.

A large campus and dormitory was built in Siem Reap. The purpose is to house students from the countryside, provide them with English and other supplementary classes while giving them access to the public secondary schools in Siem Reap.

The Building Trust team carried out a design session at Kulen Academy in February 2023 to work on developing designs for phase 3 of the project alongside the local students and staff. It is through this community engagement that we are able to build a project which the end users feel connected to and enjoy to use.

We look forward to sharing details of Phase 3 of Kulen Academy during 2023.



Design consultation



Talk from Elettra Melani BTi Volunteer



Students discuss design ideas

**Location** - Siem Reap, Cambodia  
**Project Cost** - tbc  
**Project Partners** - Kulen Outreach  
**Design Team** - BTi + cole+partners  
**Project Sponsors** - tbc  
**Duration** - 2021 - ongoing





# Members



37 Stations

75+ Countries

85000+ Members

## Stations

International,  
Bangladesh, India  
Hong Kong, Spain  
Brazil, Greece  
Mexico, USA, UK,  
Canada, Australia  
Colombia, Italia  
Cambodia, Japan,  
Bosnia & Herzegovina,  
Uganda, Nepal, South  
Korea, France, Egypt,  
Germany, Dubai,  
Costa Rica, Chile,  
Argentina, Turkey,  
Ecuador, Indonesia,  
Poland, New Zealand,  
Cote d'Ivoire, Kenya,  
China, Sierra Leone  
and Iran.

## Volunteers

Bangladesh, India  
Hong Kong, Spain  
Brazil, China, South  
Africa, Guatemala,  
Canada, England,  
Australia, Portugal,  
Indonesia, France,  
Burma, Malaysia, New  
Zealand, Chile, Turkey,  
Mexico, Ireland,  
Poland, Taiwan, Peru,  
Ecuador, Pakistan,  
Bulgaria, Belgium,  
Mozambique,  
Cambodia, Greece  
Argentina, Sri Lanka,  
Colombia, Italy, New  
Zealand, South Korea,  
Austria, Scotland, USA

We would like to give a special thanks to the key volunteers who have given their free time and dedication to Building Trust over the last year. Many thanks to Emily Holdaway and GT McKillop for pro bono accountancy advice. A special thanks to Chan Chan, Ironwood, Matt Hunt, Tyta Art, Roth 2 Talk, Noun Songty, Kanallan, Kulen Outreach, Louise Cole and our local teams for the use of their photography. A huge thanks to Kanallan, Indigo Children's Fund, Kulen Outreach and Free The Bears for their continued support during this year.



# Financial

## Statement of Financial Activities Year ending 05/04/2023

The accounts follow the Guidance for Small Charities as set out by the Charity Commission. The Annual Report shows the Primary Financial Statement as shown through the SOFA.

The simplified table shown shows the Total Income and Expenditure for 2022 - 2023. Note that £9762 was carried over from the eleventh year of accounts. Building Trust have no Tangible assets and no debts.

£151861 of funds generated were through incoming resources from Voluntary Income. This year a large portion of funding came through our charity partner Kanallan, a philanthropic consultancy that works with charities to facilitate independent humanitarian projects in developing countries. These funds were used to design and construct new schools on the Thai/Burma border and Learning Centres in Cambodia.

This year no funding was raised through activities for generating funds. Funds were however raised through public donations which generated 6.97% of the income.

It should be noted that £9686 of restricted funds were carried forward from the previous year to be spent on MOVINGschool 007.

## Operating Revenues

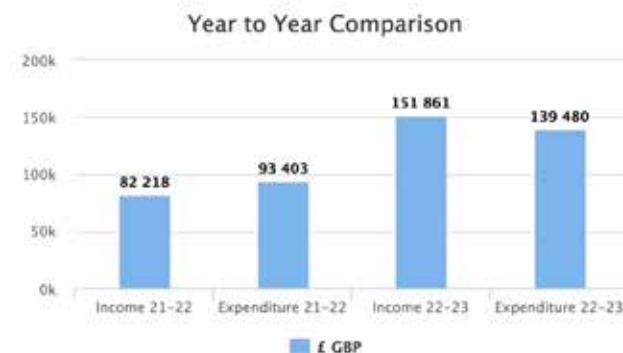

As a small charity we are yet to develop a Reserves Policy, this will be discussed at our next AGM. Please note we work on a project by project basis, our current funds (reserves) to be carried over to 2023 are £22143. A percentage of this will be spent on developing new learning centres in Asia.

We also hope to re-introduce our Membership program along with increasing public donations to generate funds in 2023 and beyond.

As can be seen from the chart above both income and expenditure have increased from years 21-22 to 22-23.

We thank Mrs Emily Holdaway and Mr GT McKillop for their continued pro-bono accountancy support.



Charity Name Building Trust international			Charity No (if any)	1142338	CC17a
Annual accounts for the period					
Period start date	6/4/2022	To	Period end date	5/4/2023	

## Section A Statement of financial activities

Recommended categories by activity	Details of own analysis	Note	Unrestricted funds	Restricted income funds	Endowment funds	Total this year	Total last year	
			£	£	£	£	£	
			F01	F02	F03	F04	F05	
<b>Incoming resources (Note 3)</b>								
Incoming resources from generated funds								
Voluntary income		S01	119,061	32,800		151,861	81,908	
Activities for generating funds		S02						
Investment income		S03						
Incoming resources from charitable activities		S04					310	
Other incoming resources		S05						
<b>Total incoming resources</b>			S06	119,061	32,800	-	151,861	82,218
<b>Resources expended (Notes 4-8)</b>								
Costs of Generating Funds								
Costs of generating voluntary income		S07	176			176	10	
Fundraising trading costs		S08						
Investment management costs		S09						
Charitable activities		S10	91,800	47,504		139,304	93,393	
Governance costs		S11						
Other resources expended		S12						
<b>Total resources expended</b>			S13	91,976	47,504		139,480	93,403
<b>Net incoming/(outgoing) resources before transfers</b>			S14	27,085	- 14,704		12,381	- 11,185
<b>Gross transfers between funds</b>			S15					
<b>Net incoming/(outgoing) resources before other recognised gains/(losses)</b>			S16	22,067	- 9,686		12,381	- 11,185
<b>Other recognised gains/(losses)</b>								
Gains and losses on revaluation of fixed assets for the charity's own use		S17						
Gains and losses on investment assets		S18						
<b>Net movement in funds</b>			S19	22,067	-9,686		12,381	- 11,185
<b>Total funds brought forward</b>			S20	76	9,686		9,762	20,947
<b>Total funds carried forward</b>			S21	22,143	-		22,143	9,762



# Donors & Partners

We are so thankful to all our donors who contributed to our many projects this year:

## Partners:

Kanallan, Indigo Children's Fund, Free the Bears, Ironwood, Allt, Kulen Outreach, Jagriti Child and Youth Concern Nepal, WCS, Friends International, Laos Department of Forestry, Cambodian Education Department, Cole + Partners and Creative Generation.

A huge thanks to everyone who donated to Building Trust international projects around the world.

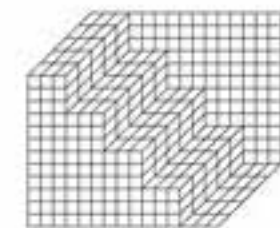



# Media & Press

In our twelfth year as a registered charity we received some fantastic press coverage including the Street Urchin pavilion design being featured in the Phnom Penh Post in Cambodia and online.

We would like to thank the following journalists and editors for their continued support promoting our projects.

ArchDaily, Architecture Lover, ArchitectureinDevelopment, Archnewsnow, Archinect, Architecturelab, Architects Journal, ArchitectureWeek, Architecture World News, Archello, Bustler, BDonline, Catalogo Diseno, Competitions.org, Competitionline, Designboom, Dezeen, E-Architect, World Architecture News

## 20-day celebration of art and design at F3

Long Kimmarita | Publication date 20 November 2022 | 19:43 ICT



The unique canopy being prepared for the event. DANA LANGLOIS



## 500 bamboo baskets weave together for sustainable 'street urchin' pavilion in cambodia

[architecture](#)

[253 shares](#)

[connections: +860](#)





# About

**Building Trust International is a non profit organisation offering design assistance to communities and individuals in need. Building Trust International assesses areas in need, finds sustainable, economical aid solutions and ultimately provides buildings and infrastructure.**

These core actions have blossomed into advocating and educating on the principles of socially aware design, providing an accessible resource on humanitarian design projects and providing a structure for the crossover of information between design professionals.

Building Trust International is a charity registered in England and Wales (1142338).

## Staff

Founder - David Cole  
Founder - Louise Cole

Consulting Partners  
Allt

Media Inquiries  
Please contact:  
[info@buildingtrustinternational.org](mailto:info@buildingtrustinternational.org)

Speaking engagements:  
Building Trust international's designers welcome the opportunity to share our work. For more information please contact Louise Cole at [louise@buildingtrustinternational.org](mailto:louise@buildingtrustinternational.org)

Contact Information  
Building Trust international  
T. +447715283054  
For more information please visit:  
**[www.buildingtrustinternational.org](http://www.buildingtrustinternational.org)**  
Detailed information about each of our projects is shared on our Facebook group  
[www.facebook.com/BuildingTrustInternational](https://www.facebook.com/BuildingTrustInternational)  
© 2010-2023  
Building Trust international  
All rights reserved.

Building Trust international makes every effort to ensure accuracy in donor and volunteer listings, but on occasion errors may occur. Please contact us at +447715283054 with any questions or comments.

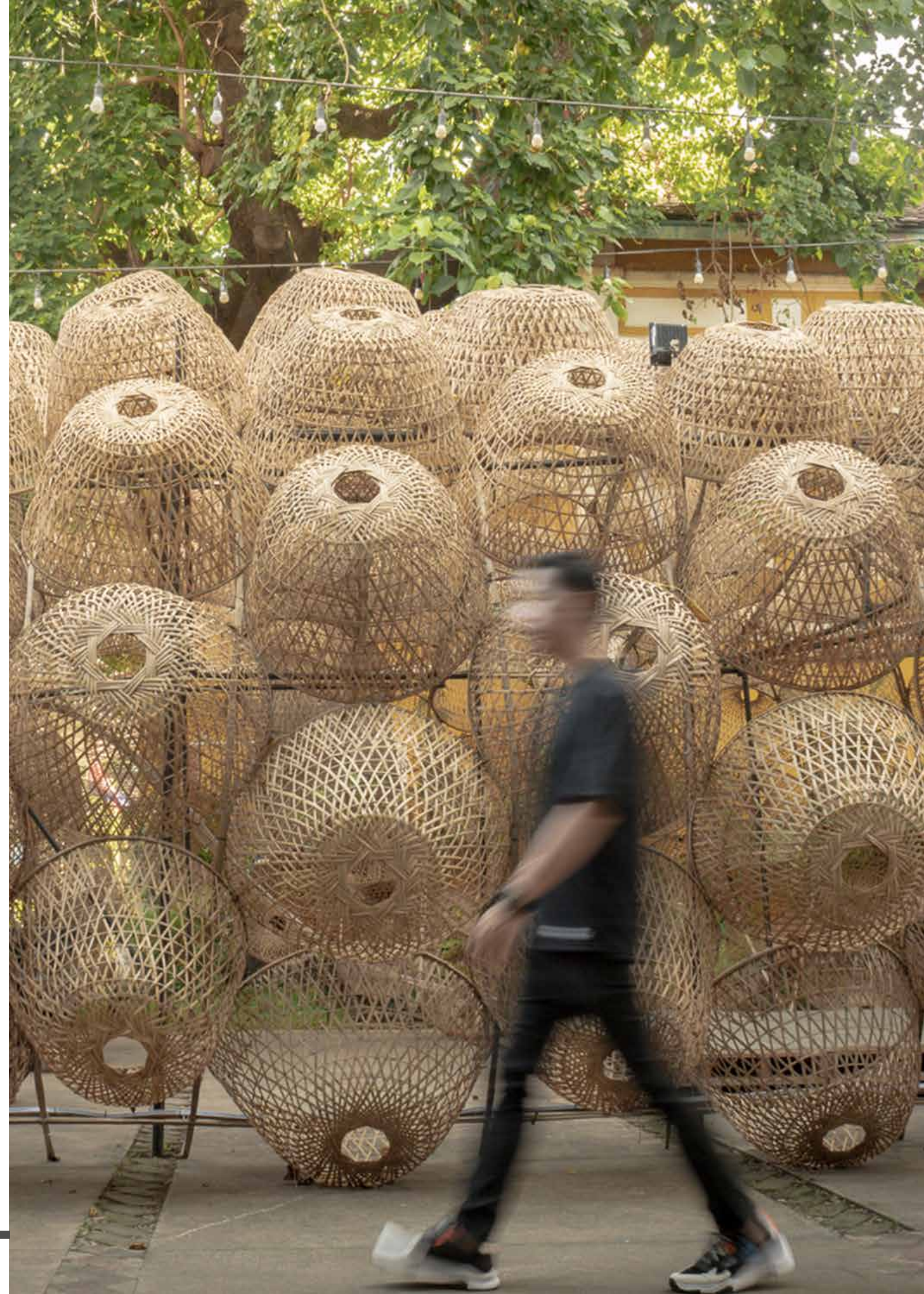



Building Trust international is a registered charity in England & Wales 1142338

Building Trust international  
International House  
45-55 Commercial St  
London, E1 6BD

[www.buildingtrustinternational.org](http://www.buildingtrustinternational.org)  
Tel: +447715283054  
© 2023 Building Trust International





Charity Name Building Trust international			Charity No (if any)	1142338	CC17a
Annual accounts for the period					
Period start date	6/4/2022	To	Period end date	5/4/2023	

## Section A Statement of financial activities

Recommended categories by activity	Details of own analysis	Note	Unrestricted funds £	Restricted income funds £	Endowment funds £	Total this year £	Total last year £
			F01	F02	F03	F04	F05
<b>Incoming resources (Note 3)</b>							
Incoming resources from generated funds							
Voluntary income		S01	119,061	32,800		151,861	81,908
Activities for generating funds		S02					
Investment income		S03					
Incoming resources from charitable activities		S04					310
Other incoming resources		S05					
<b>Total incoming resources</b>		S06	119,061	32,800	-	151,861	82,218
<b>Resources expended (Notes 4-8)</b>							
Costs of Generating Funds							
Costs of generating voluntary income		S07	176			176	10
Fundraising trading costs		S08					
Investment management costs		S09					
Charitable activities		S10	91,800	47,504		139,304	93,393
Governance costs		S11					
Other resources expended		S12					
<b>Total resources expended</b>		S13	91,976	47,504		139,480	93,403
<b>Net incoming/(outgoing) resources before transfers</b>		S14	27,085	- 14,704		12,381	- 11,185
<b>Gross transfers between funds</b>		S15					
<b>Net incoming/(outgoing) resources before other recognised gains/(losses)</b>		S16	22,067	- 9,686		12,381	- 11,185
<b>Other recognised gains/(losses)</b>							
Gains and losses on revaluation of fixed assets for the charity's own use		S17					
Gains and losses on investment assets		S18					
<b>Net movement in funds</b>		S19	22,067	-9,686		12,381	- 11,185
<b>Total funds brought forward</b>		S20	76	9,686		9,762	20,947
<b>Total funds carried forward</b>		S21	22,143	-		22,143	9,762



## Section B Balance sheet

	Note	Unrestricted funds £	Restricted income funds £	Endowment funds £	Total this year £	Total last year £
		F01	F02	F03	F04	F05
<b>Fixed assets</b>						
<b>Tangible assets</b>						
(Note 9)	B01	-	-	-	-	-
	B02	-	-	-	-	-
<b>Investments</b>						
(Note 10)	B03	-	-	-	-	-
<b>Total fixed assets</b>	B04	-	-	-	-	-
<b>Current assets</b>						
<b>Stock and work in progress</b>	B05	-	-	-	-	-
<b>Debtors</b>	B06	-	-	-	-	-
(Short term) investments	B07	-	-	-	-	-
Cash at bank and in hand	B08	-	-	-	-	-
<b>Total current assets</b>	B09	-	-	-	-	-
<b>Creditors: amounts falling due within one year</b>						
(Note 12)	B10	-	-	-	-	-
<b>Net current assets/ (liabilities)</b>	B11	-	-	-	-	-
<b>Total assets less current liabilities</b>	B12	-	-	-	-	-
<b>Creditors: amounts falling due after one year</b>						
(Note 12)	B13	-	-	-	-	-
<b>Provisions for liabilities and charges</b>	B14	-	-	-	-	-
<b>Net assets</b>	B15	-	-	-	-	-
<b>Funds of the Charity</b>						
<b>Unrestricted funds</b>	B16	-	-	-	-	-
	B17	-	-	-	-	-
<b>Restricted income funds</b>						
(Note 13)	B18	-	-	-	-	-
<b>Endowment funds (Note 13)</b>	B19	-	-	-	-	-
<b>Total funds</b>	B20	-	-	-	-	-

Signed by one or two trustees  
on behalf of all the trustees

Signature	Print Name	Date of approval
	JUDE SELLEN COLE	5/9/2023

Cells highlighted in Yellow contain formulas to add up columns C,D and E but these are not protected cells

Cells highlighted in Blue contain formulas in protected cells. The protection can be removed from the tools menu



Note 1 **Basis of preparation**

***This section should be completed by all charities.***

**1.1 Basis of accounting**

These accounts have been prepared on the basis of historic cost (except that investments are shown at market value) in accordance with:

- Accounting and Reporting by Charities – Statement of Recommended Practice (SORP 2005);
- and with\* 

ü

 Accounting Standards;
- or 

 Financial Reporting Standards for Smaller Enterprises (FRSSE);
- and with the Charities Act.

[\*\* except for the following].

***Give details in this box if a different standard has been followed.***

\* -Tick as appropriate:

· if all relevant disclosures shown in the pack have been given then please tick "Accounting Standards";

· if disclosures completed in these accounts have been restricted to those required by the FRSSE, then please tick "Financial Reporting Standards for Smaller Enterprises (FRSSE)".

\*\* - If no departures from the chosen standards have been made then delete these words; otherwise give details of any changes in the boxes.

**1.2 Change in basis of accounting**

There has been no change to the accounting policies (valuation rules and methods of accounting) since last year (§ except for the following).

***Give details in this box of any material changes that have been made.***

§ if no changes have been made to accounting policies then delete these words.

**1.3 Changes to previous accounts**

No changes have been made to accounts for previous years (§§ except for the following).

***Give details in this box of any material changes that have been made.***

§§ if no changes have been made to accounts for previous periods then delete these words.



**Note 2 Accounting policies**

*This standard list of accounting policies has been applied by the charity except for those deleted. Where a different or additional policy has been adopted then this is detailed in the box below.*

**INCOMING RESOURCES**

<b>Recognition of incoming resources</b>	These are included in the Statement of Financial Activities (SoFA) when: <ul style="list-style-type: none"> <li>· the charity becomes entitled to the resources;</li> <li>· the trustees are virtually certain they will receive the resources; and</li> <li>· the monetary value can be measured with sufficient reliability.</li> </ul>
<b>Incoming resources with related expenditure</b>	Where incoming resources have related expenditure (as with fundraising or contract income) the incoming resources and related expenditure are reported gross in the SoFA.
<b>Grants and donations</b>	Grants and donations are only included in the SoFA when the charity has unconditional entitlement to the resources.
<b>Tax reclaims on donations and gifts</b>	Incoming resources from tax reclaims are included in the SoFA at the same time as the gift to which they relate.
<b>Contractual income and performance related grants</b>	This is only included in the SoFA once the related goods or services have been delivered.
<b>Gifts in kind</b>	Gifts in kind are accounted for at a reasonable estimate of their value to the charity or the amount actually realised.  Gifts in kind for sale or distribution are included in the accounts as gifts only when sold or distributed by the charity.  Gifts in kind for use by the charity are included in the SoFA as incoming resources when receivable.
<b>Donated services and facilities</b>	These are only included in incoming resources (with an equivalent amount in resources expended) where the benefit to the charity is reasonably quantifiable, measurable and material. The value placed on these resources is the estimated value to the charity of the service or facility received.
<b>Volunteer help</b>	The value of any voluntary help received is not included in the accounts but is described in the trustees' annual report.
<b>Investment income</b>	This is included in the accounts when receivable.
<b>Investment gains and losses</b>	This includes any gain or loss on the sale of investments and any gain or loss resulting from revaluing investments to market value at the end of the year.

**EXPENDITURE AND LIABILITIES**

<b>Liability recognition</b>	Liabilities are recognised as soon as there is a legal or constructive obligation committing the charity to pay out resources.
<b>Governance costs</b>	Include costs of the preparation and examination of statutory accounts, the costs of trustee meetings and cost of any legal advice to trustees on governance or constitutional matters.
<b>Grants with performance conditions</b>	Where the charity gives a grant with conditions for its payment being a specific level of service or output to be provided, such grants are only recognised in the SoFA once the recipient of the grant has provided the specified service or output.
<b>Grants payable without performance conditions</b>	These are only recognised in the accounts when a commitment has been made and there are no conditions to be met relating to the grant which remain in the control of the charity.
<b>Support Costs</b>	Support costs include central functions and have been allocated to activity cost categories on a basis consistent with the use of resources, eg allocating property costs by floor areas, or per capita, staff costs by the time spent and other costs by their usage.

**ASSETS**

<b>Tangible fixed assets for use by charity</b>	These are capitalised if they can be used for more than one year, and cost at least £500. They are valued at cost or a reasonable value on receipt.
<b>Investments</b>	Investments quoted on a recognised stock exchange are valued at market value at the year end. Other investment assets are included at trustees' best estimate of market value.
<b>Stocks and work in progress</b>	These are valued at the lower of cost or market value.

**POLICIES ADOPTED  
ADDITIONAL TO OR  
DIFFERENT FROM  
THOSE ABOVE**



**Note 3 Analysis of incoming resources**

*Incoming resources may be further analysed if this would help the reader of the accounts.*

	Analysis	This year £	Last year £
<b>Voluntary income</b>	Public Donations (unrestricted)	5,575	8,457
	Public Donations (restricted)	5,018	
	Gift Aid		251
	MOVINGSCHOOLS 005 (res)		7,500
	Kanallan/ICF MS6 (res)		16,500
	Kanallan/ICF MS7 (res)	32,800	49,200
	Love Learning Centre	21,533	
	Cambodian Learning Centres	80,000	
	FTB Asia	6,935	
	<b>Total</b>	<b>151,861</b>	<b>81,908</b>
<b>Activities for generating funds</b>			
	<b>Total</b>		
<b>Investment income</b>			
	<b>Total</b>		
<b>Incoming resources from charitable activities</b>	Herplace Design Competition		310
	<b>Total</b>	<b>-</b>	<b>310</b>



**Section C**
**Notes to the accounts**
**Note 4**
**Analysis of resources expended**

Resources expended may be further analysed if this would help the reader of the accounts.

	Analysis	This year £	Last year £
<b>Costs of generating voluntary income</b>	Bank incoming charges		10
	Web Domain	40	
	International bank charges	19	
	Office	117	
	<b>Total</b>	<b>176</b>	<b>10</b>
<b>Fundraising trading costs</b>			
	<b>Total</b>		
<b>Investment management costs</b>			
	<b>Total</b>		
<b>Charitable activities</b>			
	Herplace Design Competition		3,324
	MOVINGSCHOOLS 005 (res)		7,500
	MOVINGSCHOOLS 005 (unres)		7,524
	Cambodia Learning Centres	57,475	3,324
	FTB Asia (res)		4,519
	FTB Asia (unres)	3,339	241
	Kulen Academy Phase 2		5,448
	Kanallan/ICF MS6 (res)		16,500
	Kanallan/ICF MS6 (unres)		5,500
	Kanallan/ICF MS7 (res)	47,504	39,514
	Kanallan/ICF MS7 (un res)	70	
	Love Learning Centre	6,803	
	New Road	20,897	
	Street Urchin	3,215	
	<b>Total</b>	<b>139,304</b>	<b>93,393</b>
<b>Governance costs</b>			-
		-	-
		-	-
	<b>Total</b>	<b>-</b>	<b>-</b>
<b>Other resources expended</b>			
	<b>Total</b>		



**Note 5 Support Costs**

*Please complete this note if the charity has analysed its expenses using activity categories and has support costs.*

Support cost type	Fundraising activity £	Charitable Activity £	Governance Activity £	Total Cost £
	-	-	-	-
	-	-	-	-
	-	-	-	-
	-	-	-	-
	-	-	-	-
	-	-	-	-
	-	-	-	-
<b>Total</b>	-	-	-	-

**Note 6 Details of certain items of expenditure****6.1 Trustee expenses**

*Please provide details of the amount of any payment or reimbursement of out-of-pocket expenses made to trustees or to third parties for expenses incurred by trustees. If no expenses were paid, please enter 'None' in the appropriate box(es).*

Number of trustees who were paid expenses

Nature of the expenses

Total amount paid

This year	Last year
£	£

**6.2 Fees for examination or audit of the accounts**

*Please provide details of the amount paid for any statutory external scrutiny of accounts and other services provided by your independent examiner or auditor. If nothing was paid please enter NONE in the appropriate box(es).*

Independent examiner's or auditors' fees for reporting on the accounts

Other fees (for example: advice, consultancy, accountancy services) paid to the independent examiner or auditor

This year £	Last year £



## Note 7

## Paid employees

Please complete this note if the charity has any employees.

## 7.1 Staff Costs

	This year £	Last year £
Gross wages, salaries and benefits in kind	35,000	35,000
Employer's National Insurance costs	3,763	3,610
Pension costs		-
<b>Total staff costs</b>	<b>38,763</b>	<b>38,610</b>

## 7.2 Average number of full-time equivalent employees in the year

The parts of the charity in which the employees work

	This year Number	Last year Number
Fundraising	-	-
Charitable Activities	-	-
Governance	-	-
Other	-	-
<b>Total</b>	<b>-</b>	<b>-</b>

## 7.3 Defined contribution pension scheme

Please complete if a defined contribution pension scheme is operated.

Brief details of the scheme

--

	This year £	Last year £
The costs of the scheme to the charity for the year		
The amount of any contributions outstanding at the year end		
The amount of any contributions prepaid at the year end		



**Note 8** **Grantmaking**

**Please complete this note if the charity made any grants or donations which in aggregate form a material part of the charitable activities undertaken.**

### 8.1 Total value of grants

Purpose for which grants made	Grants to institutions Total amount £	Grants to individuals Total amount £
	-	-
	-	-
	-	-
	-	-
	-	-
	-	-
<b>Total</b>	-	-

### 8.1 Grantmaking costs

***If the charity's accounts are prepared on the "activity basis" please give details of any support cost associated with grantmaking. Please enter "Nil" if the charity does not identify and/or allocate support costs.***

### Support costs of grantmaking

£

### 8.3 Grants made to institutions

***If the charity has made grants to particular institutions that are material in the context of its grantmaking please give details of the institution supported, purpose of the grant and total paid to each institution listed. Sufficient information should be given to provide a reasonable understanding of the range of institutions supported.***

Range of institutions supported.		
Names of institutions	Purpose	Total amount of grants paid £
		-
		-
		-
		-
		-
		-
		-
		-
		-
		-
		-
<b>Total grants to institutions</b>		-



**Note 9 Tangible fixed assets***Please complete this note if the charity has any tangible fixed assets***9.1 Cost or valuation**

	Freehold land & buildings	Other land & buildings	Plant, machinery and motor vehicles	Fixtures, fittings and equipment	Payments on account and assets under construction	Total
	£	£	£	£	£	£
Balance brought forward	-	-	-	-	-	-
Additions	-	-	-	-	-	-
Revaluations	-	-	-	-	-	-
Disposals	-	-	-	-	-	-
Transfers *	-	-	-	-	-	-
Balance carried forward	-	-	-	-	-	-

**9.2 Accumulated depreciation and impairment provisions**

<b>**Basis</b>	SL or RB	SL or RB	SL or RB	SL or RB	SL or RB
<b>** Rate</b>					

Balance brought forward	-	-	-	-	-	-
Depreciation charge for year	-	-	-	-	-	-
Impairment provisions	-	-	-	-	-	-
Revaluations	-	-	-	-	-	-
Disposals	-	-	-	-	-	-
Transfers*	-	-	-	-	-	-
Balance carried forward	-	-	-	-	-	-

**9.3 Net book value**

Brought forward	-	-	-	-	-	-
Carried forward	-	-	-	-	-	-

**9.4 Revaluation***If any fixed assets have been revalued please give details of the valuer and method of valuation*

--

\* The "transfers" row is for movements between fixed asset categories.

\*\* Please indicate the method of depreciation by deleting the method not applicable (SL = straight line; RB = reducing balance). Also please indicate the rate of depreciation: for straight line, what is the anticipated life of the asset (in years); for reducing balance, what is the percentage annual deduction.



**Note 10 Investment assets**

*Please complete this note if the charity has any investment assets.*

**10.1 Fixed assets investments**

	£
Carrying (market) value at beginning of year	-
<b>Add:</b> additions to investments at cost	-
<b>Less:</b> disposals at carrying value	-
<b>Add/(deduct):</b> net gain/(loss) on revaluation	-
Carrying (market) value at end of year	-

*Please provide below:*

**10.2 A breakdown of the market values of investments shown above agreeing with the balance sheet row B03.**

**10.3 A breakdown of the income from investments agreeing with SOFA row S03.**

**Analysis of investments**

	<b>10.2 Market value at year end</b>	<b>10.3 Income from investments for the year</b>
	£	£
Investment properties	-	-
Investments listed on a recognised stock exchange or held in common investment funds, open ended investment companies, unit trusts or other collective investment schemes	-	-
Investments in subsidiary or connected undertakings and companies	-	-
Securities not listed on a recognised Stock Exchange	-	-
Cash held as part of the investment portfolio	-	-
Other investments	-	-
<b>Total</b>	-	-

**10.4 Material investment holdings**

If any single investment is material in terms of its value (for example represents more than 5 per cent of the value of the charity's total investments) please provide details.

Investment held	
Market Value	



**Note 11 Debtors and prepayments**

*Please complete this note if the charity has any debtors or prepayments.*

**Analysis of debtors**

	Amounts falling due within one year		Amounts falling due after more than one year	
	This year £	Last year £	This year £	Last year £
Trade debtors	-	-	-	-
Amounts due from subsidiary and associated undertakings	-	-	-	-
Other debtors	-	-	-	-
Prepayments and accrued income	-	-	-	-
<b>Total</b>	-	-	-	-

**Note 12 Creditors and accruals**

*Please complete this note if the charity has any creditors or accruals.*

**12.1 Analysis of creditors**

	Amounts falling due within one year		Amounts falling due after more than one year	
	This year £	Last year £	This year £	Last year £
Loans and overdrafts	-	-	-	-
Trade creditors	-	-	-	-
Amounts due to subsidiary and associated undertakings	-	-	-	-
Other creditors	-	-	-	-
Accruals and deferred income	-	-	-	-
<b>Total</b>	-	-	-	-

**12.2 Security over assets**

*If any loan, overdraft or other creditor holds a charge or other security over any assets of the charity please provide details.*

--







## Note 14 Transactions with related parties

*If the charity has any transactions with related parties (other than the trustee expenses explained in note 6) details of such transactions should be provided in this note. If there are no transactions to report, please enter "None" in the relevant boxes.*

### 14.1 Remuneration and benefits

*Please give the amount of, and legal authority for, any remuneration or other benefits paid to a trustee or other related parties by the charity or any institution or company connected with it.*

Name of trustee or connected party	Legal authority (eg order, governing document)	Amounts paid or benefit value	
		This year £	Last year £

### 14.2 Loans

*Please give details of and amounts owing to or from the charity's trustees or other related parties by the charity at the year end.*

	Name of trustee or connected party	Legal authority	Amount owing	
			This year £	Last year £
Due to trustees and related parties				
Due from trustees and related parties				

### 14.3 Other transaction(s) with trustees or related parties

*Please give details of any transaction undertaken by (or on behalf of) the charity in which a trustee or related party has a material interest.*

Name of the trustee or related party	Relationship to charity	Description of the transaction(s)	This year £	Last year £



Section C	Notes to the accounts	(cont)
<b>Note 15</b>	<b>Additional Disclosures</b>	<p>The following are significant matters which are not covered in other notes and need to be included to provide a proper understanding of the accounts. If there is insufficient room here, please add a separate sheet.</p>





## Independent examiner's report on the accounts

### Section A

### Independent Examiner's Report

#### Report to the trustees

Building Trust International

#### On accounts for the year ended

5/4/2023

Charity no  
(if any)

1142338

#### Set out on pages

1-3

#### Responsibilities and basis of report

I report to the trustees on my examination of the accounts of the above charity ("the Trust") for the year ended 05/04/2023.

As the charity's trustees, you are responsible for the preparation of the accounts in accordance with the requirements of the Charities Act 2011 ("the Act").

I report in respect of my examination of the Trust's accounts carried out under section 145 of the 2011 Act and in carrying out my examination, I have followed all the applicable Directions given by the Charity Commission under section 145(5)(b) of the Act.

#### Independent examiner's statement

~~[The charity's gross income exceeded £250,000 and I am qualified to undertake the examination by being a qualified member of [insert name of applicable listed body]]. Delete [ ] if not applicable.~~

I have completed my examination. I confirm that no material matters have come to my attention in connection with the examination (~~other than that disclosed below~~\*) which gives me cause to believe that in, any material respect:

- the accounting records were not kept in accordance with section 130 of the Charities Act; or
- the accounts did not accord with the accounting records; or
- the accounts did not comply with the applicable requirements concerning the form and content of accounts set out in the Charities (Accounts and Reports) Regulations 2008 other than any requirement that the accounts give a 'true and fair' view which is not a matter considered as part of an independent examination.

I have no concerns and have come across no other matters in connection with the examination to which attention should be drawn in this report in order to enable a proper understanding of the accounts to be reached.

\* Please delete the words in the brackets if they do not apply.



**Signed:** 

**Date:** 09/01/2024

**Name:** Mrs Emily Annette Holdaway

**Relevant professional qualification(s) or body (if any):** Member of the Chartered Institute of Management Accountants  
Member ID:1-82YNC

**Address:** 7 Stephen Street  
Redfield  
Bristol BS5 9DY

## Section B

### Disclosure

Only complete if the examiner needs to highlight material matters of concern (see CC32, Independent examination of charity accounts: directions and guidance for examiners).

---



**Give here brief details  
of any items that the  
examiner wishes to  
disclose.**