



Building Trust international is a
registered charity in England & Wales
1142338

Building Trust international
International House
45-55 Commerical St
London, E1 6BD

www.buildingtrustinternational.org
Tel: +447715283054



Welcome

Who we are

Founder's Thoughts

Activities

Financial

Thanks & Media

*Photo: Varin School, Cambodia 2022
Front cover Kulen Academy, Cambodia 2022

Welcome

The Trustees of Building Trust international are delighted to present our Annual Report for 2021 - 2022.

A second year of the global COVID pandemic was a challenging year but we were extremely pleased to deliver several new projects in our eleventh year as a registered charity. We began work on two further MOVINGschool projects on the Thai/ Burma border. It was fantastic to develop more school projects with the local Burmese construction team who we have been working with since 2012. We also continued our strong relationship with Free the Bears to deliver conservation projects in Asia including a new conservation base camp in Laos.

Our partnership with Kanallan and Indigo Children's Fund continues to grow. Through this collaboration we have been able to design and construct multiple projects including a womens empowerment centre in Nepal which is undergoing construction and learning centres throughout Asia. It is fantastic to deliver more school facilities to children in need around the world.

We also continued our work with non-profit Kulen Outreach to design a new phase for Kulen Academy.

Key Aims:

- Sustainable design
- Humanitarian architecture
- Awareness raising
- Community involvement
- Aid relief
- Vocational training
- Skills Sharing
- Promote natural materials
- Education
- Create a global community
- Positive social impact

We have continued to work closely on the ground with our local partners and through close consultation work with communities at the very start of a project we are able to ensure our clients are part of the design process. Due to COVID, our South East Asian team now mainly work remotely in Phnom Penh, Cambodia which is made up of a strong team of local recent graduates and architects.

Many Thanks,
The Trustees April 2022
(We have complied with the duty in section 4 of the Charities Act 2006 to have due regard to public benefit guidance published by the Commission.)



Who we are

Building Trust International was founded in June 2011 with the core aim to provide design and architectural assistance to existing charities, individuals and communities in need.

An important aim at Building Trust international is to set-up international stations throughout the world led by local volunteers. We connect with individuals and give them the ownership of finding local projects which are in need of design support.

Our stations reach across the globe from Spain and Brazil, the UK to USA. We thank the individual volunteers in these countries who work tirelessly to promote our charitable work to their local communities.

Charity Structure:

A team of international volunteer engineers, designers, architects, accountants, landscape architects and more make up our enthusiastic, hardworking team. Local knowledge is key to finding sustainable local solutions, we hope to continue to build upon these relationships as we grow and deliver more projects. Creating a stronger network of like-minded caring professionals and students that can learn from one another and share resources.

TRUSTEES

Toby Maclean - Founder of Allt
Lorna Bains - Founder, Vilo Consulting
Will Postle --Development Director at Design + Industry
Jude Sellen Cole - Founder of Impact Wellbeing

Founder's Thoughts



David Cole worked on large scale stadia design projects in Russia and the UK before becoming one of the founding members of Building Trust.

"I am so pleased Building Trust has continued to deliver projects through the COVID pandemic. We have grown a strong relationship with Kanallan and due to our established connections with partners on the ground we are able to keep building school projects to remote communities and we also continue to further our conservation work worldwide. It is fantastic to still be working with skilled local workers who we have been working on projects together for over a decade." D Cole, Co-Founder

Our Objectives:

To relieve the charitable needs of communities affected by ill health, poverty, war or other disaster in such ways that the Trustees see fit particularly but not exclusively by the provision of:

I) New responses to ill health, conservation, poverty, war or other disaster through design

II) The establishment of architectural projects

III) Education in construction methods and sustainable design principles

One of the ways in which we have carried out our objectives this year is through the creation of two new schools. With more in the design phase due to be constructed in 2022 and beyond.

We continue to educate in construction methods by working with local communities and talking through how to deliver sustainable design projects.

Many thanks,

A handwritten signature in dark ink, reading 'David Cole'.

Year Successes:

- **1444** new members
- **2** new **schools**
- **3** conservation **builds**
- **3** community **workshops**

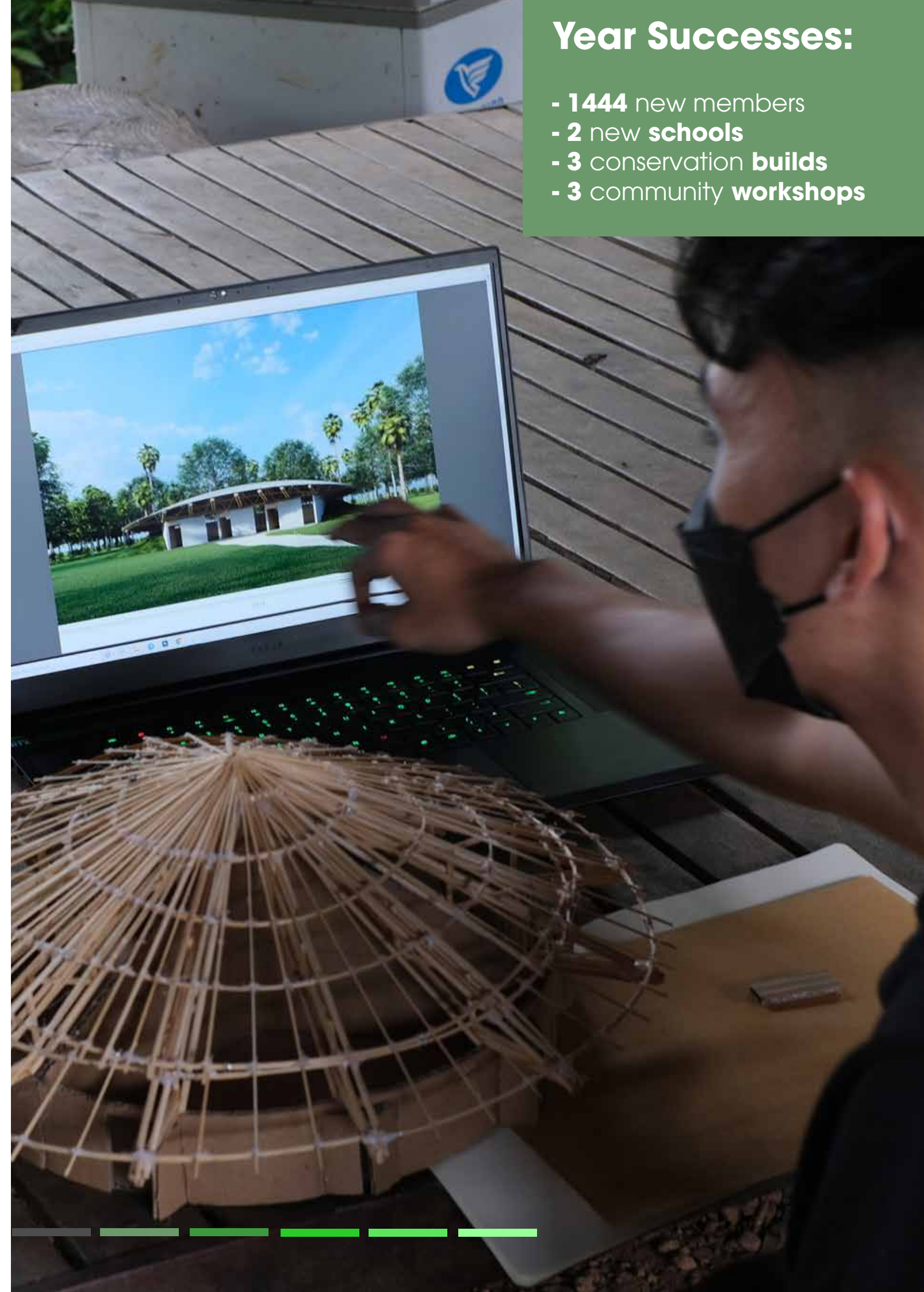

MOVINGschool 006



MOVINGschool 006

A new nursery to replace an unsafe building for children in need on the Thai/Burma border.

By continuing a strong partnership with Kanallan and Ironwood we were able to deliver a new MOVINGschool for a community on the Thai border.

Doubling the size of an existing block and wooden shack. We salvaged the existing walls and plastered them, whilst creating a steel frame to support a larger weather proof roof to make it water tight and stop the rain which always poured through in the past. We have incorporated the play area into the design and created a series of internal spaces which are bright and engaging. The space will support preschool children who will go on to a primary school which was designed and built by Building Trust over a decade ago.

The idea being that the new lightweight frame elements can be taken away off site if the need arises and reconfigured to multiple arrangements to meet any new site constraints.

The school is made up of a mix on Mon, Hmong and Karen ethnic Burmese groups and is supported by the BMWEC (Burmese Migrant Workers Education Committee) with qualified teachers who are working toward the Thai curriculum.



Render of MOVINGschool 006



During construction



Final design



Students walk to the new school building

Location - Mae Sot, Thailand
Project Cost -£22000
Project Partners -Kanallan, Ironwood + BMWEC
Design Team - cole+partners and Ironwood
Project Sponsors - Paul Sweet + Kanallan, Indigo Childrens Fund
Duration - August 2021 to December 2021



MOVINGschool 007



MOVINGschool 007

A brand new colourful school bringing education to over 200 children on the Thai/ Burma border.

The latest MOVINGschool project called Morning School, which will be the largest to date will provide multiple classrooms over two floors to children in need. The groundworks took place in March 2022 with the build due for completion by September 2022.

The MOVINGschool project continues to provide safe learning environments for migrant and refugee communities in Mae Sot Thailand. Through our partnership with Kanallan and Indigo Children's Fund we have been able to raise the funds needed for the construction of this fantastic new school.

Through colourful doorways and bright hallways we will be able to create an inviting school environment. It is great to be working alongside local building team Ironwood again to develop a further MOVINGschool project. Like MOVINGschool 001 the structure is made from steel columns which can be easily taken down if needed and moved to a new site. The building also makes use of wooden facades to offer shading in the classrooms and both local bricks for floor tiling and wood.



Render showing exterior of school



Render showing exterior of school



Local construction team start groundworks



Steel frame takes shape

Location - Mae Sot, Thailand

Project Cost - est. £80,000

Project Partners - Kanallan + Ironwood + BMWEC

Design Team -cole+partners and Ironwood

Project Sponsors - Kanallan, Indigo Children's Fund

Duration - March - Sept 2022



HER Place



HER Place

HER Place women's empowerment centre takes shape in Nepal.

In May 2021, the winners of the "HER PLACE" design challenge were announced as Dikshya Poudyal and Dibyaswor Lamichhane. The design was selected out of proposals from more than 20 countries. The local jury members praised the winning design for its careful sensitivity to local culture, uniqueness and inclusive approach to design.

We are very pleased to update the progression of the HER Place project which is currently on site in Nepal. The centre broke ground in March 2022 and is due to be complete by April 2023.

The creation of the centre will strengthen an existing outreach and mentor program being provided by Kanallan and the local charity Jagriti Child and Youth Concern Nepal.

We are really looking forward to seeing this project completed and being used in 2023 and beyond.

Photos by Kanallan



Design by Dikshya POUDYAL + Dibyaswor LAMICHHANE



Groundworks begin



HER Place begins to take shape



Location - Devachuli, Nepal

Project Cost - est.\$300,000

Project Partners - Kanallan and Jagriti Child and Youth Concern Nepal

Design Team - Dikshya Poudyal & Dibyaswor Lamichhane

Duration - March 2022 - ongoing

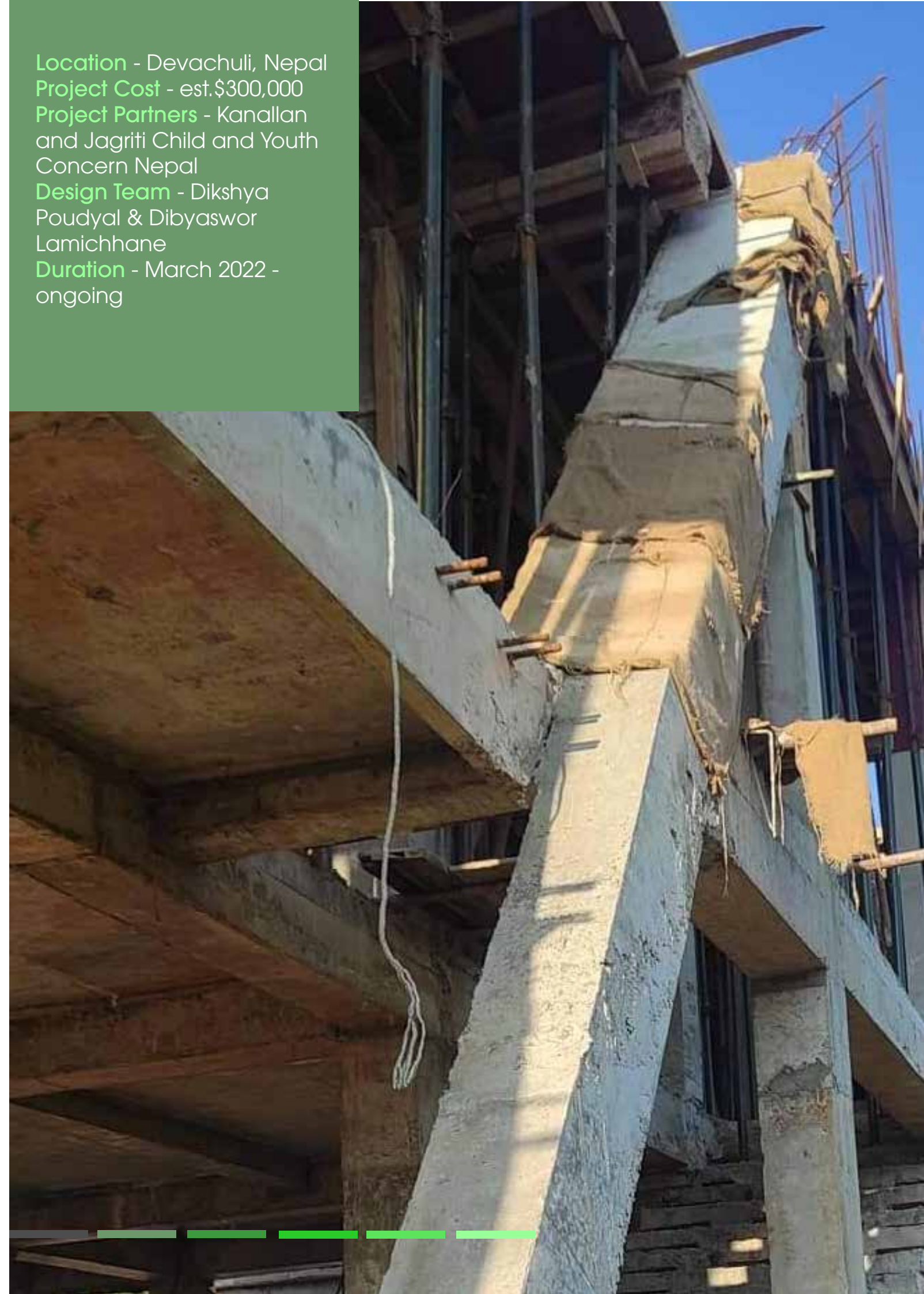

Bear Sanctuary



Quarantine + dens

Helping to bring bear bile farming to an end in Vietnam.

An update on the development of a new sanctuary for bears in Cat Tien National Park in Vietnam. Working alongside Free to Bears, a new facility in Vietnam has been created to provide a life free of cruelty and stress, and full of care and love for rescued sun and moon bears.

Free the Bears established a partnership with Vietnam provincial authorities and the Forestry Protection Department to confiscate bears from bile farms, as well as provide education and awareness on laws and efforts to end bear bile trade and farming.

The new bear sanctuary is made from gabion walls using locally sourced rocks with a prefabricated steel structure.

The design aims to immerse both bears and visitors in the wild surroundings using natural materials and reducing the use of man-made fences.



Use of gabion walls



Bear dens in the forest



Location - Cát Tiên National Park, Vietnam

Project Cost - ongoing

Project Partners - Free the Bears + Forest Protection Department of Vietnam

Design Team - cole+partners

Project Sponsors - FTB Donors

Duration - Ongoing

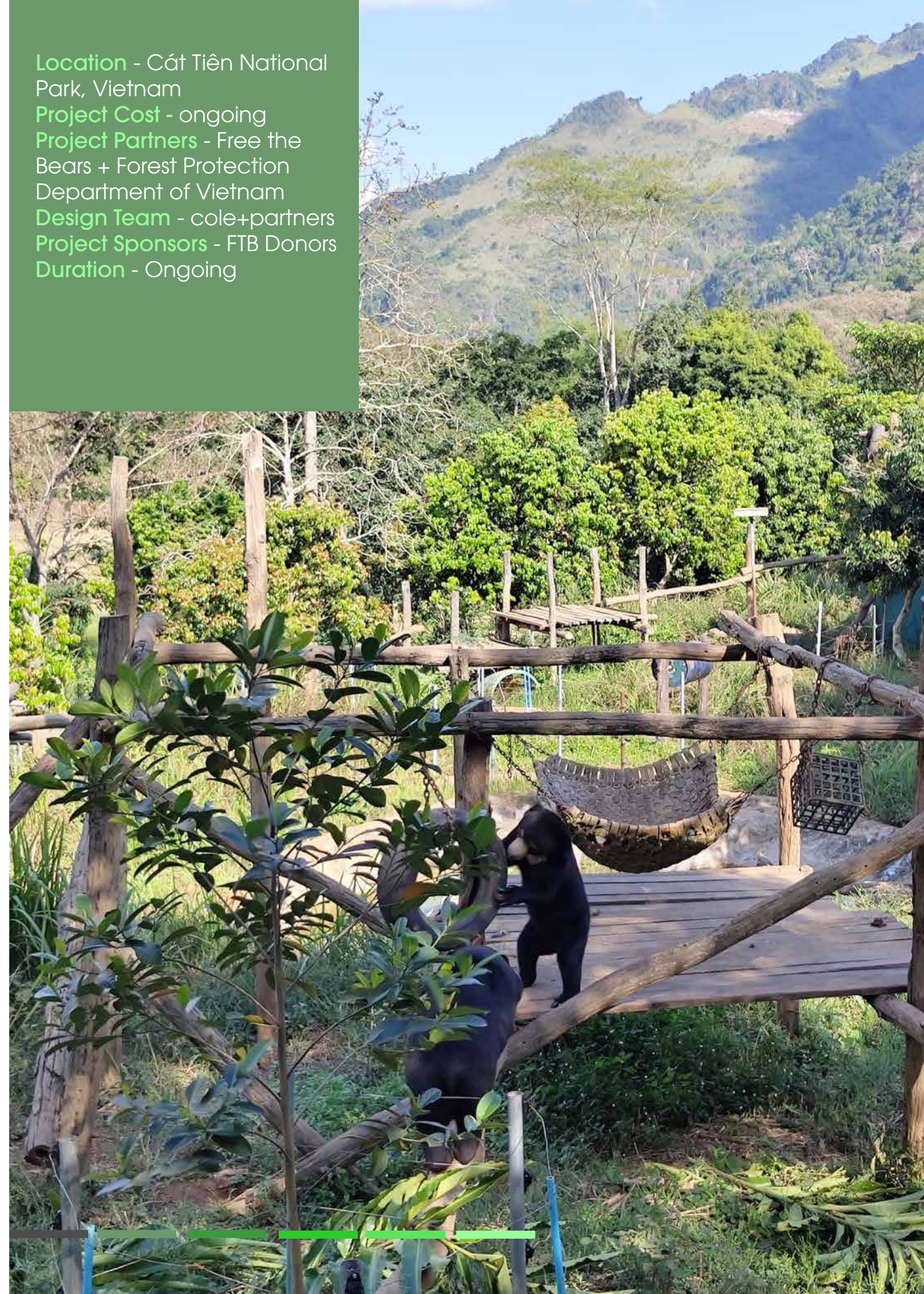

Visitor Education

Free the Bears has helped rescue over 950 bears from the world's most vulnerable bear species (sun bears, moon bears and sloth bears.)

We are very pleased to continue to work with Free the Bears to provide design and building support for the ongoing care of hundreds of rescued bears in Cambodia, Vietnam and Laos.



Bear visitor centre during construction



Gabion wall of visitor centre



External view of visitor centre



Inside of visitor centre



Location - Cát Tiên National Park, Vietnam

Project Cost - Ongoing

Project Partners - Free the Bears + Forest Protection Department of Vietnam

Design Team - cole+partners

Project Sponsors - FTB Donors

Duration - Ongoing

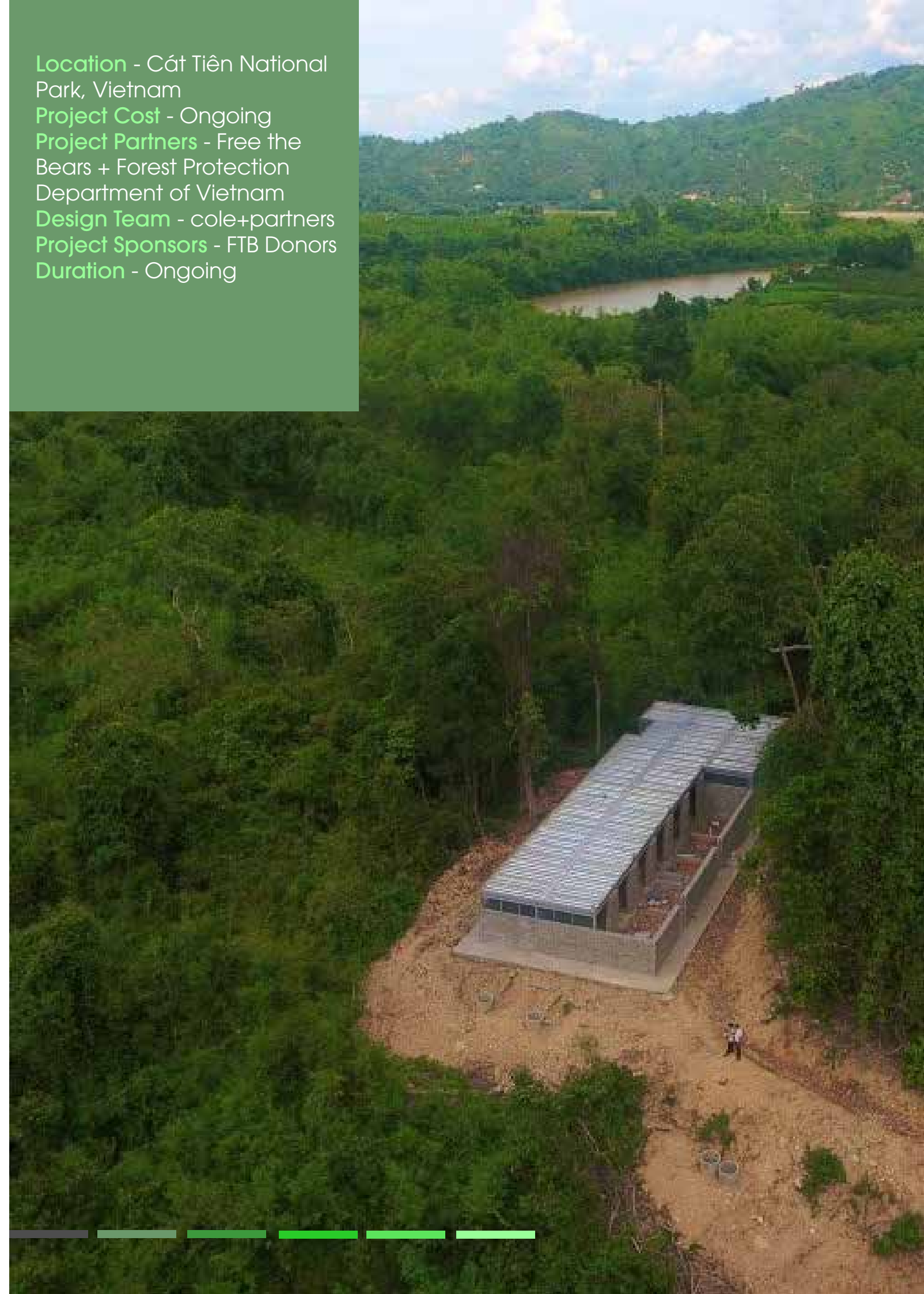

Learning Centres



Raksmeay School

New collaboration between conservation and education NGOs to assist local communities to protect wildlife and build schools.



Existing school interior and below render of design

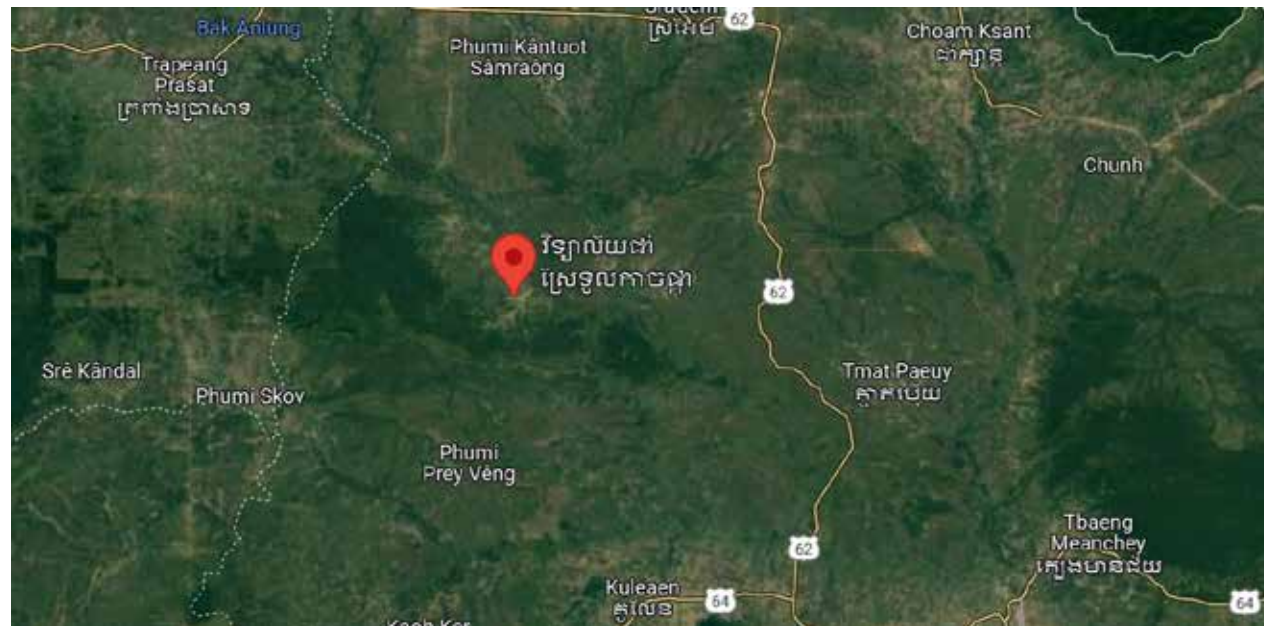

Location - Preah Vihear, Cambodia
Project Cost - tbc
Project Partners - Schools, WCS, Department of Education
Design Team -cole+partners
Project Sponsors -tbc
Duration - Ongoing



Anthil School

During this year, we conducted a series of community workshops at 3 villages; **Raksmeay, Anthil and Okok** to look at the design for new classrooms for rural schools in Cambodia.

The schools all sit within the protected areas of Preah Vihear as shown in map images.



Above: Existing school structure + below render of design

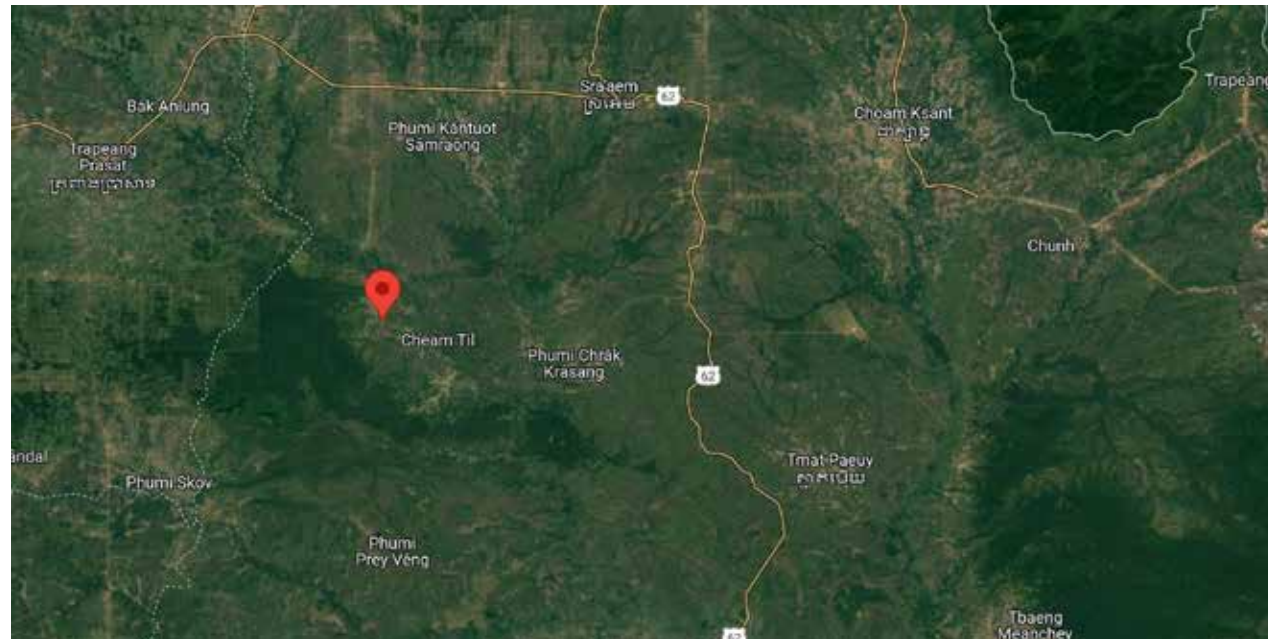

Location - Preah Vihear, Cambodia

Project Cost - tbc

Project Partners - Schools, WCS, Department of Education

Design Team -cole+partners

Project Sponsors -tbc

Duration - Ongoing

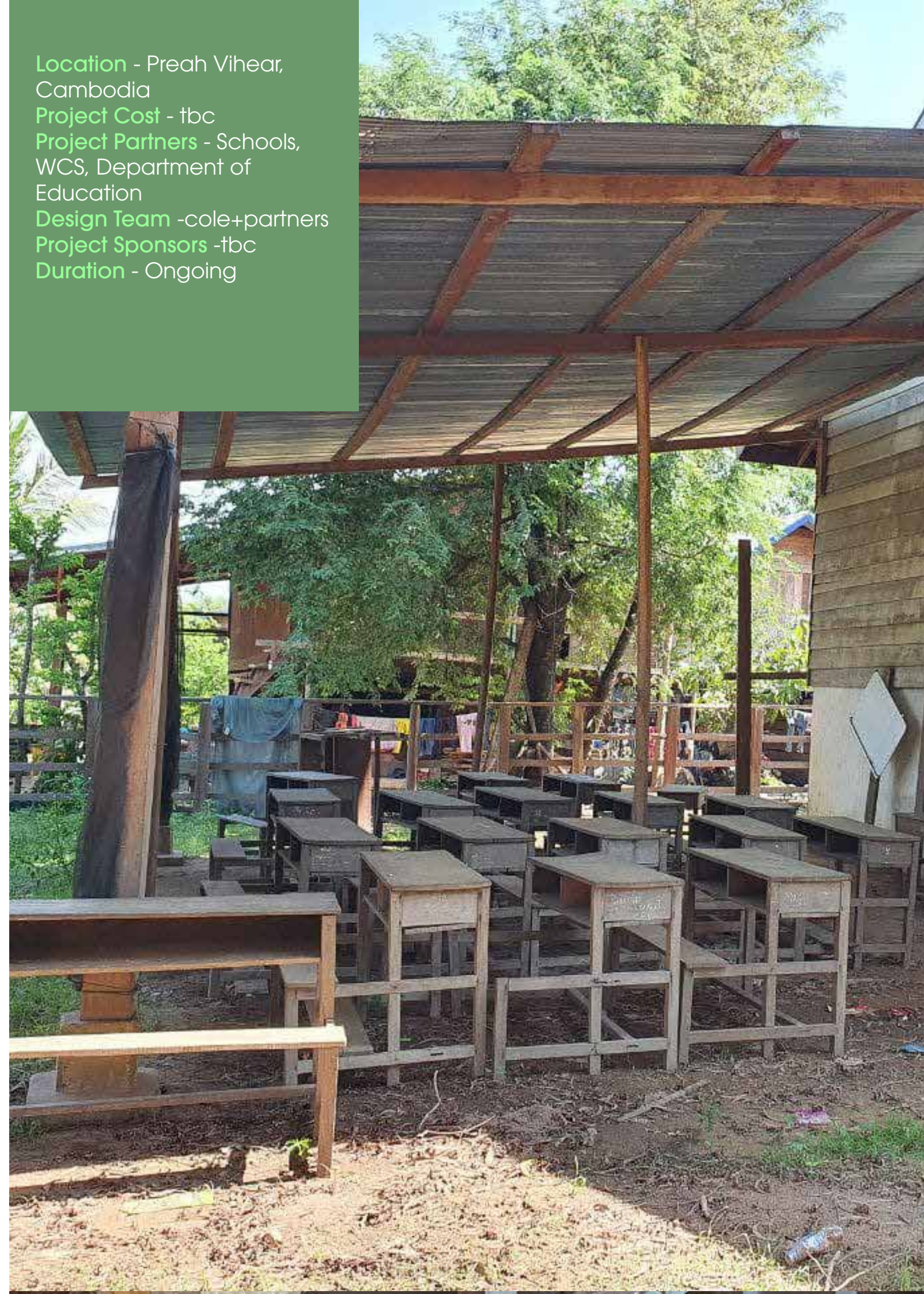

Okok School

The aim was to review existing facilities, look at increasing capacity and find more sustainable methods of construction utilising locally available materials and improving internal comfort for students and teachers.

We are looking forward to bringing these designs to life in 2023 and working with the local community to deliver the projects.



Above: current classroom + below render of design



Location - Preah Vihear, Cambodia

Project Cost - tbc

Project Partners - Schools, WCS, Department of Education

Design Team -cole+partners

Project Sponsors -tbc

Duration - Ongoing



Laos Base Camp



Laos Base Camp

An exciting new conservation project in Laos with Free the Bears.

We are very pleased to help with a conservation education centre in Laos that has been coined the base camp. Situated just outside of Luang Prabang the building sits within the wildlife sanctuary run and managed by Free the Bears.

An organisation who we are lucky to have collaborated with for nearly a decade. The charitable wildlife organisation works to end the exploitation of threatened bear species and supports the protection of bears in the wild. We were asked to design a building to provide a much needed base for visiting professionals to stay and study the wildlife and explore ways to protect the wildlife of Laos and the surrounding area.



Construction of the new Base Camp



Overhanging roof to give shade and protection



Original render



Building in construction

Location - Luang Prabang, Laos
Project Cost - Ongoing
Project Partners - Free the Bears and Laos Department of Forestry
Design Team - cole+partners
Project Sponsors - Free the Bears Sponsors
Duration - October 2021 - ongoing



Kulen Academy Phase II



Kulen Academy Phase II

We continue our collaboration with Kulen Outreach to design phase 2.

Kulen Outreach provides access to quality education to children and youth in rural, Northern Cambodia. Their model works alongside the Cambodian Public School System, helping students at the primary level through job placement.

A large campus and dormitory was built in Siem Reap. The purpose is to house students from the countryside, provide them with English and other supplementary classes while giving them access to the public secondary schools in Siem Reap. Kulen Outreach started with 10 students in 2016. In 2022 we were very pleased to continue the designs of the academy allowing Kulen Outreach to house 100 students. It has now become a small community centre.

We look forward to sharing images of the completed design which will finish construction later in 2022.



Renders of Phase 2



Render of exterior



Render of exterior



Location - Siem Reap, Cambodia
Project Cost - Ongoing
Project Partners - Kulen Outreach
Design Team -cole+partners
Project Sponsors -tbc
Duration - December 2021 to June 2022



FFF Phase II



FFF Phase II

Friends Futures Factory Phase II sees the renovation of a colonial building into a social enterprise market hall and the addition of a 3 story inner city school.

Following the successful development of the Friends Futures Factory. A space that promotes youth social enterprises in Phnom penh. Mith Samlanh got in touch to gain design support for the second phase of the project which sees the expansion of the market space and the creation of additional learning spaces for the existing kids club.

As with phase 1 of the development the project had to be sensitive to the heritage building and neighbouring streetscape. The result is a series of interconnected spaces which give young social entrepreneurs a space to connect with customers and test new products and ideas. Helping to shape the future of Cambodia in a sustainable and progressive way.

The 3 storey extension sees the existing program of classes expanded providing further youth services and educational programs that support the ongoing out reach work and vocational training of Mith Samlanh.



Renders of new phase

Location - Phnom Penh, Cambodia
Project Cost - tbc
Project Partners - Friends int.
Design Team -cole+partners
Project Sponsors - tbc
Duration -Ongoing

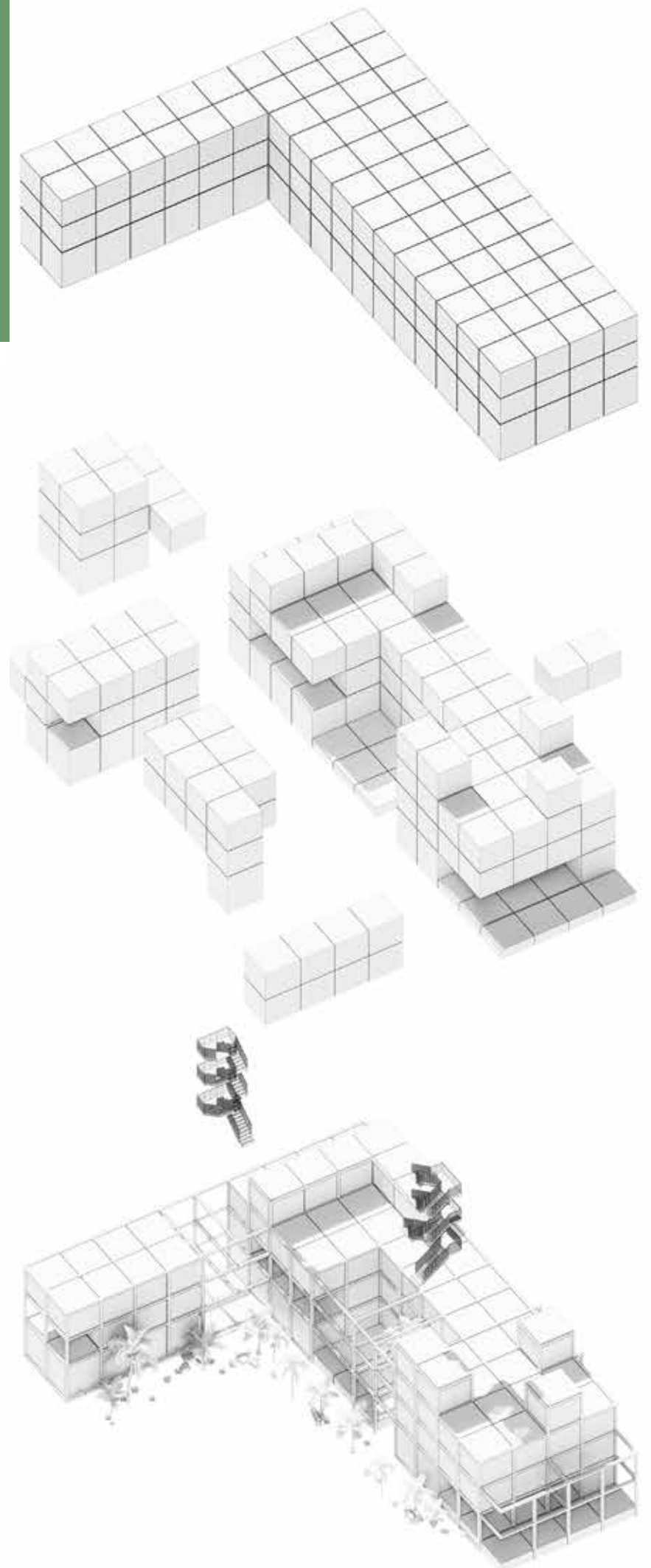

UPDATES

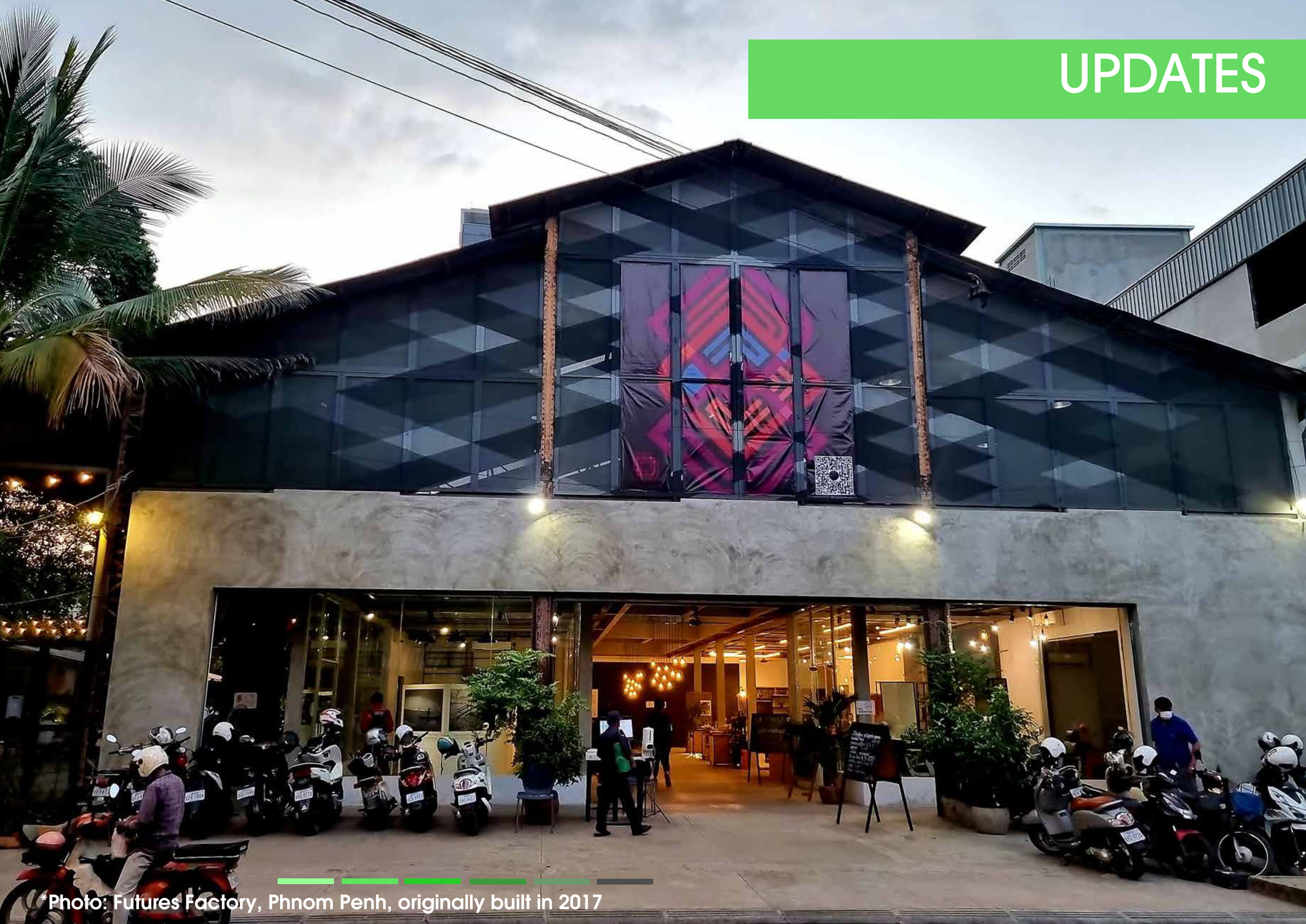

*Photo: Futures Factory, Phnom Penh, originally built in 2017



UPDATES

*Photo: Bravehearts sensory playground, Phnom Penh, originally built in 2017

Updates

A few updates from our projects around the World.

A very important part of Building Trust is to maintain relationships with our projects and ensure they have met their brief. We were pleased to receive photos from our partners and emails advising how well the buildings are working for the various users.

Laos:

In July 2015, Building Trust collaborated with the Wildlife Conservation Society in Laos to create spherical eco-lodges that hang from trees allowing visitors to observe and immerse themselves in the flora and fauna of the Nam Et-Phou Louey Biodiversity Conservation Area in northern Laos. It was great to see an update from the local team who are still using the lodges as part of their eco-tourism work.



Floating pods eco-tourism project upgraded in Laos with WCS



Pupils from Varin school enjoy their classroom

Cambodia:

In January 2020, we began construction of a new learning centre in Cambodia for the deeply underprivileged children of Varin district. It was great to see students enjoying their new school building. It was also great to see Futures Factory and Bravehearts projects in full use in Phnom Penh.

Thailand:

The MOVINGschool project in Thailand continues to grow and we were pleased to see updates from MS6 and we look forward to visiting all the school projects in Dec 2022.



Kulen Academy pupils outside their new school
*Photo to right pupils sit exams at MS6



Members



37 Stations

75+ Countries

83733 Members

Stations

International,
Bangladesh, India
Hong Kong, Spain
Brazil, Greece
Mexico, USA, UK,
Canada, Australia
Colombia, Italia
Cambodia, Japan,
Bosnia & Herzegovina,
Uganda, Nepal, South
Korea, France, Egypt,
Germany, Dubai,
Costa Rica, Chile,
Argentina, Turkey,
Ecuador, Indonesia,
Poland, New Zealand,
Cote d'Ivoire, Kenya,
China, Sierra Leone
and Iran.

Volunteers

Bangladesh, India
Hong Kong, Spain
Brazil, China, South
Africa, Guatemala,
Canada, England,
Australia, Portugal,
Indonesia, France,
Burma, Malaysia, New
Zealand, Chile, Turkey,
Mexico, Ireland,
Poland, Taiwan, Peru,
Ecuador, Pakistan,
Bulgaria, Belgium,
Mozambique,
Cambodia, Greece
Argentina, Sri Lanka,
Colombia, Italy, New
Zealand, South Korea,
Austria, Scotland, USA

We would like to give a special thanks to the key volunteers who have given their free time and dedication to Building Trust over the last year. Many thanks to Emily Holdaway and GT McKillop for pro bono accountancy advice. A special thanks to Matt Hunt, Christopher Schoenbohm, Kanallan, Kulen Outreach, Louise Cole and our local teams for the use of their photography. A huge thanks to Kanallan, Ironwood, Indigo Children's Fund, Kulen Outreach, Free The Bears, cole + partners, Friends International and Allt for their continued support during this year.

Financial

Statement of Financial Activities Year ending 05/04/2022

The accounts follow the Guidance for Small Charities as set out by the Charity Commission. The Annual Report shows the Primary Financial Statement as shown through the SOFA.

The simplified table shown shows the Total Income and Expenditure for 2020 - 2021. Note that £20947 was carried over from the tenth year of accounts. Building Trust have no Tangible assets and no debts.

99.62% of funds were generated through voluntary income. This year a large portion of funding came through our charity partner Kanallan, a philanthropic consultancy that works with charities to facilitate independent humanitarian projects in developing countries and Indigo Children's Fund. These funds were used to design and construct three new schools on the Thai/Burma border.

This year no funding was raised through activities for generating funds. However, funds were raised through income resources from charitable activities due to the Her Place design competition.

Sadly we were unable to host any design and build workshops due to the ongoing COVID pandemic making travelling too difficult.

Operating Revenue 2021 - 22

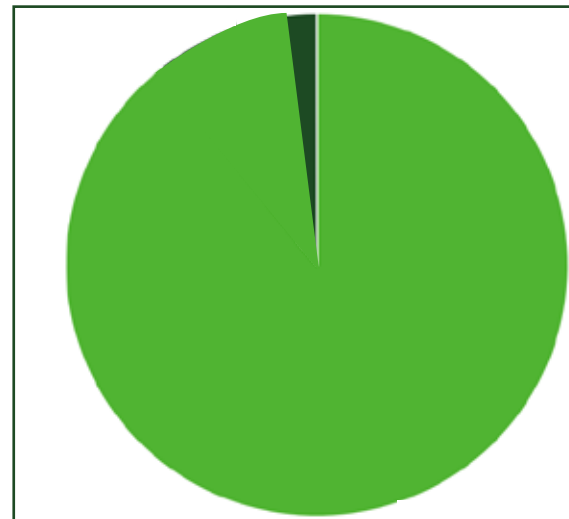

99.62% Voluntary Income

0.38% Charitable Activities

As a small charity we are yet to develop a Reserves Policy, this will be discussed at our next AGM. Please note we work on a project by project basis, our current funds (reserves) to be carried over to 2022 to 2023 are £9762. A percentage of this will be spent on developing new learning centres in Asia.

We also hope to re-introduce our Membership program to generate funds in 2022 and beyond.

We thank Mr GT McKillop and Mrs Emily Holdaway for their continued pro-bono accountancy support.



Charity Name Building Trust international			Charity No (if any)	1142338	CC17a
Annual accounts for the period					
Period start date	6/4/2021	To	Period end date	5/4/2022	

Section A Statement of financial activities

Recommended categories by activity	Details of own analysis	Note	Unrestricted funds £	Restricted income funds £	Endowment funds £	Total this year £	Total last year £
			F01	F02	F03	F04	F05
Incoming resources (Note 3)							
Incoming resources from generated funds							
Voluntary income		S01	8,708	73,200		81,908	1,000
Activities for generating funds		S02					
Investment income		S03					
Incoming resources from charitable activities		S04	310			310	44,788
Other incoming resources		S05					
Total incoming resources		S06	9,018	73,200		82,218	45,788
Resources expended (Notes 4-8)							
Costs of Generating Funds							
Costs of generating voluntary income		S07	10			10	70
Fundraising trading costs		S08					
Investment management costs		S09					
Charitable activities		S10	25,360	68,033		93,393	37,802
Governance costs		S11					
Other resources expended		S12					
Total resources expended		S13	25,370	68,033		93,403	37,872
Net incoming/(outgoing) resources before transfers		S14	- 16,352	5,167		- 11,185	7,916
Gross transfers between funds		S15					
Net incoming/(outgoing) resources before other recognised gains/(losses)		S16	- 16,352	5,167		- 11,185	7,916
Other recognised gains/(losses)							
Gains and losses on revaluation of fixed assets for the charity's own use		S17					
Gains and losses on investment assets		S18					
Net movement in funds		S19	- 16,352	5,167		- 11,185	7,916
Total funds brought forward		S20	16,428	4,519		20,947	13,031
Total funds carried forward		S21	76	9,686		9,762	20,947

Donors & Partners

We are so thankful to all our donors who contributed to our many projects this year:

Partners:

Kanallan, Indigo Children's Fund, cole + partners, Free The Bears, Ironwood, AIt, Kulen Outreach, Jagriti Child and Youth Concern Nepal, B.M.W.E.C, Laos Department of Forest, Forest Protection Department of Vietnam, Friends Futures Factory, Friends International, World Education and more.

A huge thanks to everyone who has supported Building Trust international projects around the world during this year.



Thanks

We are so thankful to all our incredible volunteer team who offer their time and skills to our station network around the world. We couldn't do it without you!



Thanks

We are so thankful to all our incredible volunteer team who offer their time and skills to our station network around the world. We couldn't do it without you!



Media & Press

In our eleventh year as a registered charity we received some fantastic press coverage including the Her Place competition results being featured online.

We would like to thank the journalists and editors for their continued support promoting our projects.

ArchitectureinDevelopment, Bustler, Archnewsnow, Archinect, Architecturelab, ArchitectureWeek, Architecture World News, BDonline, Catalogo Diseno, Competitions.org, Competitionline, Designboom, De5ign, E-architect, Inhabitat, Landscape Architects Network, Impact Design Hub, World Architecture News

If you would be interested in promoting one of our projects please get in touch info@buildingtrustinternational.org

Her Place – Building Trust International 2021 Design Challenge



*Photo: Kulen Academy, Cambodia 2022

About

Building Trust International is a non profit organisation offering design assistance to communities and individuals in need. Building Trust International assesses areas in need, finds sustainable, economical aid solutions and ultimately provides buildings and infrastructure.

These core actions have blossomed into advocating and educating on the principles of socially aware design, providing an accessible resource on humanitarian design projects and providing a structure for the crossover of information between design professionals.

Building Trust International is a charity registered in England and Wales (1142338).

Staff:
Founder - David Cole
Founder - Louise Cole

Consulting Partners:
Allt

Media Inquiries
Please contact:
info@buildingtrustinternational.org

Speaking engagements:
Building Trust international's designers welcome the opportunity to share our work. For more information please contact Louise Cole at louise@buildingtrustinternational.org

Contact Information
Building Trust international
T. +447715283054
For more information please visit:
www.buildingtrustinternational.org
Detailed information about each of our projects is shared on our Facebook group
www.facebook.com/BuildingTrustInternational
© 2010-2022 Building Trust international
All rights reserved.

Building Trust international makes every effort to ensure accuracy in donor and volunteer listings, but on occasion errors may occur. Please contact us at +447715283054 with any questions or comments.



*Photo: Kulen Academy, Cambodia 2022

Building Trust international is a registered charity in England & Wales 1142338

Building Trust international
International House
45-55 Commerical St
London, E1 6BD

www.buildingtrustinternational.org
Tel: +447715283054
© 2022 Building Trust International



Charity Name Building Trust international			Charity No (if any)	1142338	CC17a
Annual accounts for the period					
Period start date	6/4/2021	To	Period end date	5/4/2022	

Section A Statement of financial activities

Recommended categories by activity	Details of own analysis	Note	Unrestricted funds £	Restricted income funds £	Endowment funds £	Total this year £	Total last year £
			F01	F02	F03	F04	F05
Incoming resources (Note 3)							
Incoming resources from generated funds							
Voluntary income		S01	8,708	73,200		81,908	1,000
Activities for generating funds		S02					
Investment income		S03					
Incoming resources from charitable activities		S04	310			310	44,788
Other incoming resources		S05					
Total incoming resources		S06	9,018	73,200		82,218	45,788
Resources expended (Notes 4-8)							
Costs of Generating Funds							
Costs of generating voluntary income		S07	10			10	70
Fundraising trading costs		S08					
Investment management costs		S09					
Charitable activities		S10	25,360	68,033		93,393	37,802
Governance costs		S11					
Other resources expended		S12					
Total resources expended		S13	25,370	68,033		93,403	37,872
Net incoming/(outgoing) resources before transfers		S14	- 16,352	5,167		- 11,185	7,916
Gross transfers between funds		S15					
Net incoming/(outgoing) resources before other recognised gains/(losses)		S16	- 16,352	5,167		- 11,185	7,916
Other recognised gains/(losses)							
Gains and losses on revaluation of fixed assets for the charity's own use		S17					
Gains and losses on investment assets		S18					
Net movement in funds		S19	- 16,352	5,167		- 11,185	7,916
Total funds brought forward		S20	16,428	4,519		20,947	13,031
Total funds carried forward		S21	76	9,686		9,762	20,947

Section B Balance sheet

	Note	Unrestricted funds £	Restricted income funds £	Endowment funds £	Total this year £	Total last year £
		F01	F02	F03	F04	F05
Fixed assets						
Tangible assets						
(Note 9)	B01	-	-	-	-	-
	B02	-	-	-	-	-
Investments						
(Note 10)	B03	-	-	-	-	-
Total fixed assets	B04	-	-	-	-	-
Current assets						
Stock and work in progress	B05	-	-	-	-	-
Debtors	B06	-	-	-	-	-
(Short term) investments	B07	-	-	-	-	-
Cash at bank and in hand	B08	-	-	-	-	-
Total current assets	B09	-	-	-	-	-
Creditors: amounts falling due within one year						
(Note 12)	B10	-	-	-	-	-
Net current assets/ (liabilities)	B11	-	-	-	-	-
Total assets less current liabilities	B12	-	-	-	-	-
Creditors: amounts falling due after one year						
(Note 12)	B13	-	-	-	-	-
Provisions for liabilities and charges	B14	-	-	-	-	-
Net assets	B15	-	-	-	-	-
Funds of the Charity						
Unrestricted funds	B16	-	-	-	-	-
	B17	-	-	-	-	-
Restricted income funds						
(Note 13)	B18	-	-	-	-	-
Endowment funds (Note 13)	B19	-	-	-	-	-
Total funds	B20	-	-	-	-	-

Signed by one or two trustees
on behalf of all the trustees

Signature	Print Name	Date of approval
	JUDE SELLEN COLE	25/11/2022

Cells highlighted in Yellow contain formulas to add up columns C,D and E but these are not protected cells

Cells highlighted in Blue contain formulas in protected cells. The protection can be removed from the tools menu

Note 1 **Basis of preparation**

This section should be completed by all charities.

1.1 Basis of accounting

These accounts have been prepared on the basis of historic cost (except that investments are shown at market value) in accordance with:

- Accounting and Reporting by Charities – Statement of Recommended Practice (SORP 2005);
- and with*

ü

 Accounting Standards;
- or

 Financial Reporting Standards for Smaller Enterprises (FRSSE);
- and with the Charities Act.

[** except for the following].

Give details in this box if a different standard has been followed.

* -Tick as appropriate:

· if all relevant disclosures shown in the pack have been given then please tick "Accounting Standards";

· if disclosures completed in these accounts have been restricted to those required by the FRSSE, then please tick "Financial Reporting Standards for Smaller Enterprises (FRSSE)".

** - If no departures from the chosen standards have been made then delete these words; otherwise give details of any changes in the boxes.

1.2 Change in basis of accounting

There has been no change to the accounting policies (valuation rules and methods of accounting) since last year (§ except for the following).

Give details in this box of any material changes that have been made.

§ if no changes have been made to accounting policies then delete these words.

1.3 Changes to previous accounts

No changes have been made to accounts for previous years (§§ except for the following).

Give details in this box of any material changes that have been made.

§§ if no changes have been made to accounts for previous periods then delete these words.

Note 2 Accounting policies

This standard list of accounting policies has been applied by the charity except for those deleted. Where a different or additional policy has been adopted then this is detailed in the box below.

INCOMING RESOURCES

Recognition of incoming resources	These are included in the Statement of Financial Activities (SoFA) when: <ul style="list-style-type: none"> · the charity becomes entitled to the resources; · the trustees are virtually certain they will receive the resources; and · the monetary value can be measured with sufficient reliability.
Incoming resources with related expenditure	Where incoming resources have related expenditure (as with fundraising or contract income) the incoming resources and related expenditure are reported gross in the SoFA.
Grants and donations	Grants and donations are only included in the SoFA when the charity has unconditional entitlement to the resources.
Tax reclaims on donations and gifts	Incoming resources from tax reclaims are included in the SoFA at the same time as the gift to which they relate.
Contractual income and performance related grants	This is only included in the SoFA once the related goods or services have been delivered.
Gifts in kind	Gifts in kind are accounted for at a reasonable estimate of their value to the charity or the amount actually realised. Gifts in kind for sale or distribution are included in the accounts as gifts only when sold or distributed by the charity. Gifts in kind for use by the charity are included in the SoFA as incoming resources when receivable.
Donated services and facilities	These are only included in incoming resources (with an equivalent amount in resources expended) where the benefit to the charity is reasonably quantifiable, measurable and material. The value placed on these resources is the estimated value to the charity of the service or facility received.
Volunteer help	The value of any voluntary help received is not included in the accounts but is described in the trustees' annual report.
Investment income	This is included in the accounts when receivable.
Investment gains and losses	This includes any gain or loss on the sale of investments and any gain or loss resulting from revaluing investments to market value at the end of the year.

EXPENDITURE AND LIABILITIES

Liability recognition	Liabilities are recognised as soon as there is a legal or constructive obligation committing the charity to pay out resources.
Governance costs	Include costs of the preparation and examination of statutory accounts, the costs of trustee meetings and cost of any legal advice to trustees on governance or constitutional matters.
Grants with performance conditions	Where the charity gives a grant with conditions for its payment being a specific level of service or output to be provided, such grants are only recognised in the SoFA once the recipient of the grant has provided the specified service or output.
Grants payable without performance conditions	These are only recognised in the accounts when a commitment has been made and there are no conditions to be met relating to the grant which remain in the control of the charity.
Support Costs	Support costs include central functions and have been allocated to activity cost categories on a basis consistent with the use of resources, eg allocating property costs by floor areas, or per capita, staff costs by the time spent and other costs by their usage.

ASSETS

Tangible fixed assets for use by charity	These are capitalised if they can be used for more than one year, and cost at least £500. They are valued at cost or a reasonable value on receipt.
Investments	Investments quoted on a recognised stock exchange are valued at market value at the year end. Other investment assets are included at trustees' best estimate of market value.
Stocks and work in progress	These are valued at the lower of cost or market value.

**POLICIES ADOPTED
ADDITIONAL TO OR
DIFFERENT FROM
THOSE ABOVE**

Note 3 Analysis of incoming resources

Incoming resources may be further analysed if this would help the reader of the accounts.

	Analysis	This year £	Last year £
Voluntary income	Public Donations (unrestricted)	8,457	1,000
	Gift Aid	251	
	MOVINGSCHOOLS 005 (res)	7,500	
	Kanallan/ICF MS6 (res)	16,500	
	Kanallan/ICF MS7 (res)	49,200	
	Total	81,908	1,000
Activities for generating funds			
	Total		
Investment income			
	Total		
Incoming resources from charitable activities	Herplace Design Competition	310	2,841
	Varin Cambodia school (res)		25,673
	MOVINGSCHOOLS 005 (res)		7,500
	FTB Vietnam/Asia (res)		8,774
	Total	310	44,788

Note 4 Analysis of resources expended

Resources expended may be further analysed if this would help the reader of the accounts.

	Analysis	This year £	Last year £
Costs of generating voluntary income	Bank incoming charges	10	70
	Web Domain		
	Total	10	70
Fundraising trading costs			
	Total		
Investment management costs			
	Total		
Charitable activities			
	Herplace Design Competition	3,324	35
	Varin Cambodia school (res)		25,673
	MOVINGSCHOOLS 005 (res)	7,500	8,080
	MOVINGSCHOOLS 005 (unres)	7,524	
	Cambodia Learning Centres	3,324	
	FTB Asia (res)	4,519	4,014
	FTB Asia (unres)	241	
	Kulen Academy Phase 2	5,448	
	Kanallan/ICF MS6 (res)	16,500	
	Kanallan/ICF MS6 (unres)	5,500	
	Kanallan/ICF MS7 (res)	39,514	
	Total	93,393	37,802
Governance costs			-
		-	-
		-	-
	Total	-	-
Other resources expended			
	Total		

Note 5 Support Costs

Please complete this note if the charity has analysed its expenses using activity categories and has support costs.

Support cost type	Fundraising activity £	Charitable Activity £	Governance Activity £	Total Cost £
	-	-	-	-
	-	-	-	-
	-	-	-	-
	-	-	-	-
	-	-	-	-
	-	-	-	-
	-	-	-	-
Total	-	-	-	-

Note 6 Details of certain items of expenditure**6.1 Trustee expenses**

Please provide details of the amount of any payment or reimbursement of out-of-pocket expenses made to trustees or to third parties for expenses incurred by trustees. If no expenses were paid, please enter 'None' in the appropriate box(es).

Number of trustees who were paid expenses

Nature of the expenses

Total amount paid

This year	Last year
£	£

6.2 Fees for examination or audit of the accounts

Please provide details of the amount paid for any statutory external scrutiny of accounts and other services provided by your independent examiner or auditor. If nothing was paid please enter NONE in the appropriate box(es).

Independent examiner's or auditors' fees for reporting on the accounts

Other fees (for example: advice, consultancy, accountancy services) paid to the independent examiner or auditor

This year £	Last year £

Note 7

Paid employees

Please complete this note if the charity has any employees.

7.1 Staff Costs

	This year £	Last year £
Gross wages, salaries and benefits in kind	35,000	4,564
Employer's National Insurance costs	3,610	-
Pension costs	-	-
Total staff costs	38,610	4,564

7.2 Average number of full-time equivalent employees in the year

The parts of the charity in which the employees work

	This year Number	Last year Number
Fundraising	-	-
Charitable Activities	-	1
Governance	-	-
Other	-	-
Total	-	1

7.3 Defined contribution pension scheme

Please complete if a defined contribution pension scheme is operated.

Brief details of the scheme

--

	This year £	Last year £
The costs of the scheme to the charity for the year		
The amount of any contributions outstanding at the year end		
The amount of any contributions prepaid at the year end		

Note 8

Grantmaking

Please complete this note if the charity made any grants or donations which in aggregate form a material part of the charitable activities undertaken.

8.1 Total value of grants

Purpose for which grants made	Grants to institutions Total amount £	Grants to individuals Total amount £
	-	-
	-	-
	-	-
	-	-
	-	-
	-	-
Total	-	-

8.1 Grantmaking costs

If the charity's accounts are prepared on the "activity basis" please give details of any support cost associated with grantmaking. Please enter "Nil" if the charity does not identify and/or allocate support costs.

Support costs of grantmaking

£

8.3 Grants made to institutions

If the charity has made grants to particular institutions that are material in the context of its grantmaking please give details of the institution supported, purpose of the grant and total paid to each institution listed. Sufficient information should be given to provide a reasonable understanding of the range of institutions supported.

Range of institutions supported.		
Names of institutions	Purpose	Total amount of grants paid £
		-
		-
		-
		-
		-
		-
		-
		-
		-
		-
		-
Total grants to institutions		-

Note 9 Tangible fixed assets*Please complete this note if the charity has any tangible fixed assets***9.1 Cost or valuation**

	Freehold land & buildings	Other land & buildings	Plant, machinery and motor vehicles	Fixtures, fittings and equipment	Payments on account and assets under construction	Total
	£	£	£	£	£	£
Balance brought forward	-	-	-	-	-	-
Additions	-	-	-	-	-	-
Revaluations	-	-	-	-	-	-
Disposals	-	-	-	-	-	-
Transfers *	-	-	-	-	-	-
Balance carried forward	-	-	-	-	-	-

9.2 Accumulated depreciation and impairment provisions

**Basis	SL or RB	SL or RB	SL or RB	SL or RB	SL or RB
** Rate					

Balance brought forward	-	-	-	-	-	-
Depreciation charge for year	-	-	-	-	-	-
Impairment provisions	-	-	-	-	-	-
Revaluations	-	-	-	-	-	-
Disposals	-	-	-	-	-	-
Transfers*	-	-	-	-	-	-
Balance carried forward	-	-	-	-	-	-

9.3 Net book value

Brought forward	-	-	-	-	-	-
Carried forward	-	-	-	-	-	-

9.4 Revaluation*If any fixed assets have been revalued please give details of the valuer and method of valuation*

--

* The "transfers" row is for movements between fixed asset categories.

** Please indicate the method of depreciation by deleting the method not applicable (SL = straight line; RB = reducing balance). Also please indicate the rate of depreciation: for straight line, what is the anticipated life of the asset (in years); for reducing balance, what is the percentage annual deduction.

Note 10 Investment assets

Please complete this note if the charity has any investment assets.

10.1 Fixed assets investments

	£
Carrying (market) value at beginning of year	-
Add: additions to investments at cost	-
Less: disposals at carrying value	-
Add/(deduct): net gain/(loss) on revaluation	-
Carrying (market) value at end of year	-

Please provide below:

10.2 A breakdown of the market values of investments shown above agreeing with the balance sheet row B03.

10.3 A breakdown of the income from investments agreeing with SOFA row S03.

Analysis of investments

	10.2 Market value at year end	10.3 Income from investments for the year
	£	£
Investment properties	-	-
Investments listed on a recognised stock exchange or held in common investment funds, open ended investment companies, unit trusts or other collective investment schemes	-	-
Investments in subsidiary or connected undertakings and companies	-	-
Securities not listed on a recognised Stock Exchange	-	-
Cash held as part of the investment portfolio	-	-
Other investments	-	-
Total	-	-

10.4 Material investment holdings

If any single investment is material in terms of its value (for example represents more than 5 per cent of the value of the charity's total investments) please provide details.

Investment held	
Market Value	

Note 11 Debtors and prepayments

Please complete this note if the charity has any debtors or prepayments.

Analysis of debtors

	Amounts falling due within one year		Amounts falling due after more than one year	
	This year £	Last year £	This year £	Last year £
Trade debtors	-	-	-	-
Amounts due from subsidiary and associated undertakings	-	-	-	-
Other debtors	-	-	-	-
Prepayments and accrued income	-	-	-	-
Total	-	-	-	-

Note 12 Creditors and accruals

Please complete this note if the charity has any creditors or accruals.

12.1 Analysis of creditors

	Amounts falling due within one year		Amounts falling due after more than one year	
	This year £	Last year £	This year £	Last year £
Loans and overdrafts	-	-	-	-
Trade creditors	-	-	-	-
Amounts due to subsidiary and associated undertakings	-	-	-	-
Other creditors	-	-	-	-
Accruals and deferred income	-	-	-	-
Total	-	-	-	-

12.2 Security over assets

If any loan, overdraft or other creditor holds a charge or other security over any assets of the charity please provide details.

--

Note 13

Please complete this section if the charity has any endowment or restricted income funds.

13.1 Funds held

Please give a brief description of any of the following type of funds held by the charity:

- permanent endowment funds (PE);
- expendable endowment funds (EE); and
- restricted income funds, including special trusts, of the charity (R).

[illegible]

13.2 Movements of major funds

Please give details of the movements of the major funds summarised in the restricted and endowment columns of the Statement of Financial Activities.

	Fund balances brought forward	Incoming resources	Outgoing resources	Transfers	Gains and losses	Fund balances carried forward
Fund names	£	£	£	£	£	£
	-	-	-	-	-	-
	-	-	-	-	-	-
	-	-	-	-	-	-
	-	-	-	-	-	-
	-	-	-	-	-	-
	-	-	-	-	-	-
	-	-	-	-	-	-
Total Funds	-	-	-	-	-	-

13.3 Transfers between funds

Please give details of any transfers between funds.

From Fund (Name)	To Fund (Name)	Reason	Amount

Note 14 Transactions with related parties

If the charity has any transactions with related parties (other than the trustee expenses explained in note 6) details of such transactions should be provided in this note. If there are no transactions to report, please enter "None" in the relevant boxes.

14.1 Remuneration and benefits

Please give the amount of, and legal authority for, any remuneration or other benefits paid to a trustee or other related parties by the charity or any institution or company connected with it.

Name of trustee or connected party	Legal authority (eg order, governing document)	Amounts paid or benefit value	
		This year £	Last year £

14.2 Loans

Please give details of and amounts owing to or from the charity's trustees or other related parties by the charity at the year end.

	Name of trustee or connected party	Legal authority	Amount owing	
			This year £	Last year £
Due to trustees and related parties				
Due from trustees and related parties				

14.3 Other transaction(s) with trustees or related parties

Please give details of any transaction undertaken by (or on behalf of) the charity in which a trustee or related party has a material interest.

Name of the trustee or related party	Relationship to charity	Description of the transaction(s)	This year £	Last year £

Section C	Notes to the accounts	(cont)
Note 15	Additional Disclosures	<p>The following are significant matters which are not covered in other notes and need to be included to provide a proper understanding of the accounts. If there is insufficient room here, please add a separate sheet.</p>



Independent examiner's report on the accounts

Section A

Independent Examiner's Report

Report to the trustees/
members of

Building Trust International

On accounts for the year
ended

05/04/2022

Charity no
(if any) 1142338

Set out on pages

1 - 2

I report to the trustees on my examination of the accounts of the above charity ("the Trust") for the year ended 05/04/2022.

Responsibilities and
basis of report

As the charity's trustees, you are responsible for the preparation of the accounts in accordance with the requirements of the Charities Act 2011 ("the Act").

I report in respect of my examination of the Trust's accounts carried out under section 145 of the 2011 Act and in carrying out my examination, I have followed all the applicable Directions given by the Charity Commission under section 145(5)(b) of the Act.

Independent
examiner's statement

~~The charity's gross income exceeded £250,000 and I am qualified to undertake the examination by being a qualified member of [insert name of applicable listed body].~~
~~Delete {} if not applicable.~~ **THE CHARTERED INSTITUTE OF MANAGEMENT ACCOUNTANTS**

I have completed my examination. I confirm that no material matters have come to my attention in connection with the examination (other than that disclosed below *) which gives me cause to believe that in, any material respect:

- the accounting records were not kept in accordance with section 130 of the Charities Act; or
- the accounts did not accord with the accounting records; or
- the accounts did not comply with the applicable requirements concerning the form and content of accounts set out in the Charities (Accounts and Reports) Regulations 2008 other than any requirement that the accounts give a 'true and fair' view which is not a matter considered as part of an independent examination.

I have no concerns and have come across no other matters in connection with the examination to which attention should be drawn in this report in order to enable a proper understanding of the accounts to be reached.

* ~~Please delete the words in the brackets if they do not apply.~~

Signed:

Date:

11 JAN 2023

Name:

EMILY ANNETTE HOLDAWAY

Relevant professional
qualification(s) or body
(if any):

MEMBER OF THE CHARTERED INSTITUTE
OF MANAGEMENT ACCOUNTANTS

Address:

7 STEPHEN STREET
REDFIELD
BRISTOL BS5 9DY

Section B

Disclosure

Only complete if the examiner needs to highlight material matters of concern
(see CC32, Independent examination of charity accounts: directions and
guidance for examiners).

Give here brief details
of any items that the
examiner wishes to
disclose.

