

NORTON HALL CHILDREN AND FAMILY CENTRE

England & Wales · Charity number 1112752

Details

Other names NHCFC

Status Registered

Legal form Charitable company

Company number [05052641](#)

Registered 2006-01-18

Register [View on the Charity Commission register](#)

Contact

Address Norton Hall Children & Family Centr
Norton Hall
Ralph Road
Saltley
Birmingham
B8 1NA

Phone 01213283043

Email info@nortonhall.org.uk

Website www.nortonhall.org.uk

Activities

Objects: 1. TO RELIEVE POVERTY AND ADVANCE HEALTH AND EDUCATION IN THE CITY OF BIRMINGHAM, AND IN PARTICULAR TO ADDRESS THE NEEDS OF DISADVANTAGED WOMEN, CHILDREN AND YOUNG PEOPLE IN THE HODGE HILL, LADYWOOD AND SMALL HEATH CONSTITUENCIES, BY (WITHOUT EXCLUDING THE GENERALITY OF THE FOREGOING);A) PROVIDING A COMMUNITY NURSERY AND PROVISION FOR OUT OF SCHOOL CHILDCARE, AND GENERALLY PROMOTING THE DEVELOPMENT OF CHILDCARE PROVISION AIMED AT MEETING THE NEEDS OF LOW INCOME FAMILIES;B) RUNNING HOLIDAY PLAYSCHMES AND OTHER CHILDRENS PLAY PROVISION;C) DEVELOPING SUPPORT AND PROVISION FOR YOUNG PEOPLE, INCLUDING YOUTH WORK WITH GIRLS AND YOUNG WOMEN;D) PROVIDING OPPORTUNITIES FOR EDUCATION, TRAINING AND PERSONAL DEVELOPMENT;E) PROVIDING SUPPORT FOR THE ECONOMIC ADVANCEMENT OF WOMEN, INCLUDING SUPPORTING WOMEN INTO EMPLOYMENT AND ENTERPRISE;F) PROVIDING SUCH FURTHER FACILITIES AS MAY BE BENEFICIAL FOR THE WIDER COMMUNITY IN THE AREA OF BENEFIT

Activities: Working towards a community where children and young people are able to fulfill their potential and parents & guardians are equipped to support their families. The charity manages a variety of projects including Community Nursery, Out of School & Holiday Care Project, Positive Activities for Young People, support services for local women, & a range of evening/weekend sports & community facilities

Classification

- **How:** Provides Buildings/facilities/open Space, Provides Services, Provides Advocacy/advice/information
- **What:** General Charitable Purposes, Education/training, The Prevention Or Relief Of Poverty, Arts/culture/heritage/science, Amateur Sport, Economic/community Development/employment
- **Who:** Children/young People, People Of A Particular Ethnic Or Racial Origin, Other Defined Groups

Geography

- **Area of benefit:** CITY OF BIRMINGHAM - IN PARTICULAR THE HODGE HILL, LADYWOOD AND SMALL HEATH CONSTITUENCIES
- Birmingham City

Finances

Period end	Income	Expenditure	Assets	Employees
2025-03-31	£997,265	£1,013,214	£418,060	32
2024-03-31	£948,046	£894,721	£434,009	21
2023-03-31	£729,793	£729,748	£380,685	18
2022-03-31	£60,780	£682,576	£380,639	18
2021-03-31	£697,044	£573,431	£437,300	21

Trustees

Name	Role	Appointed
WENDY MARJORIE KERR	Chair	2015-04-30
GHAZALA PARVEEN		2012-01-20
IFTIKAR KARIM		
JOHN LOUIS FREEMAN		
Rosemin Ahmed		2026-04-17

NORTON HALL CHILDREN AND FAMILY CENTRE

England & Wales - Charity number 1112752

Accounts

Norton Hall Children & Family Centre

Trustees Report and Financial Statements

For the year ended 31st March 2025

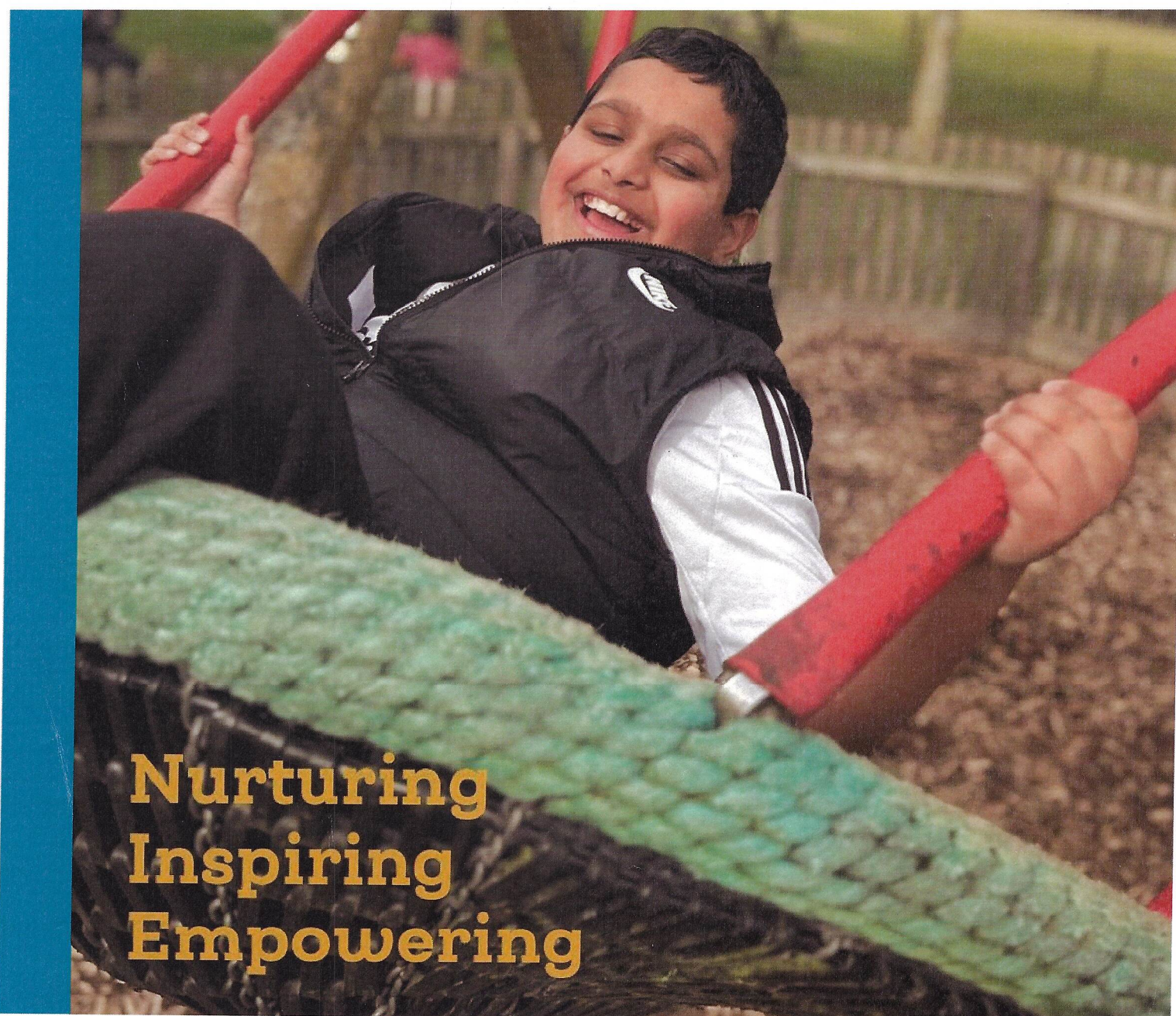

**Nurturing
Inspiring
Empowering**

CONTENTS

Pages

Trustees Report for YE25	1-21
› Chair's Review	4
› Objectives	5
› Achievement and Performance	5-16
› Staff and management	17
› Future plans	18
› Financial review and acknowledgements	18-19
› Governance	20-21
Independent Examiner's Report	22
Statement of Financial Activities	23
Balance Sheet	24
Cashflow statement	25
Notes forming part of the financial statements	26-35



FRONT COVER shows a moment of happiness for one of our young people on a trip to Ward End Park playground. Simple pleasures that not everyone has in their lives but that embodies the work of Norton Hall Children & Family Centre in our community.

TRUSTEES REPORT

The Trustees are pleased to present their report and independently examined financial statements for the year ending 31st March 2025, which are also prepared to meet the requirements for a directors' report and accounts for Companies Act purposes.

The financial statements have been prepared in accordance with the accounting policies set out in Note 1 to the accounts and comply with the Charity's governing document, applicable law, the Charities Act 2011, the Companies Act 2006, and the requirements of the Statement of Recommended Practice, "Accounting and Reporting by Charities" (SORP) issued in March 2005.

Reference and administrative information

Charity name:	Norton Hall Children and Family Centre
Charity registration number:	1112752
Company registration number:	05052641
Registered Office:	Ralph Road, Saltley, Birmingham B8 1NA.

Trustees

› Ms Wendy Kerr	Chair	Appointed April 2015
› Mr Iftikar Karim	(Secretary)	Appointed December 2004
› Ms Ghazala Parveen		Appointed September 2015
› Mr John Freeman		Appointed February 2004
› Ms Maryam Khan		Appointed April 2015

Secretary	Chief Executive Officer
Mr Iftikar Karim	Suzanne Knipe

Bankers

Unity Bank, 9 Brindley Place, Birmingham B1 2HB

Independent Examiner

Neal and Co Business Services Limited, Shakespeare Buildings, Cradley Road, Cradley Heath, West Midlands, B64 6AG.

CHAIR'S REVIEW

I am very proud to present my summary of this year's report for the Norton Hall Children & Family Centre. Our operations include the Dolphin Women's Centre in Ward End Park.

Once again this has been a very busy and eventful year, as our charity has expanded support for some of the most vulnerable and disadvantaged women, children, and families in East Birmingham.

In total across both Centres, we helped over 1,900 local women, children, and young people to improve their wellbeing and life chances.

Our community has continued to struggle with the cost-of-living crisis over the last year. 83% of the children we supported were from low-income families, and 59% had special educational needs and / or disabilities (SEND). Of the women we supported at the Dolphin Centre, 69% were long term unemployed, 47% were lone parents and 73% had limited or no English Language skills.

Our Winter food project was a lifeline to many of our families. Between October and March we gave a nutritious lunch and evening meal to many of the children attending our holiday activities, as well as gift vouchers to 250 of the families who were struggling the most with their finances.

At Norton Hall we supported almost 700 children aged 2-16 years, with preschool education, after school and school holiday positive activities, and our Starfish mentoring support programme. 92% of our preschool children who were on average four months behind in their Numeracy on entry to Nursery reached their age-related expected development by the end of the year.

Together with our partners, we supported 187 parents. SEND provision locally is very limited, and 70% of our parents have limited to no English Language skills which creates further barriers. In response, we developed a new programme benefiting 81 parents of SEND children, at the end of which 94% had improved knowledge and practical skills to support their child, and 92% were less stressed.

At the Dolphin Women's Centre, we supported over 1,000 local women to improve their life chances through participating in training and volunteering, and through the provision of employability and wellbeing support. Almost 40% improved their English language skills through English training, and 49 women got jobs after engaging in employability training and support.

In July, we launched the WASH, a five-year project based at the Dolphin Centre which aims to engage our community in nature and climate learning activities; aiming for improvements in food and growing skills, environmental knowledge, green jobs qualifications and career information and confidence building.

We developed further our Lakeside Café, with training, employment and volunteering opportunities for local women. Local people have told us that the Café is a community asset that was absolutely needed and is welcomed by all who have used it. In August we won the 'Best Café in Birmingham' Award!

Excluding fundraising and governance costs, 98p in every £1 was spent directly supporting our community. We grew our income to c.£997k and spent c.£1,013m, leaving us with just under three months free reserves in relation to the 2026 budget.

We would like to thank all our partners and funders for their much-valued support throughout this year. Your support is needed now more than ever as we set out to realise the ambitious plans we have for both centres. Finally, a big thank you to my fellow Trustees, and our dedicated staff and volunteers, whose hard work provides an invaluable service to the community.

Wendy Kerr

Chair of Trustees

OBJECTIVES

Background

Whilst established in its current form in 2006, the charity has a 50-year track record of community-based service delivery. Since 2013, our operations include running the Dolphin Women's Centre in Ward End Park. Our mission is to support local children, young people, and women to overcome disadvantage.

Charitable objectives

The objects of the charity, as set out in its Memorandum of Association are:

1. To relieve poverty and advance health and education in the City of Birmingham, and to address the needs of disadvantaged women, children and young people in the Hodge Hill, Ladywood and Small Heath constituencies, by providing:
 - a) A community nursery, provision for out of school childcare, and promoting the development of childcare provision aimed at meeting the needs of low-income families.
 - b) Holiday play schemes and other children's play provision.
 - c) Support and provision for young people, including youth work with girls and young women.
 - d) Opportunities for education, training and personal development.
 - e) Support for the economic advancement of women, including supporting women into employment and enterprise, or such further facilities as may be of benefit to the wider community in the area of benefit.
2. To promote and organise co-operation in the achievement of the above purposes.

ACHIEVEMENTS AND PERFORMANCE

We support our local community in the Ward End and Alum Rock areas of East Birmingham in Hodge Hill constituency which is ranked the second lowest on the English Index of Multiple Deprivation'. Our community has a high proportion of BAME residents, mainly of Pakistani heritage.

Our community has continued to struggle with the cost-of-living crisis over the last year, and we have grown our capacity in response. Overall, across both Centres we supported over 1,800 local women, children, and young people to improve their wellbeing and life chances.

98% of the people we supported last year were of BAME heritage. Of the women we supported at the Dolphin Centre, 69% were long term unemployed, 47% were lone parents and 73% had limited or no English Language skills. 91% of our preschool children started nursery with English as an additional language. 83% of the children we supported were from low-income families, and 59% had special educational needs and / or disabilities (SEND).

We thank our staff, volunteers, and Trustees who – through their hard work and dedication - have enabled us again this year to respond to the increase in demand for our services. We also thank our partners, whose expertise enhanced and broadened the support we could offer to our community.

Winter food project

We started the Winter Food Project because we saw children coming to play sessions so hungry their behaviour became challenging. We provided children attending activities breakfast when they arrived, a hearty lunch, and a range of snacks throughout the day.

We switched to gift vouchers last year rather than food parcels for families in line with feedback from our families and staff. The parcels were difficult to assemble and to get the contents right for each family. Our staff – who know local families well – were able to provide vouchers to those who were really struggling with their finances: given out discreetly to reduce embarrassment in front of others.

Over the holidays the children made their own pizzas and cooked them on the pizza oven in the Forest School Garden. They learnt how to make the pizza, preparing the ingredients, cooking and then eating it with their peers. Over the Christmas holidays we delivered two family winter fun days engaging engaged 40 adults and 134 children in a wide range of activities plus a hot meal for each attendee.

In total we provided:

- › 1,752 lunches to over 484 children attending our activities during school holidays.
- › 1,920 evening meals to 80 children from the most vulnerable families attending our activities.
- › 250 Aldi gift vouchers worth £20 each to 250 families.
- › 30 of the most vulnerable families with a £75 Christmas food voucher.

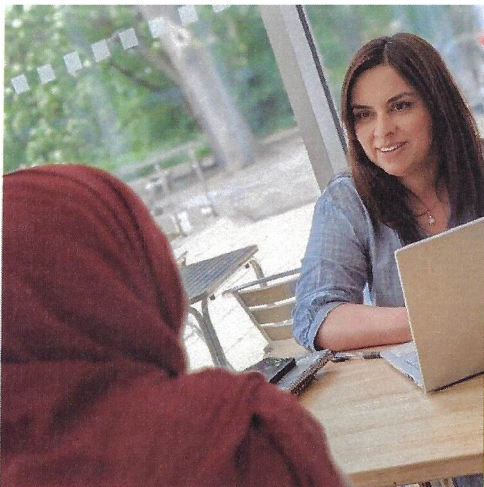

Having the conversation about not having enough food gave staff an opportunity to be able to talk openly about other forms of support.

We signposted beneficiaries who needed additional support with cost of living to local food banks, housing support organisations, Job Centre plus advisors, family support teams and other local organisations.

<

LEFT one of the Job Centre plus Employability Advisors supporting a local woman wanting to access work opportunities in a session at our Dolphin Women's Centre.

Feedback from families

"NHCFC is a life saver, thank you for the food vouchers I was really appreciative of it."

"Without this scheme I would be lost. My children play and have fun in the holidays, and they also have food which really helps me a single mother where money is so tight now days. I work and I still find it hard to survive financially but the staff at NHCFC help with activities for my children and hot food and snacks throughout the day. Thank you for all your support in the holidays."

"Staff at the Dolphin Women's Centre always makes my life easier. When I'm finding it hard with money, they helped me with food vouchers to buy food for family."

NORTON HALL – SUPPORTING CHILDREN, YOUNG PEOPLE AND FAMILIES

Our work at Norton Hall provides parents with all year round after school and holiday childcare which is either free or provided at a low cost. We also support parents through parenting training and support.

During the year we supported almost 700 children aged 2-16 through early years education, after school and school holiday positive activities, and through our Starfish mentoring support programme.

Together with our partners, we supported 187 parents struggling with parental challenges, including 81 parents of children with special educational needs and disabilities (SEND). SEND childcare provision locally is very limited. Most settings exclude SEND children due to the cost of maintaining higher staffing ratios. Language is another barrier: 70% of women we support have limited to no English Language skills.

Sunflower Community Nursery

At our Sunflower Nursery, we provide pre-school education for local children whose educational starting point in life is significantly lower than the national average. Our OFSTED rating remains 'GOOD'.

This year we provided early years education for 64 children aged 2-5 years. This included four children with complex SEND needs, who all thrived in nursery and were supported with their transition into formal education with no breakdown in placement.

Throughout the year, we engaged children in weekly sports sessions led by a professional sports coach, facilitating a wide range of physical activities to help children develop their physical skills. This had a noticeable impact on children's physical health and development. The development of core strength, gross and fine motor skills also helped them develop their early literacy and writing skills.

Our Forest School team engaged children in weekly forest school sessions to encourage a love for nature and to support their outdoor learning.

We engaged parents and children in a special workshop in the Ward End Park Community Garden with forest school activities including bushcraft skills, planting and other nature-based activities. This was a huge success, and the parents enjoyed getting outdoors in a safe space.

We also organised a workshop for 25 parents of children leaving nursery last year. The 'Read Steady Reception' workshop provided a range of information, advice and guidance on getting their child ready to transition to school.

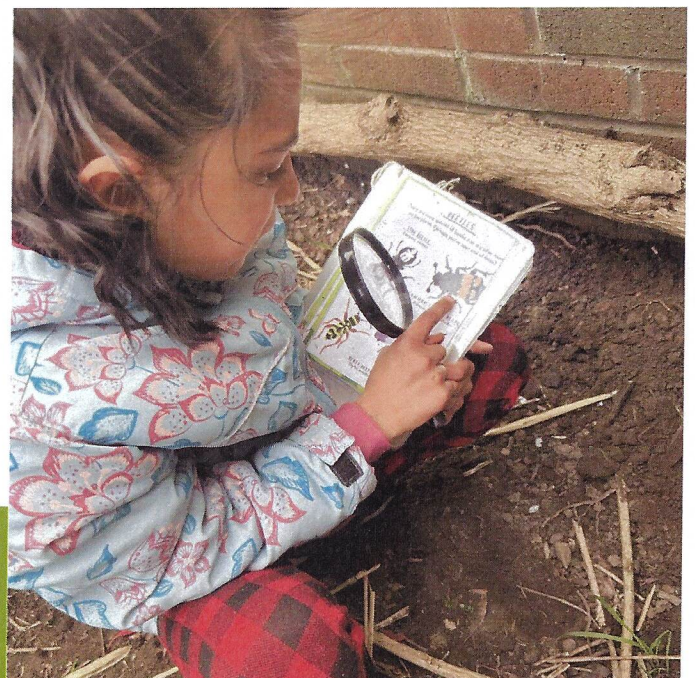

>

RIGHT a child taking part in our Forest School workshop.

Our team continued to work in partnership with 'Heart Early Years Stronger Practice Hub' partners to close the attainment gap for our children, and to reach a good level of development at the end of early years foundation stage for our nursery. Throughout the year we promoted evidence-based practice on activities which enhance children's all-around development. This has raised our profile as a Hub partner

During the year our nursery manager qualified as a Trainer for Early Talk Book and went onto deliver training to other early years providers in Birmingham. Our team were trained in the 'Glasgow Nurture' principles which is a recognised programme which aims to avoid school exclusions and improve children's self-regulation and executive function. During the year we introduced the principles at our nursery, and our nursery manager delivered Glasgow Nurture training to west Midlands early years providers.

OUTCOMES from our work with pre-school children

- > 92% of children who were on average four months behind in their Numeracy on entry to Nursery reached their age-related expected development through participation in our 'Counting Collection' intervention.
- > 100% of children who were on average six months behind in their Speech and Language on entry, made significant progress via our Early Talk Book intervention and were more ready for primary school.
- > 96% of our children leaving nursery last year were assessed as developmentally prepared for starting school (in line with child development bands using the EYFS curriculum).
- > 94% of parents with a child leaving Nursery last year agreed that their child was ready for school.

Children and Young People

We support some of the most vulnerable and disadvantaged children and young people in our community to improve their emotional wellbeing and gain confidence to navigate and manage their often difficult and challenging life circumstances.

We supported 634 children aged 5-16 this year, of whom 59% had special educational needs and / or disabilities (SEND), and 83% were from low-income families (entitled to benefit related free school meals). All of our staff are now trained in trauma informed training which was one of our priorities this year.

Positive activities

Most (575) of our children and young people engaged in what we call 'positive activities'. During the year these included Martial Arts, Football, Cookery, Creative Arts, Sports and team games, Forest School at nearby Ward End Park and play based activities for the younger children.

Positive activities enable them to gain interests and skills and develop confidence. They take place after school in the evening and at weekends and throughout school holidays.

>

RIGHT a child taking part in our Positive Activities.

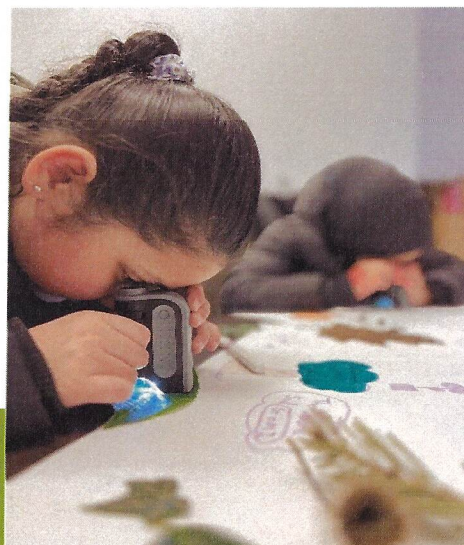

A third (204) of our children and young people engaged in Forest school and bush craft activities across the year. 59 required wrap around care as their parents were working or in education and accessed our after school and holiday care service. 21 engaged in drama activities and put on a show in the summer holidays – ‘Norton Hall has Talent’. Our 11–16-year-olds engaged well with our weekly boys and girls youth group, where we facilitate a wide range of life skill, social and sports activities.

Starfish Mentoring

Last year we supported 106 young people aged 10-14, through one to one and group mentoring. All children also participate in our positive activities, which acts as a gateway to more intensive mentoring support, enabling trust to be built between the child and our staff and volunteers. During the year we saw an increase in engagement for the positive activities which was one of our priorities.

The aim of mentoring is to help them improve their behaviour, wellbeing, engagement in school and family relations. Children are selected to join the mentoring programme by their teachers as their behavioural issues are putting them at risk of being a danger to themselves and others and potentially being excluded from education. We identify the challenges in each child’s life and build a bespoke package of support including a 12-week, one-to-one mentoring programme and drawing, talking and forest school therapies, combined with positive activities and play.

They are supported by our youth team, as well as young leader volunteers. Volunteer young leaders are local young people who we engage to lead activity sessions, providing training and support to fulfil their roles. Close in age, they provide peer support and act as role models for our young people.

Via a partnership with Family Action, we also supported 106 of the children’s parents and/or caregivers with advice and signposting on a 1:1 basis and / or in groups with wellbeing activities. Those that needed the most support engaged in our 10-week ‘Understanding your Child’s Behaviour’ course, where they developed skills like effective behaviour management.

Outcomes of mentoring

106 young people aged 10-14 were supported through 1:1 and / or group mentoring. 29 children took part in six mentoring groups, including one for seven children who had been bereaved.

76 children took part in 1:1 mentoring, of whom 39% had SEND. We survey their teachers and parents pre and post the mentoring.

The graph on the right shows the impact of the young people’s behaviour – at school, at home, and on their general wellbeing. The impact of this dropped by **46%** (**54%** for SEND children).

Other key findings included:

- > Emotional problems dropped by **37%** (**21%** SEND)
- > Conduct problems dropped by **30%** (**15%** SEND)
- > Hyperactivity scores dropped by **29%** (**2%** SEND)

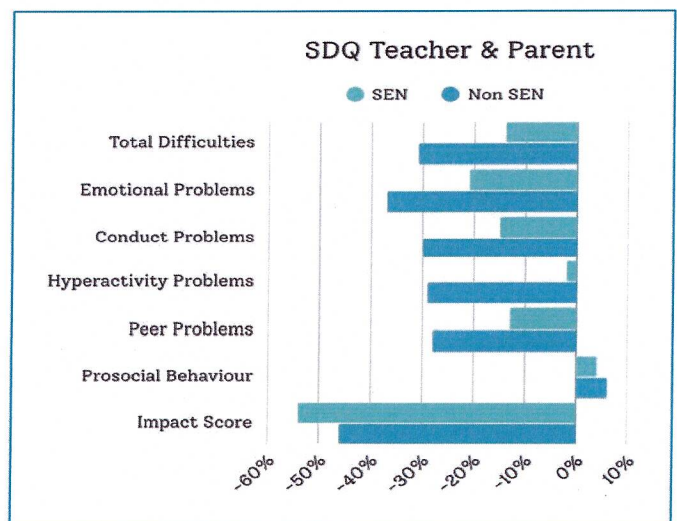

At the end of the mentoring sessions, young people felt more in control, better understood, and better at managing their emotions at school and home.

Starfish case study

T was referred to Starfish for mentoring support after becoming distressed around planned contact with his Dad, which he eventually refused to attend. He had fled domestic abuse with his Mum and younger brother and was carrying the emotional weight of that experience.

He described being locked in a room and witnessing serious harm to his brother. Although now safe at home, these traumatic memories were affecting his emotional wellbeing.

We engaged T in regular mentoring sessions which gave T a safe space to talk, build trust, and boost his self-confidence. The sessions used creative and calming activities like painting, playdough, and emotion cards to help him explore and express his thoughts. The focus was on creating a space where he felt heard and in control.

Over time, as the mentoring relationship grew, he opened up about his experiences and started showing more of his personality. T made huge progress in terms of confidence and emotional expression. At the start he was quiet and cautious, with minimal speech and a visible stutter.

Gradually, he became more talkative, relaxed, and enthusiastic about the sessions – even reminding his Mentor when it was time. He began to talk openly about his past and showed resilience when discussing it. He developed coping strategies for dealing with nerves and became more socially confident with peers.

T is now settled and happy both at home and in school. He enjoys learning, has strong friendships, and is more emotionally secure. He feels at peace with not having contact with his dad, and his wishes have been respected through the court process. His Mum, who was also supported early on by the school, now works there – strengthening the positive link between home and school. T has said he's looking forward to secondary school and is excited about making new friends.

T told us:

"I used to be nervous talking to people, but now I just speak to them, it gets easier and they become my friends. I don't miss my dad. I'm happy with Mum and my brother. I like painting. It makes me feel calm."

His Mentor reflected:

"Giving children a safe, consistent space where they feel in control and valued makes a real difference. T's progress shows how important it is to build trust, move at the child's pace, and use creative tools to help them open up. Partnership with the family and wider support networks also played a key role in his journey. It's a reminder that emotional support doesn't have to be complicated to be powerful."

📢 SPOTLIGHT on our expanded support for parents of SEND children

Together with our partners, we this year we supported 187 parents struggling with parental challenges. This included 81 parents of children with special educational needs and disabilities (SEND), for whom we expanded our support as we had developed a large waiting list following a pilot.

Across the year we supported parents in a range of ways:

- › **One to one support:** each parent had an initial meeting with one of our staff to share their feelings, concerns, and experiences. We offered guidance on how best to support their child and co-developed an Action plan based on their child's needs and their family situation. We took soundings from the child's teacher as the year progressed and adjusted plans as needed. We supported with:
 - Completing complex Student Support Provision Plans and Education Health Care Plan applications to the Special Educational Needs Assessment and Review service
 - Applications for financial support, including Disability Living Allowance, Family Funds to help purchase specialist equipment, and / or for Blue Badges giving them priority parking rights.
 - Advocacy to help them access placements at special schools like Autism West Midlands
- › **Coffee mornings:** we hosted weekly sessions during term time at the Dolphin Centre and Norton Hall, helping parents to connect with peers and share knowledge on e.g., SEND provision and resources.
- › **Training:** we delivered five training workshops, led by external specialists for 15 parents in each workshop. These covered topics such as - Behaviour Management, Toileting Techniques, Sleep Strategies, Healthy Eating, Communication and language, Autism Spectrum Disorder, and 'This is Me' (a workshop supporting parents to better understand their child's autistic or ADHD needs).
- › **Holiday play:** 88 of their children accessed play sessions two days each week of school holidays. For those with complex needs the sessions ran for three hours for three months until we could find them a specialist provider. All sessions focused on fun, stimulating sensory activities which catered to their individual needs. in a special area at Norton Hall which has lights, toys, material play, sand and water etc.
- › **Family play and stay:** we facilitated stimulating, developmentally appropriate activities for the children, their siblings and parents to engage in sensory play.

OUTCOMES from our SEND parenting programme

Due to participation in the programme, results included that:

- > 94% of parents had improved knowledge and practical skills to support their child.
- > 92% were less stressed resulting in them being more prepared to handle the challenges of raising a child / young person with SEND
- > 89% had improved network and peer support group (resulting in increased social inclusion).
- > 87% felt their parenting skills had improved.
- > 81% had a better awareness of other services or agencies to seek support.
- > 76% were more confident to work with school staff and other professionals; and,
- > 67% reported that their child has better attendance at school (increased school timetable or attending school more regularly).

Feedback from parents

"I often went to the school to raise concerns. I felt I was nagging them constantly, but I didn't have anywhere else to go. Now Norton Hall help me with my concerns. It's much quicker for my child."

"The sessions are helpful as we get a chance to off load, meet other parents in similar situations as us who can give us advice and vice versa. The staff from Norton Hall that lead the sessions have enabled us to feel heard and supported. A lot of us parents had issues with the school and were unable to get in touch with the relevant teachers. The team at Norton Hall would chase this for us which relieved a lot of anxiety and stress. They helped with behavioural techniques and were always happy to go that extra mile with printing off forms etc."

"If the play sessions in the school holidays were not available, I would go crazy in the holidays, there's not much out there for children with SEND."

DOLPHIN WOMEN'S CENTRE

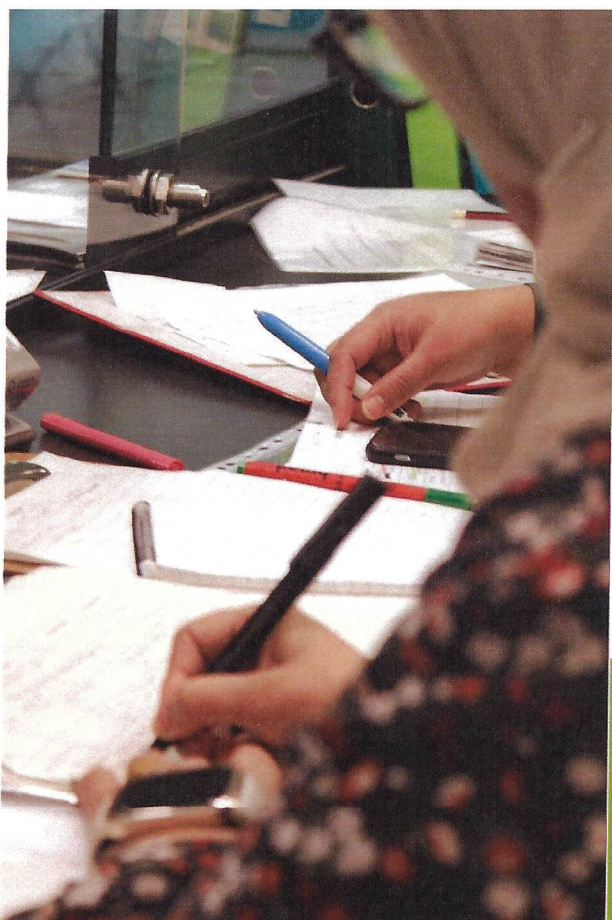

We use the Centre's Lakeside Café, Training suite, allotments, Forest school area and grounds to empower local women to overcome inequalities and disadvantage and improve their life chances through participating in training and volunteering, and through the provision of employability and wellbeing support.

During the year we supported 1,026 women through participation in training, volunteering, work experience, wellbeing activities and specialist support.

47% were lone parents, 69% long term unemployed and 73% had limited or no English language skills.

Initially we support women with information, advice and guidance and signposting to local services. We can connect women to local services providing specialist support including counselling, welfare crisis support, and health support for those living with long term illnesses.



LEFT after accessing our advice and guidance services, skills and training, local women can volunteer and apply for work experience in our Dolphin Women's Centre. This often leads to employment opportunities.

Wellbeing support

Our partner Ways to Wellbeing delivers a rolling programme at the Centre. 322 women engaged during the year in sessions from Makeup, Sewing, Cake decorating, Photography, Drama, Arts and crafts, coffee mornings, outdoor walk and talk groups and gentle exercise classes. The social nature of the provision helps women to improve their confidence and self-esteem; whilst making new friends and enjoying our green space. This prepares them for stepping into formal training courses or volunteering, or employment.

Pathways to employment support including training

During school-friendly hours we offer formal training - IT /English / Maths / Food Hygiene/ First Aid/ Childcare / Early Years Education / Employability – as well as work experience through volunteering.

During the year 72 women gained valuable work experience via volunteering. They greeted Centre visitors on Reception, supported students in our Training Centre, helped with administration tasks, supported our Café team serving customers, and our environmental team in work on our allotments and Forest school.

Training

During the year 398 women engaged in English Language training. The beginners and entry level training is delivered by experienced ESOL Tutors who volunteer with us, some of whom are retired teachers and are all local. The more advanced courses are delivered by our partners the Workers Educational Association. We offer: English for Absolute Beginners; Pre-Entry ESOL for those interested in working with Pre- School children; Entry ESOL for those interested in working in Hospitals, Textiles and Fashion & ESOL Entry Level 3.

Feedback from one of our students

"I was born in Pakistan in 1985. In early 2006 I finished my college education and got married to a stranger. My husband was a British citizen.

*I came in England in October 2006. I was a girl full of life and passion. I love to learn. I asked my husband to get education here. In our house all rules were made by my mother in law. She said to me: **'We didn't bring you here to learn education we bring you here to look after my whole family'**.*

I cooked food for 18 people every day - all my day spent in kitchen. I looked after my sister in law's children at the same time from 8 am to 6 pm - one of them were special needs. I massaged my mother in law every night. When my children were born nobody helped me not even my husband. I have 3 children 2 of them are autistic. I did everything for them, very hard.

I was a lady who always has complex because everybody in house call me mad and useless. And I feel like that as well. I goes through like this for 18 years.

In April 2024 I joined dolphin centre ESOL classes. I swear it's changed my life. Before that I was completely living in a fog. I didn't know anything about British values. My brain was completely blank. I wasn't know really about reading, I completely forgot about writing. My confidence level was zero.

But with dolphin centre classes I build up my confidence. I can write really well now. In reading and speaking I am doing really well.

I really really appreciate the lady who is running this centre Maxine. She is doing so good job. It's a great work that she is doing. I am really really thankful to her that she gave me platform to learn something.

*I believe lots of ladies like me get back to their lives because of this centre. Ladies are most important part of society. Long time ago I read: **'You give me good mothers I will give you a good nation.'***

*I am really thankful to Maxine, because of her efforts now I am a new lady. I never even wash my face with soap before when I was staying in house. I never look after myself because the people around made me feel like this. Now I am saying myself: **'No, I need to look after myself, if no one cares about me, I will care about myself.'***

Our courses are designed to prepare trainees for jobs available in our locality, such as teaching, childcare, retail, and administration. 201 women benefited from a wide range of accredited education and training opportunities delivered by our own team alongside our partners the Disability Resource Centre, South and

City College Birmingham, Matthew Boulton College, Birmingham Metropolitan College and a volunteer academic. Some of these include:

- › IT for Beginners, and IT Intermediate/ Level 1 and Advanced
- › Maths for Beginners, and Maths Functional Skills - Levels 1 and 3
- › Understanding the Role of a Community Interpreter Award – Levels 1 and 2
- › Food Hygiene – Level 1, Emergency First Aid, Safeguarding, Health & Safety and Online Safety
- › Preparation for work: CV writing, employment action plans and identification of job opportunities.
- › Introduction to Early Years - Level 1; Introduction to Supported Teaching - Level 1, and Introduction to Safeguarding in Education Setting - Level 1

Employability support programme

We helped women improve their chances of accessing employment by providing access to IT: women can use equipment at the Centre to complete job applications and where needed we can loan them a Tablet & SIM card to work on their applications at home. A Job Centre Plus Advisor is based on site providing CV support, job search, interview support, interview clothes support and benefit support when in part time work etc. Other partners include the Disability Resource Centre & Birmingham Institute for the Deaf.

Outcomes from our work with women and a case study

Of the women we supported...

- > 39% (398) improved their English language skills through English training
- > 20% (201) gained basic education & vocational qualifications through attending our training
- > 25% (254) improved their employability skills through employability training & support
- > 5% (49) got jobs after accessing employability training & support
- > 7% (72) gained work experience through volunteering

N is 45 years old and came to England in 2014 from Morocco; a single Mum of four children with no spoken English. In 2015, N found the Dolphin Centre, who supported her to access a pre-entry beginners English class - the only one suitable, as without having any basic English, N would not be eligible to be accepted onto the Council run Adult Education classes.

Over the next few years N gained level 2 qualifications in English, Maths and IT with us, grew in self-confidence and built a social support network. She gained the skills and confidence to begin to take the first steps into finding employment. We supported N with volunteering opportunities, initially on Reception and then in the Café.

N recalls:

"I can't forget the day that the Café Manager said she wanted to talk to me. I was so scared I thought I had done something wrong but my fear turned to excitement when I was offered a part time job in the Café. I will never forget that day, that someone believed in me. I really needed a job, I was a single mother with 4 children and no support and I had to feed the children. Since that time I have become the Trainee Manager. I can't believe my journey; I started from a big minus zero and here I am now, able to support my family financially and my children are all so proud of me."

SPOTLIGHT on our 'Washwood Heath Adaptation and Sustainability Hub' (WASH) project

In July, we launched the WASH, a five-year project which aims to engage our local community in nature and climate learning activities, increasing their engagement with and connection to nature locally as well as in the rural environment. The project aims to see improvements in everyday lives, including food and growing skills, improved mental and physical health, and confidence building as well as creating career opportunities and more green jobs for local people.

Alongside connecting our community with nature, we will help them take action on climate change. Based in the Dolphin Women's Centre and with a vibrant hub in the Lakeside Café, the WASH will provide a welcoming space for those who are passionate about the world in which we live and care about our local environment. We're partnering with Birmingham and Black Country Wildlife Trust, Friends of Ward End Park and New Leaf Sustainable Development to deliver the project.

Across the five years we will host a diverse range of events, outings and courses centred around the environment and 'green action', focused around Ward End Park with its Forest School area and Pond, the Lake and Wash brook.

During school holidays children will attend Forest School in Ward End Park. We will take children and their families on trips to the National Trust Brockhampton estate and the Wyre Forest to experience nature in a wilder setting. At the Dolphin Women's Centre we will engage groups of children with creative nature-based climate crisis activities and inspire families to take climate crisis actions.

Throughout we will engage learning disabled young women and volunteers in an outdoor environmental activities and learning, which will include improving the biodiversity of the Park and Lake. We will train local people as Forest School Leaders, create and deliver accredited Horticultural training courses and train local people in how to grow their own food, using our allotments as training grounds.

One of the first achievements was to create an additional allotment on an unused balcony at the Dolphin Women's Centre. As can be seen the beds, shade, table, established plants and planting and irrigation systems have been delivered and built. We can now grow food used in our Lakeside Café on the new allotment as well as our existing community allotment, reducing food miles. As of March 2025 we were training our staff and volunteers how to manage and tend to the growing allotment.



ABOVE shows the completed balcony allotment project, co-developed with residents and Slow Food Birmingham, who are experienced in roof top growing.

The WASH project is being funded thanks to a grant from The National Lottery Community Fund, the largest community funder in the UK, as well as other generous donors (see financial statements below).

Lakeside Café

Since we opened the doors to our lakeside Café and its outdoor Kiosk in 2023 we have been gradually developing what we offer and how we run it.

The Café team caters to Centre visitors, including buffet lunches for training providers who rent rooms at the Centre. The team prepare meals for children at nearby Norton Hall, as well as regular catering for various projects we run from the Centre. The produce that is grown in our community allotments is used in the Café, reducing costs and ensuring that any surplus can be invested back into supporting women. Four local women are employed at the Café, alongside local women gaining work experience as volunteers.

During the year, we further developed our team who provided excellent service and good quality food and beverages for local people accessing the park and enjoying the Café's amazing view of the Lake.

We increased promotional activity to engage more customers, growing both Café sales and hire of the Café space for meetings and events. Local people have told us that the Café is a community asset that was absolutely needed and is welcomed by all who have used it. In August we won the 'Best Café in Birmingham' Award.

Birmingham Live review, August 2024

"I visited the 'best park café' with a lake view in an unexpected corner of Birmingham. The Lakeside Café sells food as lovely as the view - and the profits go to a great cause. I've been to a few park cafes in Birmingham and this was by far the loveliest.

Good value, tasty food, friendly service and one of the prettiest views around. I couldn't fault it. The Lakeside Café at Ward End Park is worth travelling across the city to visit, but come on an empty stomach!"

STAFF AND MANAGEMENT

The day-to-day financial management is devolved to the Chief Executive - Suzanne Knipe. The Board receives quarterly management accounts, showing the actual performance compared to budget.

We have a culturally diverse staff team, balanced in age and gender. Many of our staff live locally and some are 'home grown', starting with us as volunteer young leaders. Our qualified and experienced team have a wide range of complementary skills and qualifications.

These include Youth Work and academic qualifications in for example, Play Work and Mentoring Qualifications (to Level 2 or 3), Therapeutic Counselling, Psychology, 'Trauma Informed Practice' and Drawing and Talking Therapy.

During the year we have gained new permanent employees in the Lakeside café and provided job opportunities for young women who have left school or at university to do sessional work in the café at weekends. We expanded the environmental team which now includes a new Project Manager, Volunteer and Engagement Co-ordinator, Part-time Horticulture Co-ordinator and Forest School Leader.



ABOVE shows a number of our dedicated staff team who passionately support our ethos of NURTURING, INSPIRING, EMPOWERING the lives of local children and families.

FUTURE PLANS

Trustees have reviewed the financial position of the charity over the next 12 months which has included a review of the budget for the coming year (YE26) and anticipated funding into YE27.

Over the last few years our Charity has grown significantly and therefore over the next twelve months we aim to start consolidating our internal functions and service delivery across the whole organisation.

Nursery: our team will enhance the curriculum with more focus in Expressive, Arts and Design and Physical Development areas to help children improve in these learning areas.

We will also improve our engagement with parents, which will improve developmental outcomes for children

Children, young people and women: we will continue to maintain, improve and develop the quality of services we provide to the community in response to local needs.

Norton Hall: improving the fabric of the building by developing a Planned & Preventative Maintenance Plan and securing funding to support the identified works.

CRM upgrade: developing our Lamplight system to ensure we are monitoring and evaluating the impact of our work effectively, and that our systems are fit for purpose - now and in the future.

Finance: strengthening our finance function by outsourcing the management account function which will free up capacity within the core team and improve the function via external expertise and support.

Governance: strengthening our governance will include recruiting new Trustees with appropriate skills, knowledge and experience of our work and our community whose expertise will add value to our work.

Income diversification: continue to increase trading income and diversify income streams across all our services and projects as so we are not reliant on short term grant funding.

Marketing and communications: we will continue to invest and develop strategies to engage service users, raise our profile, share learnings and market our work.



FINANCIAL REVIEW

The Trustees agreed a budget for the year with three main cost centres: 1. The Sunflower Nursery; 2. Children and Young Peoples Services; and 3. The Dolphin Women's Centre.

Total incoming resources for the year ending 31st March 2025 (YE25) were £997,265 (YE24 £948,046).

Resources expended were £1,013,214 (YE24 £894,721), which left a net deficit of £15,949 (YE24 £53,325 surplus). 98% of our expenditure was spent on directly supporting beneficiaries: 68% on the salaries of our expert team, 15% on activity costs, and 15% on premises and management costs across our two Centres. 2% was spent on fundraising and governance costs.

Total net assets at the year-end amounted to £418,060 (YE24 £434,009) of which £160,953 was restricted for spend in YE26 (YE24 £148,736).

Reserves policy and position

Due to uncertainties and the short-term nature of much of the charity's funding, the Trustees policy is to hold sufficient funds in Unrestricted reserves to allow it to operate for a period of 3-6 months in the coming budget year. This policy is reviewed annually by Trustees.

The Unrestricted reserves position at 31st March 2025 was £257,107 (YE24 £195,273) which equated to just under three months of the YE26 budget of £1,072m. The Charity holds a designated fund within its Unrestricted Reserves to cover redundancies and building maintenance; this had reduced to £79,701 (£90k YE24) as the Charity used £11k to refurbish the Sunflower Nursery kitchen.

Income generation

The charity has limited assets and its primary source of funding - 67% this year- was charitable activities income sourced through partnerships with local authorities, schools and other charities.

29% of income was received in grants from Trusts, Foundations and the National Lottery Community Fund, and 4% was donated by individuals. Where grants are given for specific purposes, they are treated as Restricted Funds. In YE25, the Charity received c.£393k of restricted grants, and tracking and managing these funds (as detailed at Note 17) is part of the charity's financial management.

Acknowledgements

We would like to thank all our partners for their much-valued support throughout this year, including Birmingham City Council Landscape Practice Group, The Friends of Ward End Park, Family Action, Birmingham Education Partnership, 26 local schools, Birmingham Adult Education Service, The Pioneer Group, local Family Support Teams and Safeguarding Hubs, Workers Education Association, Jobcentre Plus, Midland MENCAP, Birmingham MIND, Birmingham Healthy Minds, Disability Resource Centre, Sampad, Birmingham Institute for the Deaf, Salt Road, Birmingham & Black Country Wildlife Trust Spurgeon's, Children's Quarter & Ways for Wellbeing CIC.

Also, a special thank you to our funders: the National Lottery Community Fund, Birmingham City Council, and the E H Smith Charitable Trust, Eveson Charitable Trust, G.E. GEE Trust, Garfield Weston Foundation, George Henry Collins Charity, Grace Trust, Grimmitt Trust, Heart of England Community Foundation, Hudson Charitable Trust, Irving Memorial Trust, Lillie Johnson Charitable Trust, Michael Marsh Charitable Trust, Millie's Watch, Roger and Douglas Turner Charitable Trust, Roughley Trust, Saintbury Trust, Souter Charitable Trust, and the St Thomas's Dole Charity.

A big thank you to our dedicated staff team staff whose hard work provides a valuable service to the community. Thank you to our Trustees, who give their time and expertise on a voluntary basis.

Finally, a huge thank you to our team of dedicated local volunteers, who give their time to support the day-to-day work of the charity.

GOVERNANCE

Governing document

The charitable company is registered with the Charity Commission and constituted as a not-for-profit Company Limited by Guarantee having no share capital. The charity is governed by its Memorandum and Articles of Association, and the policies made from time to time by its directors, who are also the Trustees of the charity. Trustees are elected at the Annual General Meeting, with one third standing down each year. They have the power to co-opt up to three further Trustees, and at least 60% must be women.

Responsibilities of the Trustees

Company law requires the Trustees to prepare financial statements for each financial year which give a true and fair view of the situation of the charity as at the balance sheet date. This includes its incoming resources and application of resources and income and expenditure for the financial period. In preparing those financial statements, the Trustees should follow best practice and:

- › Select suitable accounting policies and then apply them consistently.
- › Make judgements and estimates that are reasonable and prudent; and,
- › Prepare the financial statements on the going concern basis unless it is inappropriate to assume that the charity will continue on that basis.

The Trustees are responsible for maintaining proper accounting records which disclose with reasonable accuracy at any time the financial position of the charitable company and to enable them to comply with the Companies Act 2006. The Trustees are also responsible for safeguarding the assets of the charity and hence for taking steps for the prevention and detection of fraud and other regularities. The Trustees who served during the period under review and up to the date of this report are set out on page 2.

Risk management

The Trustees have assessed risks to which the charity is exposed and are satisfied that systems are in place to mitigate our exposure to the major risks. Trustees are confident that sufficient funding will be available to continue to run the charity for the next 12 months and have contingency plans in place to deal with a shortfall in funding within one or more of its current activities.

Public benefit

The Trustees, having considered section 4 of the Charities Act 2006, have satisfied themselves that they have complied with the duty to have regard to the Public Benefit guidance published by the Charity Commission.

The activities and achievements of the charity are outlined in this Report and the Trustees believe, demonstrate that charity is providing public benefit.

Independent examination

The Trustees have appointed Neal and Co Business Services Limited to undertake this role.

This report has been prepared in accordance with the special provisions of Part 15 of the Companies Act 2006 relating to small companies.

Approved by the Trustees and signed on their behalf by:

A handwritten signature in black ink, appearing to read 'I. Karim', with a stylized flourish at the end.

Mr Iftikar Karim

Secretary

INDEPENDENT EXAMINER'S REPORT

I report to the Trustees on my examination of the financial statements of Norton Hall Children & Family Centre (the charity) for the year ended 31 March 2025.

Responsibilities and basis of report

As the trustees of the charity (and also its directors for the purposes of company law), you are responsible for the preparation of the financial statements in accordance with the requirements of the Companies Act 2006.

Having satisfied myself that the financial statements of the charity are not required to be audited under Part 16 of the Companies Act 2006 and are eligible for independent examination, I report in respect of my examination of the charity's financial statements carried out under section 145 of the Charities Act 2011. In carrying out my examination I have followed the Directions given by the Charity Commission under section 145(5)(b) of the Charities Act 2011.

Independent examiner's statement

Since the charity's gross income exceeded £250,000, the independent examiner must be a member of a body listed in section 145 of the Charities Act 2011. I confirm that I am qualified to undertake the examination because I am a member of the Association of Chartered Certified Accountants, which is one of the listed bodies.

I have completed my examination. I confirm that no matters have come to my attention in connection with the examination giving me cause to believe that in any material respect:

- 1 accounting records were not kept in respect of the charity as required by section 386 of the Companies Act 2006.
- 2 the financial statements do not accord with those records; or
- 3 the financial statements do not comply with the accounting requirements of section 396 of the Companies Act 2006 other than any requirement that the financial statements give a true and fair view, which is not a matter considered as part of an independent examination; or
- 4 the financial statements have not been prepared in accordance with the methods and principles of the Statement of Recommended Practice for accounting and reporting by charities applicable to charities preparing their financial statements in accordance with the Financial Reporting Standard applicable in the UK and Republic of Ireland (FRS 102).

I have no concerns and have come across no other matters in connection with the examination to which attention should be drawn in this report in order to enable a proper understanding of the financial statements to be reached.

Robert Chance FCCA

Chartered Certified Accountant

Neal and Co Business Services Limited

Shakespeare Buildings

26 Cradley Road

Cradley Heath

West Midlands

B64 6AG

Date: 01/12/25

FINANCIAL STATEMENTS FOR THE YEAR ENDING 31st MARCH 2025

Statement of Financial Activities (incorporating an Income and Expenditure Account)

	Notes	Unrestricted funds 2025 £	Restricted funds 2025 £	Total 2025 £	Unrestricted funds 2024 £	Restricted funds 2024 £	Total 2024 £
Income from:							
Donations and legacies	3	44,393	288,360	332,753	52,092	207,029	259,121
Charitable activities	4	560,123	104,389	664,512	489,690	199,235	688,925
Total income		<u>604,516</u>	<u>392,749</u>	<u>997,265</u>	<u>541,782</u>	<u>406,264</u>	<u>948,046</u>
Expenditure on:							
Raising funds	5	20,103	-	20,103	15,696	-	15,696
Charitable activities	6	612,579	380,532	993,111	479,249	399,776	879,025
Total expenditure		<u>632,682</u>	<u>380,532</u>	<u>1,013,214</u>	<u>494,945</u>	<u>399,776</u>	<u>894,721</u>
Net income/(expenditure) and movement in funds		(28,166)	12,217	(15,949)	46,837	6,488	53,325
Reconciliation of funds:							
Fund balances at 1 April 2024		<u>285,273</u>	<u>148,736</u>	<u>434,009</u>	<u>238,436</u>	<u>142,248</u>	<u>380,684</u>
Fund balances at 31 March 2025		<u>257,107</u>	<u>160,953</u>	<u>418,060</u>	<u>285,273</u>	<u>148,736</u>	<u>434,009</u>

The statement of financial activities includes all gains and losses recognised in the year. All income and expenditure derive from continuing activities.

Balance Sheet as at 31st March 2025

	Notes	2025		2024	
		£	£	£	£
Fixed assets					
Tangible assets	12		176,040		199,396
Current assets					
Debtors	13	86,675		17,768	
Cash at bank and in hand		196,967		249,935	
		<u>283,642</u>		<u>267,703</u>	
Creditors: amounts falling due within one year	14				
		<u>(41,622)</u>		<u>(33,090)</u>	
Net current assets			<u>242,020</u>		<u>234,613</u>
Total assets less current liabilities			<u>418,060</u>		<u>434,009</u>
The funds of the charity					
Restricted income funds	17		160,953		148,736
Unrestricted funds	18		257,107		285,273
			<u>418,060</u>		<u>434,009</u>

The charitable company is entitled to the exemption from the audit requirement contained in section 477 of the Companies Act 2006, for the year ended 31 March 2025.

The directors acknowledge their responsibilities for complying with the requirements of the Companies Act 2006 with respect to accounting records and the preparation of financial statements.

The members have not required the charitable company to obtain an audit of its financial statements for the year in question in accordance with section 476.

These financial statements have been prepared in accordance with the provisions applicable to companies subject to the small companies regime.

The financial statements were approved by the trustees on 24/11/2025

.....

Mr I Karim, Secretary
Trustee

Statement of Cash flows for the year ending 31st March 2025

	Notes	2025		2024	
		£	£	£	£
Cash flows from operating activities					
Cash (absorbed by)/generated from operations	21		(48,643)		65,950
Investing activities					
Purchase of tangible fixed assets		(4,325)		(49,678)	
Net cash used in investing activities			(4,325)		(49,678)
Net cash generated from financing activities			-		-
Net (decrease)/increase in cash and cash equivalents			(52,968)		16,272
Cash and cash equivalents at beginning of year			249,935		233,663
Cash and cash equivalents at end of year			<u>196,967</u>		<u>249,935</u>

Notes to the financial statements for the year ending 31st March 2025

1 Accounting policies

Charity information

Norton Hall Children & Family Centre is a charitable company limited by guarantee incorporated in England and Wales. The registered office is Ralph Road, Saltley, BIRMINGHAM B8 1NA.

1.1 Basis of preparation

The financial statements have been prepared in accordance with the charity's governing document, the Companies Act 2006, FRS 102 "The Financial Reporting Standard applicable in the UK and Republic of Ireland" and the Charities SORP "Accounting and Reporting by Charities: Statement of Recommended Practice applicable to charities preparing their accounts in accordance with the Financial Reporting Standard applicable in the UK and Republic of Ireland (FRS 102)". The charity is a Public Benefit Entity as defined by FRS 102.

The financial statements are prepared in sterling, which is the functional currency of the charity. Monetary amounts in these financial statements are rounded to the nearest £.

The financial statements have been prepared under the historical cost convention, [modified to include the revaluation of freehold properties and to include investment properties and certain financial instruments at fair value]. The principal accounting policies adopted are set out below.

1.2 Going concern

At the time of approving the financial statements, the trustees have a reasonable expectation that the charity has adequate resources to continue in operational existence for the foreseeable future. Thus the trustees continue to adopt the going concern basis of accounting in preparing the financial statements.

1.3 Charitable funds

Unrestricted funds are available for use at the discretion of the trustees in furtherance of their charitable objectives.

Restricted funds are subject to specific conditions by donors or grantors as to how they may be used. The purposes and uses of the restricted funds are set out in the notes to the financial statements.

Endowment funds are subject to specific conditions by donors that the capital must be maintained by the charity.

1.4 Income

Income is recognised when the charity is legally entitled to it after any performance conditions have been met, the amounts can be measured reliably, and it is probable that income will be received.

Cash donations are recognised on receipt. Other donations are recognised once the charity has been notified of the donation, unless performance conditions require deferral of the amount. Income tax recoverable in relation to donations received under Gift Aid or deeds of covenant is recognised at the time of the donation.

Legacies are recognised on receipt or otherwise if the charity has been notified of an impending distribution, the amount is known, and receipt is expected. If the amount is not known, the legacy is treated as a contingent asset.

1 Accounting policies (continued)

1.5 Expenditure

Expenditure is recognised once there is a legal or constructive obligation to transfer economic benefit to a third party, it is probable that a transfer of economic benefits will be required in settlement, and the amount of the obligation can be measured reliably.

Expenditure is classified by activity. The costs of each activity are made up of the total of direct costs and shared costs, including support costs involved in undertaking each activity. Direct costs attributable to a single activity are allocated directly to that activity. Shared costs which contribute to more than one activity and support costs which are not attributable to a single activity are apportioned between those activities on a basis consistent with the use of resources. Central staff costs are allocated on the basis of time spent, and depreciation charges are allocated on the portion of the asset's use.

1.6 Tangible fixed assets

Tangible fixed assets are initially measured at cost and subsequently measured at cost or valuation, net of depreciation and any impairment losses.

Depreciation is recognised so as to write off the cost or valuation of assets less their residual values over their useful lives on the following bases:

Leasehold improvements -	25 years straight line
Fixtures and fittings -	25% per annum straight line

The gain or loss arising on the disposal of an asset is determined as the difference between the sale proceeds and the carrying value of the asset, and is recognised in the statement of financial activities.

1.7 Cash and cash equivalents

Cash and cash equivalents include cash in hand, deposits held at call with banks, other short-term liquid investments with original maturities of three months or less, and bank overdrafts. Bank overdrafts are shown within borrowings in current liabilities.

1.8 Financial instruments

The following assets and liabilities are classified as financial instruments – trade debtors and trade creditors.

Trade debtors and trade creditors are measured at the undiscounted amount of cash or other consideration expected to be paid or received.

1.9 Employee benefits

Termination benefits are recognised immediately as an expense when the charity is demonstrably committed to terminate the employment of an employee or to provide termination benefits.

1.10 Retirement benefits

Payments to defined contribution retirement benefit schemes are charged as an expense as they fall due.

2 Critical accounting estimates and judgements

In the application of the charity's accounting policies, the trustees are required to make judgements, estimates and assumptions about the carrying amount of assets and liabilities that are not readily apparent from other sources. The estimates and associated assumptions are based on historical experience and other factors that are considered to be relevant. Actual results may differ from these estimates.

The estimates and underlying assumptions are reviewed on an ongoing basis. Revisions to accounting estimates are recognised in the period in which the estimate is revised where the revision affects only that period, or in the period of the revision and future periods where the revision affects both current and future periods.

3 Income from donations and legacies

	Unrestricted funds 2025 £	Restricted funds 2025 £	Total 2025 £	Unrestricted funds 2024 £	Restricted funds 2024 £	Total 2024 £
Donations and gifts	44,393	-	44,393	20,092	-	20,092
Grants	-	288,360	288,360	32,000	207,029	239,029
	<u>44,393</u>	<u>288,360</u>	<u>332,753</u>	<u>52,092</u>	<u>207,029</u>	<u>259,121</u>

4 Income from charitable activities

	Unrestricted funds 2025 £	Restricted funds 2025 £	Total 2025 £	Unrestricted funds 2024 £	Restricted funds 2024 £	Total 2024 £
Charitable activities						
Income from fees and trading	560,123	-	560,123	489,690	-	489,690
Public sector contracts and grants	-	104,389	104,389	-	199,235	199,235
	<u>560,123</u>	<u>104,389</u>	<u>664,512</u>	<u>489,690</u>	<u>199,235</u>	<u>688,925</u>

Notes to the financial statements for the year ending 31st March 2025 (continued).

5 Expenditure on raising funds

Unrestricted funds	Unrestricted funds
2025	2024
£	£

Fundraising and publicity

Other fundraising costs

20,103	15,696
<u> </u>	<u> </u>

6 Expenditure on charitable activities

Charitable activities	Charitable activities
2025	2024
£	£

Direct costs

Staff costs

684,758	582,236
---------	---------

Depreciation and impairment

27,681	26,598
--------	--------

Establishment costs

153,722	110,698
---------	---------

Direct cost of activities

124,450	158,573
<u> </u>	<u> </u>

990,611	878,105
---------	---------

Share of support and governance costs (see note 7)

Governance

2,500	920
<u> </u>	<u> </u>

993,111	879,025
<u> </u>	<u> </u>

Analysis by fund

Unrestricted funds

612,579	479,249
---------	---------

Restricted funds

380,532	399,776
<u> </u>	<u> </u>

993,111	879,025
<u> </u>	<u> </u>

7 Support costs allocated to activities

2025	2024
£	£

Governance costs

2,500	920
<u> </u>	<u> </u>

Analysed between:

Charitable activities

2,500	920
<u> </u>	<u> </u>

Notes to the financial statements for the year ending 31st March 2025 (continued).

8 Net movement in funds	2025	2024
	£	£

The net movement in funds is stated after charging/(crediting):

Fees payable for the independent examination of the charity's financial statements	2,500	920
Depreciation of owned tangible fixed assets	27,681	26,598
	<u> </u>	<u> </u>

9 Trustees

None of the trustees (or any persons connected with them) received any remuneration or benefits from the charity during the year.

10 Employees

The average monthly number of employees during the year was:

2025	2024
Number	Number
32	21
<u> </u>	<u> </u>

Employment costs	2025	2024
	£	£
Wages and salaries	629,396	533,739
Social security costs	43,486	38,966
Other pension costs	11,876	9,531
	<u> </u>	<u> </u>
	684,758	582,236
	<u> </u>	<u> </u>

There were no employees whose annual remuneration was more than £60,000.

Remuneration of key management personnel

Key management personnel comprise the CEO and Operations and Finance Manager whose combined employee benefits totalled £103,837 (2024: £91,325) including pension contributions.

11 Taxation

The charity is exempt from taxation on its activities because all its income is applied for charitable purposes.

Notes to the financial statements for the year ending 31st March 2025 (continued).

12 Tangible fixed assets

	Leasehold improvements and £	Fixtures and fittings £	Total £
Cost			
At 1 April 2024	354,463	103,028	457,491
Additions	-	4,325	4,325
	<u>354,463</u>	<u>107,353</u>	<u>461,816</u>
At 31 March 2025	354,463	107,353	461,816
Depreciation and impairment			
At 1 April 2024	192,326	65,769	258,095
Depreciation charged in the year	14,179	13,502	27,681
	<u>192,326</u>	<u>79,271</u>	<u>285,776</u>
At 31 March 2025	206,505	79,271	285,776
Carrying amount			
At 31 March 2025	<u>147,958</u>	<u>28,082</u>	<u>176,040</u>
At 31 March 2024	<u>162,137</u>	<u>37,259</u>	<u>199,396</u>

13 Debtors

	2025	2024
	£	£
Amounts falling due within one year:		
Trade debtors	64,166	13,881
Prepayments and accrued income	22,509	3,887
	<u>86,675</u>	<u>17,768</u>

14 Creditors: amounts falling due within one year

		2025	2024
	Notes	£	£
Other taxation and social security		11,589	7,764
Deferred income	15	7,092	-
Trade creditors		17,417	22,473
Other creditors		3,024	1,933
Accruals		2,500	920
		<u>41,622</u>	<u>33,090</u>

Notes to the financial statements for the year ending 31st March 2025 (continued).

15 Deferred income

	2025	2024
	£	£
Other deferred income	7,092	-
	<u>7,092</u>	<u>-</u>

Deferred income is included in the financial statements as follows:

	2025	2024
	£	£
Deferred income is included within:		
Current liabilities	7,092	-
	<u>7,092</u>	<u>-</u>
Movements in the year:		
Deferred income at 1 April 2024	-	-
Resources deferred in the year	7,092	-
	<u>7,092</u>	<u>-</u>
Deferred income at 31 March 2025	7,092	-
	<u>7,092</u>	<u>-</u>

16 Retirement benefit schemes

	2025	2024
	£	£
Defined contribution schemes		
Charge to profit or loss in respect of defined contribution schemes	11,876	9,531
	<u>11,876</u>	<u>9,531</u>

The charity operates a defined contribution pension scheme for all qualifying employees. The assets of the scheme are held separately from those of the charity in an independently administered fund.

Notes to the financial statements for the year ending 31st March 2025 (continued).

17 Restricted funds

The restricted funds of the charity comprise the unexpended balances of donations and grants held on trust subject to specific conditions by donors as to how they may be used.

	At 1 April 2024	Incoming resources	Resources expended	At 31 March 2025
	£	£	£	£
Birmingham CC- Early Years SENCO	-	8,840	(8,840)	-
Birmingham CC - Holiday Activity & Food	6,714	95,549	(102,263)	-
Birmingham CC - Neighbourhood Network Scheme	-	6,043	(6,043)	-
Capital assets Funds	111,855	-	(14,179)	97,676
National Lottery CF - SAMHP	30,167	102,480	(107,028)	25,619
Eveson Charitable Trust	-	6,000	(6,000)	-
National Lottery CF - WASH	-	115,176	(86,382)	28,794
Heart of England CF CEF	-	24,825	(24,825)	-
Birmingham CC - Pupil Premium	-	3,508	(3,508)	-
National Lottery CF - Awards for All	-	17,728	(8,864)	8,864
Other grants received	-	12,600	(12,600)	-
	<u>148,736</u>	<u>392,749</u>	<u>(380,532)</u>	<u>160,953</u>

Fund Descriptions

Birmingham City Council -Early Years SENCO: Funding to support nursery provision for those with additional needs.

Birmingham City Council - Holiday Activity & Food: Funding towards free school holiday food and fun activities.

Birmingham City Council - Neighbourhood Network Scheme: funding to engage disabled woman in environmental activities as part of the WASH project.

Capital assets funds: funding towards the capitalised costs of improvements made to the leasehold properties.

National Lottery CF-SAMHP: funding for the South Asian Mental Health Partnership - positive activities, mentoring and parenting support.

National Lottery CF-WASH: Funding for the Washwood Heath Adaption & Sustainability Hub project to engage our local community in nature and climate learning activities.

Heart of England CF CEF: funding to improve the natural environment and access to blue and green space in Ward End Park and improving environmental awareness amongst our local community as part of the WASH project.

Birmingham City Council -Pupil Premium: funding to improve educational outcomes for disadvantaged children accessing our nursery.

Notes to the financial statements for the year ending 31st March 2025 (continued).

17 Restricted funds (continued)

Fund descriptions (continued)

National Lottery CF - Awards for All: funding to train local women at the Dolphin Centre in IT, English Language as a Second Language (ESOL) and employment preparation.

Other grants received - restricted fund grants of under £5,000 value.

Valuing Worth - Rent

The Charity runs its services and activities from two community-based buildings, Norton Hall and The Dolphin Centre. Both buildings are leased from Birmingham City Council on a fully repairing Community Asset Transfer (CAT) lease. The economic rent is offset by a valuing worth exercise, using a social value tool to identify the value of the services provided by the charity, against an economic cost.

18 Unrestricted funds

The unrestricted funds of the charity comprise the unexpended balances of donations and grants which are not subject to specific conditions by donors and grantors as to how they may be used. These include designated funds which have been set aside out of unrestricted funds by the trustees for specific purposes.

	At 1 April 2024	Incoming resources	Resources expended	At 31 March 2025
	£	£	£	£
Designated funds	90,000	-	(10,299)	79,701
General funds	195,273	604,516	(622,383)	177,406
	<u>285,273</u>	<u>604,516</u>	<u>(632,682)</u>	<u>257,107</u>
Previous year:				
	At 1 April 2023	Incoming resources	Resources expended	At 31 March 2024
	£	£	£	£
Designated funds	90,000	-	-	90,000
General funds	148,436	541,782	(494,945)	195,273
	<u>238,436</u>	<u>541,782</u>	<u>(494,945)</u>	<u>285,273</u>

Notes to the financial statements for the year ending 31st March 2025 (continued).

19 Analysis of net assets between funds

	Unrestricted funds 2025 £	Restricted funds 2025 £	Total 2025 £
At 31 March 2025:			
Tangible assets	78,364	97,676	176,040
Current assets/(liabilities)	178,743	63,277	242,020
	<u>257,107</u>	<u>160,953</u>	<u>418,060</u>
	Unrestricted funds 2024 £	Restricted funds 2024 £	Total 2024 £
At 31 March 2024:			
Tangible assets	87,541	111,855	199,396
Current assets/(liabilities)	197,732	36,881	234,613
	<u>285,273</u>	<u>148,736</u>	<u>434,009</u>

20 Related party transactions

There were no disclosable related party transactions during the year (2024 - none).

21 Cash (absorbed by)/generated from operations	2025	2024
	£	£
(Deficit)/surplus for the year	(15,949)	53,325
Adjustments for:		
Depreciation and impairment of tangible fixed assets	27,681	26,598
Movements in working capital:		
(Increase) in debtors	(68,907)	(17,768)
Increase in creditors	1,440	3,795
Increase in deferred income	7,092	-
	<u>(48,643)</u>	<u>65,950</u>
Cash (absorbed by)/generated from operations		

NORTON HALL CHILDREN AND FAMILY CENTRE

England & Wales - Charity number 1112752

Accounts

CC/CH



Norton Hall Children and Family Centre

(A Charitable company, founded in 2006)

Trustees Report and Financial Statements For the year ended 31 March 2024

Charity number 1112752

Company number 05052641



The pictures above show – left – the Dolphin Centre predevelopment, and – right – our newly developed Dolphin Women's Centre. We launched the new Centre with its Lakeside Café in September 2023.

CONTENTS	Pages
Trustees Report for YE24	1-13
Independent Examiner's Report	14
Statement of Financial Activities	15
Balance Sheet	16
Notes forming part of the financial statements	17-23

TRUSTEES REPORT

The Trustees are pleased to present their report and independently examined financial statements for the year ending 31st March 2024, which are also prepared to meet the requirements for a directors' report and accounts for Companies Act purposes.

The financial statements have been prepared in accordance with the accounting policies set out in note 1 to the accounts and comply with the Charity's governing document, applicable law, the Charities Act 2011, the Companies Act 2006, and the requirements of the Statement of Recommended Practice, "Accounting and Reporting by Charities" (SORP) issued in March 2005.

REFERENCE AND ADMINISTRATIVE INFORMATION

Charity name:	Norton Hall Children and Family Centre
Charity registration number:	1112752
Company registration number:	05052641
Registered Office:	Ralph Road, Saltley, BIRMINGHAM B8 1NA.

Trustees

› Ms Wendy Kerr	Chair	Appointed April 2015
› Mr Iftikar Karim	Secretary	Appointed December 2004
› Ms Ghazala Parveen		Appointed September 2015
› Mr John Freeman		Appointed February 2004
› Ms Maryam Khan		Appointed April 2015

Secretary

Mr Iftikar Karim

Chief Executive Officer

Suzanne Knipe

Bankers

Unity Bank,
9 Brindley Place, Birmingham B1 2HB

Independent Examiner

P & W Social Accountants
The Barn, 173 Church Road, Northfield, Birmingham B31 2LX.

CHAIR'S REVIEW

I am very proud to present my summary of this year's report for the Norton Hall Children and Family Centre. Our operations include the Dolphin Women's Centre in Ward End Park.

Once again this has been a very busy and eventful year, as our charity has continued to support some of the most vulnerable and disadvantaged women, children, and families in East Birmingham.

In total across both Centres, we helped over 1,600 local women, children, and young people to improve their wellbeing and life chances.

Four in five of the families we supported last year are on low incomes, and we have seen a continuing increase in demand in people seeking advice and support, particularly with debt and financial distress.

Our Winter food project was a lifeline to many of our families, and this year we were able to more than double food provision – food parcels and hot meals for children and women attending our Centres - compared to last year.

At Norton Hall we provided preschool education, positive activities and mentoring support for almost 540 local children aged 2-16. Our after school and holiday activities provided free childcare to many parents struggling with the cost-of-living crisis, enabling them to remain in employment.

In July we launched a new three-year phase of our Starfish project, using mentoring support and positive activities to improve children's coping strategies, wellbeing and relationships. In parallel the project is working with parents to equip them to support their child's mental health, and to improve their wellbeing.

At the Dolphin Centre we completed a major redevelopment of the building and its grounds in Ward End Park and opened for business in September 2023, supporting almost 840 local women across the year.

This included opening our new Lakeside community Café for business. We are developing the Café as a social enterprise: providing training, employment and volunteering opportunities for local women, whilst providing Café facilities for centre visitors and local families to enjoy within the local park. Any surplus income generated will be used to fund services offered at the Centre.

Developments at the Dolphin Centre have increased our establishment costs significantly.

However, excluding fundraising and governance costs, 95p in every £1 was spent directly supporting our community. This includes the premises costs of the buildings in which our activities are delivered. Whilst we grew our income to almost £950k, we spent almost £900k, leaving us with just over two months free reserves in relation to our year ending 2025 budget.

We would like to thank all our partners and funders for their much-valued support throughout this year. Your support is needed now more than ever as we set out to realise the ambitious plans we have for both centres.

Finally, a big thank you to my fellow Trustees, and our dedicated staff and volunteer teams, whose hard work provides an invaluable service to the community.

Ms Wendy Kerr

Chair of Trustees

OBJECTIVES

Background

Whilst established in its current form in 2006, the charity has a 50-year track record of community-based service delivery. Since 2013, our operations include running the Dolphin Women's Centre in Ward End Park. Our mission is to support local children, young people, and women to overcome disadvantage.

Charitable objectives

The objects of the charity, as set out in its Memorandum of Association are:

1. To relieve poverty and advance health and education in the City of Birmingham, and to address the needs of disadvantaged women, children and young people in the Hodge Hill, Ladywood and Small Heath constituencies, by providing:
 - a. a community nursery, provision for out of school childcare, and promoting the development of childcare provision aimed at meeting the needs of low-income families.
 - b. holiday play schemes and other children's play provision.
 - c. support and provision for young people, including youth work with girls and young women.
 - d. opportunities for education, training and personal development.
 - e. support for the economic advancement of women, including supporting women into employment and enterprise.
- f. such further facilities as may be beneficial for the wider community in the area of benefit.
2. To promote and organise co-operation in the achievement of the above purposes.



These are two of our nursery children.

ACHIEVEMENTS AND PERFORMANCE

We support our local community in the Ward End and Alum Rock areas of East Birmingham in Hodge Hill constituency whose wards are all in England's 10% 'most deprived'. Our community has a high proportion of BAME residents, mainly of Pakistani heritage.

96% of the children we supported at Norton Hall were of BAME heritage and four in five were from families facing economic hardship. Of the women we supported at the Dolphin Centre, two in five were lone parents, 59% were long term unemployed and almost 70% had limited or no English Language skills.

Our community has really struggled with the cost-of-living crisis over the last year, and we have grown our capacity in response. Overall, across both Centres we supported over 1,600 local women, children, and young people to improve their wellbeing and life chances.

We thank our staff, volunteers, and Trustees who – through their hard work and dedication - have enabled us again this year to respond to the increase in demand for our services. We also thank our partners – whose expertise enhanced and broadened the support we could offer to our community.

Winter food project

Post pandemic we initiated a food project, giving food parcels to families we knew were really struggling with their finances. This project – spanning both Centres – has grown, and in response to demand we were able to more than double food provision compared to last year. We provided:

- › Almost 2,200 food parcels to families attending our centres.
- › Nearly a 1,000 community lunches in our Lakeside Café to c.300 women attending the Dolphin Centre.
- › Almost 1,900 lunches at Norton Hall for over 450 children attending our holiday / after school activities.
- › We also provided 30 of our most vulnerable families with a Winter Food parcel to the value of £75.00 each to help them cope over the Christmas period.

Families supported were very appreciative, many were on the verge of poverty and desperately needed support. Having a full stomach helped them undertake daily tasks, and the food support meant they could pay other bills; it helped their children to concentrate, learn and improve their behaviour.

Having the conversation about not having enough food (or being reliant on food parcels) gave our staff an opportunity to be able to talk openly about other forms of support. We signposted many families who needed additional support to local food banks, housing support organisations, Job Centre plus advisors, family support teams and other local organisations.

Feedback from families

"I cannot tell you how much this has helped me. I was so stressed about Christmas and how I was going to be able to afford food for us all. I have been trying to cut down on what I was planning to get which has really made me feel like a bad mom. You do not know how much this is going to help me and my children."

Norton Hall – our work with children, young people and families

Our work at Norton Hall provides parents with all year round after school and holiday childcare which is either free or provided at a low cost. 62 children of working parents on low incomes benefited from after school childcare this year. We also supported parents to repair family relationships through our Starfish project.

During the year we provided early years education for 63 children aged 2 -5. We also engaged 474 children aged 5- 16 in a range of positive activities and mentoring support. Finally – with the help of partners - we supported 135 parents struggling with parental challenges.

Sunflower community nursery

At our Nursery we provide pre-school education for local children whose educational starting point in life is significantly lower than the national average. Our OFSTED rating remains 'GOOD'.

This year we enhanced our learning framework by introducing a 'numeracy programme' (counting collecting) to complement our 'accelerated communication and language programme'.

80 % of the children we supported had English as an additional language.

Our new learning framework has ensured that they have the numeracy alongside the literacy skills they need for starting school.

We have also continued to be a proactive partner in the local 'stronger practice hub' part of the DFE Covid recovery programme for Early Years Providers.



Children & Young People

We support some of the most vulnerable and disadvantaged children and young people in our community to improve their emotional wellbeing and gain confidence to navigate and manage their often difficult and challenging life circumstances.

We supported over 470 children this year, of whom 57% had special educational needs and / or disabilities.

Positive activities

Most of the children we look after engage in what we call 'positive activities' - Sports, Arts, Drama, Forest School and social activities, enabling them to gain interests and skills and develop confidence.

412 children and young people participated after school and during evenings, weekends and school holidays in our busy programme, and the numbers accessing our evening activities expanded.

Working with partners we delivered a range of educational workshops, on subjects and issues that affect our young people the most.

These included workshops on gangs and knife crime, positive and healthy relationships, and practical first aid skills led by expert speakers.

The re opening of the Dolphin Centre with its Forest School area - an oasis of nature providing outdoor facilities for therapeutic play and learning - enabled us to expand our Forest School and Bushcraft activities. 181 children and young people deepened their connection to nature at the Forest School, gaining new skills in Bushcraft, developing confidence and gaining new environmental knowledge.

Starfish project

Thanks to increased funding, Starfish began a new three-year phase in July. Across three years we aim to provide bespoke early intervention support for 210 young people.

This year we exceeded the first-year target, supporting 74 young people aged 10-14, mainly through one to one and group mentoring. The aim is to help them improve their behaviour, wellbeing, engagement in school and family relations.

Children are selected to join whose behavioural issues are putting them at risk of being a danger to themselves and others, resulting in poor life chances due to - e.g., being excluded from education. They are supported by our youth team, as well as young leader volunteers.

These are local young people who we engage as volunteers to lead activity sessions. Close in age, they provide peer support and act as role models for our young people.



Children engaged in a dance with the Dragon they made at an arts session.



Children toasting marshmallows on the fire they helped create at forest school.

Via a partnership with Family Action, Starfish also supported 135 of the children's parents and / or caregivers. Their parents are engaged if their stress levels and worsening relationship with their child could result in family breakdown.

They are supported with advice and signposting on a 1:1 basis and / or in groups with wellbeing activities. Those that need the most support engage in our 10-week 'Understanding your Child's Behaviour' course, where they develop skills like effective behaviour management.

This year we delivered one cycle of this course and will use learnings to improve delivery next year.

Outcomes and feedback on our work with children and young people.

The chart shows early results from our Starfish project, which had been running for 9 months in March 2024.

We survey children at the start and end of their involvement with Starfish. We use a Strengths & Difficulties (SDQ) assessment tool with 25 question areas.

It covers emotions, concentration, behaviour and being able to get on with other people.

Each child's teacher and parent / caregiver completes the SDQ so that the combined scores reflect an 'in the round' assessment of what the child is like in each environment, before and after the programme.

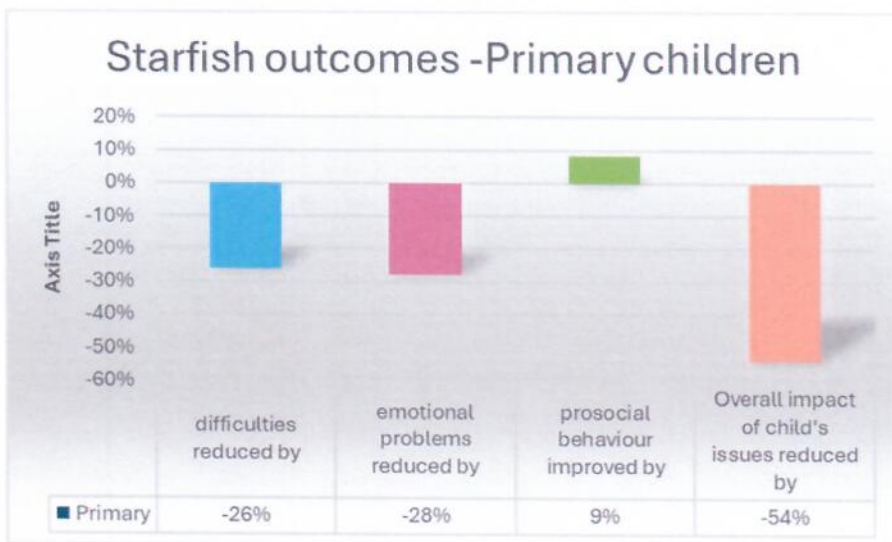

We collected 'pre' and 'post' scores from 30 of the 36 children participating.

The results show the average change from the start to the end of the mentoring programme in the children's behaviours and difficulties. The 25 questions are mapped to four categories and analysed. The average results across two cohorts are shown in the above graph. We achieved a:

- > 26% reduction in difficulties, such as their ability to concentrate in school.
- > 28% reduction in emotional problems, such as losing their temper or being very anxious.
- > 9% improvement in pro social behaviour, such as being kind to others and having friends.
- > A reduction of 54% in terms of the overall impact of the child's difficulties and behaviours on the people around them - at home, at school – as well as on the young person themselves.

Schools feedback

"D' had very low self-esteem and found it difficult to talk about his emotions. Since being supported by Starfish D is a lot happier than before. He is more able to manage and express his emotions and less likely to be argumentative and aggressive to others.

"School staff and parents have seen a drastic change in D's overall mental health and wellbeing as well as his behaviour." **Headteacher**

"R' is much calmer and less anxious. We have seen an improvement in his academic attainment since he joined Starfish." **Pastoral Lead**

Parent feedback

"The Starfish project is wanted and needed for children like mine who suffer from low self-esteem and confidence. My son has completely changed his attitude towards school and is now more engaged in his learning."

"H seems more joyful and happier than she used to be. She can explain her point of view more logically and follows it up with strong reasons (why she wants to do it etc). She started making right choices and doesn't take risks without assessing them or thinking about what she is doing. She has less tantrums or meltdowns now. Thank you everybody in your team who has helped my child."

Dolphin Women's Centre

In a major milestone we completed the redevelopment of the building and its grounds in Ward End Park and opened for business in September 2023. We supported over 1,000 women with information, advice and guidance and signposting to local services and activities and almost 840 of these went on to access our services at the Dolphin Centre.

Training and employability support

We offer local women opportunities to gain work experience and receive training in a range of areas including hospitality, horticulture, administration, IT and English language skills.

We are proud to report that, despite the upheaval caused by the project, we provided education, training, employment, health and wellbeing support for 1,004 women during the year.

Of the women we supported 94% were from BAME communities, 83% were in receipt of benefits and on low incomes. 38 % were lone parents, 59% were long term unemployed and 69% had no or very poor English Language skills.

The picture on the right shows two women at their end of training course, receiving their certificates.



We opened the doors to our new lakeside Café with its outdoor kiosk in September and have since been gradually developing what we offer and how we run it. Park visitors are so pleased that they can now enjoy a coffee and cake when they visit the park and the feedback from local people has been really positive.

The Café also caters to Centre visitors, including buffet lunches for training providers who rent rooms at the Centre. The team also prepare meals for children at nearby Norton Hall and in the Winter they provide regular community lunches as part of our Winter food project. Four local women are employed on a part time basis at the Café, alongside local women gaining work experience as volunteers and participating in a range of training opportunities linked to employment in the hospitality sector.

Volunteer feedback

Environmental programme

This year we continued to collaborate with the Friends of Ward End Park on activities within our forest school area, our community allotments and the wider Park.

We engaged and supported an additional 10 regular local volunteers in a wide range of environmental activities including growing vegetables, planting flowers, gardening, and group litter picks within the park.

We trained eight local people as level 3 Forest School Leaders, so that they can engage more people across Birmingham in outdoor learning, developing their connection to nature.

This year we also developed an Outdoor Environmental Learning Programme in partnership with the Heart of Birmingham Vocational College. So far six learning disabled young women participated in the programme, gaining environmental skills and confidence. We hope to extend this programme next year.

Outcomes

The picture below shows a group of women attending their end of training celebrations.

Of the women we supported this year...

185 improved their English language skills

64 gained basic education and vocational qualifications

148 improved their employability skills through our employment support programme

14 got jobs after accessing our employability support.

16 gained work experience through our volunteering and work experience activities



Case study

'M' came to the Dolphin Centre in 2021.

An unemployed mother of two school age children, M needed help and support to find employment, but she had very low self-confidence and self-esteem.

We supported her to gain work experience as a volunteer, supporting the busy reception team, as well as attending further education and training opportunities in our Training suite at the Centre.

As her self-confidence and skills increased, she began to provide mentoring support to other women who had little or poor English skills.

After two years M had gained the self-confidence and skills she needed to be able to progress to a further education college, where she was able to gain her teaching certificate.

She has now gained employment as an ESOL teacher and is teaching and inspiring other women in our community.

FUTURE PLANS

Trustees have reviewed the financial position of the charity over the next 12 months which has included a review of the budget for the coming year (YE25) and anticipated funding into YE26.

We aim to build reserves again over the next year and have set an income target that is higher than our planned spend to help us realise this goal.

Our plans for the coming year at Norton Hall in our work with children and families include getting all of our Mentors trained in Trauma Informed Schools UK training to enhance their skills. In response to high demand, we will expand our parenting support programme which is proving to be effective in improving family relationships.

The fabric of the building at Norton Hall needs strengthening to and made more energy efficient. Funding dependent, we aim to implement the recommendations of an independent energy assessment over the next few years to make it more fit for the future.

Our plans for the Dolphin centre include opening our Café and its outside kiosk at weekends in addition to Monday – Friday. We want to create a new Terrace allotment in an unused space and expand our community allotments to grow produce for our Café.

We run the Lakeside Cafe as a social enterprise and hope for it to be self-sustaining longer term. In the meantime, we will continue to develop our programme of English, IT, employability, horticultural and environmental training and work experience opportunities at the Centre.

We have grown quickly over the last few years, so in the coming year we will need to review our infrastructure, which may result in increasing capacity within our management team which will help with consolidation of new projects and services.

FINANCIAL REVIEW

The Trustees agreed a budget for the year with three main cost centres: 1. The Sunflower Nursery; 2. Children and Young Peoples Services; and 3. The Dolphin Women's Centre.

The Income and Expenditure Account shows total incoming resources for the year ending 31st March 2024 (YE24) of £948,046 (an increase of 30% on YE23- £729,792).

Resources expended increased by 23% to £894,721 (YE23: £729,748), which left a net surplus of £53,325 (YE23: £44 surplus). Total net assets at the year-end amounted to £434,009 (YE23: £380,684) of which £148,736 was restricted funds (YE23 £142,249).

95% of our expenditure was spent on directly supporting beneficiaries: 65% on the salaries of our expert team, 18% on activity costs, and 12% on premises and management costs across our two Centres. 2% was spent on fundraising for voluntary income and 3% on governance.

Reserves policy and position

Due to uncertainties and the short-term nature of much of the charity's funding, the Trustees policy is to hold sufficient reserves in the Unrestricted Fund (free reserves) to allow it to operate for a period of 3-6 months in the coming budget year.

The free reserves position as at 31st March 2024 was £195,273, which equated to just over two months of the YE25 budget of £1m. Designated funds of £90,000 are held to cover possible redundancies and ongoing building maintenance. This policy is reviewed annually by Trustees.

Income generation

The charity has limited assets and its primary source of funding (73% in YE24) was charitable activities income sourced through partnerships with other charities, local authorities and schools, with the remainder Trusts and Lottery and donations from individuals. Where grants are given for specific purposes, they are treated as Restricted Funds. In YE24, there was c.£406k of restricted grants (detailed at Note 2) and tracking and managing these funds is part of the charity's financial management.

Acknowledgements

We would like to thank all our partners for their much-valued support throughout this year, including Birmingham City Council Landscape Practice Group, The Friends of Ward End Park, Family Action, The Childrens Society, Birmingham Education Partnership, 26 local schools, Birmingham Adult Education Service, The Pioneer Group, local Family Support Teams and Safeguarding Hubs, Workers Education Association, Jobcentre Plus, Midland MENCAP, Birmingham MIND, Birmingham Healthy Minds, Disability Resource Centre, Sampad, Salt Road, Spurgeons, Children's Quarter & Ways for Wellbeing CIC.

Also, a special thank you to our funders: the National Lottery Community Fund, Birmingham City Council, and the CB & HH Taylor 1984 Trust, Dumbreck Charity, Edward & Dorothy Cadbury Trust, Eveson Charitable Trust, G.E. GEE Trust, Garfield Weston Foundation, GJW Turner Trust, Gosling Foundation, Grimmitt Trust, Millie's Watch, Roger and Douglas Turner Charitable Trust, Rowlands Trust, Society of the Holy Child Jesus, School for Social Entrepreneurs, Sport Birmingham, Souter Charitable Trust, St Thomas's Dole Charity, W E Dunn Trust.

A big thank you to our dedicated staff team staff whose hard work provides a valuable service to the community. Thank you to our Trustees, who give their time and expertise on a voluntary basis. Finally, a huge thank you to our team of dedicated local volunteers, who give their time to support the day-to-day work of the charity.

STRUCTURE, GOVERNANCE AND MANAGEMENT

Governing document

The charitable company is constituted as a not for profit Company Limited by Guarantee having no share capital. It is also a charity registered with the Charity Commission.

The charity is governed by its Memorandum and Articles of Association, and the policies made from time to time by its Directors, who are also the Trustees of the charity.

Trustees are elected at the AGM, with one third standing down each year. They have the power to co-opt up to three further Trustees, and at least 60% must be women. We are currently recruiting for a new Treasurer.

Responsibilities of the Trustees

Company law requires the Trustees to prepare financial statements for each financial year which give a true and fair view of the state of affairs of the charitable company as at the balance sheet date and of its incoming resources and application of resources, including income and expenditure, for the financial period. In preparing those financial statements, the Trustees should follow best practice and:

- › select suitable accounting policies and then apply them consistently.
- › make judgements and estimates that are reasonable and prudent; and,
- › prepare the financial statements on the going concern basis unless it is inappropriate to assume that the charity will continue on that basis.

The Trustees are responsible for maintaining proper accounting records which disclose with reasonable accuracy at any time the financial position of the charitable company and to enable them to comply with the Companies Act 2006. The Trustees are also responsible for safeguarding the assets of the charity and hence for taking steps for the prevention and detection of fraud and other regularities. The Trustees who served during the period under review and up to the date of this report are set out on page 2.

Risk management

The Trustees have assessed risks to which the charity is exposed and are satisfied that systems are in place to mitigate our exposure to the major risks. Trustees are confident that sufficient funding will be available to continue to run the charity for the next 12 months and have contingency plans in place to deal with a shortfall in funding within one or more of its current activities.

Management structure and staffing

The day-to-day financial management is devolved to the Chief Executive - Suzanne Knipe. The Board receives quarterly management accounts, showing the actual performance compared to budget.

We have a culturally diverse staff team, balanced in age and gender. Many of our staff live locally and some are 'home grown', starting with us as volunteer young leaders. Our qualified and experienced team have a wide range of complementary skills and qualifications.

These include Youth Work and academic qualifications in for example, Play Work and Mentoring Qualifications (to Level 2 or 3), Therapeutic Counselling, Psychology, 'Trauma Informed Practice' and Drawing and Talking Therapy.

During the year we gained new employees in our Café – all local women – however the management and staff team remained otherwise the same.

Public benefit

The Trustees, having considered section 4 of the Charities Act 2006, have satisfied themselves that they have complied with the duty to have regard to the Public Benefit guidance published by the Charity Commission.

The activities and achievements of the charity are outlined in this Report and the Trustees believe, demonstrate that charity is providing public benefit.

Independent examination

The Trustees have appointed P&W Social Accountants to undertake this role. This report has been prepared in accordance with the special provisions of Part 15 of the Companies Act 2006 relating to small companies.

Approved by the Trustees and signed on their behalf by:

A handwritten signature in black ink, appearing to read 'I. Karim', written in a cursive style.

Mr Iftikar Karim, Secretary

16th June 2024

INDEPENDENT EXAMINER'S REPORT

I report to the Trustees on my examination of the accounts of the charitable company for the year ended 31 March 2024.

Responsibilities and basis of report

As the charitable company's Trustees (also its directors for the purposes of company law) you are responsible for the preparation of the accounts in accordance with the requirements of the Companies Act 2006 ('the 2006 Act').

I have satisfied myself that the accounts of the charitable company are not required to be audited under Part 16 of the 2006 Act and are eligible for independent examination. I report in respect of my examination of your charity's accounts as carried out under section 145 of the Charities Act 2011 ('the 2011 Act'). In carrying out my examination I have followed the Directions given by the Charity Commission under section 145(5)(b) of the 2011 Act.

Independent Examiner's statement

Since the Company's gross income exceeded £250,000 your examiner must be a member of a body listed in section 145 of the Act. I can confirm that I am qualified to undertake the examination because I am a member of the Institute of Chartered Accountants in England & Wales, which is one of the listed bodies.

I have completed my examination. I can confirm that no matters have come to my attention in connection with the examination giving me cause to believe that:

1. Accounting records were not kept in respect of the Company as required by section 386 of the 2006 Act; or that,
2. The accounts do not accord with those records; or that,
3. The accounts do not comply with the accounting requirements of section 396 of the 2006 Act, other than any requirement that the accounts give a 'true and fair' view which is not a matter considered as part of an independent examination; or that,
4. The accounts have not been prepared in accordance with the methods and principles of the Statement of Recommended Practice for accounting and reporting by charities, applicable to charities preparing their accounts in accordance with the Financial Reporting Standard applicable in the UK and Republic of Ireland (FRS102).

I have no concerns and have come across no other matters in connection with the examination to which attention should be drawn in this report in order to enable a proper understanding of the accounts to be reached.

Signed by:

Date of signature:



16/06/2024

P & W Social Accountants

The Barn, 173 Church Road,
Northfield, Birmingham B31 2LX

FINANCIAL STATEMENTS FOR THE YEAR ENDING 31 MARCH 2024

Statement of Financial Activities (incorporating an Income and Expenditure Account)

	Notes	Unrestricted Funds £	Designated Funds £	Restricted Funds	2024 Total Funds £	2023 Total Funds £
INCOME FROM:						
Voluntary income	2	52,092	0	207,029	259,121	74,323
Charitable activities	3	489,690	0	199,235	688,925	655,470
TOTAL INCOME		541,782	0	406,264	948,046	729,793
EXPENDITURE ON:						
Raising voluntary income	4	15,696	0	0	15,696	14,114
Charitable Activities	4	479,249	0	399,776	879,025	715,634
TOTAL EXPENDITURE		494,945	0	399,776	894,721	729,748
NET INCOME/(EXPENDITURE)		46,837	0	6,488	53,325	45
Transfers between funds		0	0	0	0	0
NET MOVEMENT IN FUNDS		46,837	0	6,488	53,325	45
RECONCILIATION OF FUNDS:						
Total funds brought forward		148,436	90,000	142,248	380,684	313,687
TOTAL FUNDS CARRIED FORWARD		195,273	90,000	148,736	434,009	313,733

The statement of financial activities includes all gains and losses recognised in the year.
All income and expenditure derive from continuing activities.

Balance Sheet as at 31st March 2024

	Notes	2024 £	2023 £
FIXED ASSETS			
Tangible assets	6	199,396	176,316
CURRENT ASSETS			
Debtors & prepayments	7	17,768	43,249
Cash at bank & in hand		249,935	190,414
		267,703	233,663
CREDITORS			
Amounts falling due within one year	8	33,090	29,295
NET CURRENT ASSETS		234,613	204,368
NET ASSETS		434,009	380,684
FUNDS OF THE CHARITY			
	10		
Unrestricted funds		195,273	148,436
Designated funds		90,000	90,000
Restricted funds		148,736	142,248
TOTAL FUNDS		434,009	380,684

For the year ending 31.03.2024, the Charity was entitled to exemption from audit under section 477 . of the Companies Act 2006 relating to small companies

Director's responsibilities:

The members have not required the company to obtain an audit of its accounts for the year in question in accordance with section 476 of the Companies Act 2006. However, in accordance with Section 145 of the Charities Act 2011, the financial statements have been examined by an Independent Examiner, whose report is included in these accounts. The directors acknowledge their responsibilities for complying with the requirements of the Companies Act 2006 with respect to accounting records and preparation. These accounts have been prepared in accordance with the provisions applicable to companies subject to the small companies regime.

Signed on Behalf of the Board:

Approved by the Board on



Mr Iftikar Karim, Secretary

Date: 16th June 2024

The notes on the following pages form part of the financial statements

Notes to the Financial statements

Note

1. ACCOUNTING POLICIES

Basis of preparation

The financial statements have been prepared in accordance with Accounting and Reporting by Charities: Statement of Recommended Practice applicable to charities preparing their accounts in accordance with the Financial Reporting Standard applicable in the UK and Republic of Ireland (FRS102)(effective 1 January 2019) - (Charities SORP (FRS102)), the Financial Reporting Standard applicable in the UK and Republic of Ireland (FRS102) and the Companies Act 2006.

Norton Hall Children and Family Centre meets the definition of a public benefit entity under FRS102. Assets and liabilities are initially recognised at historical cost or transaction value unless otherwise stated in the relevant accounting policy note(s). The Charity Commission's guidance on public benefit organisations supports the conclusion that Norton Hall Children and Family Centre is a public benefit entity.

The reporting currency is £ Sterling.

Preparation of the accounts on a going concern basis

The financial statements have been prepared on a going concern basis which assumes that the Company will continue to operate. The validity of this assumption is dependent upon the continuance of support from the Company's key funders and in response to the progress made by the Company in pursuing a viable budget including the obtaining of further grants and other funds. The Company's current business plan shows that the Company will be able to operate in the foreseeable future. Based on this understanding, the directors believe that it remains appropriate to prepare the financial statements on a going concern basis. The financial statements do not include any adjustments which would result from the basis of preparation being inappropriate.

Tangible fixed assets

Depreciation is provided at the following annual rates in order to write off each asset over its estimated useful life (assets with a cost below £1,000 are not capitalised) :

Fixtures, fittings & equipment
Improvements to property

Income

Items of income are recognised and included in the accounts when all of the following criteria are met:

- The charity has entitlement to the funds;
- any performance conditions attached to the item(s) of income have been met or are fully within the control of the charity;
- there is sufficient certainty that receipt of the income is considered probable; and
- the amount can be measured reliably.

Expenditure

Expenditure is recognised once there is a legal or constructive obligation to make a payment to a third party, it is probable that settlement will be required and the amount of the obligation can be measured reliably.

Expenditure is classified under the following activity headings:

Taxation

The charity is exempt from corporation tax on its charitable activities.

Fund Accounting

Unrestricted Funds can be used in accordance with the charitable objectives at the discretion of the trustees.

Restricted funds can only be used for the particular restricted purposes within the objects of the charity.

Restrictions arise when specified by the donor or when funds are raised for a particular restricted purpose.

Further explanation of the nature and purpose of each fund is included in the notes to the financial statements.

Debtors

Trade and other debtors are recognised at the settlement amount due after any trade discount offered.

Prepayments are valued at the amount prepaid after taking account of any trade discounts due.

Cash at bank and in hand

Cash at bank and cash in hand includes cash and short term highly liquid investments with a short maturity of three months or less from the date of acquisition or opening of the deposit or similar account.

Creditors and provisions

Creditors and provisions are recognised where the charity has a present obligation resulting from a past event that will probably result in the transfer of funds to a third party and the amount due to settle the obligation can be measured or estimated reliably. Creditors and provisions are normally recognised at their settlement amount after allowing for any trade discounts due.

Pension costs

The Company operates a money purchase pension scheme for employees. Employer contributions are charged as an expense in the period to which they relate and are allocated to activities in line with the related salary cost.

Notes 2 & 3

2. VOLUNTARY INCOME	2024	2023
	£	£
Donations	20,092	59,744
Grants received - Restricted		
Eveson Charitable Trust	5,000	0
Gosling Foundation	5,000	0
Millie's Watch	15,000	0
National Lottery CF - Cost of Living	44,875	0
National Lottery CF - SAYMPH	118,554	0
Society of the Holy Child Jesus	10,000	0
Sport Birmingham - Together Fund	0	9,579
Other grants received	8,600	0
	207,029	9,579
Grants received - Unrestricted		
Garfield Weston Foundation	20,000	0
Roger & Douglas Turner Charitable Trust	5,000	5,000
Other grants received	7,000	0
	32,000	5,000
Total voluntary income	259,121	74,323
3. INCOME FROM CHARITABLE ACTIVITIES	2024	2023
Public sector contracts and grants		
Birmingham CC - Building Development	0	12,500
Birmingham CC - Early Years SENCO	9,624	12,930
Birmingham CC - Holiday Activity & Food	133,450	126,565
Birmingham CC - Neighbourhood Network Scheme	0	4,960
Birmingham CC - Neighbourhood Development Support Unit	4,950	2,500
Birmingham CC - Pupil Premium	0	1,935
Birmingham CC - Valuing Worth Norton Hall	26,211	26,211
Birmingham CC - Valuing Worth Dolphin Centre	25,000	25,000
Total public sector contracts & grants	199,235	212,601
Income from fees and trading		
Norton Hall - Nursery	140,141	128,381
Norton Hall - Children and Young People	260,080	281,325
Dolphin Women's Centre	74,943	33,163
Environmental	4,825	0
Lakeside Café	9,701	0
Total fees and trading	489,690	442,869
Total Charitable Activities Income	688,925	655,470

Notes 4 & 5

4. EXPENDITURE	2024	2023
Charitable		
Activities:	£	£
Establishment costs	110,698	99,494
Staff costs	582,236	500,809
Direct cost of activities	158,573	100,184
Depreciation	26,598	14,179
FutureBuilders loan interest	0	88
Independent Examiner's Fee	920	880
Finance costs	0	0
	879,025	715,634
Raising funds:		
Fundraiser	15,696	10,220
Other direct costs	0	800
External support	0	3,094
	15,696	14,114
Total expenditure	894,721	729,748

5. STAFF COSTS, TRUSTEES REMUNERATION AND EXPENSES

There were no trustees remuneration or other benefits for the year ended 31st March 2024 nor for the year ended 31st March 2023.

£38 of expenses was paid to one Trustee reimbursing traveling expenses (2023: £Nil).

STAFF COSTS	2024	2023
	£	£
Wages and salaries	533,739	468,345
Employer costs - National Insurance	38,966	34,388
Pension costs	9,531	8,296
Agency staff fees		
	582,236	511,029

The average number of full-time equivalent employees during the year was:

21	18
----	----

No employees had emoluments in excess of £60,000 (2023: nil).

Key management personnel comprise the CEO and Operations and Finance Manager whose combined employee benefits totalled £91,325 (2023: £81,582) including pension contributions.

Notes 6-9

6. TANGIBLE FIXED ASSETS	Leasehold etc £	Fixtures, fittings, equip £	Total
Costs			
As at 31st March 2023	354,463	53,350	407,813
Additions	0	49,678	0
At 31 March 2024	354,463	103,028	457,491
Depreciation			
As at 31st March 2023	178,147	53,350	231,497
Charge for the year	14,179	12,419	26,598
At 31 March 2024	192,326	65,769	258,095
Net Book Value			
31st March 2024	162,137	37,259	199,396
31st March 2023	176,316	0	176,316

7. DEBTORS: AMOUNTS FALLING DUE WITHIN ONE YEAR

	2024 £	2023 £
Trade Debtors	13,881	38,869
Prepayments	3,887	4,380
	17,768	43,249

8. CREDITORS: AMOUNTS FALLING DUE WITHIN ONE YEAR

	2024 £	2023 £
Trade Creditors	22,473	18,492
Tax and social security	7,764	8,107
Pensions	1,933	1,816
Accrued expenses	920	880
	33,090	29,295

9. ANALYSIS OF NET ASSETS BETWEEN FUNDS

	Unrestricted Funds £	Restricted Funds £	Designated Funds £	2024 Total Funds £	2023 Total Funds £
Fixed Assets	87,541	111,855	0	199,396	176,316
Net Current Assets	107,732	36,881	90,000	234,613	204,368
	195,273	148,736	90,000	434,009	380,684

Notes 10-12

10. FUNDS	Opening balance	Income	Expenditure	Transfers	Balance
	£	£	£	£	£
General Fund	148,436	541,782	494,945	0	195,273
Designated Fund - Maintenance & Redundancy Reserve	90,000	0	0	0	90,000
Restricted Funds					
Birmingham CC - Early Years SENCO	0	9,624	9,624	0	0
Birmingham CC - Holiday Activity & Food	0	133,450	126,736	0	6,714
Birmingham CC - Neighbourhood Network Scheme	2,500	0	2,500	0	0
Birmingham CC - Neighbourhood Dev Support Unit	4,136	4,950	9,086	0	0
Birmingham CC - Valuing Worth Norton Hall	0	26,211	26,211	0	0
Birmingham CC - Valuing Worth Dolphin Centre	0	25,000	25,000	0	0
Capital assets funds	126,034	0	14,179	0	111,855
National Lottery CF - Cost of Living	0	44,875	44,875	0	0
Sport Birmingham - Together Fund	9,578	0	9,578	0	0
National Lottery CF - SAYMPH	0	118,554	88,387	0	30,167
Eveson Charitable Trust	0	5,000	5,000	0	0
Gosling Foundation	0	5,000	5,000	0	0
Millie's Watch	0	15,000	15,000	0	0
Society of the Holy Child Jesus	0	10,000	10,000	0	0
Other grants received	0	8,600	8,600	0	0
Total Restricted Funds	142,248	406,264	399,776	0	148,736
Total Funds	380,684	948,046	894,721	0	434,009

Fund Descriptions

Birmingham CC - Early Years SENCO: funding to support nursery provision for those with additional needs.
 Birmingham CC - Holiday Activity & Food: funding towards free school holiday food and fun activities.
 Birmingham CC - Neighbourhood Network Scheme: funding to deliver basic English classes to women.
 Birmingham CC - Neighbourhood Development Support Unit: funding towards increased utilities costs.
 Birmingham CC - Valuing Worth Norton Hall: funding to offset the rent of properties used by the charity.
 Birmingham CC - Valuing Worth Dolphin Centre: funding to offset the rent of properties used by the charity.
 Capital assets funds: funding towards the capitalised costs of improvements made to the leasehold properties.
 National Lottery CF - Cost of Living: funding towards our Winter Food project
 Sport Birmingham - Together Fund: funding for children's sport and activity.
 National Lottery CF - SAYMPH: funding for positive activities, mentoring and parenting support
 Eveson Charitable Trust - Towards our Positive Activities work with children at Norton Hall
 Gosling Foundation - Towards our Positive Activities work with children at Norton Hall
 Millie's Watch - Towards our work with children at Norton Hall including Forest School
 Society of the Holy Child Jesus - Towards our work at the Dolphin Centre
 Other grants received - restricted funds all under £5,000

11. COMMITMENTS

The total of future minimum lease payments under non- cancellable operating leases are:
 Within one year - £1,738 (£1,210 comparative)
 Between one and five years - £0 (£907 comparative)

12. RELATED PARTY TRANSACTIONS

There were no transactions with related parties during the year or previous year that require disclosure in these accounts.

Note 13

**13. Comparative statement of Financial Activities
(incorporating an Income and Expenditure Account)
for the year ended 31st March 2023**

	Unrestricted Funds £	Designated Funds £	Restricted Funds £	Total Funds £
INCOME FROM:				
Voluntary Income	59,744	0	14,579	74,323
Charitable activities	442,869	0	212,601	655,470
TOTAL INCOME	502,613	0	227,180	729,793
EXPENDITURE ON:				
Raising voluntary income	14,114	0	0	14,114
Charitable Activities	461,467	0	254,167	715,634
TOTAL EXPENDITURE	475,581	0	254,167	729,748
NET INCOME and net movement in funds for year				
Transfers between funds	0	0	0	0
NET MOVEMENT IN FUNDS	27,032	0	(26,987)	45
RECONCILIATION OF FUNDS:				
Total funds brought forward	121,403	90,000	169,236	380,639
TOTAL FUNDS CARRIED FORWARD	148,435	90,000	142,249	380,684

NORTON HALL CHILDREN AND FAMILY CENTRE

England & Wales - Charity number 1112752

Accounts



Norton Hall Children and Family Centre

(A Charitable company, founded in 2006)

Trustees Annual Report and Financial Statements For the year ended 31 March 2023



Charity number 1112752
Company number 05052641



CONTENTS	Pages
Trustees Report for YE23	2-10
Independent Examiner's Report	11
Statement of Financial Activities	12
Balance Sheet	13
Notes forming part of the financial statements	14-22

TRUSTEES REPORT

The Trustees are pleased to present their report and independently examined financial statements for the year ending 31st March 2023, which are also prepared to meet the requirements for a directors' report and accounts for Companies Act purposes.

The financial statements have been prepared in accordance with the accounting policies set out in note 1 to the accounts and comply with the Charity's governing document, applicable law, the Charities Act 2011, the Companies Act 2006, and the requirements of the Statement of Recommended Practice, "Accounting and Reporting by Charities" (SORP) issued in March 2005.

REFERENCE AND ADMINISTRATIVE INFORMATION

Charity name:	Norton Hall Children and Family Centre
Charity registration number:	1112752
Company registration number:	05052641
Registered Office:	Ralph Road, Saltley, BIRMINGHAM B8 1NA.

Trustees

> Ms Wendy Kerr, Chair	Appointed 30 th April 2015
> Mr Iftikar Karim, Secretary	Appointed 6 th Dec 2004
> Ms Ghazala Parveen	Appointed 10 th Sept 2015
> Mr John Freeman	Appointed 23 rd Feb 2004
> Ms Maryam Khan	Appointed 30 th April 2015

Secretary

Mr Iftikar Karim

Chief Executive Officer

Suzanne Knipe

Bankers

Unity Bank,
9 Brindley Place, Birmingham B1 2HB

Independent Examiner

P & W Social Accountants
The Barn,
173 Church Road
Northfield, Birmingham B31 2LX.

CHAIR'S REVIEW

I am very proud to present my summary of this year's report for the Norton Hall Children and Family Centre. We support our local community in the Ward End and Alum Rock areas of East Birmingham. Our operations include running the Dolphin Women's Centre in Ward End Park.

Once again this has been a very busy and eventful year, as our charity has continued to support some of the most vulnerable and disadvantaged women, children, and families in East Birmingham.

The cost-of-living crisis has impacted on the demand for our services and again we have noticed a significant increase in people seeking advice and support, particularly with debt and financial distress. During the pandemic we created a food service for those families who were really struggling, and over the year we gave 1,400 food parcels to 250 families, and almost 6,000 hot meals to around 400 children.

At Norton Hall our Sunflower Community preschool Nursery was inspected by OFSTED and received a GOOD report. We developed a new programme which successfully accelerated children's learning in language and communication, so as to meet the national educational average on starting school.

We have seen a huge milestone year for our Dolphin Centre as we commenced a major redevelopment project for the building and its grounds in Ward End Park. The project is due to be completed in July 2023, and our training and education services for women have been temporarily relocated.

We have already started to see the benefits of cross over between the Centres. Children from Norton Hall have participated in outdoor activities in the specially created Forest School area in the Dolphin Centre grounds. Via Forest School we are introducing children and young people from our inner-city community to a range of nature-based activities.

Despite the upheavals of the Dolphin Centre project, and the pressures of the cost-of-living crisis on our funding, I am proud to report that last year we supported over 1,400 local women, children, and young people to improve their wellbeing and life chances.

Over the last two years, we have grown our services by 36% in response to huge demand. Developments at the Dolphin Centre have increased our establishment costs significantly. Whilst we grew our income to £730k, we just about broke even, leaving us with less than three months reserves. 96% of our expenditure was spent on supporting beneficiaries, and only 4% on governance and fundraising.

Alongside recruiting a new Treasurer, our plans for the coming year include continuing our food project, and to engage local positive role models as volunteer mentors for our young beneficiaries.

We want to use an unused Terrace at the Dolphin centre to grow produce for our Café, and develop new training and work experience opportunities for women, including those with learning disabilities.

Thank you to all our partners and funders for their much-valued support throughout this year. Your support is needed now more than ever as we set out to realise our ambitious plans.

Finally, a big thank you to my fellow Trustees, and our dedicated staff and volunteer teams, whose hard work provides such a valuable service to the community.

Ms Wendy Kerr

Chair of Trustees

OBJECTIVES

Background

Whilst established in its current form in 2006, the charity has a strong track record (50 years) of community-based service delivery. Since 2013, our operations include running the Dolphin Women's Centre in Ward End Park. Our mission is to support local children, young people and women to overcome disadvantage.

Charitable objectives

The objects of the charity, as set out in its Memorandum of Association are:

1. To relieve poverty and advance health and education in Hodge Hill, Ladywood and Small Heath (Birmingham). To address the needs of disadvantaged women and children by providing:
 - a. a community nursery and provision for out of school childcare, and generally promoting the development of childcare provision aimed at meeting the needs of low income families.
 - b. holiday play schemes and other children's play provision.
 - c. support and provision for young people, including youth work with girls and young women.
 - d. opportunities for education, training and personal development.
 - e. support for the economic advancement of women, including supporting women into employment and enterprise.
- f. such further facilities as may be beneficial for the wider community in the area of benefit.
 2. To promote and organise co-operation in the achievement of the above purposes.

ACHIEVEMENTS AND PERFORMANCE

At both Norton Hall and within our Dolphin Centre services we have been able to respond to the increase in demand for our services through the hard work and dedication of our staff, volunteers, and Trustees. Our Trustees, most of our workforce and our volunteers are from the local community. Our partners played a crucial role in our success; their expertise enhances and broadens the support we can provide.

Norton Hall Children and Family Centre

Sunflower community nursery

At Norton Hall's Nursery we provide pre-school education for local children whose educational starting point in life is significantly lower than the national average.

This year we were inspected by OFSTED and received a 'GOOD' report.

We developed a new intensive programme which successfully accelerated children's learning in language and communication.

We worked in partnership with four other local Nursery Schools to create a 'Stronger Practice Hub', a new initiative funded through the Department for Education Covid Recovery Programme.

Through this Hub we have shared our skills and learning with 32 other local childcare providers, to continue to improve early years outcomes for all local children.



Outcomes

The objective of our Nursery work is to develop strong foundations for pre-school children.

Over the last year we provided early years education for 63 local children, of whom 89% came from families who have English as a second language. Outcomes achieved included that:

- › All children attending our accelerated learning programme met the national educational average when they left us, ready to start school in September.

Children attending the Nursery:

- › Get on better with others, creating the foundations to develop future relationships.
- › Are ready for school, creating strong foundations for future academic attainment.
- › Have improved speech and language, creating strong literacy and numeracy foundations.
- › Progressed developmentally, reducing the gap in attainment for disadvantaged children.

Children & Young People and their families

The programmes we deliver have continued to develop, supporting some of our most vulnerable children and young people (aged 8-16) and their families.

Supporting parents on low incomes

We provide all year round after school and holiday childcare, at an affordable cost. Many of the working parents we support are on low wages, and / or are single parents. Over the last year we supported 56 local parents with safe and affordable after school and holiday childcare through several programmes.

During and post pandemic and working with Fareshare, we have been feeding families. Either by providing nutritious hot meals/ snacks to children during activities and / or by giving food parcels. This year we started seeing children coming to play sessions so hungry their behaviour had become challenging.

We began giving them breakfast when they arrived to maintain them until we provided a hearty lunch, alongside a range of snacks throughout the day. Last year we provided almost 1,400 food parcels to 250 families, and almost 6,000 hot meals to nearly 400 children.

Positive activities

Most of the children we look after participate in positive activities after school and during evenings, weekends and school holidays.

This year we provided girls and boy groups, and a broad range of sports, arts, drama, forest school and social activities, enabling children to gain new interests and skills and develop self-confidence.

Over the last year 390 local children and young people participated in our positive activities, of whom 63% were children with special educational needs.



One to one mentoring

We continued to provide a bespoke support service for young people struggling with emerging mental health issues or other social and emotional challenges. Many young people benefiting from mentoring have initially participated in our positive activities.

Parent feedback:

"Without the support of Norton Hall, my son would have been placed in emergency services to keep him safe from his own challenges." "Norton Hall's after school club helps single working parents like me and provides security and a place of safety for the children. There's a large range of activities that my kids always love."

Forest school and environmental programme

Utilising the new forest school space at the Dolphin Centre, we have been able to provide outdoor nature play activities for 143 local children throughout the school summer holidays. We developed an environmental programme and have been able to introduce children from our urban inner-city community to a range of nature-based activities.

Outcomes

The objective of our work with children and young people is to improve their life chances. Our activities help children gain resilience, improve their emotional wellbeing, and gain confidence to navigate and manage their often difficult and challenging life circumstances.

Over the last year a total of 460 vulnerable and children and young people benefited from our activities. These children:

- › Had increased confidence and improved social skills, enabling them to make friends, maintain relationships and feel happier and less isolated.
- › Were more able to manage their feelings, resulting in fewer emotional outbursts at home and school and therefore reducing the risk of exclusion from school.
- › Had improved emotional wellbeing, with improved self-esteem; being less likely to self-harm, become involved in drugs/ other high-risk behaviours and less likely to require statutory mental health services.
- › Had improved academic attainment, improving their life chances as children were more likely to stay in education and progress into further education.

Teacher feedback

"I cannot praise Norton Hall highly enough. I have seen some amazing results from the work they have done. I feel it is important to have this resource in the area as it is vital to be able to offer vulnerable children an opportunity to have a positive play experience and supportive environment."

Dolphin Women's Centre

This year has been a milestone year for the Centre as we began refurbishing and extending the building and developing the grounds. The vision for the Centre's redevelopment was informed by extensive consultation with our local community.

The project entails extensive refurbishment and extension of the Dolphin Centre building including a green energy retrofit. We are creating a lakeside café (see right) for local people to enjoy when they visit the Park. This will offer women opportunities to be trained and gain work experience in a range of hospitality areas.

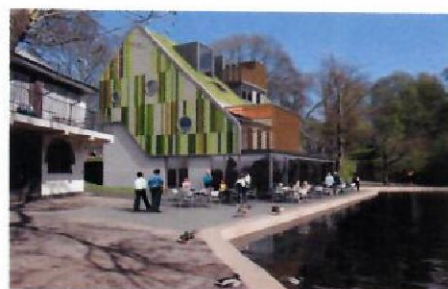

We have made large-scale environmental improvements to the wider parkland, upgrading paths and signage around the lake, the Wash Brook, and woodland area. We have planted more trees and created a clearing which has created a safe space in which to deliver our Forest School and Therapeutic Nature Activity programme.

Together with the Friends of Ward End Park we regenerated and improved an overgrown and neglected community garden. Within the garden we have created an allotment area, in which to grow produce for the Café. This again is providing opportunities for local women to gain work experience and receive training in a range of gardening, environment and horticultural areas.

The project commenced in July 2022, is due to be completed in July 2023 and necessitated the temporary re location of our services for women. It is being realised in collaboration with Birmingham City Council Landscape Practice Group and the Friends of Ward End Park.

Funding for the scheme was managed on our behalf by Birmingham City Council. It included grants from the European Regional Development Fund; the Greater Birmingham and Solihull Local Enterprise Partnership's Growing Places Fund; the East Birmingham Programme; HS2's Community & Environment Fund and Birmingham City Council's Community Infrastructure Levy funds.

Outcomes

The objective of our work at the Centre is to empower women to overcome inequality.

We are proud to report that - despite the upheaval of the redevelopment project- we provided education, training, employment, health and wellbeing support for 922 women during the year.

Our work means that women participating in our activities:

- › Have improved English language skills - enabling them to progress to further education and training and improving their employment prospects.
- › Have improved their digital literacy skills -enabling them to utilise technology for navigate life in today's technological world.
- › Have increased confidence - enabling them to achieve their personal goals and become more independent.
- › Have improved emotional wellbeing, reduced anxiety, stress, and low mood - resulting in a positive impact on their family and home life.
- › Experience reduced isolation, with new friendships and new support groups - encouraging greater community cohesion.

'Nosheen' had been at home, caring for her children and not in work for 13 years. Being out of work had really affected her confidence and she wasn't sure what she could do about it; even if she was to apply for a job, she didn't have anyone she could ask for a reference. When Nosheen's youngest child started nursery, she decided to send out CV's out to local schools with a view to getting some volunteering experience whilst the children were at school/nursery, but she did not get responses.

Whilst carrying out an online search Nosheen came across the Dolphin Centre. She contacted the Manager and was asked to come in immediately. During the meeting she was advised that she could pick days/times that suited her and start straightaway. After 3 months of volunteering the Manager asked Nosheen if she would like to support her with enrolments - one of the busiest times of the academic year - and Nosheen really enjoyed it. During the summer Nosheen asked to be considered for any vacancies at the Centre. She initially obtained a short-term contact which has turned into a permanent post and has now been with us for 5 years!

Nosheen told us how grateful she was to have been given the opportunity, saying: "I am in awe of what being at the Dolphin Centre has done for me. My confidence has grown immensely, and I feel that I can in turn give back to the community by supporting others. The Dolphin Centre is a safe, friendly space- everyone is so welcoming."

FINANCIAL REVIEW

The Trustees agreed a budget for the year with three main cost centres: 1. The Sunflower Nursery; 2. Children and Young Peoples Services; and 3. The Dolphin Women's Centre.

The Income and Expenditure Account shows total incoming resources for the year ending 31st March 2023 (YE23) of £729,792 (YE22: £625,915).

Resources expended amounted to £729,748 (YE22: £682,576), which left a net surplus of £44 (YE22: £56,661 deficit). Total net assets at the year-end amounted to £380,684 (YE22: £380,639) of which 142,249 was restricted funds (YE22 £169,236).

96% of our expenditure was spent on supporting beneficiaries: 70% on the salaries of our expert team, 13% on activity costs, and 13% on premises costs across our two Centres. 4% was spent on governance and fundraising.

Reserves policy and position

Due to uncertainties and the short-term nature of much of the charity's funding, the Trustees policy is to hold sufficient reserves in the Unrestricted Fund (free reserves) to allow it to operate for a period of 3-6 months.

Current free reserves are at £148,436, which equates to just over two months of the YE24 budget of £801k. Designated funds of £90k are held to cover possible redundancies and ongoing building maintenance. This policy is reviewed annually by Trustees.

Income generation

The charity has limited assets and its primary source of funding (90% in YE23) was charitable activities income sourced through partnerships with other charities, local authorities and schools, with the remainder Trusts and Lottery and donations from individuals. Where grants are given for specific purposes, they are treated as Restricted Funds. In YE23, there were 10 restricted grants and tracking and managing these funds is part of the charity's financial management.

Acknowledgements

We would like to thank all our partners for their much-valued support throughout this year, including Birmingham City Council Landscape Practice Group, The Friends of Ward End Park, Family Action, The Childrens Society, Birmingham Education Partnership, 26 local schools, Birmingham Adult Education Service, The Pioneer Group, local Family Support Teams and Safeguarding Hubs, Workers Education Association, Jobcentre Plus, Birmingham MENCAP, Birmingham MIND, Birmingham Healthy Minds, Disability Resource Centre, Sampad and Salt Road Artists.

Also, a special thank you to our funders: the National Lottery Community Fund, Sport Birmingham, Roger and Douglas Charitable Trust, Birmingham City Council, Midland Mencap, Children's Quarter and Street Games.

A big thank you to our dedicated staff team staff whose hard work provides a valuable service to the community. Thank you to our Trustees, who give their time and expertise on a voluntary basis. Finally, a huge thank you to our team of dedicated local volunteers, who give their time to support the day-to-day work of the charity.

STRUCTURE, GOVERNANCE AND MANAGEMENT

Governing document

The charitable company is constituted as a not-for-profit Company Limited by Guarantee having no share capital. It is also a charity registered with the Charity Commission.

The charity is governed by its Memorandum and Articles of Association, and the policies made from time to time by its Trustees, who are also Directors of the charitable company.

Trustees are elected at the AGM, with one third standing down each year. They have the power to co-opt up to three further Trustees, and at least 60% must be women. Following the passing of our Treasurer, we are recruiting for a new Treasurer.

Public benefit

The Trustees, having considered section 4 of the Charities Act 2006, have satisfied themselves that they have complied with the duty to have regard to the Public Benefit guidance published by the Charity Commission.

The activities and achievements of the charity are outlined in this Report and the Trustees believe that the Report demonstrates that the charity is providing public benefit.

Independent examination

The Trustees have appointed P&W Social Accountants to undertake this role. This report has been prepared in accordance with the special provisions of Part 15 of the Companies Act 2006 relating to small companies.

Responsibilities of the Trustees

Company law requires the Trustees to prepare financial statements for each financial year which give a true and fair view of the state of affairs of the charitable company as at the balance sheet date and of its incoming resources and application of resources, including income and expenditure, for the financial period. In preparing those financial statements, the Trustees should follow best practice and:

- › select suitable accounting policies and then apply them consistently.
- › make judgements and estimates that are reasonable and prudent; and,
- › prepare the financial statements on the going concern basis unless it is inappropriate to assume that the charity will continue on that basis.

The Trustees are responsible for maintaining proper accounting records which disclose with reasonable accuracy at any time the financial position of the charitable company and to enable them to comply with the Companies Act 2006. The Trustees are also responsible for safeguarding the assets of the charity and hence for taking steps for the prevention and detection of fraud and other regularities. The Trustees who served during the period under review and up to the date of this report are set out on page 2.

Risk management

The Trustees have assessed risks to which the charity is exposed and are satisfied that systems are in place to mitigate our exposure to the major risks. Trustees are confident that sufficient funding will be available to continue to run the charity for the next 12 months and have contingency plans in place to deal with a shortfall in funding within one or more of its current activities.

Management structure

The day-to-day financial management is devolved to the Chief Executive - Suzanne Knipe. The Board receives quarterly management accounts, showing the actual performance compared to budget.

We have a culturally diverse staff team, balanced in age and gender. Many of our staff live locally and some are 'home grown', starting with us as volunteer young leaders. Our qualified and experienced team have a wide range of complementary skills and qualifications.

These include Youth Work and academic qualifications in for example, Play Work and Mentoring Qualifications (to Level 2 or 3), Therapeutic Counselling, Psychology, 'Trauma Informed Practice' and Drawing and Talking Therapy.

During the year we established and recruited to a new position of Environmental Manager who is also our Forest School Trainer and is responsible for developing our environmental programme of work.

Future plans

Trustees have reviewed the financial position of the charity over the next 12 months which has included a review of the budget for the YE24 and anticipated funding into YE25.

We aim to build reserves over the next year and have set an income target that is higher than our planned spend to help us realise this goal.

Over the last two years, we have grown our services by 36% in response to huge demand. Our plans for the coming year in our work with children and families are to continue to grow and upskill our staff team, and to engage local positive role models as volunteer mentors - particularly young Asian males.

Our plans for the Dolphin centre include the creation of a Terrace allotment and expansion of our community allotments to grow produce for our Café, whilst providing horticultural and environmental training and work experience opportunities for local women. We will also develop new training and work experience opportunities within our Café for young women with learning disabilities.

Approved by the Trustees and signed on their behalf by:



Mr Iftikar Karim, Secretary

INDEPENDENT EXAMINER'S REPORT

I report to the Trustees on my examination of the accounts of the charitable company for the year ended 31 March 2023.

Responsibilities and basis of report

As the charitable company's Trustees (also its directors for the purposes of company law) you are responsible for the preparation of the accounts in accordance with the requirements of the Companies Act 2006 ('the 2006 Act').

I have satisfied myself that the accounts of the charitable company are not required to be audited under Part 16 of the 2006 Act and are eligible for independent examination. I report in respect of my examination of your charity's accounts as carried out under section 145 of the Charities Act 2011 ('the 2011 Act'). In carrying out my examination I have followed the Directions given by the Charity Commission under section 145(5)(b) of the 2011 Act.

Independent Examiner's statement

Since the Company's gross income exceeded £250,000 your examiner must be a member of a body listed in section 145 of the Act. I can confirm that I am qualified to undertake the examination because I am a member of the Institute of Chartered Accountants in England & Wales, which is one of the listed bodies.

I have completed my examination. I can confirm that no matters have come to my attention in connection with the examination giving me cause to believe that:

1. Accounting records were not kept in respect of the Company as required by section 386 of the 2006 Act; or that,
2. The accounts do not accord with those records; or that,
3. The accounts do not comply with the accounting requirements of section 396 of the 2006 Act, other than any requirement that the accounts give a 'true and fair' view which is not a matter considered as part of an independent examination; or that,
4. The accounts have not been prepared in accordance with the methods and principles of the Statement of Recommended Practice for accounting and reporting by charities, applicable to charities preparing their accounts in accordance with the Financial Reporting Standard applicable in the UK and Republic of Ireland (FRS102).

I have no concerns and have come across no other matters in connection with the examination to which attention should be drawn in this report in order to enable a proper understanding of the accounts to be reached.

Signed by:

Date of signature: 27TH Nov 2023



P & W Social Accountants

The Barn

173 Church Road,

Northfield, Birmingham B31 2LX

FINANCIAL STATEMENTS FOR THE YEAR ENDING 31 MARCH 2023

Statement of Financial Activities (incorporating an Income and Expenditure Account)

	Notes	Unrestricted Funds £	Designated Funds £	Restricted Funds	2023 Total Funds £	2022 Total Funds £
INCOME FROM:						
Voluntary income	2	59,744	0	14,579	74,323	36,254
Charitable activities	3	442,869	0	212,601	655,470	589,661
TOTAL INCOME		502,613	0	227,180	729,793	625,915
EXPENDITURE ON:						
Raising voluntary income	4	14,114	0	0	14,114	12,122
Charitable Activities	4	461,467	0	254,167	715,634	670,454
TOTAL EXPENDITURE		475,581	0	254,167	729,748	682,576
NET INCOME/(EXPENDITURE)		27,033	0	-26,987	45	-56,661
Transfers between funds		0	0	0	0	0
NET MOVEMENT IN FUNDS		27,033	0	-26,987	45	-56,661
RECONCILIATION OF FUNDS:						
Total funds brought forward		121,403	90,000	169,236	380,639	313,687
TOTAL FUNDS CARRIED FORWARD		148,436	90,000	142,249	380,684	257,027

The statement of financial activities includes all gains and losses recognised in the year. All income and expenditure derive from continuing activities

Balance Sheet

		2023	2022
		£	£
	Notes		
FIXED ASSETS			
Tangible assets	6	176,316	190,495
CURRENT ASSETS			
Debtors & prepayments	7	43,249	42,326
Cash at bank & in hand		190,415	224,005
		<u>233,664</u>	<u>266,331</u>
CREDITORS			
Amounts falling due within one year	8	29,295	76,187
		<u>204,369</u>	<u>190,144</u>
NET CURRENT ASSETS			
		<u>204,369</u>	<u>190,144</u>
NET ASSETS			
		<u>380,685</u>	<u>380,639</u>
FUNDS OF THE CHARITY			
	10		
Unrestricted funds		148,436	121,403
Designated funds		90,000	90,000
Restricted funds		142,249	169,236
TOTAL FUNDS		<u>380,684</u>	<u>380,639</u>

For the year ending 31st March 2023 the company was entitled to exemption from audit under section 477 of the Companies Act 2006 relating to small companies.

Director's responsibilities:

The members have not required the company to obtain an audit of its accounts for the year in question in accordance with section 476 of the Companies Act 2006. However, in accordance with Section 145 of the Charities Act 2011, the financial statements have been examined by an Independent Examiner, whose report is included in these accounts. The Directors acknowledge their responsibilities for complying with the requirements of the Companies Act 2006 with respect to accounting records and the preparation of accounts. These accounts have been prepared in accordance with the provisions applicable to companies subject to the small companies regime.

Signed on behalf of the Board by:



Mr Iftikar Karim, Secretary

Approved by the Board on:

29/11/2023

Date:

The notes on the following pages form part of the financial statements

Notes to the Financial statements

Note

1. ACCOUNTING POLICIES

Basis of preparation

The financial statements have been prepared in accordance with Accounting and Reporting by Charities: Statement of Recommended Practice applicable to charities preparing their accounts in accordance with the Financial Reporting Standard applicable in the UK and Republic of Ireland (FRS102)(effective 1 January 2019) - (Charities SORP (FRS102)), the Financial Reporting Standard applicable in the UK and Republic of Ireland (FRS102) and the Companies Act 2006.

Norton Hall Children and Family Centre meets the definition of a public benefit entity under FRS102. Assets and liabilities are initially recognised at historical cost or transaction value unless otherwise stated in the relevant accounting policy note(s).

The Charity Commission's guidance on public benefit organisations supports the conclusion that Norton Hall Children and Family Centre is a public benefit entity. The reporting currency is £ Sterling.

Preparation of the accounts on a going concern basis

The financial statements have been prepared on a going concern basis which assumes that the Company will continue to operate. The validity of this assumption is dependent upon the continuance of support from the Company's key grant funders and in response to the progress made by the Company in pursuing a viable budget including the obtaining of further grants and other funds. The Company's current business plan shows that the Company will be able to operate in the foreseeable future. Based on this understanding, the directors believe that it remains appropriate to prepare the financial statements on a going concern basis. The financial statements do not include any adjustments which would result from the basis of preparation being inappropriate.

Tangible fixed assets

Depreciation is provided at the following annual rates in order to write off each asset over its estimated useful life (assets with a cost below £1,000 are not capitalised) :

Fixtures, fittings & equipment	-25% per annum straight line - 25 years straight
Improvements to property	line

Income

Items of income are recognised and included in the accounts when all of the following criteria are met:

- The charity has entitlement to the funds;
- any performance conditions attached to the item(s) of income have been met or are fully within the control of the charity;
- there is sufficient certainty that receipt of the income is considered probable; and
- the amount can be measured reliably.

Expenditure

Expenditure is recognised once there is a legal or constructive obligation to make a payment to a third party, it is probable that settlement will be required and the amount of the obligation can be measured reliably.

Expenditure is classified under the following activity headings:

- Costs of raising funds comprise staff costs and other direct costs involved in the raising of funds for the charity;

- Expenditure on charitable activities includes the direct costs of activities undertaken to further the purposes of the charity and their associated support & governance costs.

Irrecoverable VAT is charged as a cost against the activity for which the expenditure was incurred.

Taxation

The charity is exempt from corporation tax on its charitable activities.

Fund Accounting

Unrestricted Funds can be used in accordance with the charitable objectives at the discretion of the trustees.

Restricted funds can only be used for the particular restricted purposes within the objects of the charity. Restrictions arise when specified by the donor or when funds are raised for a particular restricted purpose.

Further explanation of the nature and purpose of each fund is included in the notes to the financial statements.

Debtors

Trade and other debtors are recognised at the settlement amount due after any trade discount offered. Prepayments are valued at the amount prepaid after taking account of any trade discounts due.

Cash at bank and in hand

Cash at bank and cash in hand includes cash and short term highly liquid investments with a short maturity of three months or less from the date of acquisition or opening of the deposit or similar account.

Creditors and provisions

Creditors and provisions are recognised where the charity has a present obligation resulting from a past event that will probably result in the transfer of funds to a third party and the amount due to settle the obligation can be measured or estimated reliably. Creditors and provisions are normally recognised at their settlement amount after allowing for any trade discounts due.

Pension costs

The Company operates a money purchase pension scheme for employees. Employer contributions are charged as an expense in the period to which they relate and are allocated to activities in line with the related salary cost.

Note

2. VOLUNTARY INCOME

	2023 £	2022 £
Donations	59,744	9,569
Trusts & Company grants		
Good Things Foundation	0	9,145
HS2 Community & Environment Fund	0	12,540
Longhurst Foundation	0	5,000
Roger & Douglas Turner Charitable Trust	5,000	0
Sport Birmingham - Together Fund	9,579	0
Total Trust & company grants	<u>14,579</u>	<u>26,685</u>
TOTAL VOLUNTARY INCOME	<u><u>74,323</u></u>	<u><u>36,254</u></u>

3. CHARITABLE ACTIVITIES INCOME

	2023 £	2022 £
Birmingham CC - Building Development	12,500	12,500
Birmingham CC - Early Years SENCO	12,930	7,170
Birmingham CC – Holiday Activity & Food	126,565	109,239
Birmingham CC - Neighbourhood Network Scheme	4,960	0
Birmingham CC - Neighbourhood Development Support Unit	2,500	0
Birmingham CC - Pupil Premium	1,935	819
Birmingham CC - Valuing Worth Norton Hall	26,211	26,211
Birmingham CC - Valuing Worth Dolphin Centre	25,000	25,000
HMRC - Coronavirus Job Retention Scheme	0	12,404
West Mids Combined Authority - Commonwealth Games Legacy	0	9,700
	<u>212,601</u>	203,043
Income from charitable activities:		
Norton Hall - Nursery	128,382	104,934
Norton Hall - Children and Young People	281,325	249,266
Dolphin Women's Centre	33,163	32,418
	<u>442,869</u>	<u>386,618</u>
TOTAL CHARITABLE ACTIVITIES INCOME	<u><u>655,470</u></u>	<u><u>589,661</u></u>

Note

4. EXPENDITURE	2023	2022
Charitable Activities:	£	£
Establishment costs	99,494	129,272
Staff costs	500,809	428,683
Direct cost of activities	100,184	94,764
Depreciation	14,179	14,179
FutureBuilders loan interest	88	357
Independent Examiner's Fee	880	800
Finance costs	0	2,400
	715,634	670,454
Raising voluntary income		
Staff costs	10,220	11,322
Other direct costs	800	800
External support	3,094	
	14,114	12,122
Total expenditure	729,748	682,576

5. STAFF COSTS, TRUSTEES REMUNERATION AND EXPENSES

There were no trustees remuneration or other benefits for the year ended 31st March 2023 nor for

the year ended 31st March 2022.

No expenses were paid to Trustees during the year (2022: £Nil).

STAFF COSTS	2023	2022
	£	£
Wages and salaries	468,345	405,564
Employer costs - National Insurance	34,388	27,415
Pension costs	8,296	7,026
	511,029	440,005

The average number of full-time equivalent employees during the year was as follows:

	2023	2022
	18	18

No employees had emoluments in excess of £60,000 (2021: nil).

Key management personnel comprise the Chief Executive Officer and Operations and Finance Manager whose combined employee benefits totalled £81,582 (2022: £64,922) including pension contributions.

6. TANGIBLE FIXED ASSETS	Fixtures, fittings & equip	Total
Costs	£	
As at 31st March 2022	53,350	53,350
Additions	0	0
At 31 March 2023	53,350	53,350
Depreciation		
As at 31st March 2022	53,350	53,350
Charge for the year	0	0
At 31 March 2023	53,350	53,350
Net Book Value		
31st March 2023	0	0
31st March 2022	0	0

Note

7. DEBTORS: AMOUNTS FALLING DUE WITHIN ONE YEAR

	2023	2022
	£	£
Trade Debtors	38,869	38,972
Prepayments	4,380	3,354
Total Debtors	<u>43,249</u>	<u>42,326</u>

8. CREDITORS: AMOUNTS FALLING DUE WITHIN ONE YEAR

	2023	2022
	£	£
Trade Creditors	18,492	65,046
Tax and social security	9,923	5,685
Accrued expenses	880	800
Future Builders Loan	0	4,656
	<u>29,295</u>	<u>76,187</u>

9. ANALYSIS OF NET ASSETS BETWEEN FUNDS

	Unrestricted Funds £	Restricted Funds £	Designated Funds £	2023 Total Funds £	2022 Total Funds £
Fixed Assets	-126,034	126,034	0	0	190,495
Net Current Assets	274,470	16,214	90,000	380,684	190,144
	<u>148,436</u>	<u>142,248</u>	<u>90,000</u>	<u>380,684</u>	<u>380,639</u>

Note

10. FUNDS

	Opening Balance	Income	Expenditure	Transfers	Balance
	£	£	£	£	£
Unrestricted Funds					
General Fund	121,403	502,613	475,581	0	148,436
Designated Fund - Maintenance & Redundancy Reserve	90,000	0	0	0	90,000
Restricted Funds					
Birmingham CC - Building Development	0	12,500	12,500	0	0
Birmingham CC - Early Years SENCO	0	12,930	12,930	0	0
Birmingham CC – Holiday Activity & Food	11,745	126,565	138,310	0	0
Birmingham CC - Neighbourhood Development Support Unit	0	2,500	0	0	2,500
Birmingham CC - Neighbourhood Network Scheme	0	4,960	824	0	4,136
Birmingham CC - Pupil Premium	0	1,935	1,935	0	0
Birmingham CC - Valuing Worth Norton Hall	0	26,211	26,211	0	0
Birmingham CC - Valuing Worth Dolphin Centre	0	25,000	25,000	0	0
Capital Assets Fund	140,213	0	14,179	0	126,034
Good Things Foundation	5,487	0	5,487	0	0
Longhurst Foundation	4,000	0	4,000	0	0
West Mids Combined Authority - Commonwealth Games Legacy	7,791	0	7,791	0	0
Roger & Douglas Turner Charitable Trust	0	5,000	5,000	0	0
Sport Birmingham - Together Fund	0	9,578	0	0	9,578
Total Restricted Funds	169,236	227,179	254,167	0	142,248
Total All Funds	380,639	729,792	729,748	0	380,684

Fund Descriptions

Birmingham CC - Building Development: funding (sourced from ERDF) to project manage the refurbishment of the Dolphin Centre.

Norton Hall Children and Family Centre Trustees Report and Financial Statements for the Year Ending 31st March 2023

- Birmingham CC - Early Years SENCO: funding to support nursery provision for those with additional needs.
- Birmingham CC – Holiday Activity & Food: funding (sourced from DfE) towards free school holiday food and fun activities
- Birmingham CC - Neighbourhood Development Support Unit: funding towards increasing utilities costs.
- Birmingham CC - Neighbourhood Network Scheme: funding to deliver basic English classes to women
- Birmingham CC - Pupil Premium: funding to provide improved nursery facilities and activities
- Birmingham CC - Valuing Worth Norton Hall: funding to offset the rent of the properties used by the charity
- Birmingham CC - Valuing Worth Dolphin Centre: funding to offset the rent of the properties used by the charity
- Capital assets Fund: funding towards the capitalised costs of the improvements made to the leasehold properties
- Good Things Foundation: funding to support women with digital literacy.
- Longhurst Foundation: towards gardening and environmental activities for women
- Roger & Douglas Turner Charitable Trust: towards work supporting children and young people
- Sport Birmingham - Together Fund: funding for children's sport and physical activity
- West Mids Combined Authority - Commonwealth Games Legacy: funding for activities and services for women

11. COMMITMENTS

The total of future minimum lease payments under non- cancellable operating leases are:

Within one year - £1,210 (£1,210 comparative)

Between one and five years - £907 (£2,117 comparative)

12. RELATED PARTY TRANSACTIONS

There were no transactions with related parties during the year or previous year that require disclosure in these accounts.

Comparative statement of Financial Activities incorporating an Income and Expenditure Account) for the year ended 31st March 2022
 Note 13.

	Unrestricted Funds £	Total Funds £	Restricted Funds £	Total Funds £
INCOME FROM:				
Voluntary income	9,569	0	51,211	60,780
Charitable activities	386,618	0	178,517	565,135
TOTAL INCOME	396,187	10,220	229,728	625,915
EXPENDITURE ON:				
Raising voluntary income	12,122	0	0	12,122
Charitable Activities	370,479	20,000	279,975	670,454
TOTAL EXPENDITURE NET INCOME	382,601	20,000	279,975	682,576
and net movement in funds for year	13,586	(9,780)	(50,247)	(56,661)
Transfers between funds	(53,580)	50,000	3,580	0
NET MOVEMENT IN FUNDS	(39,994)	60,000	(46,667)	(56,661)
RECONCILIATION OF FUNDS:				
Total funds brought forward	161,397	60,000	215,903	437,300
TOTAL FUNDS CARRIED FORWARD	121,403	90,000	169,236	380,639

NORTON HALL CHILDREN AND FAMILY CENTRE

England & Wales - Charity number 1112752

Accounts

COMPANY NO : 5052641

CHARITY NO : 1112752

**REPORT OF THE TRUSTEES AND
FINANCIAL STATEMENTS FOR THE YEAR ENDED 31 MARCH 2022
FOR
NORTON HALL CHILDREN & FAMILY CENTRE**



NORTON HALL CHILDREN & FAMILY CENTRE

**COMPANY INFORMATION
FOR THE YEAR ENDED 31 MARCH 2022**

TRUSTEES:	Ms W Kerr Ms G Parveen Mr J Freeman Mr I Karim Ms M Khan
SECRETARY:	I Karim
CENTRE CO-ORDINATOR:	S Knipe
REGISTERED OFFICE:	Norton Hall Children & Family Centre Ralph Road Saltley Birmingham B8 1NA
REGISTERED COMPANY NUMBER:	5052641 (England and Wales)
REGISTERED CHARITY NUMBER :	1112752
INDEPENDENT EXAMINER :	P & W Social Accountants The Barn 173 Church Road, Northfield Birmingham B31 2LX
BANKERS:	Unity Trust Bank Nine Brindleyplace Birmingham B1 2HB

NORTON HALL CHILDREN & FAMILY CENTRE

REPORT OF THE TRUSTEES

FOR THE YEAR ENDED 31 MARCH 2022

The Trustees are pleased to present their annual directors' report together with the financial statements of the charity for the year ended 31 March 2022, which are also prepared to meet the requirements for a directors' report and accounts for Companies Act purposes. The financial statements comply with the Charities Act 2011, the Companies Act 2006, the Memorandum and Articles of Association, and Accounting and Reporting by Charities: Statement of Recommended Practice applicable to charities preparing their accounts in accordance with the Financial Reporting Standard applicable in the UK and Republic of Ireland (FRS102) (updated 1 January 2019).

OBJECTS AND ACTIVITIES

The objects of the charity, as set out in its Memorandum of Association are:

1. To relieve poverty and advance health and education in the City of Birmingham, and in particular to address the needs of disadvantaged women, children and young people in the Hodge Hill, Ladywood and Small Heath constituencies, by (without excluding the generality of the foregoing) :
 - a) providing a community nursery and provision for out of school childcare, and generally promoting the development of childcare provision aimed at meeting the needs of low income families.
 - b) running holiday play schemes and other children's play provision.
 - c) developing support and provision for young people, including youth work with girls and young women.
 - d) providing opportunities for education, training and personal development.
 - e) providing support for the economic advancement of women, including supporting women into employment and enterprise.
 - f) providing such further facilities as may be beneficial for the wider community in the area of benefit.
2. To promote and organise co-operation in the achievement of the above purposes.

Norton Hall is a community-based charity that has been working in the Ward End and Alum Rock areas of Birmingham for nearly 50 years. The community we support is affected by disproportionate levels of environmental, social, and economic deprivation. The charity has three main areas of work:

Developing strong foundations for Preschool Children.

- Our 'Sunflower' Community Nursery supports local parents and families, many of whom are on low incomes. We provide Pre-School Education for children aged between 2 and 5 years and build strong educational foundations for children whose social and educational starting point is significantly lower than the national average.

Improving Outcomes for Children & Young People

- Our Out of School and Holiday Care Service provides after school and holiday childcare for children of working parents. This service supports up to 40 children each day and provides local parents with affordable quality childcare.
- Our Positive Activity programmes and Mentoring project supports children & young people with added vulnerabilities, learning difficulties and/or special educational needs. The project provides a range of positive activities and Play opportunities and a one-to-one mentoring programme.

Empowering women to overcome Inequality

- Our Dolphin Women's Centre supports the most vulnerable, economically, and socially disadvantaged women in our community. The project focusses on three key areas: Education, Employability and Health and Wellbeing.

All of the Centre's activities are aimed at supporting local children and families, in an area of high deprivation. No member of the company, including the Trustees, receive any financial benefit from their involvement with the Centre.

In developing activities and delivering services, the Trustees have taken account of the guidance published by the Charity Commission on public benefit.

NORTON HALL CHILDREN & FAMILY CENTRE

REPORT OF THE TRUSTEES (CONTINUED)

FOR THE YEAR ENDED 31 MARCH 2022

ACHIEVEMENTS AND PERFORMANCE

This year, we supported 1,465 local women and children.

Developing strong foundations for Preschool Children.

Our OFSTED rated "OUTSTANDING" Sunflower Community Nursery provided pre-school education for children whose educational starting point in life is significantly lower than the national average.

In the last 12 months we are pleased to report:

Throughout COVID we supported 62 children with face-to-face preschool education, 84% of whom made accelerated progress to meet the national educational average for their age.

Improving Outcomes for Children & Young People

Out of School and holiday Care Service

This year this service supported 44 working parents on low incomes by providing out of school hours childcare after school and during school holidays.

Positive Activities and Mentoring Projects

This year we have provided one-to-one mentoring support, a range of positive activities, and Play opportunities during evenings, weekends and throughout the school holidays.

Throughout this programme we have supported 379 vulnerable and disadvantaged children and young people to become more resilient, have improved emotional wellbeing and self-confidence. This has enabled them to be better able to manage their often difficult and challenging life circumstances.

Empowering Women to Overcome Inequality

The Dolphin Women's Centre in Ward End Park has continued to provide education, employment, mental health, and wellbeing support services for local women, focussing on support for women who experience multiple disadvantages.

In the last 12 months we are pleased to report we have supported 980 local women

Future Development

Working in partnership with Birmingham City Council Landscape Practice we are pleased to report we have secured funding for the refurbishment and extension of the Dolphin Centre building, and for environmental improvements and enhancements for the wider regeneration of Ward End Park, in which the Dolphin centre is situated.

Throughout the year we have continued to work with in partnership with a range of organisations to develop and deliver services for local people that meet local needs. We would like to thank all of our partners for their much valued support, these include: Birmingham City Council Landscape Practice Group, Family Action, Birmingham Education Partnership (BEP), 26 local schools, local Family Support Teams and Safeguarding Hubs, Birmingham Adult Education Service, Workers Education Association (WEA), Jobcentre Plus, Birmingham MENCAP, Birmingham MIND, Birmingham Healthy Minds, Disability Resource Centre, Sampad, The Friends of Ward End Park.

A special thank you to our funders for their kind support this year, whose support has enabled us to continue to provide our services that improve the lives of women and children in our local community. Thank you to: The Barbara Ward Foundation Trust Hudson Charitable Trust, National Lottery Community Fund, Power to Change, Midland Mencap, Children's Quarter, Street Games, Birmingham City Council, Family Action, Birmingham Education Partnership, NNS – Neighbourhood Network Scheme.

Also a big thank you to our dedicated staff team staff who work tirelessly to provide quality services to local people and our team of committed local volunteers, who give their valuable 'free' time and contribute to the work of the

NORTON HALL CHILDREN & FAMILY CENTRE

REPORT OF THE TRUSTEES (CONTINUED)

FOR THE YEAR ENDED 31 MARCH 2022

FINANCIAL REVIEW

The Trustees agreed a budget for the year with five main cost centres: the Day Nursery, Out of School and work with Young People, Dolphin Centre, Community use, and core costs. Day to day financial management is devolved to the Centre Coordinator and the Business Manager, but the Board received regular management accounts, showing the actual performance compared to budget.

Where grants are given for specific purposes, they are treated as Restricted Funds. In the year to 31 March 2021, there were 16 restricted funds (2021: 13), and tracking and managing these funds is a major part of the charity's financial management. We are grateful to all our funders for their valuable support.

In the year to 31 March 2022 64.4% (2021: 64.6%) of the expenditure went on staff salaries and employer costs, and 13.8% (2021: 12.9%) on the direct cost of the Centre's activities. The remaining 21.8% (2021: 22.5%) was spent on premises, overheads, governance, fundraising and depreciation.

The Trustees have assessed the major risks to which the charity is exposed and are satisfied that systems are in place to mitigate our exposure to the major risks.

The Trustees have adopted a policy on reserves. Due to uncertainties and the short term nature of much of the charity's funding, the aim is to hold sufficient reserves in the Unrestricted Fund to allow it to operate for a period of 3 months. This would require reserves of around £120,000. Current free reserves, at £121,403 are near the agreed target. The Trustees also hold a Designated Reserve fund of £90,000 to cover possible redundancies and ongoing building maintenance.

Trustees have reviewed the financial position of the charity over the next 12 months which has included a review of the budget for the year to 31 March 2023 and anticipated funding into 2024. Trustees are confident that sufficient funding will be available to continue to run the charity for the next 12 months and have a number of contingency plans in place to deal with a shortfall in funding within one or more of its current activities.

STRUCTURE, GOVERNANCE AND MANAGEMENT

The company is constituted as a not for profit Company Limited by Guarantee having no share capital, and is also a charity registered with the Charity Commission. It is governed by its Memorandum and Articles of Association, and the policies made from time to time by its Directors, who are also the trustees of the charity.

The Trustees are elected at the AGM, with one third standing down each year. The Trustees also have the power to co-opt up to 3 further trustees. At least 60% of the Trustees must be women.

The Trustees serving during the year under review and at the date of this report were:

Ms Wendy Kerr

Ms Ghazala Parveen

Mr John Freeman

Mr Iftikar Karim

Ms Maryam Khan

NORTON HALL CHILDREN & FAMILY CENTRE

REPORT OF THE TRUSTEES (CONTINUED)

FOR THE YEAR ENDED 31 MARCH 2022

STATEMENT OF DIRECTORS' RESPONSIBILITIES

The trustees are responsible for preparing the financial statements in accordance with applicable law and regulations. Company law requires the trustees to prepare financial statements for each financial year. Under that law the trustees have elected to prepare the financial statements in accordance with United Kingdom Generally Accepted Accounting Practice (United Kingdom Accounting Standards and applicable law). The financial statements are required by law to give a true and fair view of the state of affairs of the company and of the profit or loss of the company for that period. In preparing these financial statements, the trustees are required to :

- select suitable accounting policies and then apply them consistently;
- make judgements and estimates that are reasonable and prudent;
- prepare the financial statements on the going concern basis unless it is inappropriate to presume that the company will continue in business.

The trustees are responsible for keeping proper accounting records which disclose with reasonable accuracy at any time the financial position of the company and to enable them to ensure that the financial statements comply with the Companies Act 2006. They are also responsible for safeguarding the assets of the company and hence for taking reasonable steps for the prevention and detection of fraud and other irregularities.

INDEPENDENT EXAMINER

The Trustees have appointed P&W Social Accountants to undertake this role.

This report has been prepared in accordance with the special provisions of Part 15 of the Companies Act 2006 relating to small companies.

APPROVAL

This Report was approved by the Board of Trustees and signed on its behalf.

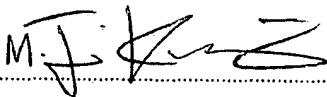
.....

I Karim - Trustee

Date 7/12/2022

**INDEPENDENT EXAMINER'S REPORT TO THE TRUSTEES OF
NORTON HALL CHILDREN & FAMILY CENTRE ('THE COMPANY')
FOR THE YEAR ENDED 31 MARCH 2022**

I report to the charity trustees on my examination of the accounts of the Company for the year ended 31 March 2022.

Responsibilities and basis of report

As the charity's trustees of the Company (also its directors for the purposes of company law) you are responsible for the preparation of the accounts in accordance with the requirements of the Companies Act 2006 ('the 2006 Act').

Having satisfied myself that the accounts of the Company are not required to be audited under Part 16 of the 2006 Act and are eligible for independent examination, I report in respect of my examination of your charity's accounts as carried out under section 145 of the Charities Act 2011 ('the 2011 Act'). In carrying out my examination I have followed the Directions given by the Charity Commission under section 145(5)(b) of the 2011 Act.

Independent Examiner's statement

Since the Company's gross income exceeded £250,000 your examiner must be a member of a body listed in section 145 of the Act. I can confirm that I am qualified to undertake the examination because I am a member of the Institute of Chartered Accountants in England & Wales, which is one of the listed bodies.

I have completed my examination. I can confirm that no matters have come to my attention in connection with the examination giving me cause to believe:

1. accounting records were not kept in respect of the Company as required by section 386 of the 2006 Act; or
2. the accounts do not accord with those records; or
3. the accounts do not comply with the accounting requirements of section 396 of the 2006 Act other than any requirement that the accounts give a 'true and fair' view which is not a matter considered as part of an independent examination; or
4. the accounts have not been prepared in accordance with the methods and principles of the Statement of Recommended Practice for accounting and reporting by charities applicable to charities preparing their accounts in accordance with the Financial Reporting Standard applicable in the UK and Republic of Ireland (FRS102).

I have no concerns and have come across no other matters in connection with the examination to which attention should be drawn in this report in order to enable a proper understanding of the accounts to be reached.



P & W Social Accountants
The Barn
173 Church Road,
Northfield
Birmingham
B31 2LX

Date 15/12/2022

Norton Hall Children and Family Centre

**Statement of Financial Activities (incorporating an Income and Expenditure Account)
for the year ended 31st March 2022**

	Notes	Unrestricted Funds £	Designated Funds £	Restricted Funds	2022 Total Funds £	2021 Total Funds £
INCOME FROM:						
Donations & legacies	2	9,569	0	51,211	60,780	67,711
Charitable activities	3	386,618	0	178,517	565,135	629,333
TOTAL INCOME		396,187	0	229,728	625,915	697,044
EXPENDITURE ON:						
Raising funds	4	12,122	0	0	12,122	11,058
Charitable Activities	4	370,479	20,000	279,975	670,454	562,374
TOTAL EXPENDITURE		382,601	20,000	279,975	682,576	573,432
NET INCOME/(EXPENDITURE)		13,586	-20,000	-50,247	-56,661	123,613
Transfers between funds		-53,580	50,000	3,580	0	0
NET MOVEMENT IN FUNDS		-39,994	30,000	-46,667	-56,661	123,613
RECONCILIATION OF FUNDS:						
Total funds brought forward		161,397	60,000	215,903	437,300	313,687
TOTAL FUNDS CARRIED FORWARD		121,403	90,000	169,236	380,639	437,300

The statement of financial activities includes all gains and losses recognised in the year.
All income and expenditure derive from continuing activities.

Balance Sheet
As at 31st March 2022

		2022	2021
		£	£
	Notes		
FIXED ASSETS			
Tangible assets	6	190,495	204,673
CURRENT ASSETS			
Debtors & prepayments	7	42,326	23,578
Cash at bank & in hand		224,005	247,713
		<u>266,331</u>	<u>271,291</u>
CREDITORS			
Amounts falling due within one year	8	76,187	33,765
		<u>190,144</u>	<u>237,526</u>
NET CURRENT ASSETS			
		<u>380,639</u>	<u>442,199</u>
TOTAL ASSETS LESS CURRENT LIABILITIES			
CREDITORS			
Amounts falling due after more than one year	9	0	4,899
		<u>380,639</u>	<u>437,300</u>
NET ASSETS			
FUNDS OF THE CHARITY			
	11		
Unrestricted funds		121,403	161,397
Designated funds		90,000	60,000
Restricted funds		169,236	215,903
TOTAL FUNDS		<u><u>380,639</u></u>	<u><u>437,300</u></u>

For the year ending 31st March 2022 the company was entitled to exemption from audit under section 477 of the Companies Act 2006 relating to small companies.

Director's responsibilities :

The members have not required the company to obtain an audit of its accounts for the year in question in accordance with section 476 of the Companies Act 2006. However, in accordance with Section 145 of the Charities Act 2011, the financial statements have been examined by an Independent Examiner, whose report is included in these accounts.

The directors acknowledge their responsibilities for complying with the requirements of the Companies Act 2006 with respect to accounting records and the preparation of accounts.

These accounts have been prepared in accordance with the provisions applicable to companies subject to the small companies regime.

On Behalf of the Board:

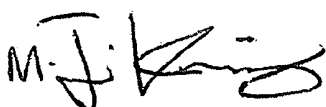

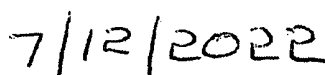

I Karim - Trustee

Approved by the Board on

The notes form part of the financial statements

Norton Hall Children and Family Centre

Notes to the Financial statements for the year ended 31st March 2022

Note

1. ACCOUNTING POLICIES

Basis of preparation

The financial statements have been prepared in accordance with Accounting and Reporting by Charities: Statement of Recommended Practice applicable to charities preparing their accounts in accordance with the Financial Reporting Standard applicable in the UK and Republic of Ireland (FRS102)(effective 1 January 2019) - (Charities SORP (FRS102)), the Financial Reporting Standard applicable in the UK and Republic of Ireland (FRS102) and the Companies Act 2006.

Norton Hall Children and Family Centre meets the definition of a public benefit entity under FRS102. Assets and liabilities are initially recognised at historical cost or transaction value unless otherwise stated in the relevant accounting policy note(s).

The Charity Commission's guidance on public benefit organisations supports the conclusion that Norton Hall Children and Family Centre is a public benefit entity.

The reporting currency is £ Sterling.

Preparation of the accounts on a going concern basis

The financial statements have been prepared on a going concern basis which assumes that the Company will continue to operate. The validity of this assumption is dependent upon the continuance of support from the Company's key grant funders and in response to the progress made by the Company in pursuing a viable budget including the obtaining of further grants and other funds. The Company's current business plan shows that the Company will be able to operate in the foreseeable future. Based on this understanding, the directors believe that it remains appropriate to prepare the financial statements on a going concern basis. The financial statements do not include any adjustments which would result from the basis of preparation being inappropriate.

Tangible fixed assets

Depreciation is provided at the following annual rates in order to write off each asset over its estimated useful life (assets with a cost below £1,000 are not capitalised) :

Fixtures, fittings & equipment	-25% per annum straight line
Improvements to property	- 25 years straight line

Income

Items of income are recognised and included in the accounts when all of the following criteria are met:

- The charity has entitlement to the funds;
- any performance conditions attached to the item(s) of income have been met or are fully within the control of the charity;
- there is sufficient certainty that receipt of the income is considered probable; and
- the amount can be measured reliably.

Expenditure

Expenditure is recognised once there is a legal or constructive obligation to make a payment to a third party, it is probable that settlement will be required and the amount of the obligation can be measured reliably.

Expenditure is classified under the following activity headings:

- Costs of raising funds comprise staff costs and other direct costs involved in the raising of funds for the charity;
- Expenditure on charitable activities includes the direct costs of activities undertaken to further the purposes of the charity and their associated support & governance costs.

Irrecoverable VAT is charged as a cost against the activity for which the expenditure was incurred.

Taxation

The charity is exempt from corporation tax on its charitable activities.

Fund Accounting

Unrestricted Funds can be used in accordance with the charitable objectives at the discretion of the trustees.

Restricted funds can only be used for the particular restricted purposes within the objects of the charity. Restrictions arise when specified by the donor or when funds are raised for a particular restricted purpose.

Further explanation of the nature and purpose of each fund is included in the notes to the financial statements.

Debtors

Trade and other debtors are recognised at the settlement amount due after any trade discount offered. Prepayments are valued at the amount prepaid after taking account of any trade discounts due.

Cash at bank and in hand

Cash at bank and cash in hand includes cash and short term highly liquid investments with a short maturity of three months or less from the date of acquisition or opening of the deposit or similar account.

Creditors and provisions

Creditors and provisions are recognised where the charity has a present obligation resulting from a past event that will probably result in the transfer of funds to a third party and the amount due to settle the obligation can be measured or estimated reliably. Creditors and provisions are normally recognised at their settlement amount after allowing for any trade discounts due.

Pension costs

The Company operates a money purchase pension scheme for employees. Employer contributions are charged as an expense in the period to which they relate and are allocated to activities in line with the related salary cost.

Norton Hall Children and Family Centre

Notes to the Financial statements for the year ended 31st March 2022

Note

2. INCOME FROM DONATIONS & LEGACIES

	2022	2021
	£	£
Donations	9,569	16,500
Restricted grants:		
BCC Norton Hall Valuing Worth grant	26,211	26,211
BCC Dolphin Centre Valuing Worth grant	25,000	25,000
	<u>51,211</u>	<u>51,211</u>
Total	<u>60,780</u>	<u>67,711</u>

3. INCOME FROM CHARITABLE ACTIVITIES

	2022	2021
	£	£
Restricted grants:		
Children in Need - Young Carers	0	9,963
Pupil Premium	819	668
EYSE	7,170	8,620
HS2 CEF	12,540	24,971
TNL COVID Response Fund	0	89,540
Power to Change	0	58,872
Communities & Families Fund	0	9,362
Coronavirus Job Retention Scheme	12,404	74,566
Healthy Happy Holidays	109,239	0
Good Things Foundation	9,145	0
The Longhurst Foundation	5,000	0
BCC Building Development	12,500	0
Commonwealth Games Legacy	9,700	0
	<u>178,517</u>	<u>276,561</u>
Income from charitable activities:		
Nursery	104,934	136,663
Children and Young People	244,266	150,795
Dolphin Centre	23,418	40,344
Lettings	5,000	20
Other	9,000	24,950
	<u>386,618</u>	<u>352,772</u>
Total	<u>565,135</u>	<u>629,333</u>

Norton Hall Children and Family Centre

**Notes to the Financial statements
for the year ended 31st March 2022**

Note

4. EXPENDITURE	2022	2021
Charitable Activities:		£
Establishment costs	129,272	107,743
Staff costs	428,683	360,248
Direct cost of activities	94,764	73,544
Depreciation	14,179	14,656
FutureBuilders loan interest	357	582
Independent Examiner's Fee	800	800
Finance costs	2,400	4,800
	<u>670,454</u>	<u>562,374</u>
Raising funds:		
Staff costs	11,322	10,258
Other direct costs	800	800
	<u>12,122</u>	<u>11,058</u>
Total expenditure	<u>682,576</u>	<u>573,432</u>

5. STAFF COSTS, TRUSTEES REMUNERATION AND EXPENSES

There were no trustees remuneration or other benefits for the year ended 31st March 2022 nor for the year ended 31st March 2021.

No expenses were paid to Trustees during the year (2021: £64.20 paid in travel expenses to one trustee).

STAFF COSTS	2022	2021
	£	£
Wages and salaries	405,564	346,969
Employer costs - National Insurance	27,415	18,027
Pension costs	7,026	5,510
	<u>440,005</u>	<u>370,507</u>

The average number of full-time equivalent employees during the year was as follows:

18 18

No employees had emoluments in excess of £60,000 (2021: nil).

Key management personnel comprise the Centre Co-ordinator and Business Manager whose combined employee benefits totalled £64,922 (2021: £58,642) including pension contributions.

6. TANGIBLE FIXED ASSETS	Fixtures, fittings		Total 2022
	Leasehold etc	& equip	
	£	£	
Costs			
As at 31st March 2021	354,463	53,350	407,813
Additions	0	0	0
At 31 March 2022	<u>354,463</u>	<u>53,350</u>	<u>407,813</u>
Depreciation			
As at 31st March 2021	149,789	53,350	203,139
Charge for the year	14,179	0	14,179
At 31 March 2022	<u>163,968</u>	<u>53,350</u>	<u>217,318</u>
Net Book Value			
31st March 2022	<u>190,495</u>	<u>0</u>	<u>190,495</u>

Norton Hall Children and Family Centre

Notes to the Financial statements
for the year ended 31st March 2022

Note

7. DEBTORS: AMOUNTS FALLING DUE WITHIN ONE YEAR

	2022	2021
	£	£
Trade Debtors	38972	22,653
Prepayments	3354	926
Total Debtors	42,326	23,578

8. CREDITORS: AMOUNTS FALLING DUE WITHIN ONE YEAR

	2022	2021
	£	£
Trade Creditors	65046	21,697
Tax and social security	5685	6,133
Accrued expenses	800	800
FutureBuilders loan	4656	5,136
Total Creditors	76,187	33,765

9. CREDITORS: AMOUNTS FALLING DUE AFTER ONE YEAR

Futurebuilders loan	0	4,899
---------------------	----------	--------------

10. ANALYSIS OF NET ASSETS BETWEEN FUNDS

	Unrestricted Funds £	Restricted Funds £	Designated Funds £	2022 Funds £	2021 Total Funds £
Fixed Assets	50,282	140,213	0	190,495	204,673
Net Current Assets	71,121	29,023	90,000	190,144	237,526
Long term Liabilities	0	0	0	0	(4,899)
Total	121,403	169,236	90,000	380,639	437,300

Norton Hall Children and Family Centre

Notes to the Financial statements
for the year ended 31st March 2022

Note

11. FUNDS

	Opening Balance £	Income £	Expenditure £	Transfers £	Closing Balance £
Unrestricted Funds					
General Fund	161,397	396,187	382,601	-53,580	121,403
Designated Fund - Maintenance & Redundancy Reserve	60,000	0	20,000	50,000	90,000
Restricted Funds					
BCC - Valuing Worth rent grant- NH	0	26,211	26,211	0	0
BCC - Valuing Worth rent grant- Dolphin	0	25,000	25,000	0	0
Children In Need - Young Carers	1,274	0	1,280	6	0
Pupil Premium	0	819	819	0	0
EYSE	0	7,170	7,170	0	0
HS2 CEF	2,189	12,540	14,729	0	0
Power to Change	6,441	0	6,441	0	0
Coronavirus Job Retention Scheme	0	12,404	12,404	0	0
Healthy Happy Holidays	0	109,239	97,494	0	11,745
REACH	14,608	0	14,608	0	0
TNL Community Fund Development Grant	37,000	0	40,574	3,574	0
Good Things Foundation	0	9,145	3,658	0	5,487
The Longhurst Foundation	0	5,000	1,000	0	4,000
BCC Building Development	0	12,500	12,500	0	0
Commonwealth Games Legacy	0	9,700	1,909	0	7,791
Capital assets funds	154,391	0	14,178	0	140,213
	215,903	229,728	279,975	3,580	169,236
Total Funds	437,300	625,915	682,576	0	380,639

BCC Valuing Worth : Grants from Birmingham City Council to offset the rent of the properties used by the charity

Children in Need : A grant to support positive activities for young carers

Pupil Premium : Funds to provide improved nursery facilities and activities

EYSE : a grant to support nursery provision for those with additional needs

HS2 CEF : a grant to support a volunteering project to maintain and improve Ward End Park

Power to Change : a grant to deliver services in the local community to support those affected by Covid 19

Coronavirus Job Retention Scheme : a grant to cover costs of staff on furlough

REACH : A grant for business planning and financial modelling for the planned expansion of the Dolphin Centre

TNL Community Fund Development Grant : a grant to meet professional fees to progress the expansion of the Dolphin Centre

Good Things Foundation: funding to support women with digital literacy.

The Longhurst Foundation – grant towards a gardening and environmental programme for women at the Dolphin Centre.

BCC Building Development – funding from Birmingham City Council / ERDF to project manage the refurbishment of the Dolphin Centre.

Commonwealth Games Legacy: funding for activities and services for women at the Dolphin Centre.

Capital assets funds : Grants received towards the capitalised costs of the improvements made to the leasehold property

12. COMMITMENTS

The total of future minimum lease payments under non- cancellable operating leases are:

Within one year - £1,210 (£1,210 comparative)

Between one and five years - £2,117 (£3,327 comparative)

13. RELATED PARTY TRANSACTIONS

There were no transactions with related parties during the year or previous year that require disclosure in these accounts.

Norton Hall Children and Family Centre

**Notes to the Financial statements
for the year ended 31st March 2022**

Note

**14. Comparative statement of Financial Activities
(incorporating an Income and Expenditure Account)
for the year ended 31st March 2021.**

	Unrestricted Funds £	Designated Funds £	Restricted Funds £	Total Funds £
INCOME FROM:				
Donations & legacies	16,500	0	51,211	67,711
Charitable activities	352,772	0	276,561	629,333
TOTAL INCOME	369,272	0	327,772	697,044
EXPENDITURE ON:				
Raising funds	11,058	0	0	11,058
Charitable Activities	211,637	0	350,737	562,374
TOTAL EXPENDITURE	222,695	0	350,737	573,432
NET INCOME and net movement in funds for year	146,578	0	(22,965)	123,612
Transfers between funds	-60,000	60,000	0	0
NET MOVEMENT IN FUNDS	86,578	60,000	-22,965	123,612
RECONCILIATION OF FUNDS:				
Total funds brought forward	74,819	0	238,868	313,687
TOTAL FUNDS CARRIED FORWARD	221,397	60,000	215,903	437,300

NORTON HALL CHILDREN AND FAMILY CENTRE

England & Wales - Charity number 1112752

Accounts

COMPANY NO : 5052641

CHARITY NO : 1112752

**REPORT OF THE TRUSTEES AND
FINANCIAL STATEMENTS FOR THE YEAR ENDED 31 MARCH 2021
FOR
NORTON HALL CHILDREN & FAMILY CENTRE**

NORTON HALL CHILDREN & FAMILY CENTRE

**COMPANY INFORMATION
FOR THE YEAR ENDED 31 MARCH 2021**

TRUSTEES:	Ms W Kerr Ms G Parveen Mr J Freeman Mr I Karim Ms M Khan
SECRETARY:	I Karim
CENTRE CO-ORDINATOR:	S Knipe
REGISTERED OFFICE:	Norton Hall Children & Family Centre Ralph Road Saltley Birmingham B8 1NA 5052641 (England and Wales)
REGISTERED CHARITY NUMBER :	1112752
INDEPENDENT EXAMINER :	P & W Social Accountants The Barn 173 Church Road, Northfield Birmingham B31 2LX
BANKERS:	Unity Trust Bank Nine Brindleyplace Birmingham B1 2HB

NORTON HALL CHILDREN & FAMILY CENTRE

REPORT OF THE TRUSTEES

FOR THE YEAR ENDED 31 MARCH 2021

The Trustees are pleased to present their annual directors' report together with the financial statements of the charity for the year ended 31 March 2021, which are also prepared to meet the requirements for a directors' report and accounts for Companies Act purposes. The financial statements comply with the Charities Act 2011, the Companies Act 2006, the Memorandum and Articles of Association, and Accounting and Reporting by Charities: Statement of Recommended Practice applicable to charities preparing their accounts in accordance with the Financial Reporting Standard applicable in the UK and Republic of Ireland (FRS102) (updated 1 January 2019).

OBJECTS AND ACTIVITIES

The objects of the charity, as set out in its Memorandum of Association are:

1. To relieve poverty and advance health and education in the City of Birmingham, and in particular to address the needs of disadvantaged women, children and young people in the Hodge Hill, Ladywood and Small Heath constituencies, by (without excluding the generality of the foregoing) :
 - a) providing a community nursery and provision for out of school childcare, and generally promoting the development of childcare provision aimed at meeting the needs of low income families.
 - b) running holiday play schemes and other children's play provision.
 - c) developing support and provision for young people, including youth work with girls and young women.
 - d) providing opportunities for education, training and personal development.
 - e) providing support for the economic advancement of women, including supporting women into employment and enterprise.
 - f) providing such further facilities as may be beneficial for the wider community in the area of benefit.
2. To promote and organise co-operation in the achievement of the above purposes.

This year, the charity provided the following services :

- **'Sunflower' Nursery.** This service supports families on low incomes with children whose social and educational starting point is significantly lower than the national average. We provide 'OUTSTANDING' Pre-School Education which builds strong educational foundations for the future
- **Out of School Care and Holiday care service** providing childcare places for local working parents, for 40 children each day aged between 6 and 14 years
- **The 'Starfish' Mentoring Support and Positive Activities Project.** This service supports vulnerable and disadvantaged children & young people and children with learning difficulties and special educational needs. We provide a range of activities, play opportunities and one to one mentoring.
- **The Dolphin Women's Centre,** providing a range of services that empower local women and support them to improve their health, skills, education and employability. Working with partners, We provide Education, Training, Employment and Mental Health and Wellbeing support.

All of the Centre's activities are aimed at supporting local children and families, in an area of high deprivation. No member of the company, including the Trustees, receive any financial benefit from their involvement with the Centre.

In developing activities and delivering services, the Trustees have taken account of the guidance published by the Charity Commission on public benefit.

ACHIEVEMENTS AND PERFORMANCE

Our vision is for a community where children and young people can fulfil their potential and where women are empowered to overcome multiple disadvantages.

This year we have faced significant challenges because of the COVID pandemic and the lockdown of the country in March 2020.

At the start of the pandemic in March 2020 we had to close both of our centres and furlough most of our staff. During this time, we undertook telephone surveys to identify the immediate impact the lockdown was having on our local community. As a result of this consultation, we re-shaped our services with a focus on four key areas :

- Mental Health and Wellbeing
- Digital exclusion
- Educational and Parental Support
- Food insecurity

NORTON HALL CHILDREN & FAMILY CENTRE

REPORT OF THE TRUSTEES (CONTINUED)

FOR THE YEAR ENDED 31 MARCH 2021

After the first few weeks of lockdown, we re-opened our services to provide childcare support for children of key workers, children with special educational needs and the most vulnerable children. We also opened our Dolphin Women's Centre to provide an emergency drop-in service for the most vulnerable women in our community. The rest of our services we adapted to provide these virtually online and through telephone support.

Throughout this year we supported a total of **640** women, children, and families in the following areas:

MENTAL HEALTH & WELLBEING

- We supported **280** Women, children & young people with mental health & wellbeing
- Throughout the pandemic we carried out 2,656 individual wellbeing support calls
- We offered intensive wellbeing support to 78 people
- We referred 21 people to specialist mental health services
- We safely delivered 495 face-to-face play and positive activity sessions to 188 vulnerable children and young people
- We conducted 71 on-line sessions for children & young people

EDUCATION & PARENTAL SUPPORT

- We offered educational support to **170** families
- We delivered intensive support to **29** parents with children who have complex special educational needs
- We supported **49** families to access on-line education
- We provided **495** educational resources and activity packs

DIGITAL EXCLUSION

- We supported a total of **221** people to get on-line
- **58** parents were supported to access information and make school applications
- **32** women were provided with IT equipment and internet access and helped to set up email accounts
- **163** women were supported to use platforms such as zoom to continue with their learning journeys
- **781** online women's training sessions were delivered and accessed by **220** women

FOOD POVERTY

- We provided **2,004** hot meals and lunches to local children
- We delivered **478** food parcels to local families
- We signposted **181** families to food banks and other food support services
- **37** Women received employability support
- **30** families received benefits advice and support

During the year we have continued to work with Birmingham City Council and other key stakeholders to secure capital funding of £2.4 million for the regeneration of Ward End Park and refurbishment of the Dolphin Centre.

We have continued to collaborate with a wide range of organisations and schools, drawing in specialist skills and services to improve and enhance the services we provide to our local community, and this year we worked collaboratively with a total of 65 partner organisations.

The Trustees would like to thank our dedicated staff team, our volunteers, our partners and funders for their support over this challenging year, enabling us to support some of the most vulnerable and disadvantaged women and children in our community.

FINANCIAL REVIEW

While 2020-21 was an extremely challenging year operationally, it was a successful year financially. While our income from self-generated activities (Nursery and Out of School fees and Dolphin Centre lettings) was down on the previous year, we were able to offset this through loss of business insurance. Staff costs were reduced through use of the Covid Job Retention Scheme, while in the second part of the year, we received two very generous donations, from the National Lottery Community Fund and from Power to Change, which enabled us to show a surplus on our Unrestricted funds. We were also able to upgrade the IT suite at the Dolphin Centre, and to redecorate and re-furnish the Nursery rooms at Norton Hall.

The Trustees agreed a budget for the year with five main cost centres : the Day Nursery, Out of School and work with Young People, Dolphin Centre, Community use, and core costs. Day to day financial management is devolved to the Centre Co-ordinator and the Business Manager, but the Board received regular management accounts, showing the actual performance compared to budget.

NORTON HALL CHILDREN & FAMILY CENTRE

REPORT OF THE TRUSTEES (CONTINUED)

FOR THE YEAR ENDED 31 MARCH 2021

Where grants are given for specific purposes, they are treated as Restricted Funds. In the year to 31 March 2021, there were 13 restricted funds (2020 : 10), and tracking and managing these funds is a major part of the charity's financial management. We are grateful to all our funders for their valuable support.

In the year to 31 March 2021 64.6% (2020: 66.9%) of the expenditure went on staff salaries and employer costs, and 12.9% (2020: 13.2%) on the direct cost of the Centre's activities. The remaining 22.5% (2020: 19.9%) was spent on premises, overheads, governance, fundraising and depreciation.

The Trustees have assessed the major risks to which the charity is exposed and are satisfied that systems are in place to mitigate our exposure to the major risks.

The Trustees have adopted a policy on reserves. Due to uncertainties and the short term nature of much of the charity's funding, the aim is to hold sufficient reserves in the Unrestricted Fund to allow it to operate for a period of 3 months and/or to meet redundancy costs for posts that cannot be sustained. This would require reserves of around £120,000. Current free reserves, at £161,397 are well above this agreed target, and the Trustees were also able to create a Designated Reserve fund of £60,00 to cover possible redundancies and ongoing building maintenance.

Trustees have reviewed the financial position of the charity over the next 12 months which has included a review of the budget for the year to 31 March 2022 and anticipated funding into 2023. Trustees are confident that sufficient funding will be available to continue to run the charity for the next 12 months and have a number of contingency plans in place to deal with a shortfall in funding within one or more of its current activities.

STRUCTURE, GOVERNANCE AND MANAGEMENT

The company is constituted as a not for profit Company Limited by Guarantee having no share capital, and is also a charity registered with the Charity Commission. It is governed by its Memorandum and Articles of Association, and the policies made from time to time by its Directors, who are also the trustees of the charity.

The Trustees are elected at the AGM, with one third standing down each year. The Trustees also have the power to co-opt up to 3 further trustees. At least 60% of the Trustees must be women.

The Trustees serving during the year under review and at the date of this report were:

Ms Wendy Kerr

Ms Ghazala Parveen

Mr John Freeman

Mr Iftikar Karim

Ms Maryam Khan

STATEMENT OF DIRECTORS' RESPONSIBILITIES

The trustees are responsible for preparing the financial statements in accordance with applicable law and regulations. Company law requires the trustees to prepare financial statements for each financial year. Under that law the trustees have elected to prepare the financial statements in accordance with United Kingdom Generally Accepted Accounting Practice (United Kingdom Accounting Standards and applicable law). The financial statements are required by law to give a true and fair view of the state of affairs of the company and of the profit or loss of the company for that period. In preparing these financial statements, the trustees are required to :

- select suitable accounting policies and then apply them consistently;
- make judgements and estimates that are reasonable and prudent;
- prepare the financial statements on the going concern basis unless it is inappropriate to presume that the company will continue in business.

The trustees are responsible for keeping proper accounting records which disclose with reasonable accuracy at any time the financial position of the company and to enable them to ensure that the financial statements comply with the Companies Act 2006. They are also responsible for safeguarding the assets of the company and hence for taking reasonable steps for the prevention and detection of fraud and other irregularities.

**NORTON HALL CHILDREN & FAMILY CENTRE
REPORT OF THE TRUSTEES (CONTINUED)
FOR THE YEAR ENDED 31 MARCH 2021**

INDEPENDENT EXAMINER

The Trustees have appointed P&W Social Accountants to undertake this role.

This report has been prepared in accordance with the special provisions of Part 15 of the Companies Act 2006 relating to small companies.

APPROVAL

This Report was approved by the Board of Trustees and signed on its behalf.

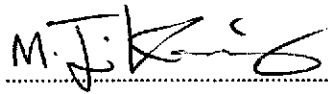
.....

Date 29/09/2021

I Karim - Trustee

**INDEPENDENT EXAMINER'S REPORT TO THE TRUSTEES OF
NORTON HALL CHILDREN & FAMILY CENTRE ('THE COMPANY')
FOR THE YEAR ENDED 31 MARCH 2021**

I report to the charity trustees on my examination of the accounts of the Company for the year ended 31 March 2021.

Responsibilities and basis of report

As the charity's trustees of the Company (also its directors for the purposes of company law) you are responsible for the preparation of the accounts in accordance with the requirements of the Companies Act 2006 ('the 2006 Act').

Having satisfied myself that the accounts of the Company are not required to be audited under Part 16 of the 2006 Act and are eligible for independent examination, I report in respect of my examination of your charity's accounts as carried out under section 145 of the Charities Act 2011 ('the 2011 Act'). In carrying out my examination I have followed the Directions given by the Charity Commission under section 145(5)(b) of the 2011 Act.

Independent Examiner's statement

Since the Company's gross income exceeded £250,000 your examiner must be a member of a body listed in section 145 of the Act. I can confirm that I am qualified to undertake the examination because I am a member of the Institute of Chartered Accountants in England & Wales, which is one of the listed bodies.

I have completed my examination. I can confirm that no matters have come to my attention in connection with the examination giving me cause to believe:

1. accounting records were not kept in respect of the Company as required by section 386 of the 2006 Act; or
2. the accounts do not accord with those records; or
3. the accounts do not comply with the accounting requirements of section 396 of the 2006 Act other than any requirement that the accounts give a 'true and fair' view which is not a matter considered as part of an independent examination; or
4. the accounts have not been prepared in accordance with the methods and principles of the Statement of Recommended Practice for accounting and reporting by charities applicable to charities preparing their accounts in accordance with the Financial Reporting Standard applicable in the UK and Republic of Ireland (FRS102).

I have no concerns and have come across no other matters in connection with the examination to which attention should be drawn in this report in order to enable a proper understanding of the accounts to be reached.

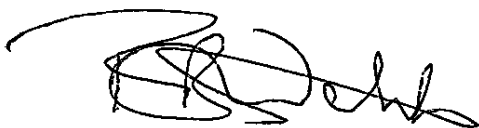

P & W Social Accountants
The Barn
173 Church Road,
Northfield
Birmingham
B31 2LX

Date 29TH SEPTEMBER 2021

Norton Hall Children and Family Centre

Statement of Financial Activities (incorporating an Income and Expenditure Account)
for the year ended 31st March 2021

	Notes	Unrestricted Funds £	Designated Funds £	Restricted Funds £	2021 Total Funds £	2020 Total Funds £
INCOME FROM:						
Donations & legacies	2	16,500		51,211	67,711	75,611
Charitable activities	3	352,772		276,561	629,333	511,201
TOTAL INCOME		369,272		327,772	697,044	586,812
EXPENDITURE ON:						
Raising funds	4	11,058			11,058	9,200
Charitable Activities	4	211,636		350,737	562,373	494,023
TOTAL EXPENDITURE		222,694		350,737	573,431	503,223
NET INCOME/(EXPENDITURE)		146,578		-22,965	123,613	83,589
Transfers between funds		-60,000	60,000		0	
NET MOVEMENT IN FUNDS		86,578	60,000	-22,965	123,613	83,589
RECONCILIATION OF FUNDS:						
Total funds brought forward		74,819		238,868	313,687	230,098
TOTAL FUNDS CARRIED FORWARD		161,397	60,000	215,903	437,300	313,687

The statement of financial activities includes all gains and losses recognised in the year.
All income and expenditure derive from continuing activities.

Balance Sheet
As at 31st March 2021

		2021	2020
		£	£
	Notes		
FIXED ASSETS			
Tangible assets	6	204,673	219,330
CURRENT ASSETS			
Debtors & prepayments	7	23,578	27,106
Cash at bank & in hand		247,713	94,313
		<u>271,291</u>	<u>121,419</u>
CREDITORS			
Amounts falling due within one year	8	33,765	19,877
NET CURRENT ASSETS		<u>237,526</u>	<u>101,542</u>
TOTAL ASSETS LESS CURRENT LIABILITIES		<u>442,199</u>	<u>320,872</u>
CREDITORS			
Amounts falling due after more than one year	9	4,899	7,185
NET ASSETS		<u>437,300</u>	<u>313,687</u>
FUNDS OF THE CHARITY	11		
Unrestricted funds		161,397	74,819
Designated funds		60,000	
Restricted funds		215,903	238,868
TOTAL FUNDS		<u>437,300</u>	<u>313,687</u>

For the year ending 31st March 2021 the company was entitled to exemption from audit under section 477 of the Companies Act 2006 relating to small companies.

Director's responsibilities :

The members have not required the company to obtain an audit of its accounts for the year in question in accordance with section 476 of the Companies Act 2006. However, in accordance with Section 145 of the Charities Act 2011, the financial statements have been examined by an Independent Examiner, whose report is included in these accounts.

The directors acknowledge their responsibilities for complying with the requirements of the Companies Act 2006 with respect to accounting records and the preparation of accounts.

These accounts have been prepared in accordance with the provisions applicable to companies subject to the small companies regime.

On Behalf of the Board:

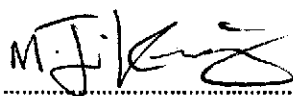
.....

I Karim - Trustee

29th September 2021
.....

Approved by the Board on

Norton Hall Children and Family Centre

Notes to the Financial statements for the year ended 31st March 2021

Note

1. ACCOUNTING POLICIES

Basis of preparation

The financial statements have been prepared in accordance with Accounting and Reporting by Charities: Statement of Recommended Practice applicable to charities preparing their accounts in accordance with the Financial Reporting Standard applicable in the UK and Republic of Ireland (FRS102)(effective 1 January 2015) - (Charities SORP (FRS102)), the Financial Reporting Standard applicable in the UK and Republic of Ireland (FRS102) and the Companies Act 2006.

Norton Hall Children and Family Centre meets the definition of a public benefit entity under FRS102. Assets and liabilities are initially recognised at historical cost or transaction value unless otherwise stated in the relevant accounting policy note(s).

The reporting currency is £ Sterling.

Preparation of the accounts on a going concern basis

The financial statements have been prepared on a going concern basis which assumes that the Company will continue to operate. The validity of this assumption is dependent upon the continuance of support from the Company's key grant funders and in response to the progress made by the Company in pursuing a viable budget including the obtaining of further grants and other funds. The Company's current business plan shows that the Company will be able to operate in the foreseeable future. Based on this understanding, the directors believe that it remains appropriate to prepare the financial statements on a going concern basis. The financial statements do not include any adjustments which would result from the basis of preparation being inappropriate.

Tangible fixed assets

Depreciation is provided at the following annual rates in order to write off each asset over its estimated useful life (assets with a cost below £1,000 are not capitalised) :

Fixtures, fittings & equipment	-25% per annum straight line
Improvements to property	- 25 years straight line

Income

Items of income are recognised and included in the accounts when all of the following criteria are met:

- The charity has entitlement to the funds;
- any performance conditions attached to the item(s) of income have been met or are fully within the control of the charity;
- there is sufficient certainty that receipt of the income is considered probable; and
- the amount can be measured reliably.

Expenditure

Expenditure is recognised once there is a legal or constructive obligation to make a payment to a third party, it is probable that settlement will be required and the amount of the obligation can be measured reliably.

Expenditure is classified under the following activity headings:

- Costs of raising funds comprise staff costs and other direct costs involved in the raising of funds for the charity;
- Expenditure on charitable activities includes the direct costs of activities undertaken to further the purposes of the charity and their associated support & governance costs.

Irrecoverable VAT is charged as a cost against the activity for which the expenditure was incurred.

Taxation

The charity is exempt from corporation tax on its charitable activities.

Fund Accounting

Unrestricted Funds can be used in accordance with the charitable objectives at the discretion of the trustees.

Restricted funds can only be used for the particular restricted purposes within the objects of the charity. Restrictions arise when specified by the donor or when funds are raised for a particular restricted purpose.

Further explanation of the nature and purpose of each fund is included in the notes to the financial statements.

Debtors

Trade and other debtors are recognised at the settlement amount due after any trade discount offered. Prepayments are valued at the amount prepaid after taking account of any trade discounts due.

Cash at bank and in hand

Cash at bank and cash in hand includes cash and short term highly liquid investments with a short maturity of three months or less from the date of acquisition or opening of the deposit or similar account.

Creditors and provisions

Creditors and provisions are recognised where the charity has a present obligation resulting from a past event that will probably result in the transfer of funds to a third party and the amount due to settle the obligation can be measured or estimated reliably. Creditors and provisions are normally recognised at their settlement amount after allowing for any trade discounts due.

Pension costs

The Company operates a money purchase pension scheme for employees. Employer contributions are charged as an expense in the period to which they relate and are allocated to activities in line with the related salary cost.

Norton Hall Children and Family Centre

Notes to the Financial statements for the year ended 31st March 2021

Note

2. INCOME FROM DONATIONS & LEGACIES

	2021	2020
	£	£
Donations	16,500	24,400
Restricted grants:		
BCC Norton Hall Valuing Worth grant	26,211	26,211
BCC Dolphin Centre Valuing Worth grant	25,000	25,000
	<u>51,211</u>	<u>51,211</u>
Total	<u>67,711</u>	<u>75,611</u>

3.

	2021	2020
	£	£
Restricted grants:		
Children in Need - Young Carers	9,963	9,963
Pupil Premium	668	3,227
EYSE	8,620	7,104
HS2 CEF	24,971	24,756
TNL COVID Response Fund	89,540	
Power to Change	58,872	
Communities & Families Fund	9,362	
Coronavirus Job Retention Scheme	74,566	4,533
Healthy Happy Holidays		27,320
REACH		25,282
TNLC Development Grant		47,000
	<u>276,561</u>	<u>149,185</u>
Income from charitable activities:		
Nursery	136,663	156,217
Children and Young People	150,795	153,479
Dolphin Centre	40,344	50,619
Lettings	20	1,701
Other	24,950	
	<u>352,772</u>	<u>362,016</u>
Total	<u>629,333</u>	<u>511,201</u>

Norton Hall Children and Family Centre

Notes to the Financial statements
for the year ended 31st March 2021

Note

4. EXPENDITURE	2021	2020
Charitable Activities:		£
Establishment costs	107,742	76,756
Staff costs	360,248	328,567
Direct cost of activities	73,544	66,180
Depreciation	14,656	15,667
FutureBuilders loan interest	582	1,203
Independent Examiner's Fee	800	850
Finance costs	4,800	4,800
	<u>562,373</u>	<u>494,023</u>
Raising funds:		
Staff costs	10,258	8,400
Other direct costs	800	800
	<u>11,058</u>	<u>9,200</u>
	<u>573,431</u>	<u>503,223</u>

5. STAFF COSTS, TRUSTEES REMUNERATION AND EXPENSES

There were no trustees remuneration or other benefits for the year ended 31st March 2021 nor for the year ended 31st March 2020.

£64.20 was paid in travel expenses to one trustee (2020: no trustees expenses paid).

STAFF COSTS	2,021	2020
	£	£
Wages and salaries	346,969	315,981
Employer costs - National Insurance	18,027	16,114
Pension costs	5,510	4,872
	<u>370,507</u>	<u>336,967</u>

The average number of full-time equivalent employees during the year was as follows:

18	18
----	----

No employees had emoluments in excess of £60,000 (2020: nil).

Key management personnel comprise the Centre Co-ordinator and Business Manager whose combined employee benefits totalled £58,642 including pension contributions.

6. TANGIBLE FIXED ASSETS	Fixtures, fittings		Total 2021	Total 2020
	Leasehold etc	& equip		
	£	£		
Costs				
As at 31st March 2020	354,462	53,350	407,813	407,813
Additions	-	-		-
At 31 March 2021	<u>354,462</u>	<u>53,350</u>	<u>407,813</u>	407,813
Depreciation				
As at 31st March 2020	135,611	52,872	188,483	172,185
Charge for the year	14,178	478	14,656	15,668
At 31 March 2021	<u>149,789</u>	<u>53,350</u>	<u>203,139</u>	188,483
Net Book Value				
31st March 2021	<u>204,673</u>	<u>0</u>	<u>204,673</u>	204,673
31st March 2020	<u>218,851</u>	<u>478</u>	<u>219,330</u>	219,330

Norton Hall Children and Family Centre

Notes to the Financial statements for the year ended 31st March 2021

Note

7. DEBTORS: AMOUNTS FALLING DUE WITHIN ONE YEAR

	2021	2020
	£	£
Trade Debtors	22,653	23,888
Prepayments	926	3,218
Total Debtors	23,578	27,106

8. CREDITORS: AMOUNTS FALLING DUE WITHIN ONE YEAR

	2021	2020
	£	£
Trade Creditors	21,697	9,821
Tax and social security	6,133	4,070
Accrued expenses	800	850
FutureBuilders loan	5,136	5,136
	33,765	19,877

9. CREDITORS: AMOUNTS FALLING DUE AFTER ONE YEAR

Futurebuilders loan	4,899	7,185
---------------------	--------------	--------------

10. ANALYSIS OF NET ASSETS BETWEEN FUNDS

	Unrestricted Funds £	Restricted Funds £	Designated Funds £	2021 Total Funds £	2020 Total Funds £
Fixed Assets	50,281	154,392		204,673	219,330
Net Current Assets	116,014	61,511	60,000	237,525	101,542
Long term Liabilities	(4,899)			(4,899)	(7,185)
	161,397	215,903	60,000	437,300	313,687

Norton Hall Children and Family Centre

Notes to the Financial statements for the year ended 31st March 2021

Note

11. FUNDS

	Opening Balance £	Income £	Expenditure £	Transfers £	Closing Balance £
Unrestricted Funds					
General Fund	74,819	369,272	222,694	-60,000	161,397
Designated Fund - Maintenance & Redundancy Reserve				60,000	60,000
Restricted Funds					
BCC - Valuing Worth rent grant- NH	-	26,211	26,211		0
BCC - Valuing Worth rent grant- Dolphin	-	25,000	25,000		0
Children in Need - Young Carers	1,263	9,963	9,952		1,274
Pupil Premium	1	668	669		0
EYSE	-	8,620	8,620		0
HS2 CEF	2,555	24,971	25,337		2,189
TNL COVID Response Fund		89,540	89,540		-
Power to Change		58,872	52,431		6,441
Communities & Families Fund		9,362	9,362		0
Coronavirus Job Retention Scheme		74,566	74,565		0
REACH	21,479		6,871		14,608
TNL Community Fund Development Grant	45,000		8,000		37,000
Capital assets funds	168,570		14,178		154,392
	238,868	327,772	350,737	0	215,903
Total Funds	313,687	697,044	573,432	0	437,300

BCC Valuing Worth : Grants from Birmingham City Council to offset the rent of the properties used by the charity

Children in Need : A grant to support positive activities for young carers

Pupil Premium : Funds to provide improved nursery facilities and activities

EYSE : a grant to support nursery provision for those with additional needs

HS2 CEF : a grant to support a volunteering project to maintain and improve Ward End Park

TNL COVID Response Fund : a grant to support the organisation through the pandemic

Power to Change : a grant to deliver services in the local community to support those affected by Covid 19

Communities & Families Fund : grant from BVSC to provide positive educational play activities and specialist parental support

Coronavirus Job Retention Scheme : a grant to cover costs of staff on furlough

REACH : A grant for business planning and financial modelling for the planned expansion of the Dolphin Centre

TNL Community Fund Development Grant : a grant to meet professional fees to progress the expansion of the Dolphin Centre

Capital assets funds : Grants received towards the capitalised costs of the improvements made to the leasehold property

12. COMMITMENTS

The total of future minimum lease payments under non- cancellable operating leases are:

Within one year - £1,210 (£1,210 comparative)

Between one and five years - £2,117 (£3,327 comparative)

13. RELATED PARTY TRANSACTIONS

There were no transactions with related parties during the year or previous year that require disclosure in these accounts.

Norton Hall Children and Family Centre

Notes to the Financial statements
for the year ended 31st March 2021

Note

14. Comparative statement of Financial Activities
(incorporating an Income and Expenditure Account)
for the year ended 31st March 2020

	Unrestricted Funds £	Restricted Funds £	Total Funds £
INCOME FROM:			
Donations & legacies	24,400	51,211	75,611
Charitable activities	362,016	149,185	511,201
TOTAL INCOME	386,416	200,396	586,812
EXPENDITURE ON:			
Raising funds	9,200	0	9,200
Charitable Activities	344,741	149,282	494,023
TOTAL EXPENDITURE	353,941	149,282	503,223
NET INCOME and net movement in funds for year	32,475	51,114	83,589
RECONCILIATION OF FUNDS:			
Total funds brought forward	42,344	187,754	230,098
TOTAL FUNDS CARRIED FORWARD	74,819	238,868	313,687