

Southlands Methodist Trust

Review of Activities

September 2020 – August 2021



— S M T —



Overview and Introduction

The Trustees of the Southlands Methodist Trust (SMT) are pleased to offer this account of the charity's work during the course of the year 2020-21.

The charitable purposes of the Trust, its position within a collegiate university, and its reach into the broader learning life of the Church provide opportunities for creative and innovative interventions. Working so closely with institutions that share commitments to creating meaningful change and transforming lives, SMT interventions have the potential for significant impact on learning and practice. Throughout this report are examples of how the charity has advanced that mission.

The continuing challenges caused by the impact of the coronavirus pandemic during 2020-21 led to some limitations on our work, but it also continued to present opportunities for novel ways of working. It allowed us to embed innovative practice using new technologies, which emerged in the preceding year.

Those wishing to find out more about our work are invited to visit southlandsmethodisttrust.org.uk and susannawesleyfoundation.org, and to follow the social media accounts listed at the end of this report.

Thank you for taking an interest in the Southlands Methodist Trust. Please do contact the Trustees if you would like to work with us and help shape what we become in future years.



Dr Christopher Stephens
Head of Southlands College



The Reverend Dr Tim Macquiban
Chair of Trustees

Contents

Overview and Introduction	1
Contents	2
Administrative Details	3
Objectives and Activities	4
Research and Knowledge Exchange (RKE)	6
Research and Knowledge Exchange at Roehampton	6
Chaplaincy and the 'Most Significant Change' Project	12
The Susanna Wesley Foundation	14
Enriching Community Life	22
Enhancing Student Outcomes	23
Southlands Venture	24
Community Music	28
Awards, Prizes and Hardship/Access Grants	30
Supporting Chaplaincy	31
Nurturing Alumni Relationships	36
Managing our College Archives	38
Enhancing Methodist Education	40
Methodist Schools in Britain	42
Higher and Further Education	44
Europe and Worldwide	45
Southlands 150	46
Celebrating our History and Planning for our Future	47
Reimagining our College Buildings for a Sustainable Future	50
Saving Mount Clare Temple	54

Administrative Details

for the year ended 31st August 2021

Trustees:

Rev Dr Tim Macquiban, Chair
Rev Dr Jennifer Smith, Deputy Chair
Rev Dr Stan Brown
Rev Dr Joanne Cox-Darling
Mr Alan Davies (appointed October 2020)
Rev Geoffrey Farrar (appointed March 2021)
Dr Clive Norris
Rev Colin Smith
Rev Michaela Youngson (resigned June 2021)

Registered office:

Southlands College, 80 Roehampton Lane, London, SW15 5SL

Auditors:

haysmacintyre
Chartered Accountants
10 Queen Street Place
London EC4R 1AG

Solicitors:

Pothecary Witham Weld
70 St George's Square
London SW1V 3RD

Bankers:

Methodist Central Finance Board
9 Bonhill Street
London EC2A 4PE

HSBC
West End Corporate Banking Centre
70 Pall Mall
London SW1Y 5EZ

Objectives and Activities

The aims and purposes of the charity are:

1. as part of the work carried out through the Discipleship and Ministries Learning Network, to support in association with the college and university the development of Christian, and specifically Methodist, scholarship, research and innovation of local, national and global significance and to facilitate the public dissemination of such developments.
2. to enable members of the Methodist community and wider public in Britain and internationally to benefit from the academic and other expertise and experience within the college and the university and the facilities available within them.
3. to enrich the community life of the college and the work of its chaplaincy in ways that reflect its Methodist values and ethos.
4. to maintain and develop the relationship between the Methodist Church, the college and the university in the context of developing the contribution made to the work carried out through the Discipleship and Ministries Learning Network.
5. to further the wider charitable purposes of the Methodist Church through close working with the other persons and bodies responsible for the work carried out through the Discipleship and Ministries Learning Network.

Objectives and Activities



Research & Knowledge Exchange

The SMT participates fully in the research and knowledge exchange (RKE) agenda of Southlands College, helping to shape RKE activities across the University of Roehampton's departments, and especially focusing on work that most closely aligns with the priorities of the Methodist Church in Britain. It resources research projects, supports partnerships and facilitates the research of the Susanna Wesley Foundation.

Together with its sister colleges, Southlands College provides the physical spaces for the academic work of the University of Roehampton to take place; our colleges are the building blocks that provide the context for that work. However, the contributions of Southlands to the advanced academic activities of the university also extend into more direct contributions and resourcing.

During 2020-21, plans were formed to restructure considerably the university's RKE centres in order to focus work on key themes. Many of these themes



overlap with areas of interest in the mission of the Methodist Church and work was done to explore how, in practice, these centres can better collaborate with the Methodist Church to ensure an alignment of interest. As a result, in the coming academic year, representatives from Southlands will be included in the planning and development of the university's research priorities; the Director of the Susanna Wesley Foundation has been invited to take a role on the advisory board for the university's RKE Centre for Practical Philosophy, Theology and Religion. This opportunity for input will ensure that RKE activities at Southlands and through the Southlands Methodist Trust can be both informed by and also inform the RKE work of the wider research environment at Roehampton.

Project Sponsorship

In the reporting year, the Southlands Methodist Trust continued to fund RKE at the University of Roehampton in areas that meet the charitable objectives of the Trust and that have benefit to the public more broadly. Each year the Head of Southlands College works with the Trustees of the SMT to manage and administer a grants-awarding scheme for RKE work in the university that supports both the research profile of the university and the charitable purposes of the Trust. In 2020-21, a number of projects took place across Roehampton's departments, and a further series of grants were awarded for the following academic year.

Projects commenced during 2020-21:

1. *The effects of the coronavirus lockdown on children's psychosocial and educational adjustment during school transition*

What are the effects of the Covid-19 lockdown on pupils' outcomes, especially for those who undergo school transition simultaneously? This question can only be asked because we have a single historical event impacting people's lives at the same time. The aim of this study is to explore the effects of the Covid-19 lockdown on children's psychosocial and educational adjustment during school transition.

2. *The effect of COVID-19 lockdown on the learning journey of commuter students*

As a result of the lockdown imposed by COVID-19, the Roehampton Business School had to rapidly transition to more home and digitally based teaching and learning. The research proposed in this application will explore the effect of the changes on the learning journey of commuter students who are the majority in the Business School.

RKE at Roehampton

3. *The effects of the coronavirus lockdown on children's psychosocial and educational adjustment during school transition*

What are the effects of the Covid-19 lockdown on pupils' outcomes, especially for those who undergo school transition simultaneously? This question can only be asked because we have a single historical event impacting people's lives at the same time. The aim of this study is to explore the effects of the Covid-19 lockdown on children's psychosocial and educational adjustment during school transition.

4. *An investigation into social control by neglect*

The project is an investigation into social control by neglect; that is to say, the absence of institutional control and social support in the lives of certain groups. Key informants in four sites: criminal justice, disability welfare, homelessness and migration will be consulted. It is intended that a number of case studies will illustrate the conceptual parameters of this theory.

5. *Latin American professional women and men in the UK: A critical exploration of the workplace experiences and career trajectories of an understudied immigrant group*

This research project examines the workplace experiences, career trajectories and professional identities of Latin American professionals in London, an understudied immigrant group in the UK.

6. *Once More with Feeling: A reinvention of Hysteria using photography, performance and writing*

This project consists of an art exhibition and a series of corresponding satellite events. Over the year events and exhibitions will be held both at Roehampton and external institutions such as The Freud Museum (London) and the Royal College of Art (RCA). The project aims to generate public engagement concerning societal frameworks, historical and contemporary, of the repression of women.

7. *Public Engagement: Challenging myths of empire*

In an age of decolonising research and the curriculum (at all levels) it is important to question the increasing glorification of empire in recent years. Using public engagement tools, the Australian 'working man's paradise' narrative and the continuing belief that convicts transported to Australia in the nineteenth century were 'better off' can be challenged. This will be done through the creation of bi-monthly life-narratives of convicts who were transported to Australia and died as paupers.

8. *Phiroz Mehta*

This project seeks to capture and assess the philosophy and impact of Phiroz Mehta (1902-1994), an Indian spiritual teacher in 1970s-1990s Britain, whose impact remains undocumented outside of his close circle and who has not been analysed in an academic context.

Projects approved during the year for completion in 2021-22:

1. *Bridging the ethnic minority gap between educational development and doctoral supervision: Social justice and inclusivity*

This proposed study would produce a Doctoral Supervisor Resource Pack to support the educational development of supervisors in promoting networking skills and relational working for ethnic minority doctoral students. This pack will address aspects of culture, environment and vocational aspiration with a focus on student values and their alignment with those of their doctoral programmes.

2. *Reading4Normal Book Club*

The Reading4Normal Book Club is an online reading-group scheme that aims to bring together young readers to discuss young adult novels. The project would facilitate a nine-month Reading4Normal Book Club at six schools (two in the Wandsworth area linked to four across the UK), including an author event. It would support the creation of a website and social media programme.

3. *Understanding emotional journeys: the emotional impact of commuting and campus-based learning during the era of COVID-19*

This research engages with the emotional challenges faced by Roehampton students on their 'commute', whether onto campus or accessing e-learning remotely. Visual methods will provide a novel approach to conceptualising the emotional experience of these students through personal photographs and drawings related to their 'commute'. This will improve their emotional literacy and develop key employability skills like problem-solving, communication, creativity and self-management.

4. *Public Engagement: Diverse Shakespeare at Shakespeare's Globe*

This public engagement project will call on the research findings of the Engendering the Stage project team (based in the School of Humanities), to train key members of staff at Shakespeare's Globe in new research into diversity in the Shakespearean period.

RKE at Roehampton

5. *Productivity and food safety improvements for women in community mechanised palm oil processing: The Case of Ejisu Juaben Municipality, Ashanti Region, Ghana*

The overarching aim of this study is to evaluate the technological needs of women and specifically explore the technological, gender and food safety issues. To achieve the research aim, the lead investigator will be working with the country director of Self-Help International, Ghana and the Ashanti Regional Engineer for the Ministry of Food and Agriculture to gain access to the research subjects and key stakeholders.

6. *Growth Outlook for Family Businesses under Uncertainty: An Exploratory Study of the Local Business Community in South West London*

Under the backdrop of such an uncertainty-driven external environment, following the double-edged uncertainty of Brexit and the pandemic, the proposed research project aims to understand the resilience of (small) family businesses in South West London and investigate the complex interaction of these businesses with their external environments.

7. *The Potato Teeth Project: A comparison of classroom and garden-based educational interventions for oral hygiene in primary school pupils*

The project proposes to investigate the relative benefits of two similar, garden-themed intervention work packages for improving the oral health of primary school pupils. Both programmes will involve the same one-hour regimen of activities, facilitated by students from University of Roehampton, in conjunction with the Growhampton Student Union.

Large, collaborative projects

From time to time, staff at Southlands College work with the Trustees of the SMT and academics at Roehampton to shape projects that require a more significant funding commitment over a longer period.

During the reporting year, one such project involved research exploring examples of joint Methodist-Roman Catholic social action work across the United Kingdom. The project used participative, qualitative research methods and ways of reflecting on the data that are advocated in Theological Action Research. This project involved academics, theologians and practitioners coming together from a number of institutions to reflect on what had been heard from those on the ground in different ecumenical

RKE at Roehampton

contexts. The project engaged with a range of intentions and approaches, and has yielded some significant questions about what the church can learn from everyday ecumenism, the results of which will be published in future years.

Exploring ecumenism in practice has been a particular focus of work sponsored by the SMT in recent years, drawing on the Methodist Church's commitments in this area and aiming to honour the ecumenical heritage of the University of Roehampton and its founding colleges. Continuing this work, the Trustees agreed in the spring of 2021 to sponsor a new, significant project through the university's School of Humanities, called 'Faith Long Lived: Ecumenical Experiences of Saying the Creed'. The project will examine, empirically and theoretically, the experience of saying the creed in the context of Christian worship in some of the local faith communities in the Roehampton area, including Methodist communities.

RKE and Chaplaincy

The ‘Most Significant Change’ Project was an action research project, led by the Susanna Wesley Foundation, involving the multi-faith chaplaincy team at Roehampton.

The purpose of the project was to explore the contribution that chaplaincy makes to the life of the university and to the staff and student education experience in particular, and to find ways of capturing and demonstrating that contribution. Part of the project involved determining an appropriate method for uncovering impact within the context of religious ministry and the MSC methodology was chosen as an approach that accommodated the distinctive nature of chaplaincy and its intentions.

The MSC methodology involves collecting stories that reveal some change or impact. It has been used in a range of charities and non-governmental organisations where the *raison d'être* is social change, and where more traditional approaches to monitoring and evaluation have not been found to take account of the complexity of the work or reflect the nature of the changes being sought. Similarly, in relation to chaplaincy (and HE chaplaincy in particular), it is difficult to track impact and to do so in such a way that recognizes the subtleties of the work.

The project has been a collaborative process involving testing a version of the MSC methodology and using it as a vehicle for individual and team learning. Whilst gathering stories and mining them for meaning has been part of the project, the process has also aimed to uncover something about what is most valued by different chaplains, their various callings and motivations, and their different understandings. More broadly, the process of undertaking the project together has provided an opportunity for exploring the place and purposes of chaplaincy within the context presented by the university.

An ‘Evaluation and Reflective Practice Tool’ for use in connection with chaplaincy activities and events has been developed as an outcome of the project. This will be trialled over the coming year, both to offer the chaplaincy team a means of reflecting on their work and its impact, and also in order to explore whether a contribution can be made into the wider HE sector, both in terms of scholarship and the development of practice. As this happens, questions around intention and impact will continue to feature at Roehampton as the chaplains work together to contribute to the flourishing of the university’s staff and students.

RKE and Chaplaincy



The Susanna Wesley Foundation



*"Like good stewards of the manifold grace of God,
serve one another with whatever gift each of you has
received."*

1 Peter 4: 10

The Susanna Wesley Foundation

The Susanna Wesley Foundation (SWF) is a community of scholars and practitioners based at Southlands College and supported directly by both the Southlands Methodist Trust and the University of Roehampton. The Foundation's purpose is to facilitate research and enquiry that influences practice and generates learning of benefit to the wider community.

Values and Approach

Throughout 2020-21, the Foundation continued to encourage conversations that brought together people from a range of academic, professional, cultural and faith backgrounds to generate new understandings and questions for future research and activity. In January 2021, SWF embarked on a new theme for the calendar year – 'Embodied Faith' – and in the light of the restrictions imposed by the pandemic, SWF's customary annual conference was re-imagined as a series of online events to discuss how embodiment connects with knowing, belonging and ministering. These events showcased the Foundation's values and approach in bringing together academics and practitioners, authors of secular books with published theologians, and clergy with lay, along with students, tutors, chaplains and community leaders. Central to the events were conversations between the speakers, and then breakout sessions in smaller groups followed by more open conversation. The aim was to create an environment that encouraged participation and the exchange of ideas between those with different perspectives, triggering creative thought and building connections across silos, whether disciplinary or other.

The impetus for the work of the Foundation continued to be to contribute to the building of flourishing communities – an ideal that aligns with the University of Roehampton's approach – and this was reflected in many of its activities and the research that it conducted and sponsored.

The SWF Community

Building connections between academics, practitioners and the wider community has thus continued: the employees, sponsored doctoral students, Associates and Honorary Research Fellows of the Foundation are

The Susanna Wesley Foundation

one – if a very significant – part of a larger group of people who participate in our activities, listen to our podcasts, and receive our regular newsletters. This determinedly relational approach is informed by our search for dialogue between research and practice.

Given this desire for exchange between academics and practitioners, SWF is an enthusiastic supporter of the university's professional doctorate in theology, and over the year has sponsored a number of students who have chosen this route in preference to a PhD. Their areas of study include: disability theology and embodied ways to know God; the work of lay employees within British Methodism and its relationship to vocation and calling; story-telling and culture change in local Methodist churches; and non-binary gender, the Bible, and Christian practice. SWF has also sponsored two other students to complete their PhDs. One of these students is using theological action research as his methodology – a participative approach to research that we favour in the Foundation – and a second student has been looking at the relationship between organisation theory and ecclesiology, thus bringing together different disciplines, another feature that we encourage.

Justice, Dignity and Solidarity

2020-21 has been a significant year in the Methodist Church's quest to become an inclusive church, with the development of its strategy around equality, diversity and inclusion. Members of the Susanna Wesley Foundation – staff and associates – contributed to this development, drawing on the previous work of the Foundation around cultural difference and around learning, transformation and systemic change. The outcome of this work in the Methodist Church has been termed a 'Strategy for Justice, Dignity and Solidarity'. Justice and inclusion is a priority area of interest for the Foundation and SWF will continue to work with the Church in this area. It also aligns with one of the University of Roehampton's research and knowledge exchange priorities: Social Justice and Inclusivity.

Given the priority accorded by the Foundation to this area, we also focused a number of podcasts, both in our 'Flourishing' (2020) and our 'Embodied Faith' (2021) series, around this theme: topics included neurodiversity, social activism and racial justice, and solidarity. These and other podcasts have been posted on the Foundation's website; some of them feature members of the university – students and staff – but also practitioners and clergy, Methodist and other. The aim is to facilitate conversation between those of different perspectives and backgrounds and, in the exchange, to generate new questions and understandings, both during the conversa-

The Susanna Wesley Foundation

If You Want to Go Far, Go Together:

Solidarity and embodied faith

Podcast guests:



**Luke
Larner**



**Farai
Mapamula**



Neurodiversity and Disability in the Church:

Gifts and needs

Podcast guests:



**Rachel
Noel**



**Fiona
MacMillan**



People, Poverty and Power:

Bending towards justice

Podcast guests:



**Justin
Thacker**



**Lucy
Zwolinska**

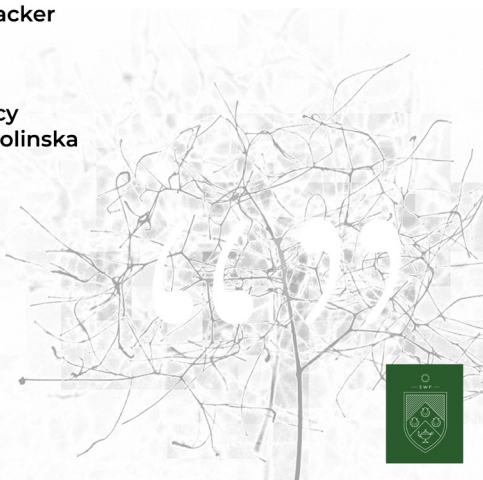

Transitioning Church:

Queer stories of cost, risk and gift

Podcast guests:



**Karl
Rutlidge**



**Jarel
Robinson Brown**



The Susanna Wesley Foundation

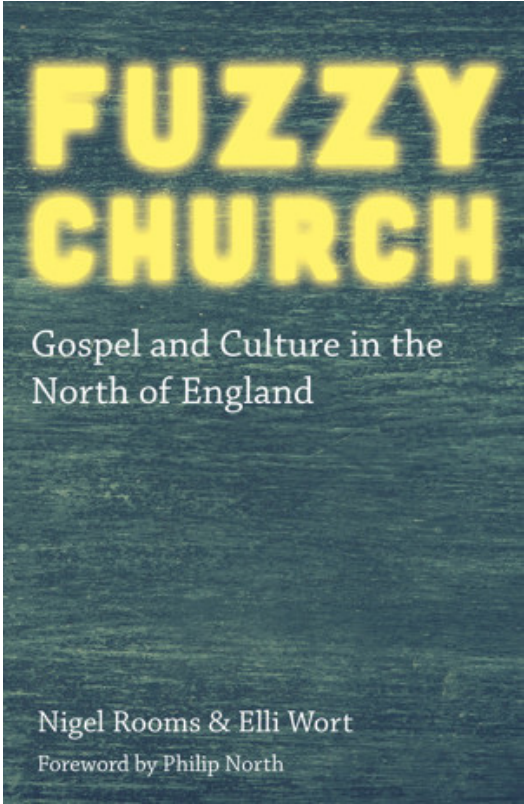
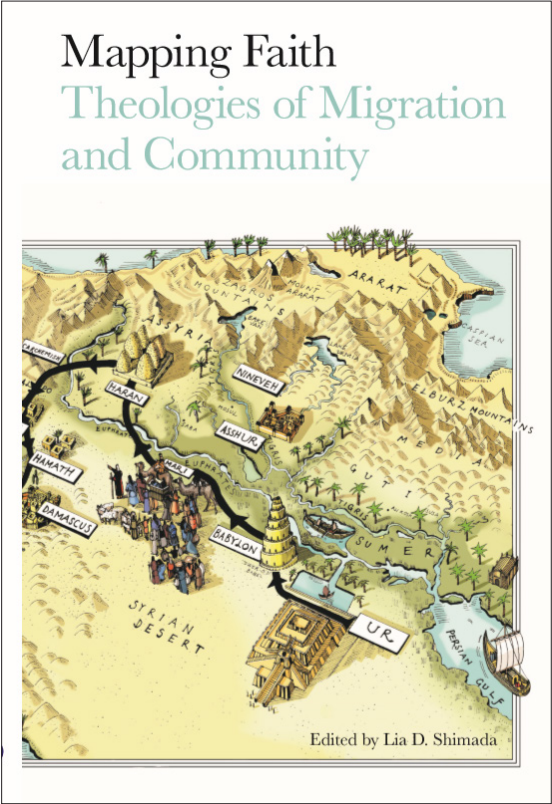

Research and Knowledge Exchange

18

Flourishing Ministers
Flourishing Communities

A resource from the
Susanna Wesley Foundation

The Susanna Wesley Foundation

tions themselves but also in their dissemination to others via the website, so serving our communities and promulgating our values. Such SWF work is in line with the university's philosophy of research and knowledge exchange and in accordance with many of the university's priorities in this regard, and all of it connects to the interface between faith and society.

Supporting academic dialogue and expanding participation

In the light of the lack of representation of those from the global majority in academic theology communities, the Foundation funded student bursaries for attendance at the Society for the Study of Theology (SST) and the British and Irish Association for Practical Theology (BIAPT) conferences. This is part of a package of initiatives being taken by these groups in their quest to become more inclusive, and thus to enhance their scholarship, and both listen and learn from a wider range of voices.

The Foundation also supported the University of Roehampton's Research Group in Theology, Religion and Practice, sponsoring some speakers and contributing others from its own community.

Well-being in ministry

SWF continued to sponsor work around well-being in ministry, with the completion of a project looking at a particular theory of human behaviour – Bowen family systems theory – and its application in the context of local churches. A resource entitled *Flourishing Ministers, Flourishing Communities* has grown out of this project, which provides ministers with insights into the interplay between self and system, and helps them to handle the dynamics involved in their roles; it will be launched soon. The colleague involved completed her doctorate at Roehampton, has previously delivered a seminar to the university's practical theology research group and has presented at SWF conferences. Such connections with the university's staff, students and alumni contribute to the life of the Foundation. In terms of the area of study, well-being is a priority area for the university and it will also continue to feature in the Foundation's work.

Work around learning, strategy and change

Work around learning and change continue to feature in the Foundation's portfolio, with ongoing projects in both areas. The theological action research project exploring learning in Methodism involving University of Roehampton academics has been of benefit to a number of Methodist

The Susanna Wesley Foundation

communities; disseminating the insights gained became the focus of the work in 2021. In relation to a project looking at models and understandings of change in the context of Methodism, 2020-21 has seen some empirical work, the findings from which will be shared in the 2021-22 academic year, along with those from another project looking at how 'Church strategy' is perceived and enacted in local contexts.

Publications and dissemination

In 2021, *Fuzzy Church: Gospel and Culture in the North of England* was published, a book that presents the findings and implications of qualitative field research that was sponsored by the Foundation in 2018-19. The authors, Nigel Rooms and Elli Wort, presented the book at an event sponsored by the Foundation in summer 2021, in partnership with the university's research group in theology, religion and practice, and with a response from the Methodist Church's 'Church at the Margins' Officer.

The year also saw a number of events arising out of the publication of *'Mapping Faith: theologies of migration and community'*, edited by SWF's Senior Research Officer, Lia Shimada. In line with SWF's philosophy of sharing perspectives in generative conversation, Lia choreographed and facilitated a series of seminars that have showcased the book while building fruitful connections between its contributors, and posing interesting questions for the many attendees, over 100 in one instance. The approach highlighted the benefit of conversation between those of different faiths, and of creative ways of sharing understandings: one of the events centred around poetry, to beautiful and compelling effect.

SWF's Communications and Resources Officer, Emma Pavey, had a peer-reviewed article published in the *Journal of Practical Theology* entitled 'Exploring open and relational theology and Theory U for transformational change'.

Conference in partnership with MODEM: 'Beyond Blame: Making Accountability Work'

The joint MODEM/SWF conference in 2020 was an online webinar that brought together academics and practitioners. Contributors, who were interviewed about their experience, encompassed organisational, political and social perspectives and covered both faith-based and secular contexts. Their reflections were then put alongside some of the theoretical ideas underpinning organisational, political and social accountability,

The Susanna Wesley Foundation

looking both at what is difficult and what is possible. The conference received excellent feedback and provided another example of the dialogue between academic and practitioner understandings and perspectives that lies at the heart of SWF's approach.

Plans for the future

As we go forward, the Susanna Wesley Foundation will give attention to sharing insights from the different projects it has conducted and funded over the last few years, organising events, developing resources and posting pieces on its website that showcase some of the work and generate further conversation and learning, for the benefit of the Church and the wider community. Justice, dignity and solidarity will continue to be an important theme, and the Foundation will support the Methodist Church as it implements its JDS strategy. Learning, particularly focusing on the laity and on learning in community, together with the complexities involved in systemic change, will be ongoing strands of work, but with a new emphasis on sustainability, well-being and building flourishing communities.

Enriching Community Life

An important aspect of the SMT's work is to enrich the community life of Southlands College, specifically in ways that reflect its Methodist values and ethos, and through this to maintain and develop the relationship between the Methodist Church, the college and the University of Roehampton.

Southlands College delivers a diverse programme of activities for students and staff throughout the year. Many of these are shaped and delivered by the college staff team, but the programme seeks to be one that is also co-created with our students and our academic departments in order to ensure it is engaging, relevant and intellectually stimulating. Students are encouraged to explore their own identity and develop a sense of belonging, while also engaging in activities that build on their academic learning and speak of the college's values, values that are inherited from those of the Church and nurtured by the SMT.



Enhancing Student Outcomes

The work of Southlands College continues to evolve as the institution expands and the Higher Education sector changes. Responding to this, and in efforts to ensure its programme of work is coherent, proactive and purposeful, Southlands has identified the focus of its activity around five broad areas:

- ◆ **Offering welcome, hospitality and belonging**
- ◆ **Engaging our community in critical issues facing society**
- ◆ **Encouraging the exploration of identity**
- ◆ **Celebrating achievement**
- ◆ **Influencing whole-university identity and activity**

The SMT provides support for this work, both through direct funding and the provision of resources and staff time, to enable the flourishing of these goals in practice within the life of the college.

Some examples of activity of this kind in the reporting year included:

- ◆ Supporting postgraduate students to present their research on the concepts of the Sticky Campus, and on the experience, belonging and attainment of BAME commuter students by co-organising two events; a staff conference they titled 'Enhancing the BAME student experience', and a student conference they called 'Navigating through life as a BAME student'. A wide-ranging discussion helped educate members of the wider Roehampton community about the experience of our students, their identity and how they can be nurtured by educational bodies.
- ◆ Setting up a monthly Business Ethics Forum, which enabled students to discuss ethical issues, aiming to help students widen their horizons and thinking in the context of a more social learning environment, and in so doing to feel a sense of belonging at the Roehampton Business School and Southlands College.
- ◆ Establishing a 'vlog' called *Careers, Values and Vocations: Women's Stories*, which celebrated achievements of women associated with Southlands; it encouraged students to consider their values and how they might be used to influence career choices.

Southlands Venture



"[God] has told you, O mortal, what is good...to do justice, and to love kindness, and to walk humbly with your God."

Micah 6: 8

Southlands Venture is a programme that builds on the college's commitment to enable students to live as responsible citizens, encouraging our community members to explore how they can best use their interests and skills to make the world a better place.

Asking individuals to look beyond themselves in response to wider social issues, Venture projects can take the form of campaigning, volunteering, outreach, or charitable work, either within or beyond the university community. Venture projects always focus on issues of social concern and demonstrate positive interaction with the world in which we live. Students are encouraged to bring their own ideas to life or work on a project that emerges from the wider student community.

Southlands Venture enables these student initiatives to flourish by offering grants and mentoring. Coordinated by members of the college staff team, Venture is financed by the SMT and reflects a number of the Methodist Church's core values as lived out at the college: a concern for social justice and fairness; enabling the development of human, social and organisational skills; and making a contribution to the wider community. These values are also embodied in the University of Roehampton's Enabling Strategies and the skills encouraged by Southlands Venture map closely onto those that enable our graduates to become successful leaders in their future careers.

In the context of the pandemic, and in particular the ongoing impact of lockdown and experiences of digital fatigue, it was important for the Venture team to recognise the limitations of planning typical venture projects over 2020-21. Rather than pursuing individual projects to be delivered and supported remotely, the team decided to prioritise promoting Venture within the Southlands community, building collaborative links with the Business School, and exploring future ways of embedding Venture within the academic programmes overseen by the new Faculty of Business and Law. In doing this, the college staff team is seeking to extend the enrichment of inclusive and transformational student education communities for future years.

Southlands Venture

During the course of the year, Venture activities included:

- ◆ the creation of a promotional video for use by the college team and academic schools;
- ◆ the sharing of promotional material online, in community spaces and in our international student welcome packs;
- ◆ developing relationships within the Faculty of Business and Law that enabled an extension of our understanding of one another's programmes in relation to Venture, and the creative exploration of how Venture might be embedded for credit within the academic syllabus;
- ◆ offering Venture as an initiative pertinent to those attending our new co-curricular Business Ethics Forum as a tool to support students with ideas and ambitions to make a meaningful change within the world, with appropriate support and mentoring.

Although the opportunity for students to deliver community initiatives in person was limited, three practical volunteering projects were set up by the college team in which students could participate:

- ◆ 'Painting and Decorating': students learned practical skills while enhancing the college environment.
- ◆ 'Planting and Growing': both online and in-person sessions where students were provided with pots, compost, and plants to grow and nurture. This gave students opportunities to learn new skills, learn about sustainability and enhance personal well-being.
- ◆ 'Creating Community Hampers': this was a student-led campaign initiated by student leaders to encourage the Roehampton community to make charity donations for two food banks. It featured a video watched over 334 times, and an Instagram campaign interacted by with by 494 students.



Community Music



"Beautiful music is the art of the prophets that can calm the agitations of the soul; it is one of the most magnificent and delightful presents God has given us."
Martin Luther

Music remains a core activity at Southlands that builds skills, develops community and expresses creativity.

In 2020-21, music was more subdued than previously, in the face of the many and serious practical challenges of bringing people together to play and sing. However, the SMT continued to support activities at Southlands that offered the chance for our musicians to engage in community building, networking and performing. Working with individuals and groups through Zoom, staff and students also became part of online, livestream concerts and gigs through Facebook and other platforms. Our singers discovered the benefit of backing tracks, which enabled some semblance of collaborative performance at home and in their isolated flats on campus.

There were some highlights in the gaps between lockdowns, during which those on campus were able to take part in an outdoor community choir, in African drumming using the university drums donated by the Southlands Methodist Trust, and in some sessions on music and mindfulness in the Peace Garden at Digby Stuart College. Outdoor Christmas carols with the local primary school and karaoke with the college student leaders by the tree in Southlands Quad gave a lift to those on campus in late December. Together with chaplaincy and colleagues at Digby Stuart College, there was also a simple online carol service.

The college and SMT assisted in supporting the development of four musicians through our music scholarship programme. These four used scholarship funds to continue to study online with their teachers and to work on new repertoire. This was of particular benefit to those who also found that their part-time work was no longer available. Having this link running through the lockdown period gave students an extra level of support and focus during times of apparent inertia. As the pandemic restrictions lift, it is exciting to see the enthusiasm for music of those now returning to campus, and our more fulsome programme of work is already in full swing as we enter the 2021-22 academic year.

Awards, Prizes and Hardship/ Access Grants

In 2020-21, the SMT continued to sponsor a range of prizes and awards for staff and students, encouraging a culture of excellence in academic achievement across the college.

Of particular value to the Trust is the awarding of prizes that celebrate the history and ethos of the college by honouring both individuals and their work that promote the Methodist identity of Southlands College. Examples of these awards include:

- ◆ The Susanna Wesley Award – given to a female staff member who promotes a values-focused approach, for an outstanding role in educational leadership in the college
- ◆ The Charles Wesley Award – given to a student or staff member who has contributed exceptionally to the development of community music at Southlands
- ◆ The John Wesley Award – given to a student who has contributed particularly notably to the student chapel community
- ◆ Postgraduate Award – for a postgraduate business studies student presenting a display about their work that shows special capacity for engagement with the community

In addition to these awards, the Trust, through the Head of College, offers small bursaries to students in positions of particular financial need. Some of these are attached to particular funds (the Smith Fund for Southlands students entering postgraduate study, the Aldridge Fund for supporting music in the college chapel and the Southlands Fund for supporting student activities) and others are from the main Trust funds. The Trustees intend to continue sponsoring these activities in future years.

Supporting Chaplaincy

Fulfilling the aim of the SMT to enrich the community life of Southlands College and its chaplaincy, the Trustees have continued to sponsor activities both within the college's Methodist Chapel and through its Methodist chaplaincy, and also to encourage and support the wider provision of multi-faith chaplaincy work for the whole of the university community.

The Trust directly funds one post in the chaplaincy team. It also offers financing for some chaplaincy activities led by the Methodist Chaplain to the university and sponsors projects run across the wider multi-faith chaplaincy team that align with its charitable objectives. Three members of the university's multi-faith chaplaincy team form part of the Southlands College team (both Methodist and Muslim); they work alongside Anglican and Roman Catholic chaplains and volunteer associate chaplains serving our Pentecostal, Jewish, and Christian LGBT+ communities.

Chaplaincy Activities

At Southlands, our contributions to a university-wide programme of Christian worship are at times both distinctively Methodist and also ecumenical. These sit alongside our programme of worship and confessional activity for people of all faiths and none, with a special focus on our college's large Muslim community. Our chaplains prioritise their wider work in areas that speak of the values and ethos formed from the college's Methodist heritage, a heritage that gives life to those values in practice. A small selection of their work from the reporting year includes:

- ◆ The development of a Living Well programme, focusing on themes relating to 'living well with ourselves and others'. The programme included a series of podcasts in which members of staff and the wider Methodist community were interviewed on issues including healthy eating, sustainable food, work-life balance, and foodbanks and the pandemic. Living Well also offered online drop-ins to enable students to connect with one another and chaplaincy staff whilst in isolation. The focus for these drop-ins was around general self-care and, in response to the need of those attending, experiencing bereavement in isolation.

Supporting Chaplaincy



"Let us then pursue what makes for peace and for mutual upbuilding."

Romans 14: 19

Supporting Chaplaincy

- ◆ The development of Reef Reads as a college community initiative: short, student-focused book reviews that promote reading across the college community, celebrate the achievements of our academic staff, and increase awareness of staff and student leaders connected with our community. Books reviewed involved themes that reflect our college identity and the inclusive values of the university, celebrating Black History Month, LGBT+ History Month, Local and Community History Month and Earth Day.
- ◆ The College Chaplain has a particular role in the external work of the college. In 2020-21, she represented the college and university within wider networks, including engagement with the London HE Chaplains Network and the National Methodist HE Chaplains Network. She also presented the work of Southlands College in relation to Roehampton's ecumenical community at Barat House to the President of the Methodist Conference as part of a local Circuit event. During the year, both students and staff made a distinctly Methodist contribution to our local community by offering recorded music, readings and prayers for Putney Methodist Church's worship and our wider Methodist circuit.
- ◆ The College Chaplain has held the story of Southlands' Methodist heritage in several practical ways, helping to nurture a flourishing college community. This has included the provision of pastoral and bereavement support, sending regular messages (via social media) to the college community relating to religious festivals, marking significant moments in the pandemic, and offering special resources from the Methodist Church (e.g. a 'drop the debt' campaign). Our Chaplains have also been a voice and witness within the college and university community to demonstrate care for our planet and the promotion of ethical and Fairtrade products.
- ◆ The Coexist Café is a space for discussion that moved from being in person to predominantly online in 2020-21. Over the year, the café facilitated 21 interfaith/inter-belief engagements between over 100 individuals, during which they explored faith and social justice themes. Through thought-provoking discussion, the forum empowered individuals to establish their place within the community as well as discerning their place in the wider world.

The Coexist Café was facilitated by the Muslim Chaplain with support from our student leaders, who co-created the programme of themes and led conversations, embodying the college's commitment to widen students' horizons and to engage them in discussion and action on

Supporting Chaplaincy

contemporary issues. The chaplaincy team hopes to reinstate the Coexist Café in a physical location on campus as soon as possible.

Chaplaincy Community Worker and Community Living

A major contribution of the Trust was to sponsor the employment of a Chaplaincy Community Worker (CCW). The CCW role focuses on three areas of work:

- ◆ Strengthening our ecumenical relationships through supporting the running of an intentional Christian student community house (Barat House) on campus, overseen by the Digby Stuart College and Southlands College chaplains, and performing a continuing leadership role within this community
- ◆ Supporting the work of Southlands Chapel and the Southlands College team in the nurturing of community across the Southlands cohort
- ◆ Being an active member of the wider chaplaincy team

The CCW role is intended to provide the opportunity for someone to work for two or three years in a faith context to explore their own vocation, to develop their working skills, and to help boost the work of the chaplaincy.

The Barat House Ecumenical Community is supported by the Southlands Methodist Trust alongside the Society of the Sacred Heart and draws on Methodist and Roman Catholic traditions to shape the identity and practices of this residential staff and student community. During 2020-21, the community was both dispersed and gathered. Throughout this time, the CCW supported the resident students through practical and emotional challenges, and also continued a regular rhythm of life centred on prayer, social time, spiritual reflection and engagement with the wider world. Additional activities included a shared commitment to reading the bible in a year and the introduction of journaling techniques as a tool to support spiritual and vocational reflection.

Resources and mentoring for the community were provided by the Southlands and Digby Stuart College Chaplains, who created an interactive online resource and offered regular one-to-one meetings with student members of the community.

Supporting Chaplaincy



Nurturing Alumni Relationships



*"A loyal friend is like a safe shelter;
find one, and you have found a treasure.."*

Sirach 6: 14

Nurturing Alumni Relationships

Important to the development of a meaningful college community is the work done at Southlands to sustain relationships with past staff and students.

Along with the college and the Southlands Methodist Trust, the university's alumni and development staff teams dedicate resources to programmes and events with this in mind. Through and alongside these, the college focuses its energies on sustaining links with the dispersed Southlands community – which still extends to those who attended the college in the 1930s – in ways that celebrate and nurture the nature and quality of the community itself.

2020-21 was a challenging year for the college in engaging with its alumni, with the majority of gathered events being impossible. A number of small alumni reunions had been planned and were due to be facilitated by the college for groups who wished to meet here, but none could in fact meet. However, members of these groups remain in contact with us and we plan to support their reunions in the coming years as society opens up more after the series of nationwide lockdowns.

Despite the restrictions, during 2020-21 we continued to make contact with alumni proactively through a number of means. In January 2020, the college, with the support of the SMT, published its alumni magazine, *The Southlander*. This is sent to past students, staff and Fellows and provides space for the college to connect with that group, inform them about life at Southlands today, and encourage them to continue to support us in any way they can.

During the year, initial plans were made for the 150th anniversary of the founding of the college, which will be celebrated in the summer of 2022. Ideas include academic conferences, exhibitions, dinners and other collaborative ventures. They also feature a major alumni reunion in July 2022, which will be supported and resourced by both the university and the SMT.

Managing our College Archives

The Southlands Methodist Trust retains ownership of the historical archives of Southlands College, which are housed in the college. The archive contains documents and artefacts relating to the history of the college, including a large array of student work dating back to the college's establishment.

During the reporting year, the Trust continued to employ a part-time Archivist to maintain, develop and facilitate use of the college archive. It is made accessible to the wider public through the Archivist's work in answering individual requests and developing an online database of materials.

The Trust also continued to support small grants through the Head of College to acquire relevant additions to the archive (such as images and books concerning the historical life of the college) and to protect and display a range of pictures and artefacts from the archive. These illustrate the history of the college and bring it to life for those staff and students who currently occupy it. This work will continue in the coming year.

Although the archive itself was closed to visitors for significant periods in 2020-21, the Archivist was able to return to work for much of the year, in which work to catalogue and promote the archive continued, especially on college media platforms. A number of historic portraits of former senior figures associated with the college were removed from the archive, restored and brought into the main part of the college.

In addition to this, and as part of the archive's work to ensure that records of the continuing life of the college today are kept for future generations, a new portrait of a former Deputy Principal, Prof. Marilyn Holness, OBE, was acquired and framed, to be added to the college walls. This was done to mark Marilyn's inclusion in the Southbank exhibition, *Phenomenal Women: Portraits of UK Black Female Professors* and as part of the college's wider project of ensuring the images on our walls reflect fully the diversity of our community, past and present.

Managing our College Archives



© 2020 Bill Knight

Marilyn Holness

Enhancing Methodist Education

Southlands College places the University of Roehampton at the heart of the Methodist Church's national and international educational networks. Important to the work of the Trust is to nurture new, generative projects and workstreams that bring benefit to the college, the university and to the wider Church.

Southlands is a key member of both the Methodist-related Theological Schools in Europe (MTSE) and the International Association of Methodist-related Schools, Colleges and Universities (IAMSCU). These involvements provide the college and university with access into a family of institutions from which mutual support and collaborative ventures emerge. In the UK, Southlands College works closely with a range of educational partners and especially the British Methodist Schools groups, which include Methodist Academies and Schools Trust (MAST), Methodist Independent Schools Trust (MIST), the Methodist Schools Committee (MSC) and the Methodist Education Round Table.



Enhancing Methodist Education

In an academic year defined by COVID-19 and its effects around the globe, our international work might have been expected to suffer. It is true that we have not easily been able to meet fellow Methodist educators in person. Nevertheless, we have remained busy and active, maintaining links with our partners and planning for the new world that emerges post-pandemic.



Methodist Schools in Britain

Southlands continues to work with Methodist primary and secondary schools across Britain, which this year saw the publication of a major new strategy document for the Methodist Church in Britain, laying out its vision for education in the coming decade.

Southlands College and the University of Roehampton are identified as key in the development and implementation of this new strategy and the Head of Southlands College provides important links between Higher Education and Methodist Schools, acting as Trustee of Methodist Academies and Schools Trust (MAST) and a member of the Methodist Schools Committee, which wrote the strategy.

During 2020-21, the Southlands Methodist Trust continued to offer a significant grant to MAST to support its staffing and work; this has resulted in a commitment to ensure an increasingly close collaboration between Southlands and the work of Methodist Education more broadly. Despite the challenges of lockdown and distance learning, these collaborations continued to expand, including the provision of sessions on Methodist education as part of student training for teaching in church schools; the provision of online training and development sessions for Roehampton students alongside Methodist teachers and the contribution of Roehampton academics to the provision of those sessions; and the contribution by MAST staff to the delivery of sessions for Education students by the Free Church Education Committee.

Mrs Barbara Easton, the Head of Service for Methodist Schools and a valued colleague of the college was elected in July 2020 as the Vice-President of the Methodist Conference to serve for the year 2021-22. This is the highest office in the Methodist Church in Britain open to lay people and is a validation of the hard work and passionate commitment Barbara has shown for a distinctive Methodist contribution to education. It places Methodist Education, and Southlands College, at the heart of the Methodist consciousness. Barbara will continue to work with Southlands during her Vice-Presidential year, including in the celebration of the college's 150th anniversary.

Methodist Schools in Britain



Barbara Easton

*"It is our duty to contemplate what [God] has wrought,
and to understand as much of it as we are able."*

John Wesley

Higher and Further Education

As well as continuing to work with partners across Europe through its active involvement in the association of Methodist-related Theological Schools in Europe (MTSE), Southlands College has taken a leading role in drawing together all those adult educational institutions and heritage bodies that relate to Methodism in Britain and Ireland.

In collaboration with the leaders in the British and Irish Methodist Connexions, Southlands convened an initial online gathering of senior leaders from representatives of nearly all such institutions, chaired by the Revd Dr Tim Macquiban, who is also chair of the SMT.

The result of this extremely positive meeting was the decision to continue to build closer relationships that will benefit us all and allow the distinctive Wesleyan voice to be heard in higher education discussions across these islands. The bringing together of this group is one outcome of a close working relationship with the Methodist Church's central administrative and education teams and will help to demonstrate the value and resources that the college offers into the wider learning life of the Methodist Church. In turn, this will build stronger bilateral and multi-lateral relationships that will support Roehampton's sustainability through institutional educational and research partnerships, student recruitment and profile-building.

The first in-person gathering of this network, to be hosted by Southlands and with the support of a grant from the SMT, will take place in the Autumn of 2021.

Europe and Worldwide

The restrictions on international travel caused by the pandemic have generated creative thinking about how we maintain and nurture relationships across borders.

The Board of IAMSCU, of which the Head of College is a Director, has continued to meet online, which has allowed for a fuller attendance due to the lack of need for visas and airfares. This development has enabled more active involvement from colleagues in the Global Majority world, and their presence has reminded us of the continuing challenges of global inequality that affect education in every part of the world.

The IAMSCU Board of Directors issued a Common Statement on the COVID-19 pandemic, highlighting the important research going on in Methodist-related medical schools and hospitals around the world, and re-committing all its members to the ongoing battle for equality, justice and solidarity. As part of that commitment, the Southlands Methodist Trust has agreed for funds to be released to develop a range of scholarships that will be aimed at providing opportunities for global engagement for students who would otherwise be prevented from accessing this reach. We are very excited that the launch of these awards will form part of our celebrations of the 150th anniversary of the college in 2022.

This year saw the Southlands College team, the Susanna Wesley Foundation and our Trustees begin planning work for events to commemorate Southlands College's 150th anniversary from the perspective of our educational partnerships. Alongside the range of UK-focused activities, we are delighted that our work with the University of Roehampton International Office has produced a new fee reduction for international students coming from Methodist-related institutions. This will make international study not only more attractive but also more accessible in the future.

The Southlands Methodist Trust agreed last year to inaugurate the Susanna Wesley Visiting Fellowship only to be hit by COVID-19 before the first Fellow could be appointed. We are now planning to welcome our first Visiting Fellow in the coming academic year, as part of the Southland 150 celebrations.

Southlands 150

In 2022, Southlands College will celebrate both its 150th anniversary and also 25 years at its present site on Roehampton Lane.

During 2020-21, members of the college team, Trustees of the Southlands Methodist Trust and University of Roehampton Professional Services staff came together to begin a detailed planning process for work to mark this special anniversary.

Resources were allocated for a range of activities and programmes across educational, research and sustainability areas, with the goal of involving a diverse mix of students and staff from the college and university and bringing in wider communities from the local area, from university partners and from Methodist-related institutions in the UK and overseas.



Southlands College

1872 150 years 2022

Celebrating our History and Planning for our Future

Celebrating our History and Planning for our Future

Significant resource commitments were made during this planning process to establish a rich programme that will include:

Events:

- ◆ A major academic and practitioner conference on the theme of sustainability
- ◆ An educational programme focused on London-based Methodist heritage for leaders and students from Methodist-related institutions overseas
- ◆ Celebratory events, including alumni reunions, gala dinners and the bestowing of honorary College Fellowships
- ◆ An education-focused day, including a Vice-Presidential visitation, showcasing education research and launching new student scholarships
- ◆ Curating a number of exhibitions that celebrate the college's history and explore its current and future work
- ◆ Marking the 150th anniversary at the Methodist Conference

Awards:

- ◆ Re-establishing the Susanna Wesley Visiting Fellowship, inviting overseas scholars from Methodist-related institutions to become part of the Roehampton community
- ◆ Establishing a large number of new student scholarships and bursaries that encourage young people to become Roehampton students, and Roehampton students to expand their global reach
- ◆ Developing a series of proposals for Methodist-related honorary doctoral awards for consideration by the university's relevant committees

Celebrating our History and Planning for our Future

Resources:

- ◆ Publishing a new book about the recent history of Southlands, told primarily through the voices of our students as recorded in the college archives
- ◆ Establishing new ways of showcasing research funded by the Southlands Methodist Trust, to expand its reach and impact

Recruitment, Fundraising and Development:

- ◆ Expanding our recruitment from global Methodism by launching discounted fees on university programmes for students coming to Roehampton from Methodist-related institutions overseas
- ◆ Launching a new development programme to help support our vision for the future of Southlands College

During 2021-22, the delivery of these various streams of activity will be a major focus of the college's work and of the activity of the SMT.

Celebrating our History and Planning for our Future



Reimagining our College Buildings for a Sustainable Future

Planning for the college's 150th anniversary during 2020-21 included the appointment by the university of a specialist consultant to review the present Southlands College buildings.

Working with the various college communities, including several Trustees of the SMT and the Head of College, a proposal was formed that aims to reimagine how Southlands can be further developed as a place and space that significantly enhances the learning environment and offers greater sustainability (in all definitions of that word) for the future.

The proposal is underpinned by four key educational commitments; these emerge from the Methodist Church's mission and values, the historical work of Southlands College, and the modern-day work and vision of the University of Roehampton.

Education as community

A commitment to creating permeable spaces where the boundaries between student and student, between student and staff, and between staff and staff are removed, and ways of working are radically reshaped to ensure all are brought together in one, fully inclusive environment. This involves breaking down (literally) the barrier between college and community; opening up Southlands College to the community; and providing creative and collaborative spaces that engage students with the outside world and with one another.

Education as service

A commitment to reshaping the world around us through helping to shape leaders of the future; encouraging students to hold values of commitment to improve the world around them; and engaging in key social justice issues.

Education as formation

A commitment to becoming a rounded person with a strong set of values who has a rich engagement with the creative, physical, mindful and spiritual aspects of life. This involves the holding together of spaces for learning, for exploring, for music and creativity, for sports, for prayer, for worship and spiritual engagement, and for well-being activities.

Reimagining our College Buildings for a Sustainable Future

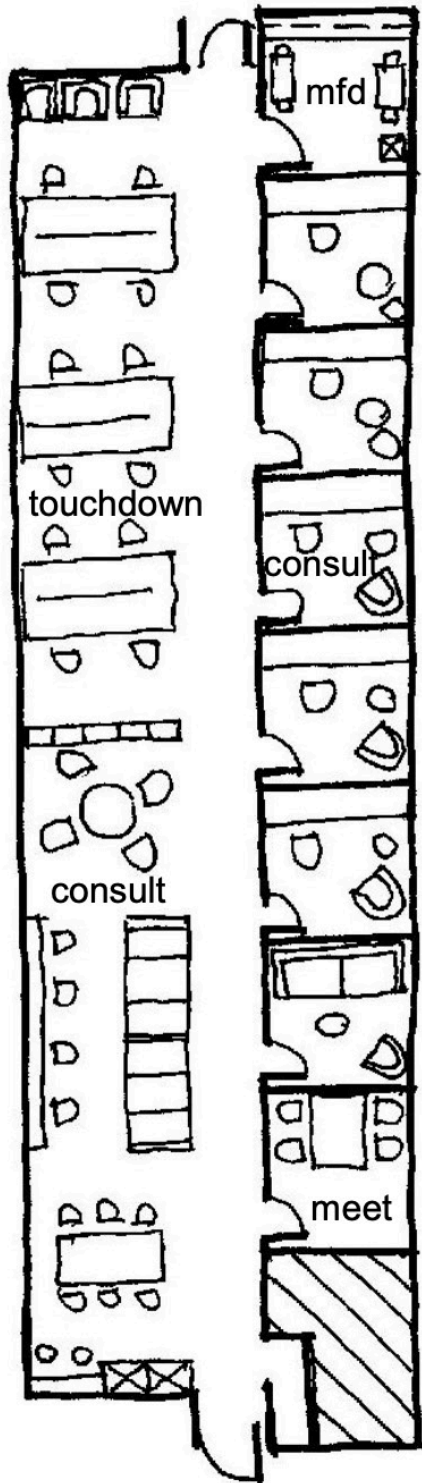

Reimagining our College Buildings

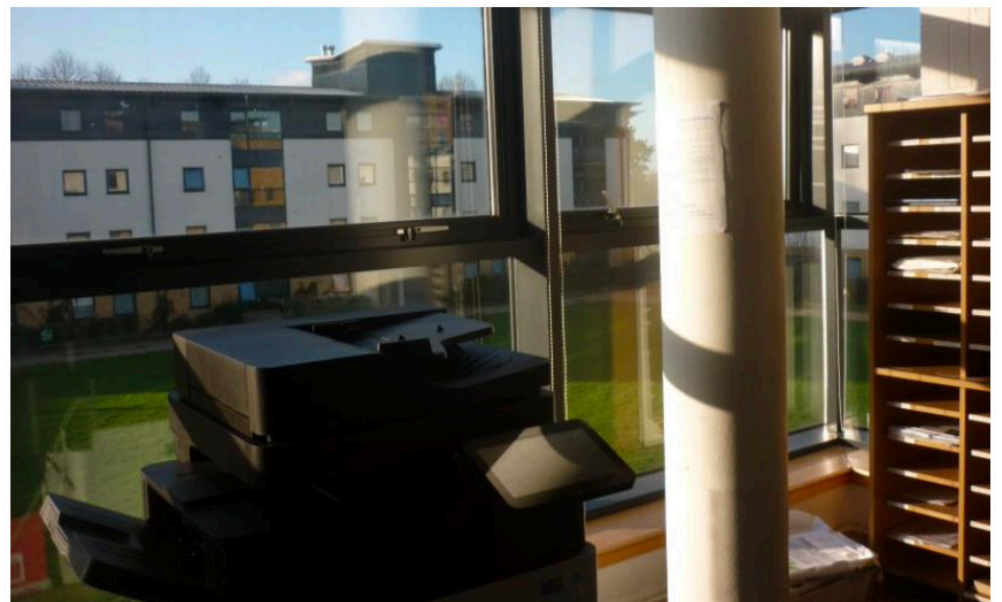
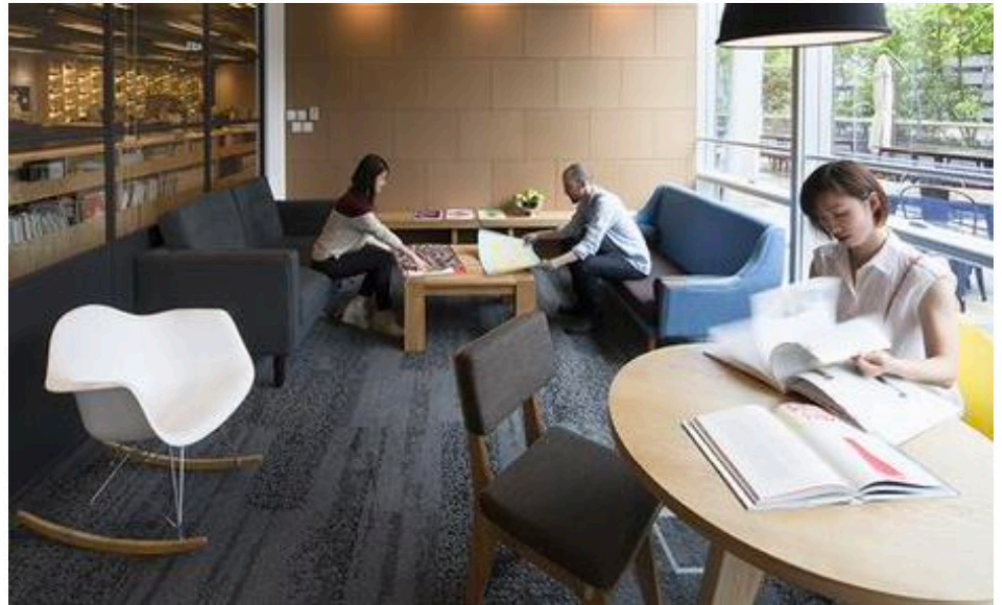
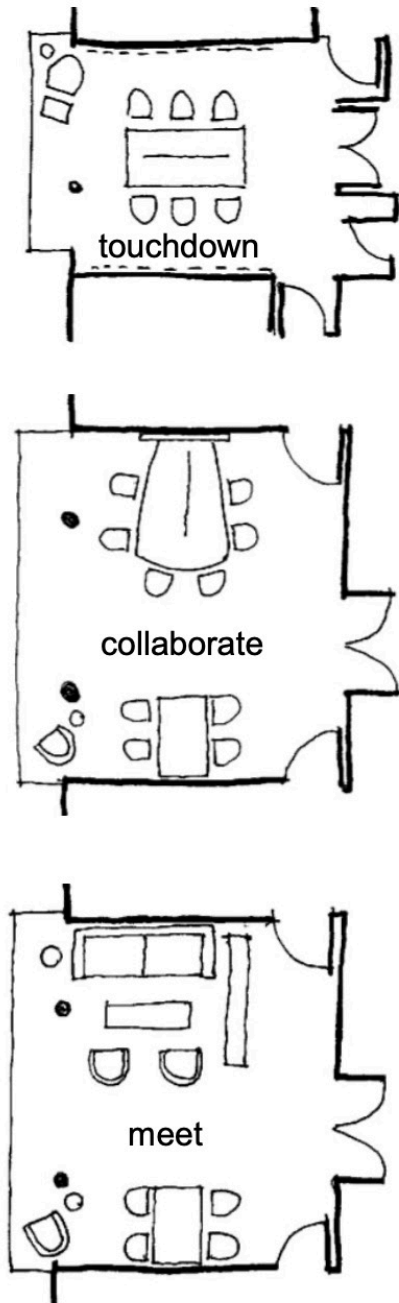

Reimagining our College Buildings

Education for sustainability

A commitment to creating a sustainable learning environment that will accommodate the evolving needs of those who use, manage and fund buildings in efficient, effective and environmentally friendly ways. This involves facilitating positive social interaction; building friendships; encouraging social inclusion; developing trust and reinforcing civic identity and pride; and instilling environmentally sustainable behaviours through user training and mindfulness.

Key practical aims from the proposal include:

- ◆ Significant enhancements to teaching spaces to address the needs of a growing Faculty of Business and Law that is focused on practices connected to social responsibility
- ◆ Reorienting the college buildings to face the local community, thus offering the chance for a more permeable boundary; encouraging knowledge exchange between the university and our local communities; and providing spaces for key local facilities, social enterprise and start-up hubs
- ◆ Creating larger and more collaborative spaces to reduce the boundaries between staff and students, between students and students, and between all members of our community
- ◆ Increasing and improving resources for commuting students to enable their better inclusion in the life of the college and to enhance engagement in university activity amongst students from traditionally under-represented communities.
- ◆ Offering improved spaces for activity that nurtures human flourishing beyond the core university activities of teaching and learning
- ◆ Reducing staff dependency on offices and handing over spaces to our student communities to offer flexible and social learning facilities

Working closely together, staff from Southlands College and the university's development team refined this proposal with the oversight of the SMT. It will become a focus in 2021-22 for the university's fundraising and development strategy, and Trustees of the SMT will work in parallel with university colleagues to promote and enable that fundraising exercise to ensure wider church networks in particular are harnessed to enhance the project.

Saving Mount Clare Temple

The Methodist Church owns the freehold of the Mount Clare Estate, which is leased to the University of Roehampton, an arrangement overseen by the Trustees of the SMT. The estate includes a Grade 1 listed house, mid-20th century student accommodation for nearly 200 students, and a Grade 2* listed Doric temple.

The temple is thought to have been built in the 1760s or 1770s and designed by Sir William Chambers. It is small but remarkable, a pioneer building in a period when Greek forms were very slow to catch on in English architecture. Of particular note is the temple's painted ceiling: it is an elegant, neo-classical design and an artistic achievement of considerable refinement and delicacy.

The Mount Clare Temple has been on the 'Heritage at Risk' register since the estate was purchased by the Church. Before then, it had experienced major damage both from environmental factors and from vandalism.

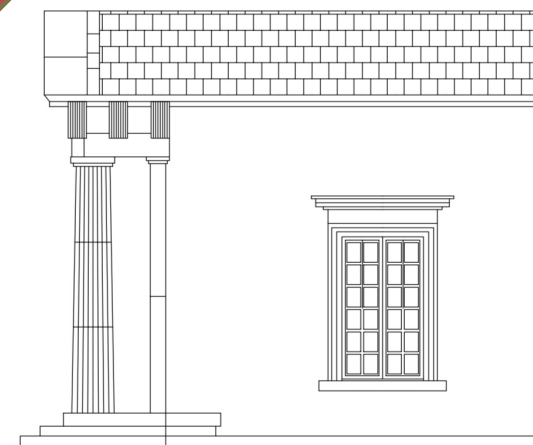

SOUTH ELEVATION
As Existing, NTS

Saving Mount Clare Temple

Many of its more precious decorative features were stolen or destroyed and the ceiling had suffering from years of neglect. In recent years, the Trust and the university have both invested significant funds and efforts to protect and preserve the temple from further damage. However, while the security of the temple has been achieved, attempts to raise sufficient funds for significant restoration work have been unsuccessful.

During the reporting year, however, new grant funding was secured by the Trust to take a significant step forward in the SMT's aim of protecting the temple and enabling its use as a local tool for community engagement and learning. This grant has now been combined with funds committed by the SMT and, during the spring of 2021, the Trustees commissioned specialist heritage architects and stone masons to perform a detailed survey of the building. This will provide assessments of the work needed to begin a comprehensive protection and restoration project. This development was coordinated, facilitated and supported jointly by staff of Southlands College, the SMT and the University of Roehampton estates team.

In the coming year, the Trustees hope to receive this report in full and to begin commissioning aspects of the work identified in it, up to the cost of the funds available. The hope is that work will start in the spring and summer of 2022. The Trustees will continue to explore future grant options to raise further funds to continue the restoration of the temple.

In order to increase local interest and engagement in the restoration project, outreach activities will be organised during the coming year, especially including local youth groups that meet in the adjacent community centre. A social media fundraising campaign will also be launched to raise further capital.

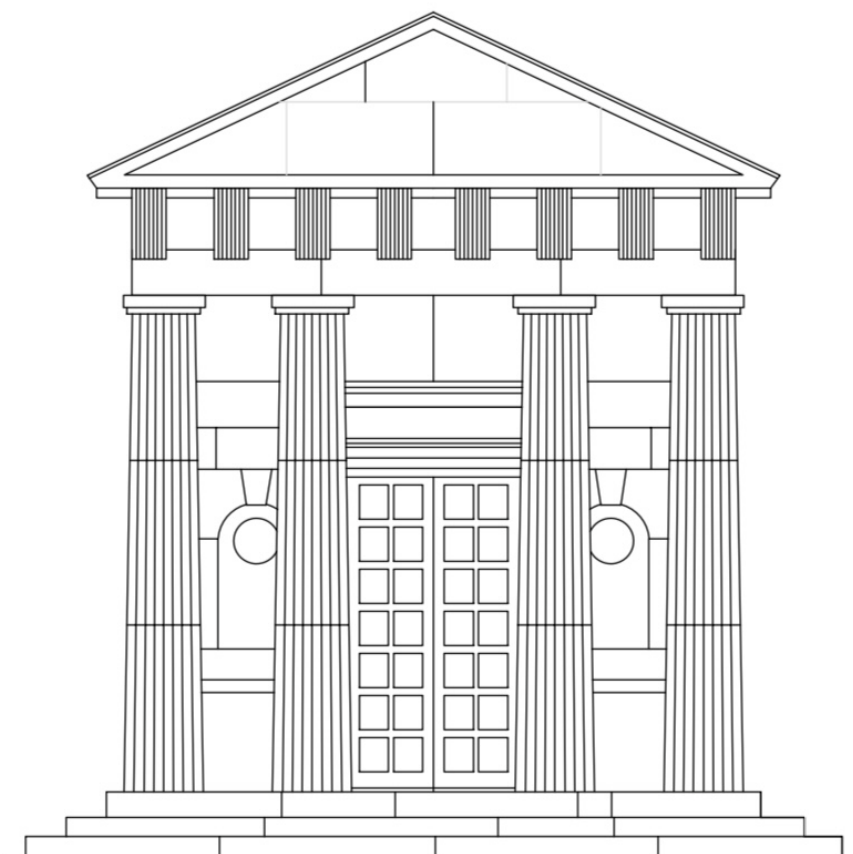

WEST ELEVATION
As Existing, NTS

The Southlands Methodist Trust
is a charity of the Methodist Church in Britain.

Registered charity number 1100660

Southlands College
80 Roehampton Lane
London SW14 5SL

SWF@roehampton.ac.uk
southlandsmethodisttrust.org.uk
020 8392 4462

Southlands Methodist Trust Report and Financial Statements For the Year Ended 31 August 2021



— S M T —

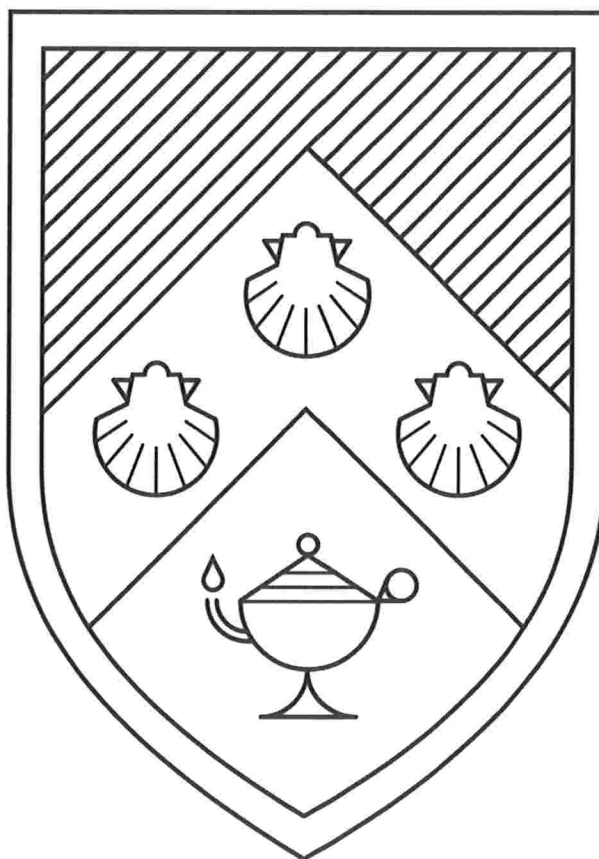

The Southlands Methodist Trust
is a charity of the
Methodist Church in Britain

Registered charity number 1100660

Southlands College
80 Roehampton Lane
London SW15 5SL

SWF@roehampton.ac.uk
www.susannawesleyfoundation.org
020 8392 4462

SOUTHLANDS METHODIST TRUST

REFERENCE AND ADMINISTRATIVE DETAILS

FOR THE YEAR ENDED 31 AUGUST 2021

Trustees:

Rev Dr Tim Macquiban, Chair
 Rev Stan Brown
 Rev Dr J Cox-Darling
 Dr Clive Norris
 Rev Colin Smith
 Rev M Youngson (resigned, August 2021)
 Mr Alan Davies (appointed, October 2020)
 Rev Jennifer Smith
 Rev Geoffrey Farrar (appointed, March 2021)

Registered office:

Southlands College
 80 Roehampton Lane
 London
 SW15 5SL

Auditors:

Haysmacintyre LLP
 Chartered Accountants
 10 Queen Street Place
 London EC4R 1AG

Bankers:

Methodist Central Finance Board
 9 Bonhill Street
 London
 EC2A 4PE

 HSBC
 West End Corporate Banking Centre
 70 Pall Mall
 London
 SW1Y 5EZ

Solicitors:

Potheary Witham Weld
 70 St George's Square
 London
 SW1V 3RD

SOUTHLANDS METHODIST TRUST

TRUSTEES' REPORT

FOR THE YEAR ENDED 31 AUGUST 2021

STRUCTURE GOVERNANCE AND MANAGEMENT

The Trustees present their report and audited financial statements for the year ended 31 August 2021. The Trustees have adopted the provisions of the Statement of Recommended Practice for Charities (SORP 2015) (Second Edition, effective 1 January 2019), in preparing the annual report and financial statements of the charity.

The Southlands Methodist Trust (SMT) is a registered unincorporated charity (Charity number 1100660). The Governing Document is a Deed of Trust.

Trustees are appointed by a decision of Methodist Council, at the recommendation of members of the Trustees. When vacancies arise, a sub-group of the trustee board is formed in order to conduct a search process. This includes both direct approaches and approaches through the Church's Connexional Team, asking for expressions of interest. From time to time, advertisements of vacancies are also used in the press. CVs of those expressing interest in appointments are considered by the sub-group and brought to a full meeting of the trustee board, where a decision is made to recommend names to Council.

RISK ASSESSMENT

The Trustees have active involvement in the day to day running of the charity. This involvement ensures that they are fully aware of the risks and required action to sufficiently mitigate those risks. As the charity grows the Trustees will more formally record the risk assessment process they undertake as part of their duties as trustees.

OBJECTIVES AND ACTIVITIES

The aims and purposes of the charity are:

- 1) as part of the work carried out through the Discipleship and Ministries Learning Network, to support in association with the College and University the development of Christian, and specifically Methodist, scholarship, research and innovation, of local, national and global significance and to facilitate the public dissemination of such developments.
- 2) to enable members of the Methodist community and wider public in Britain and internationally to benefit from the academic and other expertise and experience within the College and the University and the facilities available within them.
- 3) to enrich the community life of the College and the work of its chaplaincy in ways that reflect its Methodist values and ethos.
- 4) to maintain and develop the relationship between the Methodist Church, the College and the University in the context of developing the contribution made to the work carried out through the Discipleship and Ministries Learning Network.
- 5) to further the wider charitable purposes of the Methodist Church through close working with the other persons and bodies responsible for the work carried out through the Discipleship and Ministries Learning Network.

Fundraising

SMT does not fundraise with the public and has not received any complaints in this regard during the year.

SOUTHLANDS METHODIST TRUST

TRUSTEES' REPORT (continued)

FOR THE YEAR ENDED 31 AUGUST 2021

Public benefit

The Trustees confirm that they have complied with the duty in section 17 of the Charities Act 2011 to have due regard to public benefit guidance published by the Charity Commission in determining the activities undertaken by the Charity. The Trustees review the activities of the Charity against its aims on an ongoing basis and are satisfied that all activities continue to be related to the aims which are set in such a way as to benefit society as a whole. The benefits are set out in the review of activities shown below.

SUSANNA WESLEY FOUNDATION

The Susanna Wesley Foundation (SWF) is a community of scholarship, research and innovation based at Southlands College. The SWF provides direction and a significant focus for the Trust's in-house activities, brokering projects and partnerships to generate its research, scholarship and innovation.

The Trust employs a small staff team at the Foundation, who work alongside a group of Associates and Honorary Research Fellows, University of Roehampton academics from a range of disciplines, doctoral students whom the Trust sponsors, and SMT grant recipients from various institutions, as well as those who subscribe to the Foundation's quarterly newsletter, and who regularly participate in SWF events.

SWF Contribution:

Justice, Dignity and Solidarity

Members of SWF contributed to the Methodist Church's quest to become an inclusive church, drawing on the previous work of the Foundation around cultural difference and around learning, transformation and systemic change. The outcome of this work in the Methodist Church has been termed a 'Strategy for Justice, Dignity and Solidarity'. Given the priority accorded by the Foundation to this area, we also focused a number of podcasts, both in our 'Flourishing' (2020) and our 'Embodied Faith' (2021) series, around this theme: topics included neurodiversity, social activism and racial justice, and solidarity. These and other podcasts have been posted on the Foundation's website. The aim is to facilitate conversation between those of different perspectives and backgrounds and, in the exchange, to generate new questions and understandings.

Supporting academic dialogue and expanding participation

In the light of the lack of representation of those from the global majority in academic theology communities, the Foundation funded student bursaries for attendance at the Society for the Study of Theology (SST) and the British and Irish Association for Practical Theology (BIAPT) conferences. This is part of a package of initiatives being taken by these groups in their quest to become more inclusive, and thus to enhance their scholarship, and both listen and learn from a wider range of voices. The Foundation also supported the University of Roehampton's Research Group in Theology, Religion and Practice, sponsoring some speakers and contributing others from its own community.

Well-being in ministry

SWF continued to sponsor work around well-being in ministry, with the completion of a project looking at Bowen family systems theory – and its application in the context of local churches. A resource entitled *Flourishing Ministers, Flourishing Communities* has grown out of this project, which provides ministers with insights into the interplay between self and system, and helps them to handle the dynamics involved in their roles; it will be launched soon.

Work around learning, strategy and change

A theological action research project exploring learning in Methodism has been of benefit to a number of communities; disseminating the insights gained became the focus of the work in 2021. In relation to a project looking at models and

SOUTHLANDS METHODIST TRUST

TRUSTEES' REPORT (continued)

FOR THE YEAR ENDED 31 AUGUST 2021

understandings of change in the context of Methodism, 2020-21 has seen some empirical work, the findings from which will be shared in the 2021-22 academic year, along with those from another project looking at how 'Church strategy' is perceived and enacted in local contexts.

Publications and dissemination

In 2021, *Fuzzy Church: Gospel and Culture in the North of England* was published, a book that presents the findings and implications of research sponsored by the Foundation in 2018-19. The authors presented the book at an event sponsored by the Foundation.

The year also saw a number of events arising out of the publication of '*Mapping Faith: theologies of migration and community*', edited by SWF's Senior Research Officer, Lia Shimada. Lia choreographed and facilitated a series of seminars that have showcased the book while building fruitful connections between its contributors.

SWF's Communications and Resources Officer, Emma Pavey, had a peer-reviewed article published in the Journal of Practical Theology entitled 'Exploring open and relational theology and Theory U for transformational change'.

Conference: 'Beyond Blame: Making Accountability Work'

A joint MODEM/SWF conference brought together academics and practitioners to consider organisational, political and social accountability, looking both at what is difficult and what is possible. The conference provided another example of the dialogue between academic and practitioner understandings and perspectives that lies at the heart of SWF's approach.

Plans for the future

The Susanna Wesley Foundation will give attention to sharing insights from the different projects it has conducted and funded over the last few years, organising events, developing resources and posting pieces on its website that showcase some of the work and generate further conversation and learning, for the benefit of the Church and the wider community. Justice, dignity and solidarity will continue to be an important theme, and the Foundation will support the Methodist Church as it implements its JDS strategy. Learning, particularly focusing on the laity and on learning in community, together with the complexities involved in systemic change, will be ongoing strands of work, but with a new emphasis on sustainability, well-being and building flourishing communities.

RESEARCH AND KNOWLEDGE EXCHANGE

In 2020-21, the SMT sponsored a number of projects across the University of Roehampton's departments. Projects focus on issues of importance to the Church and Society and are chosen with a concern for their potential to contribute to the wider benefit of the public.

Projects commenced during 2020-21:

- The effects of the coronavirus lockdown on children's psychosocial and educational adjustment during school transition
- The effect of COVID-19 lockdown on the learning journey of commuter students
- The effects of the coronavirus lockdown on children's psychosocial and educational adjustment during school transition
- An investigation into social control by neglect
- Latin American professional women and men in the UK: A critical exploration of the workplace experiences and career trajectories of an understudied immigrant group

SOUTHLANDS METHODIST TRUST

TRUSTEES' REPORT (continued)

FOR THE YEAR ENDED 31 AUGUST 2021

- Once More with Feeling: A reinvention of Hysteria using photography, performance and writing
- Public Engagement: Challenging myths of empire
- the philosophy and impact of Phiroz Mehta (1902-1994)

Projects approved during the year for completion in 2021-22:

- Bridging the ethnic minority gap between educational development and doctoral supervision: Social justice and inclusivity
- Reading4Normal Book Club: an online reading-group scheme that aims to bring together young readers to discuss young adult novels.
- Understanding emotional journeys: the emotional impact of commuting and campus-based learning during the era of COVID-19
- Public Engagement: Diverse Shakespeare at Shakespeare's Globe
- Productivity and food safety improvements for women in community mechanised palm oil processing: The Case of Ejisu Juaben Municipality, Ashanti Region, Ghana
- Growth Outlook for Family Businesses under Uncertainty: An Exploratory Study of the Local Business Community in South West London
- The Potato Teeth Project: A comparison of classroom and garden-based educational interventions for oral hygiene in primary school pupils

NURTURING CHAPLAINCY

The SMT continued to sponsor activities within both the college's Methodist Chapel and through its Methodist chaplaincy, and also to encourage and support the wider provision of multi-faith chaplaincy work for the whole of the university community. The Trust directly funds one post in the Chaplaincy team, offers financing for some chaplaincy activities led by the Methodist Chaplain to the university, and also sponsors projects run across the wider multi-faith chaplaincy team which align with its charitable objects. The Methodist Chaplain and Chaplaincy Community Worker (CCW) support the work of Southlands College and contribute to the building of a student community and the creation of a supportive and flourishing environment that reflects the Methodist ethos of Southlands. The chaplaincy also hosts a range of events and runs student and staff engagement programmes, both at Southlands and across the university campus.

The Trust will continue to offer its support to the college and university chaplaincy team in a variety of ways, including grants for small projects which encourage the Methodist ethos of the college and for building up the community life of the Southlands chapel. The Trust intends to continue supporting the appointment of the CCW during 2021-22.

SOUTHLANDS VENTURE

Southlands Venture is a programme that encourages students to explore how they can use their interests and skills to make the world a better place. The Venture supports initiatives by offering seed-funding to resource ideas, as well as offering mentoring to enable students to receive the advice and guidance they need to lead campaigning, volunteering and charitable work successfully. The programme is coordinated by the college's staff team and financed by the Southlands Methodist Trust.

During the course of the year, Venture activities included:

- the creation of a promotional video for use by the college team and academic schools;
- the sharing of promotional material online, in community spaces and in our international student welcome packs;

SOUTHLANDS METHODIST TRUST

TRUSTEES' REPORT (continued)

FOR THE YEAR ENDED 31 AUGUST 2021

- developing relationships within the Faculty of Business and Law that enabled an extension of our understanding of one another's programmes in relation to Venture, and the creative exploration of how Venture might be embedded for credit within the academic syllabus;
- offering Venture as an initiative pertinent to those attending our new co-curricular Business Ethics Forum as a tool to support students with ideas and ambitions to make a meaningful change within the world, with appropriate support and mentoring.

Although the opportunity for students to deliver community initiatives in person was limited by the ongoing pandemic, three practical volunteering projects were set up by the college team in which students could participate:

- 'Painting and Decorating': students learned practical skills while enhancing the college environment.
- 'Planting and Growing': both online and in-person sessions where students were provided with pots, compost, and plants to grow and nurture.
- 'Creating Community Hampers': this was a student-led campaign initiated by student leaders to encourage the Roehampton community to make charity donations for two food banks. It featured a video watched over 334 times, and an Instagram campaign interacted by with 494 students.

HISTORIC ARCHIVES

The Southlands Methodist Trust retains ownership of the historical archives of Southlands College, which are housed in the college. During the reporting year, the Trust continued to employ a part-time Archivist to maintain, develop and facilitate use of the college archive. It is made accessible to the wider public through the Archivist's work in answering individual requests and developing an online database of materials.

Although the archive itself was closed to visitors for significant periods in 2020-21, the Archivist was able to return to work for much of the year, in which work to catalogue and promote the archive continued. A number of historic portraits of former senior figures associated with the college were removed from the archive, restored and brought into the main part of the college, to celebrate the college's history.

In addition to this, and as part of the archive's work to ensure that records of the continuing life of the college today are kept for future generations, a new portrait of a former Deputy Principal, Prof. Marilyn Holness, OBE, was acquired and framed, to be added to the college walls. This was done to mark Marilyn's inclusion in the Southbank exhibition, *Phenomenal Women: Portraits of UK Black Female Professors* and as part of the college's wider project of ensuring the images on our walls reflect fully the diversity of our community, past and present.

NURTURING METHODIST EDUCATION

During 2020-21, the Southlands Methodist Trust continued to offer a significant grant to Methodist Academies and Schools Trust (MAST) to support its staffing and work; this has resulted in a commitment to ensure an increasingly close collaboration between Southlands and the work of Methodist Education more broadly. Despite the challenges of lockdown and distance learning, these collaborations continued to expand, including the provision of sessions on Methodist education as part of student training for teaching in church schools; the provision of online training and development sessions for Roehampton students alongside Methodist teachers and the contribution of Roehampton academics to the provision of those sessions; and the contribution by MAST staff to the delivery of sessions for Education students by the Free Church Education Committee.

In collaboration with the leaders in the British and Irish Methodist Connexions, The SMT provided funds and staffing to facilitate an initial online gathering of senior leaders from representatives of nearly all Methodist-founded institutions of further and higher education, chaired by the Revd Dr Tim Macquiban, Chair of the SMT. The result of

SOUTHLANDS METHODIST TRUST

TRUSTEES' REPORT (continued)

FOR THE YEAR ENDED 31 AUGUST 2021

this was the establishment of the BIREN network, which nurtures close working across such institutions. This will help to demonstrate the value and resources that Southlands offers into the wider learning life of the Methodist Church. In turn, this will build stronger bilateral and multi-lateral relationships that will support sustainability through institutional educational and research partnerships, student recruitment and profile-building.

The first in-person gathering of this network, was held in the Autumn of 2021, supported by SMT funds.

NURTURING METHODIST EDUCATIONAL PARTNERSHIPS

The SMT committed resources to establish a network to connect Methodist-related Higher Education providers across the UK and Ireland. Working in partnership with the Ministries and Vocation Team at Methodist Church House and the Board of Ministry, Learning and Development of the Methodist Church in Ireland, the Head of College and Partnerships Officer (a role sponsored by the Trust) established broad terms of reference for the group and the trustees of the SMT committed to seed funding for it.

Within the primary and secondary education sector, our closest work during 2020-21 was, once again, with MAST and its schools, significant funding for which is provided by the Southlands Methodist Trust. Support for the appointment of the Head of Service for MAST from the SMT ensured that the work of the schools charity could continue to develop. This support will continue in 2021-22.

The trustees announced the creation of the Susanna Wesley International Visiting Fellowship in the summer of 2019. This enables scholars and experienced practitioners from the wider Wesleyan family to visit the Roehampton campus for an extended period of time to undertake research, study and encounter, and to contribute their expertise to the wider Connexion. While restrictions on international travel have so far prevented the appointment of a Fellow in 2019-20 and 2020-21 we hope to be able to welcome colleagues from other IAMSCU member institutions, post-pandemic, to join us in this way and share their insights with us.

MANAGING SOUTHLANDS COLLEGE ARCHIVES

The Southlands Methodist Trust retains ownership of the historical archives of Southlands College, which are housed in the college. The archive contains historical documents and artefacts relating to the history of the college, including a large array of student work from throughout the college's establishment. During the reporting year, the Trust continued to employ a part-time Archivist to maintain, develop and facilitate use of the college archive. It is made accessible to the wider public through the Archivist's work in answering individual requests and developing an online database of materials. The Trust also continued to support small grants to acquire relevant additions to the archive (such as images and books concerning the historical life of the college) and to protect and display a range of pictures and artefacts from the archive. These will illustrate the history of the college and bring it alive for those staff and students who currently occupy it. This work will continue in the coming year after a pause due to pandemic workplace restrictions.

SUPPORTING INNOVATIVE RESEARCH

The SMT continues to provide grants for research, in addition to areas addressed by the Susanna Wesley Foundation, on subjects of importance to the church and society, with the purpose of benefitting the wider public. In the reporting year, this included:

- The effect of COVID-19 Lockdown on the learning journey of commuter students.
- The effects of the coronavirus lockdown on children's psychosocial and educational adjustment during school transition
- An investigation into social control by neglect

SOUTHLANDS METHODIST TRUST

TRUSTEES' REPORT (continued)

FOR THE YEAR ENDED 31 AUGUST 2021

- Latin American professional women and men in the UK
- Once More with Feeling: A reinvention of Hysteria using photography, performance and writing
- Public Engagement: Challenging myths of empire
- Philosophy and Impact of Phiroz Mehta

Projects approved for completion in 2021-22 include:

- Growth outlook for Family Businesses under uncertainty: A exploratory study of the Local Business Community in South West London
- Productivity and good safety improvements for women in community mechanised palm oil processing: the case of Ejisu Juaben Municipality, Ashanti region, Ghana
- Understanding emotional journeys: the emotional impact of the student 'commute' during the era of Covid-19
- The Potato Teeth Project: A comparison of classroom and garden-based educational interventions for oral hygiene in primary school pupils
- Reading4Normal Book Club
- Public Engagement: Diverse Shakespeare at Shakespeare's Globe
- Bridging the ethnic minority gap between educational development and doctoral supervision: Social justice and inclusivity

FINANCE REVIEW

At the start of the year the net assets of the Trust amounted to £10.4m of which £800,000 was an expendable endowment and the remaining £9.3m represented general funds. Income is derived from interest on and dividends from the invested assets and lease income from the investment property. The Trust does not undertake public fundraising activities. Expenditure during the year totalled £506k, which was expended on activities within the charitable objects of the Fund, most of which was spent on events and research carried out under the Susanna Wesley Foundation banner. £10k was spent on governance. Net assets at the end of the year totalled £10.4m.

More details of the financial position of the charity are set out in the Statement of Financial Activities, together with the Balance Sheet and Notes to the Financial Statements.

The accounts are approved during a period where there is still some uncertainty as a result of the continuing international spread of a coronavirus (COVID-19). The charity was, and will be, able to continue its work with little interruption to normal activities. Investments have begun to pick up again in value. The ultimate impact of COVID-19 on the UK, the world, the economy and the charity sector is yet to be seen. However, through appropriate consideration of risks as part of its normal risk management processes and mitigating actions both already taken and available to be taken, the trustees consider it appropriate for the going concern basis to be adopted for these accounts.

The Mount Clare Estate has suffered no material decline or change to the Lease since the recent valuation in July 2019, however market conditions may have had a detrimental effect on value.

The advice from the surveyors is that valuations are currently being reported on the basis of 'material valuation uncertainty' as per VPS 3 and VPGA 10 of the RICS Red Book Global. Consequently, less certainty, and a higher degree of caution, should be attached to the valuation than would normally be the case. Given the unknown future impact that COVID-19 might have on the real estate market, they recommend that trustees keep the valuation of this property under frequent review. A new valuation was carried out in March 2022 with a view to marketing the property. This valued the property at a higher sum on this basis, but stated that at its current usage, the valuation was not materially different to the current value included in the accounts. The decision to market the property was not taken until after the year-end.

SOUTHLANDS METHODIST TRUST

TRUSTEES' REPORT (continued)

FOR THE YEAR ENDED 31 AUGUST 2021

RESERVES POLICY

In accordance with the Trust Deed, the Trustees hold, as an expendable endowment, £800,000. The Trust's reserves (after allowing for amounts tied up in fixed assets and investment property) amounts to £1.25m. The trustees' general policy on reserves is that, unless there is an exceptional reason to seek permission to utilise the expendable endowment, they will maintain it and retain other reserves or build them further to a level that will generate sufficient income to achieve the aims of the charity.

The Trustees aim to retain around 1 year of Operating and Capital Costs as cash reserves, being approximately £500k, which is substantially higher than the cash reserves held as at year end, but the remaining free reserves are easily accessible.

For the year ended 31 August 2021, operating costs were £506k (including £60k of grant liabilities). The forecast for 2021-22 financial year is £695k for operating costs and £75k capital expenditure. Future years' operating costs will be in the region of £500k - £690k.

85% of the income (£400k) for the Trust is derived from the Mount Clare lease. The remaining 15% (£73k) is derived from Dividends and Interest on investment funds and cash assets, and donations, in line with forecasts.

The above policy will inevitably require amendment once the plans, and their execution, have been agreed with regards to the Mount Clare Estate. The trustees are therefore satisfied that the reserves of the charity are at a satisfactory level.

STATEMENT OF TRUSTEE'S RESPONSIBILITIES

The trustees are required by law to prepare financial statements for each financial year which give a true and fair view of the state of affairs of the charity as at the end of the financial year and of the surplus or deficit for that year. In preparing those financial statements the trustees are required to:

- select suitable accounting policies and then apply them consistently;
- observe the methods and principles of the Charities SORP;
- make judgements and estimates that are reasonable and prudent;
- follow applicable accounting standards, and
- prepare the financial statements on the going concern basis unless it is inappropriate to presume that the charity will continue in operation.

The trustees are responsible for keeping proper accounting records which disclose with reasonable accuracy at any time the financial position of the charities and enable them to ensure that the financial statements comply with the Charities Act 2011. They are also responsible for safeguarding the assets of the charities and hence for taking reasonable steps for the prevention and detection of fraud and other irregularities.

The trustees confirm that the investments have been acquired in accordance with their powers and that the charities can meet all their obligations.

AUDITORS

A resolution re-appointing Haysmacintyre LLP will be proposed at the forthcoming Trustees' meeting.

BY ORDER OF THE BOARD OF TRUSTEES



Date: 25 May 2022

Rev Dr Tim Macquiban, Chair of Trustees

INDEPENDENT AUDITOR'S REPORT TO THE TRUSTEES OF

SOUTHLANDS METHODIST TRUST

Opinion

We have audited the financial statements of Southlands Methodist Trust for the year ended 31 August 2021 which comprise the Statement of Financial Activities, Balance Sheet and notes to the financial statements, including a summary of significant accounting policies. The financial reporting framework that has been applied in their preparation is applicable law and United Kingdom Accounting Standards, including Financial Reporting Standard 102 *The Financial Reporting Standard applicable in the UK and Republic of Ireland* (United Kingdom Generally Accepted Accounting Practice).

In our opinion, the financial statements:

- give a true and fair view of the state of the charity's affairs as at 31 August 2021 and of the charity's net movement in funds for the year then ended;
- have been properly prepared in accordance with United Kingdom Generally Accepted Accounting Practice; and
- have been prepared in accordance with the requirements of the Charities Act 2011.

Basis for opinion

We have been appointed as auditor under section 144 of the Charities Act 2011 and report in accordance with the Act and relevant regulations made or having effect thereunder. We conducted our audit in accordance with International Standards on Auditing (UK) (ISAs (UK)) and applicable law. Our responsibilities under those standards are further described in the Auditor's responsibilities for the audit of the financial statements section of our report. We are independent of the charity in accordance with the ethical requirements that are relevant to our audit of the financial statements in the UK, including the FRC's Ethical Standard, and we have fulfilled our other ethical responsibilities in accordance with these requirements. We believe that the audit evidence we have obtained is sufficient and appropriate to provide a basis for our opinion.

Conclusions relating to going concern

We have nothing to report in respect of the following matters in relation to which the ISAs (UK) require us to report to you where:

- the trustees' use of the going concern basis of accounting in the preparation of the financial statements is not appropriate; or
- the trustees have not disclosed in the financial statements any identified material uncertainties that may cast significant doubt about the charity's ability to continue to adopt the going concern basis of accounting for a period of at least twelve months from the date when the financial statements are authorised for issue.

Other information

The trustees are responsible for the other information. The other information comprises the information included in the Trustees' Annual Report. Our opinion on the financial statements does not cover the other information and, except to the extent otherwise explicitly stated in our report, we do not express any form of assurance conclusion thereon.

In connection with our audit of the financial statements, our responsibility is to read the other information and, in doing so, consider whether the other information is materially inconsistent with the financial statements or our knowledge obtained in the audit or otherwise appears to be materially misstated. If we identify such material inconsistencies or apparent material misstatements, we are required to determine whether there is a material misstatement in the financial statements or a material misstatement of the other information. If, based on the work we have performed, we conclude that there is a material misstatement of this other information, we are required to report that fact. We have nothing to report in this regard.

Matters on which we are required to report by exception

We have nothing to report in respect of the following matters in relation to which the Charities (Accounts and Reports) Regulations 2008 require us to report to you if, in our opinion:

- adequate accounting records have not been kept by the charity; or
- sufficient accounting records have not been kept; or
- the charity financial statements are not in agreement with the accounting records and returns; or
- we have not received all the information and explanations we require for our audit.

Responsibilities of trustees for the financial statements

As explained more fully in the trustees' responsibilities statement, the trustees are responsible for the preparation of the financial statements and for being satisfied that they give a true and fair view, and for such internal control as the trustees determine is necessary to enable the preparation of financial statements that are free from material misstatement, whether due to fraud or error.

INDEPENDENT AUDITOR'S REPORT TO THE TRUSTEES OF

SOUTHLANDS METHODIST TRUST (continued)

In preparing the financial statements, the trustees are responsible for assessing the charity's ability to continue as a going concern, disclosing, as applicable, matters related to going concern and using the going concern basis of accounting unless the trustees either intend to liquidate the charity or to cease operations, or have no realistic alternative but to do so.

Auditor's responsibilities for the audit of the financial statements

Our objectives are to obtain reasonable assurance about whether the financial statements as a whole are free from material misstatement, whether due to fraud or error, and to issue an auditor's report that includes our opinion. Reasonable assurance is a high level of assurance, but is not a guarantee that an audit conducted in accordance with ISAs (UK) will always detect a material misstatement when it exists. Misstatements can arise from fraud or error and are considered material if, individually or in the aggregate, they could reasonably be expected to influence the economic decisions of users taken on the basis of these financial statements.

Irregularities, including fraud, are instances of non-compliance with laws and regulations. We design procedures in line with our responsibilities, outlined above, to detect material misstatements in respect of irregularities, including fraud. The extent to which our procedures are capable of detecting irregularities, including fraud is detailed below:

Based on our understanding of the charity and the environment in which it operates, we identified that the principal risks of non-compliance with laws and regulations related to compliance with Canon law, employment law and health and safety regulations, and we considered the extent to which non-compliance might have a material effect on the financial statements. We also considered those laws and regulations that have a direct impact on the preparation of the financial statements such as Canon Law, the Charities Act 2011, The Statement of Recommended Practice for Charities (SORP 2019), FRS102 and payroll taxes.

We evaluated management's incentives and opportunities for fraudulent manipulation of the financial statements (including the risk of override of controls), and determined that the principal risks were related to recognition of income and management bias in certain accounting estimates. Audit procedures performed by the engagement team included:

- Inspecting trustees' minutes
- Inspecting correspondence with regulators and tax authorities;
- Discussions with management including consideration of known or suspected instances of non-compliance with laws and regulation and fraud;
- Evaluating management's controls designed to prevent and detect irregularities;
- Identifying and testing journals, in particular journal entries posted at the year-end or those with unusual descriptions; and
- Challenging assumptions and judgements made by management in their critical accounting estimates.

A further description of our responsibilities for the audit of the financial statements is located on the Financial Reporting Council's website at: www.frc.org.uk/auditorsresponsibilities. This description forms part of our auditor's report.

Use of our report

This report is made solely to the charity's trustees, as a body, in accordance with section 144 of the Charities Act 2011 and regulations made under section 154 of that Act. Our audit work has been undertaken so that we might state to the charity's trustees those matters we are required to state to them in an Auditor's report and for no other purpose. To the fullest extent permitted by law, we do not accept or assume responsibility to anyone other than the charity's trustees as a body for our audit work, for this report, or for the opinions we have formed.



Haysmacintyre LLP
Statutory Auditors
10 Queen Street Place
London
EC4R 1AG

Date: 7 June 2022

Haysmacintyre LLP is eligible to act as an auditor in terms of section 1212 of the Companies Act 2006

SOUTHLANDS METHODIST TRUST

STATEMENT OF FINANCIAL ACTIVITIES

FOR THE YEAR ENDED 31 AUGUST 2021

	Notes	Unrestricted funds £	Endowment funds £	Total funds 2021 £	Total Funds 2020 £
Income and endowments from:					
Donations and legacies		23,264	-	23,264	308
Charitable activities		-	-	-	-
Investments	2	449,646	-	449,646	457,633
Total income		<u>472,910</u>	<u>-</u>	<u>472,910</u>	<u>457,941</u>
Expenditure on:					
Raising funds	3	3,688	-	3,688	4,153
Charitable activities	4	502,430	-	502,430	679,443
Total expenditure	6	<u>506,118</u>	<u>-</u>	<u>506,118</u>	<u>683,596</u>
Net (expenditure)/income before gains and losses on investments		<u>(33,208)</u>	<u>-</u>	<u>(33,208)</u>	<u>(225,655)</u>
Gains on investments	10	358,099	-	358,099	(150,892)
Net (expenditure)/net movement in funds		<u>324,891</u>	<u>-</u>	<u>324,891</u>	<u>(376,547)</u>
Reconciliation of funds:					
Balance brought forward at 1 September 2020		9,293,541	800,000	10,093,541	10,470,088
BALANCES CARRIED FORWARD AT 31 AUGUST 2021	14	<u>£9,618,432</u>	<u>£800,000</u>	<u>£10,418,432</u>	<u>£10,093,541</u>

- All funds in both years are unrestricted and there has been no movement on the endowment fund in either year.
- All transactions are derived from continuing activities.
- All recognised gains and losses are included in the Statement of Financial Activities.

SOUTHLANDS METHODIST TRUST

BALANCE SHEET

AS AT 31 AUGUST 2021

	Notes	£	2021 £	£	2020 £	£
FIXED ASSETS						
Investment property	9		8,345,000		8,345,000	
Other investments	10		2,066,011		1,823,351	
Tangible fixed assets	11		19,275		23,130	
			<u>10,430,286</u>		<u>10,191,481</u>	
CURRENT ASSETS						
Debtors	12	2,593		-		
Cash at bank and in hand		140,612		92,766		
		<u>143,205</u>		<u>92,766</u>		
CREDITORS: due within one year	13	(155,058)		(190,706)		
NET CURRENT ASSETS			(11,853)		(97,940)	
NET ASSETS			<u>£10,418,433</u>		<u>£10,093,541</u>	
FUNDS AND RESERVES						
General funds	14		9,618,433		9,293,541	
Endowment funds			800,000		800,000	
			<u>£10,418,433</u>		<u>£10,093,541</u>	

Approved by the Trustees on and signed on their behalf by:

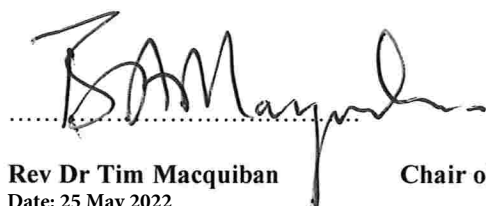

Rev Dr Tim Macquiban
Date: 25 May 2022

Chair of Trustees



Rev Dr Joanne Cox-Darling

Trustee

Date: 25 May 2022

SOUTHLANDS METHODIST TRUST

NOTES TO THE FINANCIAL STATEMENTS

FOR THE YEAR ENDED 31 AUGUST 2021

1. ACCOUNTING POLICIES

Statement of compliance

The financial statements are prepared under the historical cost convention as modified to include the revaluation of investments. The format of the financial statements has been presented to comply with the Charities Act 2011, and The Statement of Recommended Practice for Charities (SORP 2015) (Second Edition, effective 1 January 2019).

The Charity is a Public Benefit Entity as defined by FRS102.

Basis of Accounting

The financial statements have been prepared under the Charities Act 2011 on the historical cost convention [as modified by the valuation of investments], which is consistent with the prior year.

Going concern

The Trustees consider that there are no material uncertainties which would cast doubt on the Charity's ability to continue as a going concern.

Significant judgments and sources estimation uncertainty

In the view of the trustees in applying the accounting policies adopted, no judgements were required that have a significant effect on the amounts recognised in the financial statements nor do any estimates or assumptions made carry a significant risk of material adjustment in the next financial year.

Fund accounting

Unrestricted funds comprise accumulated surpluses and deficits on general funds. They are available for use at the discretion of the trustees in furtherance of the general charitable objectives.

Income recognition

All income and endowments are recognised when the criteria of entitlement, measurement and probability of receipt have been satisfied.

Investment income, including interest receivable, and other miscellaneous income are accounted for on a receivable basis.

Expenditure

Expenditure is recognised as soon as the related liability is incurred and has been classified under headings that aggregate all costs relating to that category. Liabilities are recognised as soon as there is a legal or constructive obligation committing the Charity to the expenditure.

Employment benefits, including holiday pay, are recognised in the period in which they are earned. Termination benefits are recognised in the period in which the decision is made and communicated to the relevant employee(s).

Expenditure on raising funds comprises investment manager's fees. Expenditure on charitable activities comprises expenditure directly related to charity's objects.

Support costs represent indirect costs relating to raising funds and the Charity's charitable activities.

Governance costs comprise the costs of running the charity, auditors' remuneration, certain legal costs and all costs of complying with constitutional and statutory requirements, such as costs of Board meetings and of preparing the statutory accounts.

NOTES TO THE FINANCIAL STATEMENTS

FOR THE YEAR ENDED 31 AUGUST 2021

1. ACCOUNTING POLICIES (continued)**Investments**

Investments are initially recognised at their transaction cost and subsequently valued at fair value at the Balance Sheet date, unless fair value cannot be measured reliably in which case it is measured at cost less impairment. Investment gains and losses, whether realised or unrealised, are combined and shown in the heading 'Net gains/(losses) on investments' in the Statement of Financial Activities.

Investment property

The Investment Property is held at fair value. No depreciation is charged and movements in valuation are taken to the Statement of Financial Activities. The most recent independent valuation of the freehold investment properties was undertaken in July 2019 by Giles Sutcliffe MRICS on behalf of Cluttons LLP.

Fixed assets

Expenditure on fixed assets is capitalised where the cost (or the value if donated) is in excess of £500; otherwise it is written off through the Statement of Financial Activities.

Tangible fixed assets are depreciated at rates calculated to write off the cost, less estimated residual value of each asset evenly over its expected life, as follows:-

Fixtures and fittings to be written off over seven years or to the end of August 2025, whichever is the shortest.

Financial instruments

Basic financial instruments transactions that result in the recognition of financial assets and liabilities like trade and other accounts receivable and payable are accounted for on the following basis:

Cash and cash equivalents

Cash and cash equivalents includes cash in hand, deposits held at banks, other short-term highly liquid investments with original maturities of three months or less and bank overdrafts. Bank overdrafts, when applicable, are shown within current liabilities.

Debtors and creditors

Debtors and creditors are measured at the transaction price less any provision for impairment. Any losses arising from impairment are recognised as expenditure.

Funds

General funds comprise the accumulated surplus or deficit from the Statement of Financial Activities which is not restricted nor designated funds. They are available for use at the discretion of the Trustees in furtherance of the general objectives of the charity.

Designated funds comprise funds that have been set aside at the discretion of the Trustees for specific purposes. The purpose and use of the designated unrestricted funds are set out in the notes to the accounts.

Restricted income funds comprise unexpended balances of donations and grants held in trust to be applied for specific purposes.

Permanent endowment funds comprise trust funds which are subject to specific trusts declared by the donors or with their authority. The condition of the trust is that the capital element is not expendable. The income arising from the investments is applied only in accordance with the conditions imposed by the donors (where specified) or for the general purposes of the Charity. The Trustees have power of discretion to convert the expendable endowment fund into income. It is however their policy to retain the capital of this fund to generate income. Income arising on this fund can be used in accordance with the objects of the Trust and is included in unrestricted income.

Pensions

The charity's liability is limited to the annual contributions payable. All contributions are charged to the Statement of Financial Activities in the year in which they accrue.

SOUTHLANDS METHODIST TRUST

NOTES TO THE FINANCIAL STATEMENTS

FOR THE YEAR ENDED 31 AUGUST 2021

2. INVESTMENT INCOME	2021 £	2020 £
Rental income from Mount Clare	400,000	400,000
Interest on cash deposits	154	626
Dividends on investments	49,492	57,007
	<u>£449,646</u>	<u>£457,633</u>
3. RAISING FUNDS	2021 £	2020 £
Investment management fees	<u>£3,688</u>	<u>£4,153</u>
4. CHARITABLE ACTIVITIES	2021 £	2020 £
Support of assistant chaplain	28,745	29,942
Support of music provision	75	2,541
Archive development	7,476	6,903
Head of College and Chaplain's Funds	2,527	2,510
Southlands Venture	-	1,094
Southlands Fund	11	-
SWF research centre	206,656	297,736
Small grants	23,136	23,911
MAST	86,000	50,000
Roehampton University Career Project	-	100,000
Southlands College Assistant Head of College	50,000	-
Ecumenical work	-	28,567
Methodism's University College	39,836	52,618
IAMSCU	244	6,333
Professional fees – Mount Clare	1,429	9,426
Support costs	45,988	54,260
Governance costs (note 5)	10,307	13,602
	<u>£502,430</u>	<u>£679,443</u>

5. GOVERNANCE COSTS

No trustees received remuneration for their services during the year (2020: £nil).

Reimbursed travel expenses of £202 were paid to 1 trustee during the year (2020: travel expenses of £531 were paid to 3 trustees).

NOTES TO THE FINANCIAL STATEMENTS

FOR THE YEAR ENDED 31 AUGUST 2021

6. ANALYSIS OF TOTAL EXPENDITURE – 2021

	Direct costs £	Grants £	Other costs £	Total £
Raising funds	-	-	3,688	3,688
Charitable activities	215,806	219,798	10,531	446,135
Support costs	45,988	-	-	45,988
Governance	10,307	-	-	10,307
	<u>£272,101</u>	<u>£219,798</u>	<u>£14,219</u>	<u>£506,118</u>

Grants totalling £103,376 were paid to Roehampton University. Support costs have been allocated to direct costs.

ANALYSIS OF TOTAL EXPENDITURE -2020

	Direct costs (including staff costs) £	Grants £	Other costs £	Total £
Raising funds	-	-	4,153	4,153
Charitable activities	232,634	353,085	25,794	611,513
Support costs	54,326	-	-	54,326
Governance	13,604	-	-	13,604
	<u>£300,564</u>	<u>£353,085</u>	<u>£29,947</u>	<u>£693,596</u>

7. STAFF COSTS

	2021 £	2020 £
Salaries	166,174	173,346
Employer's NI	4,447	9,035
Pension costs	9,922	9,653
	<u>£180,543</u>	<u>£192,034</u>

The number of employees during the year was 7 (4.5 full time equivalent employees) (2020 – 4.5) with all employee time involved in charitable activities or providing support services to charitable activities. No employees had emoluments in excess of £60,000 (2020 - none). The charity's key management personnel consist of the Research Director and the Executive Director. Payments to them amounted to £82,337 (2020 - £93,688). The pension scheme is a defined contribution scheme and has no other commitments or obligations beyond the contributions paid.

8. NET MOVEMENT IN FUNDS

	2021 £	2020 £
This is stated after charging:		
Auditor's remuneration	<u>£6,500</u>	<u>£6,300</u>

SOUTHLANDS METHODIST TRUST

NOTES TO THE FINANCIAL STATEMENTS

FOR THE YEAR ENDED 31 AUGUST 2021

9. INVESTMENT PROPERTY

Freehold land
and buildings
£

Valuation:

At 1 September 2020

8,345,000

At 31 August 2021

£8,345,000

Net book value:

At 31 August 2021

£8,345,000

At 31 August 2020

£8,345,000

The property was transferred into Southlands Methodist Trust on 31 July 2010 and was reclassified as an investment property during that year and therefore transferred out of tangible fixed assets and recognised within investments. The property was valued at August 2019 by an independent valuer at £8.345 million. A further valuation carried out in March 2022 indicated that the valuation based on the existing use would be £8.2m. As this amount is not materially different the valuation has not been adjusted.

10. OTHER INVESTMENTS

2021

2020

£

£

At 1 September 2020

1,823,351

1,944,334

Investment additions

43,000

172,494

Investment disposals

(158,439)

(142,433)

Investment gains/(losses)

358,099

(151,044)

Market value at 31 August 2021

£2,066,011

£1,823,351

Equity Fund

1,555,759

1,341,394

Corporate Bond Fund

202,085

167,024

Property Fund

308,167

314,933

£2,066,011

£1,823,351

11. TANGIBLE FIXED ASSETS

Fixtures and
fittings

Cost

At 1 September 2020

26,985

Additions

-

At 31 August 2021

26,985

Depreciation

At 1 September 2020

-

Charge in year

3,855

3,855

Net book value:

At 31 August 2021

£19,275

At 31 August 2020

£23,130

SOUTHLANDS METHODIST TRUST

NOTES TO THE FINANCIAL STATEMENTS

FOR THE YEAR ENDED 31 AUGUST 2021

12. DEBTORS	2021 £	2020 £
Accrued income	2,443	
Prepayments	150	-
	<u>£2,593</u>	<u>£-</u>
13. CREDITORS due within one year	2021 £	2020 £
Deferred income*	66,667	66,667
Accrued expenses	15,715	9,093
Tax and social security	2,661	4,323
Pension payable	1,444	1,448
Accounts payable	8,185	1,230
Grants payable	60,386	107,945
	<u>£155,058</u>	<u>£190,706</u>

*Deferred income is the same value at the beginning and end of the year. It represents rents received in advance.

14. ANALYSIS OF NET ASSETS BETWEEN FUNDS	Endowment Funds * £	General Funds £	Total 2021 £
Fund balances at 31 August 2021 are represented by:			
Fixed assets	800,000	9,630,286	10,430,286
Current assets	-	143,205	143,205
Current liabilities	-	(155,058)	(155,058)
Net assets	<u>£800,000</u>	<u>£9,618,433</u>	<u>£10,418,433</u>

* Endowment funds represent the capital value of donations received from the Southlands College Trust governed by trust deed dated 5 October 2000. The trust fund is an expendable endowment where the capital can only be spent on the express permission of the Methodist Council. Income generated from the fund is credited to the general fund in accordance with the trust deed.

ANALYSIS OF NET ASSETS BETWEEN FUNDS	Endowment Funds * £	General Funds £	Total 2020 £
Fund balances at 31 August 2020 are represented by:			
Fixed assets	800,000	9,391,481	10,191,481
Current assets	-	92,766	92,766
Current liabilities	-	(190,706)	(190,706)
Net assets	<u>£800,000</u>	<u>£9,293,541</u>	<u>£10,093,541</u>

SOUTHLANDS METHODIST TRUST**NOTES TO THE FINANCIAL STATEMENTS****FOR THE YEAR ENDED 31 AUGUST 2021**

15. TAXATION

The Southlands Methodist Trust is a registered charity and therefore is not liable to income tax or corporation tax on income or gains derived from its charitable activities, as they fall within the exemptions available to registered charities.

16. RELATED PARTIES

There were no related party transactions in the year or previous year to be disclosed.

Southlands Methodist Trust Report and Financial Statements For the Year Ended 31 August 2021



— S M T —

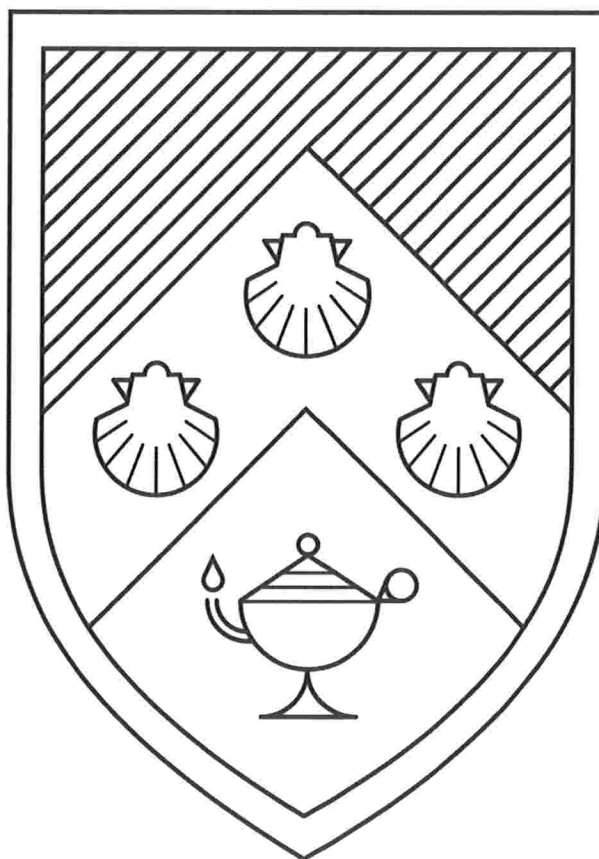

The Southlands Methodist Trust
is a charity of the
Methodist Church in Britain

Registered charity number 1100660

Southlands College
80 Roehampton Lane
London SW15 5SL

SWF@roehampton.ac.uk
www.susannawesleyfoundation.org
020 8392 4462

SOUTHLANDS METHODIST TRUST

REFERENCE AND ADMINISTRATIVE DETAILS

FOR THE YEAR ENDED 31 AUGUST 2021

Trustees:

Rev Dr Tim Macquiban, Chair
 Rev Stan Brown
 Rev Dr J Cox-Darling
 Dr Clive Norris
 Rev Colin Smith
 Rev M Youngson (resigned, August 2021)
 Mr Alan Davies (appointed, October 2020)
 Rev Jennifer Smith
 Rev Geoffrey Farrar (appointed, March 2021)

Registered office:

Southlands College
 80 Roehampton Lane
 London
 SW15 5SL

Auditors:

Haysmacintyre LLP
 Chartered Accountants
 10 Queen Street Place
 London EC4R 1AG

Bankers:

Methodist Central Finance Board
 9 Bonhill Street
 London
 EC2A 4PE

 HSBC
 West End Corporate Banking Centre
 70 Pall Mall
 London
 SW1Y 5EZ

Solicitors:

Potheary Witham Weld
 70 St George's Square
 London
 SW1V 3RD

SOUTHLANDS METHODIST TRUST

TRUSTEES' REPORT

FOR THE YEAR ENDED 31 AUGUST 2021

STRUCTURE GOVERNANCE AND MANAGEMENT

The Trustees present their report and audited financial statements for the year ended 31 August 2021. The Trustees have adopted the provisions of the Statement of Recommended Practice for Charities (SORP 2015) (Second Edition, effective 1 January 2019), in preparing the annual report and financial statements of the charity.

The Southlands Methodist Trust (SMT) is a registered unincorporated charity (Charity number 1100660). The Governing Document is a Deed of Trust.

Trustees are appointed by a decision of Methodist Council, at the recommendation of members of the Trustees. When vacancies arise, a sub-group of the trustee board is formed in order to conduct a search process. This includes both direct approaches and approaches through the Church's Connexional Team, asking for expressions of interest. From time to time, advertisements of vacancies are also used in the press. CVs of those expressing interest in appointments are considered by the sub-group and brought to a full meeting of the trustee board, where a decision is made to recommend names to Council.

RISK ASSESSMENT

The Trustees have active involvement in the day to day running of the charity. This involvement ensures that they are fully aware of the risks and required action to sufficiently mitigate those risks. As the charity grows the Trustees will more formally record the risk assessment process they undertake as part of their duties as trustees.

OBJECTIVES AND ACTIVITIES

The aims and purposes of the charity are:

- 1) as part of the work carried out through the Discipleship and Ministries Learning Network, to support in association with the College and University the development of Christian, and specifically Methodist, scholarship, research and innovation, of local, national and global significance and to facilitate the public dissemination of such developments.
- 2) to enable members of the Methodist community and wider public in Britain and internationally to benefit from the academic and other expertise and experience within the College and the University and the facilities available within them.
- 3) to enrich the community life of the College and the work of its chaplaincy in ways that reflect its Methodist values and ethos.
- 4) to maintain and develop the relationship between the Methodist Church, the College and the University in the context of developing the contribution made to the work carried out through the Discipleship and Ministries Learning Network.
- 5) to further the wider charitable purposes of the Methodist Church through close working with the other persons and bodies responsible for the work carried out through the Discipleship and Ministries Learning Network.

Fundraising

SMT does not fundraise with the public and has not received any complaints in this regard during the year.

SOUTHLANDS METHODIST TRUST

TRUSTEES' REPORT (continued)

FOR THE YEAR ENDED 31 AUGUST 2021

Public benefit

The Trustees confirm that they have complied with the duty in section 17 of the Charities Act 2011 to have due regard to public benefit guidance published by the Charity Commission in determining the activities undertaken by the Charity. The Trustees review the activities of the Charity against its aims on an ongoing basis and are satisfied that all activities continue to be related to the aims which are set in such a way as to benefit society as a whole. The benefits are set out in the review of activities shown below.

SUSANNA WESLEY FOUNDATION

The Susanna Wesley Foundation (SWF) is a community of scholarship, research and innovation based at Southlands College. The SWF provides direction and a significant focus for the Trust's in-house activities, brokering projects and partnerships to generate its research, scholarship and innovation.

The Trust employs a small staff team at the Foundation, who work alongside a group of Associates and Honorary Research Fellows, University of Roehampton academics from a range of disciplines, doctoral students whom the Trust sponsors, and SMT grant recipients from various institutions, as well as those who subscribe to the Foundation's quarterly newsletter, and who regularly participate in SWF events.

SWF Contribution:

Justice, Dignity and Solidarity

Members of SWF contributed to the Methodist Church's quest to become an inclusive church, drawing on the previous work of the Foundation around cultural difference and around learning, transformation and systemic change. The outcome of this work in the Methodist Church has been termed a 'Strategy for Justice, Dignity and Solidarity'. Given the priority accorded by the Foundation to this area, we also focused a number of podcasts, both in our 'Flourishing' (2020) and our 'Embodied Faith' (2021) series, around this theme: topics included neurodiversity, social activism and racial justice, and solidarity. These and other podcasts have been posted on the Foundation's website. The aim is to facilitate conversation between those of different perspectives and backgrounds and, in the exchange, to generate new questions and understandings.

Supporting academic dialogue and expanding participation

In the light of the lack of representation of those from the global majority in academic theology communities, the Foundation funded student bursaries for attendance at the Society for the Study of Theology (SST) and the British and Irish Association for Practical Theology (BIAPT) conferences. This is part of a package of initiatives being taken by these groups in their quest to become more inclusive, and thus to enhance their scholarship, and both listen and learn from a wider range of voices. The Foundation also supported the University of Roehampton's Research Group in Theology, Religion and Practice, sponsoring some speakers and contributing others from its own community.

Well-being in ministry

SWF continued to sponsor work around well-being in ministry, with the completion of a project looking at Bowen family systems theory – and its application in the context of local churches. A resource entitled *Flourishing Ministers, Flourishing Communities* has grown out of this project, which provides ministers with insights into the interplay between self and system, and helps them to handle the dynamics involved in their roles; it will be launched soon.

Work around learning, strategy and change

A theological action research project exploring learning in Methodism has been of benefit to a number of communities; disseminating the insights gained became the focus of the work in 2021. In relation to a project looking at models and

SOUTHLANDS METHODIST TRUST

TRUSTEES' REPORT (continued)

FOR THE YEAR ENDED 31 AUGUST 2021

understandings of change in the context of Methodism, 2020-21 has seen some empirical work, the findings from which will be shared in the 2021-22 academic year, along with those from another project looking at how 'Church strategy' is perceived and enacted in local contexts.

Publications and dissemination

In 2021, *Fuzzy Church: Gospel and Culture in the North of England* was published, a book that presents the findings and implications of research sponsored by the Foundation in 2018-19. The authors presented the book at an event sponsored by the Foundation.

The year also saw a number of events arising out of the publication of '*Mapping Faith: theologies of migration and community*', edited by SWF's Senior Research Officer, Lia Shimada. Lia choreographed and facilitated a series of seminars that have showcased the book while building fruitful connections between its contributors.

SWF's Communications and Resources Officer, Emma Pavey, had a peer-reviewed article published in the Journal of Practical Theology entitled 'Exploring open and relational theology and Theory U for transformational change'.

Conference: 'Beyond Blame: Making Accountability Work'

A joint MODEM/SWF conference brought together academics and practitioners to consider organisational, political and social accountability, looking both at what is difficult and what is possible. The conference provided another example of the dialogue between academic and practitioner understandings and perspectives that lies at the heart of SWF's approach.

Plans for the future

The Susanna Wesley Foundation will give attention to sharing insights from the different projects it has conducted and funded over the last few years, organising events, developing resources and posting pieces on its website that showcase some of the work and generate further conversation and learning, for the benefit of the Church and the wider community. Justice, dignity and solidarity will continue to be an important theme, and the Foundation will support the Methodist Church as it implements its JDS strategy. Learning, particularly focusing on the laity and on learning in community, together with the complexities involved in systemic change, will be ongoing strands of work, but with a new emphasis on sustainability, well-being and building flourishing communities.

RESEARCH AND KNOWLEDGE EXCHANGE

In 2020-21, the SMT sponsored a number of projects across the University of Roehampton's departments. Projects focus on issues of importance to the Church and Society and are chosen with a concern for their potential to contribute to the wider benefit of the public.

Projects commenced during 2020-21:

- The effects of the coronavirus lockdown on children's psychosocial and educational adjustment during school transition
- The effect of COVID-19 lockdown on the learning journey of commuter students
- The effects of the coronavirus lockdown on children's psychosocial and educational adjustment during school transition
- An investigation into social control by neglect
- Latin American professional women and men in the UK: A critical exploration of the workplace experiences and career trajectories of an understudied immigrant group

SOUTHLANDS METHODIST TRUST

TRUSTEES' REPORT (continued)

FOR THE YEAR ENDED 31 AUGUST 2021

- Once More with Feeling: A reinvention of Hysteria using photography, performance and writing
- Public Engagement: Challenging myths of empire
- the philosophy and impact of Phiroz Mehta (1902-1994)

Projects approved during the year for completion in 2021-22:

- Bridging the ethnic minority gap between educational development and doctoral supervision: Social justice and inclusivity
- Reading4Normal Book Club: an online reading-group scheme that aims to bring together young readers to discuss young adult novels.
- Understanding emotional journeys: the emotional impact of commuting and campus-based learning during the era of COVID-19
- Public Engagement: Diverse Shakespeare at Shakespeare's Globe
- Productivity and food safety improvements for women in community mechanised palm oil processing: The Case of Ejisu Juaben Municipality, Ashanti Region, Ghana
- Growth Outlook for Family Businesses under Uncertainty: An Exploratory Study of the Local Business Community in South West London
- The Potato Teeth Project: A comparison of classroom and garden-based educational interventions for oral hygiene in primary school pupils

NURTURING CHAPLAINCY

The SMT continued to sponsor activities within both the college's Methodist Chapel and through its Methodist chaplaincy, and also to encourage and support the wider provision of multi-faith chaplaincy work for the whole of the university community. The Trust directly funds one post in the Chaplaincy team, offers financing for some chaplaincy activities led by the Methodist Chaplain to the university, and also sponsors projects run across the wider multi-faith chaplaincy team which align with its charitable objects. The Methodist Chaplain and Chaplaincy Community Worker (CCW) support the work of Southlands College and contribute to the building of a student community and the creation of a supportive and flourishing environment that reflects the Methodist ethos of Southlands. The chaplaincy also hosts a range of events and runs student and staff engagement programmes, both at Southlands and across the university campus.

The Trust will continue to offer its support to the college and university chaplaincy team in a variety of ways, including grants for small projects which encourage the Methodist ethos of the college and for building up the community life of the Southlands chapel. The Trust intends to continue supporting the appointment of the CCW during 2021-22.

SOUTHLANDS VENTURE

Southlands Venture is a programme that encourages students to explore how they can use their interests and skills to make the world a better place. The Venture supports initiatives by offering seed-funding to resource ideas, as well as offering mentoring to enable students to receive the advice and guidance they need to lead campaigning, volunteering and charitable work successfully. The programme is coordinated by the college's staff team and financed by the Southlands Methodist Trust.

During the course of the year, Venture activities included:

- the creation of a promotional video for use by the college team and academic schools;
- the sharing of promotional material online, in community spaces and in our international student welcome packs;

SOUTHLANDS METHODIST TRUST

TRUSTEES' REPORT (continued)

FOR THE YEAR ENDED 31 AUGUST 2021

- developing relationships within the Faculty of Business and Law that enabled an extension of our understanding of one another's programmes in relation to Venture, and the creative exploration of how Venture might be embedded for credit within the academic syllabus;
- offering Venture as an initiative pertinent to those attending our new co-curricular Business Ethics Forum as a tool to support students with ideas and ambitions to make a meaningful change within the world, with appropriate support and mentoring.

Although the opportunity for students to deliver community initiatives in person was limited by the ongoing pandemic, three practical volunteering projects were set up by the college team in which students could participate:

- 'Painting and Decorating': students learned practical skills while enhancing the college environment.
- 'Planting and Growing': both online and in-person sessions where students were provided with pots, compost, and plants to grow and nurture.
- 'Creating Community Hampers': this was a student-led campaign initiated by student leaders to encourage the Roehampton community to make charity donations for two food banks. It featured a video watched over 334 times, and an Instagram campaign interacted by with 494 students.

HISTORIC ARCHIVES

The Southlands Methodist Trust retains ownership of the historical archives of Southlands College, which are housed in the college. During the reporting year, the Trust continued to employ a part-time Archivist to maintain, develop and facilitate use of the college archive. It is made accessible to the wider public through the Archivist's work in answering individual requests and developing an online database of materials.

Although the archive itself was closed to visitors for significant periods in 2020-21, the Archivist was able to return to work for much of the year, in which work to catalogue and promote the archive continued. A number of historic portraits of former senior figures associated with the college were removed from the archive, restored and brought into the main part of the college, to celebrate the college's history.

In addition to this, and as part of the archive's work to ensure that records of the continuing life of the college today are kept for future generations, a new portrait of a former Deputy Principal, Prof. Marilyn Holness, OBE, was acquired and framed, to be added to the college walls. This was done to mark Marilyn's inclusion in the Southbank exhibition, *Phenomenal Women: Portraits of UK Black Female Professors* and as part of the college's wider project of ensuring the images on our walls reflect fully the diversity of our community, past and present.

NURTURING METHODIST EDUCATION

During 2020-21, the Southlands Methodist Trust continued to offer a significant grant to Methodist Academies and Schools Trust (MAST) to support its staffing and work; this has resulted in a commitment to ensure an increasingly close collaboration between Southlands and the work of Methodist Education more broadly. Despite the challenges of lockdown and distance learning, these collaborations continued to expand, including the provision of sessions on Methodist education as part of student training for teaching in church schools; the provision of online training and development sessions for Roehampton students alongside Methodist teachers and the contribution of Roehampton academics to the provision of those sessions; and the contribution by MAST staff to the delivery of sessions for Education students by the Free Church Education Committee.

In collaboration with the leaders in the British and Irish Methodist Connexions, The SMT provided funds and staffing to facilitate an initial online gathering of senior leaders from representatives of nearly all Methodist-founded institutions of further and higher education, chaired by the Revd Dr Tim Macquiban, Chair of the SMT. The result of

SOUTHLANDS METHODIST TRUST

TRUSTEES' REPORT (continued)

FOR THE YEAR ENDED 31 AUGUST 2021

this was the establishment of the BIREN network, which nurtures close working across such institutions. This will help to demonstrate the value and resources that Southlands offers into the wider learning life of the Methodist Church. In turn, this will build stronger bilateral and multi-lateral relationships that will support sustainability through institutional educational and research partnerships, student recruitment and profile-building.

The first in-person gathering of this network, was held in the Autumn of 2021, supported by SMT funds.

NURTURING METHODIST EDUCATIONAL PARTNERSHIPS

The SMT committed resources to establish a network to connect Methodist-related Higher Education providers across the UK and Ireland. Working in partnership with the Ministries and Vocation Team at Methodist Church House and the Board of Ministry, Learning and Development of the Methodist Church in Ireland, the Head of College and Partnerships Officer (a role sponsored by the Trust) established broad terms of reference for the group and the trustees of the SMT committed to seed funding for it.

Within the primary and secondary education sector, our closest work during 2020-21 was, once again, with MAST and its schools, significant funding for which is provided by the Southlands Methodist Trust. Support for the appointment of the Head of Service for MAST from the SMT ensured that the work of the schools charity could continue to develop. This support will continue in 2021-22.

The trustees announced the creation of the Susanna Wesley International Visiting Fellowship in the summer of 2019. This enables scholars and experienced practitioners from the wider Wesleyan family to visit the Roehampton campus for an extended period of time to undertake research, study and encounter, and to contribute their expertise to the wider Connexion. While restrictions on international travel have so far prevented the appointment of a Fellow in 2019-20 and 2020-21 we hope to be able to welcome colleagues from other IAMSCU member institutions, post-pandemic, to join us in this way and share their insights with us.

MANAGING SOUTHLANDS COLLEGE ARCHIVES

The Southlands Methodist Trust retains ownership of the historical archives of Southlands College, which are housed in the college. The archive contains historical documents and artefacts relating to the history of the college, including a large array of student work from throughout the college's establishment. During the reporting year, the Trust continued to employ a part-time Archivist to maintain, develop and facilitate use of the college archive. It is made accessible to the wider public through the Archivist's work in answering individual requests and developing an online database of materials. The Trust also continued to support small grants to acquire relevant additions to the archive (such as images and books concerning the historical life of the college) and to protect and display a range of pictures and artefacts from the archive. These will illustrate the history of the college and bring it alive for those staff and students who currently occupy it. This work will continue in the coming year after a pause due to pandemic workplace restrictions.

SUPPORTING INNOVATIVE RESEARCH

The SMT continues to provide grants for research, in addition to areas addressed by the Susanna Wesley Foundation, on subjects of importance to the church and society, with the purpose of benefitting the wider public. In the reporting year, this included:

- The effect of COVID-19 Lockdown on the learning journey of commuter students.
- The effects of the coronavirus lockdown on children's psychosocial and educational adjustment during school transition
- An investigation into social control by neglect

SOUTHLANDS METHODIST TRUST

TRUSTEES' REPORT (continued)

FOR THE YEAR ENDED 31 AUGUST 2021

- Latin American professional women and men in the UK
- Once More with Feeling: A reinvention of Hysteria using photography, performance and writing
- Public Engagement: Challenging myths of empire
- Philosophy and Impact of Phiroz Mehta

Projects approved for completion in 2021-22 include:

- Growth outlook for Family Businesses under uncertainty: A exploratory study of the Local Business Community in South West London
- Productivity and good safety improvements for women in community mechanised palm oil processing: the case of Ejisu Juaben Municipality, Ashanti region, Ghana
- Understanding emotional journeys: the emotional impact of the student 'commute' during the era of Covid-19
- The Potato Teeth Project: A comparison of classroom and garden-based educational interventions for oral hygiene in primary school pupils
- Reading4Normal Book Club
- Public Engagement: Diverse Shakespeare at Shakespeare's Globe
- Bridging the ethnic minority gap between educational development and doctoral supervision: Social justice and inclusivity

FINANCE REVIEW

At the start of the year the net assets of the Trust amounted to £10.4m of which £800,000 was an expendable endowment and the remaining £9.3m represented general funds. Income is derived from interest on and dividends from the invested assets and lease income from the investment property. The Trust does not undertake public fundraising activities. Expenditure during the year totalled £506k, which was expended on activities within the charitable objects of the Fund, most of which was spent on events and research carried out under the Susanna Wesley Foundation banner. £10k was spent on governance. Net assets at the end of the year totalled £10.4m.

More details of the financial position of the charity are set out in the Statement of Financial Activities, together with the Balance Sheet and Notes to the Financial Statements.

The accounts are approved during a period where there is still some uncertainty as a result of the continuing international spread of a coronavirus (COVID-19). The charity was, and will be, able to continue its work with little interruption to normal activities. Investments have begun to pick up again in value. The ultimate impact of COVID-19 on the UK, the world, the economy and the charity sector is yet to be seen. However, through appropriate consideration of risks as part of its normal risk management processes and mitigating actions both already taken and available to be taken, the trustees consider it appropriate for the going concern basis to be adopted for these accounts.

The Mount Clare Estate has suffered no material decline or change to the Lease since the recent valuation in July 2019, however market conditions may have had a detrimental effect on value.

The advice from the surveyors is that valuations are currently being reported on the basis of 'material valuation uncertainty' as per VPS 3 and VPGA 10 of the RICS Red Book Global. Consequently, less certainty, and a higher degree of caution, should be attached to the valuation than would normally be the case. Given the unknown future impact that COVID-19 might have on the real estate market, they recommend that trustees keep the valuation of this property under frequent review. A new valuation was carried out in March 2022 with a view to marketing the property. This valued the property at a higher sum on this basis, but stated that at its current usage, the valuation was not materially different to the current value included in the accounts. The decision to market the property was not taken until after the year-end.

SOUTHLANDS METHODIST TRUST

TRUSTEES' REPORT (continued)

FOR THE YEAR ENDED 31 AUGUST 2021

RESERVES POLICY

In accordance with the Trust Deed, the Trustees hold, as an expendable endowment, £800,000. The Trust's reserves (after allowing for amounts tied up in fixed assets and investment property) amounts to £1.25m. The trustees' general policy on reserves is that, unless there is an exceptional reason to seek permission to utilise the expendable endowment, they will maintain it and retain other reserves or build them further to a level that will generate sufficient income to achieve the aims of the charity.

The Trustees aim to retain around 1 year of Operating and Capital Costs as cash reserves, being approximately £500k, which is substantially higher than the cash reserves held as at year end, but the remaining free reserves are easily accessible.

For the year ended 31 August 2021, operating costs were £506k (including £60k of grant liabilities). The forecast for 2021-22 financial year is £695k for operating costs and £75k capital expenditure. Future years' operating costs will be in the region of £500k - £690k.

85% of the income (£400k) for the Trust is derived from the Mount Clare lease. The remaining 15% (£73k) is derived from Dividends and Interest on investment funds and cash assets, and donations, in line with forecasts.

The above policy will inevitably require amendment once the plans, and their execution, have been agreed with regards to the Mount Clare Estate. The trustees are therefore satisfied that the reserves of the charity are at a satisfactory level.

STATEMENT OF TRUSTEE'S RESPONSIBILITIES

The trustees are required by law to prepare financial statements for each financial year which give a true and fair view of the state of affairs of the charity as at the end of the financial year and of the surplus or deficit for that year. In preparing those financial statements the trustees are required to:

- select suitable accounting policies and then apply them consistently;
- observe the methods and principles of the Charities SORP;
- make judgements and estimates that are reasonable and prudent;
- follow applicable accounting standards, and
- prepare the financial statements on the going concern basis unless it is inappropriate to presume that the charity will continue in operation.

The trustees are responsible for keeping proper accounting records which disclose with reasonable accuracy at any time the financial position of the charities and enable them to ensure that the financial statements comply with the Charities Act 2011. They are also responsible for safeguarding the assets of the charities and hence for taking reasonable steps for the prevention and detection of fraud and other irregularities.

The trustees confirm that the investments have been acquired in accordance with their powers and that the charities can meet all their obligations.

AUDITORS

A resolution re-appointing Haysmacintyre LLP will be proposed at the forthcoming Trustees' meeting.

BY ORDER OF THE BOARD OF TRUSTEES



Rev Dr Tim Macquiban, Chair of Trustees

INDEPENDENT AUDITOR'S REPORT TO THE TRUSTEES OF

SOUTHLANDS METHODIST TRUST

Opinion

We have audited the financial statements of Southlands Methodist Trust for the year ended 31 August 2021 which comprise the Statement of Financial Activities, Balance Sheet and notes to the financial statements, including a summary of significant accounting policies. The financial reporting framework that has been applied in their preparation is applicable law and United Kingdom Accounting Standards, including Financial Reporting Standard 102 *The Financial Reporting Standard applicable in the UK and Republic of Ireland* (United Kingdom Generally Accepted Accounting Practice).

In our opinion, the financial statements:

- give a true and fair view of the state of the charity's affairs as at 31 August 2021 and of the charity's net movement in funds for the year then ended;
- have been properly prepared in accordance with United Kingdom Generally Accepted Accounting Practice; and
- have been prepared in accordance with the requirements of the Charities Act 2011.

Basis for opinion

We have been appointed as auditor under section 144 of the Charities Act 2011 and report in accordance with the Act and relevant regulations made or having effect thereunder. We conducted our audit in accordance with International Standards on Auditing (UK) (ISAs (UK)) and applicable law. Our responsibilities under those standards are further described in the Auditor's responsibilities for the audit of the financial statements section of our report. We are independent of the charity in accordance with the ethical requirements that are relevant to our audit of the financial statements in the UK, including the FRC's Ethical Standard, and we have fulfilled our other ethical responsibilities in accordance with these requirements. We believe that the audit evidence we have obtained is sufficient and appropriate to provide a basis for our opinion.

Conclusions relating to going concern

We have nothing to report in respect of the following matters in relation to which the ISAs (UK) require us to report to you where:

- the trustees' use of the going concern basis of accounting in the preparation of the financial statements is not appropriate; or
- the trustees have not disclosed in the financial statements any identified material uncertainties that may cast significant doubt about the charity's ability to continue to adopt the going concern basis of accounting for a period of at least twelve months from the date when the financial statements are authorised for issue.

Other information

The trustees are responsible for the other information. The other information comprises the information included in the Trustees' Annual Report. Our opinion on the financial statements does not cover the other information and, except to the extent otherwise explicitly stated in our report, we do not express any form of assurance conclusion thereon.

In connection with our audit of the financial statements, our responsibility is to read the other information and, in doing so, consider whether the other information is materially inconsistent with the financial statements or our knowledge obtained in the audit or otherwise appears to be materially misstated. If we identify such material inconsistencies or apparent material misstatements, we are required to determine whether there is a material misstatement in the financial statements or a material misstatement of the other information. If, based on the work we have performed, we conclude that there is a material misstatement of this other information, we are required to report that fact. We have nothing to report in this regard.

Matters on which we are required to report by exception

We have nothing to report in respect of the following matters in relation to which the Charities (Accounts and Reports) Regulations 2008 require us to report to you if, in our opinion:

- adequate accounting records have not been kept by the charity; or
- sufficient accounting records have not been kept; or
- the charity financial statements are not in agreement with the accounting records and returns; or
- we have not received all the information and explanations we require for our audit.

Responsibilities of trustees for the financial statements

As explained more fully in the trustees' responsibilities statement, the trustees are responsible for the preparation of the financial statements and for being satisfied that they give a true and fair view, and for such internal control as the trustees determine is necessary to enable the preparation of financial statements that are free from material misstatement, whether due to fraud or error.

INDEPENDENT AUDITOR'S REPORT TO THE TRUSTEES OF

SOUTHLANDS METHODIST TRUST (continued)

In preparing the financial statements, the trustees are responsible for assessing the charity's ability to continue as a going concern, disclosing, as applicable, matters related to going concern and using the going concern basis of accounting unless the trustees either intend to liquidate the charity or to cease operations, or have no realistic alternative but to do so.

Auditor's responsibilities for the audit of the financial statements

Our objectives are to obtain reasonable assurance about whether the financial statements as a whole are free from material misstatement, whether due to fraud or error, and to issue an auditor's report that includes our opinion. Reasonable assurance is a high level of assurance, but is not a guarantee that an audit conducted in accordance with ISAs (UK) will always detect a material misstatement when it exists. Misstatements can arise from fraud or error and are considered material if, individually or in the aggregate, they could reasonably be expected to influence the economic decisions of users taken on the basis of these financial statements.

Irregularities, including fraud, are instances of non-compliance with laws and regulations. We design procedures in line with our responsibilities, outlined above, to detect material misstatements in respect of irregularities, including fraud. The extent to which our procedures are capable of detecting irregularities, including fraud is detailed below:

Based on our understanding of the charity and the environment in which it operates, we identified that the principal risks of non-compliance with laws and regulations related to compliance with Canon law, employment law and health and safety regulations, and we considered the extent to which non-compliance might have a material effect on the financial statements. We also considered those laws and regulations that have a direct impact on the preparation of the financial statements such as Canon Law, the Charities Act 2011, The Statement of Recommended Practice for Charities (SORP 2019), FRS102 and payroll taxes.

We evaluated management's incentives and opportunities for fraudulent manipulation of the financial statements (including the risk of override of controls), and determined that the principal risks were related to recognition of income and management bias in certain accounting estimates. Audit procedures performed by the engagement team included:

- Inspecting trustees' minutes
- Inspecting correspondence with regulators and tax authorities;
- Discussions with management including consideration of known or suspected instances of non-compliance with laws and regulation and fraud;
- Evaluating management's controls designed to prevent and detect irregularities;
- Identifying and testing journals, in particular journal entries posted at the year-end or those with unusual descriptions; and
- Challenging assumptions and judgements made by management in their critical accounting estimates.

A further description of our responsibilities for the audit of the financial statements is located on the Financial Reporting Council's website at: www.frc.org.uk/auditorsresponsibilities. This description forms part of our auditor's report.

Use of our report

This report is made solely to the charity's trustees, as a body, in accordance with section 144 of the Charities Act 2011 and regulations made under section 154 of that Act. Our audit work has been undertaken so that we might state to the charity's trustees those matters we are required to state to them in an Auditor's report and for no other purpose. To the fullest extent permitted by law, we do not accept or assume responsibility to anyone other than the charity's trustees as a body for our audit work, for this report, or for the opinions we have formed.

Haysmacintyre LLP
Statutory Auditors
10 Queen Street Place
London
EC4R 1AG

Date:

Haysmacintyre LLP is eligible to act as an auditor in terms of section 1212 of the Companies Act 2006

SOUTHLANDS METHODIST TRUST

STATEMENT OF FINANCIAL ACTIVITIES

FOR THE YEAR ENDED 31 AUGUST 2021

	Notes	Unrestricted funds £	Endowment funds £	Total funds 2021 £	Total Funds 2020 £
Income and endowments from:					
Donations and legacies		23,264	-	23,264	308
Charitable activities		-	-	-	-
Investments	2	449,646	-	449,646	457,633
Total income		<u>472,910</u>	<u>-</u>	<u>472,910</u>	<u>457,941</u>
Expenditure on:					
Raising funds	3	3,688	-	3,688	4,153
Charitable activities	4	502,430	-	502,430	679,443
Total expenditure	6	<u>506,118</u>	<u>-</u>	<u>506,118</u>	<u>683,596</u>
Net (expenditure)/income before gains and losses on investments		<u>(33,208)</u>	<u>-</u>	<u>(33,208)</u>	<u>(225,655)</u>
Gains on investments	10	358,099	-	358,099	(150,892)
Net (expenditure)/net movement in funds		<u>324,891</u>	<u>-</u>	<u>324,891</u>	<u>(376,547)</u>
Reconciliation of funds:					
Balance brought forward at 1 September 2020		9,293,541	800,000	10,093,541	10,470,088
BALANCES CARRIED FORWARD AT 31 AUGUST 2021	14	<u>£9,618,432</u>	<u>£800,000</u>	<u>£10,418,432</u>	<u>£10,093,541</u>

- All funds in both years are unrestricted and there has been no movement on the endowment fund in either year.
- All transactions are derived from continuing activities.
- All recognised gains and losses are included in the Statement of Financial Activities.

SOUTHLANDS METHODIST TRUST

BALANCE SHEET

AS AT 31 AUGUST 2021

	Notes	£	2021 £	£	2020 £	£
FIXED ASSETS						
Investment property	9		8,345,000		8,345,000	
Other investments	10		2,066,011		1,823,351	
Tangible fixed assets	11		19,275		23,130	
			<u>10,430,286</u>		<u>10,191,481</u>	
CURRENT ASSETS						
Debtors	12	2,593		-		
Cash at bank and in hand		140,612		92,766		
		<u>143,205</u>		<u>92,766</u>		
CREDITORS: due within one year	13	(155,058)		(190,706)		
NET CURRENT ASSETS			(11,853)		(97,940)	
NET ASSETS			<u>£10,418,433</u>		<u>£10,093,541</u>	
FUNDS AND RESERVES						
General funds	14		9,618,433		9,293,541	
Endowment funds			800,000		800,000	
			<u>£10,418,433</u>		<u>£10,093,541</u>	

Approved by the Trustees on and signed on their behalf by:

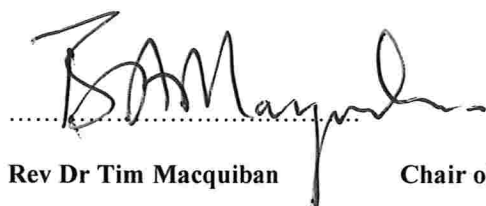

Rev Dr Tim Macquiban

Chair of Trustees



Rev Dr Joanne Cox-Darling

Trustee

SOUTHLANDS METHODIST TRUST

NOTES TO THE FINANCIAL STATEMENTS

FOR THE YEAR ENDED 31 AUGUST 2021

1. ACCOUNTING POLICIES

Statement of compliance

The financial statements are prepared under the historical cost convention as modified to include the revaluation of investments. The format of the financial statements has been presented to comply with the Charities Act 2011, and The Statement of Recommended Practice for Charities (SORP 2015) (Second Edition, effective 1 January 2019).

The Charity is a Public Benefit Entity as defined by FRS102.

Basis of Accounting

The financial statements have been prepared under the Charities Act 2011 on the historical cost convention [as modified by the valuation of investments], which is consistent with the prior year.

Going concern

The Trustees consider that there are no material uncertainties which would cast doubt on the Charity's ability to continue as a going concern.

Significant judgments and sources estimation uncertainty

In the view of the trustees in applying the accounting policies adopted, no judgements were required that have a significant effect on the amounts recognised in the financial statements nor do any estimates or assumptions made carry a significant risk of material adjustment in the next financial year.

Fund accounting

Unrestricted funds comprise accumulated surpluses and deficits on general funds. They are available for use at the discretion of the trustees in furtherance of the general charitable objectives.

Income recognition

All income and endowments are recognised when the criteria of entitlement, measurement and probability of receipt have been satisfied.

Investment income, including interest receivable, and other miscellaneous income are accounted for on a receivable basis.

Expenditure

Expenditure is recognised as soon as the related liability is incurred and has been classified under headings that aggregate all costs relating to that category. Liabilities are recognised as soon as there is a legal or constructive obligation committing the Charity to the expenditure.

Employment benefits, including holiday pay, are recognised in the period in which they are earned. Termination benefits are recognised in the period in which the decision is made and communicated to the relevant employee(s).

Expenditure on raising funds comprises investment manager's fees. Expenditure on charitable activities comprises expenditure directly related to charity's objects.

Support costs represent indirect costs relating to raising funds and the Charity's charitable activities.

Governance costs comprise the costs of running the charity, auditors' remuneration, certain legal costs and all costs of complying with constitutional and statutory requirements, such as costs of Board meetings and of preparing the statutory accounts.

NOTES TO THE FINANCIAL STATEMENTS

FOR THE YEAR ENDED 31 AUGUST 2021

1. ACCOUNTING POLICIES (continued)**Investments**

Investments are initially recognised at their transaction cost and subsequently valued at fair value at the Balance Sheet date, unless fair value cannot be measured reliably in which case it is measured at cost less impairment. Investment gains and losses, whether realised or unrealised, are combined and shown in the heading 'Net gains/(losses) on investments' in the Statement of Financial Activities.

Investment property

The Investment Property is held at fair value. No depreciation is charged and movements in valuation are taken to the Statement of Financial Activities. The most recent independent valuation of the freehold investment properties was undertaken in July 2019 by Giles Sutcliffe MRICS on behalf of Cluttons LLP.

Fixed assets

Expenditure on fixed assets is capitalised where the cost (or the value if donated) is in excess of £500; otherwise it is written off through the Statement of Financial Activities.

Tangible fixed assets are depreciated at rates calculated to write off the cost, less estimated residual value of each asset evenly over its expected life, as follows:-

Fixtures and fittings to be written off over seven years or to the end of August 2025, whichever is the shortest.

Financial instruments

Basic financial instruments transactions that result in the recognition of financial assets and liabilities like trade and other accounts receivable and payable are accounted for on the following basis:

Cash and cash equivalents

Cash and cash equivalents includes cash in hand, deposits held at banks, other short-term highly liquid investments with original maturities of three months or less and bank overdrafts. Bank overdrafts, when applicable, are shown within current liabilities.

Debtors and creditors

Debtors and creditors are measured at the transaction price less any provision for impairment. Any losses arising from impairment are recognised as expenditure.

Funds

General funds comprise the accumulated surplus or deficit from the Statement of Financial Activities which is not restricted nor designated funds. They are available for use at the discretion of the Trustees in furtherance of the general objectives of the charity.

Designated funds comprise funds that have been set aside at the discretion of the Trustees for specific purposes. The purpose and use of the designated unrestricted funds are set out in the notes to the accounts.

Restricted income funds comprise unexpended balances of donations and grants held in trust to be applied for specific purposes.

Permanent endowment funds comprise trust funds which are subject to specific trusts declared by the donors or with their authority. The condition of the trust is that the capital element is not expendable. The income arising from the investments is applied only in accordance with the conditions imposed by the donors (where specified) or for the general purposes of the Charity. The Trustees have power of discretion to convert the expendable endowment fund into income. It is however their policy to retain the capital of this fund to generate income. Income arising on this fund can be used in accordance with the objects of the Trust and is included in unrestricted income.

Pensions

The charity's liability is limited to the annual contributions payable. All contributions are charged to the Statement of Financial Activities in the year in which they accrue.

SOUTHLANDS METHODIST TRUST

NOTES TO THE FINANCIAL STATEMENTS

FOR THE YEAR ENDED 31 AUGUST 2021

2. INVESTMENT INCOME	2021 £	2020 £
Rental income from Mount Clare	400,000	400,000
Interest on cash deposits	154	626
Dividends on investments	49,492	57,007
	<u>£449,646</u>	<u>£457,633</u>
3. RAISING FUNDS	2021 £	2020 £
Investment management fees	<u>£3,688</u>	<u>£4,153</u>
4. CHARITABLE ACTIVITIES	2021 £	2020 £
Support of assistant chaplain	28,745	29,942
Support of music provision	75	2,541
Archive development	7,476	6,903
Head of College and Chaplain's Funds	2,527	2,510
Southlands Venture	-	1,094
Southlands Fund	11	-
SWF research centre	206,656	297,736
Small grants	23,136	23,911
MAST	86,000	50,000
Roehampton University Career Project	-	100,000
Southlands College Assistant Head of College	50,000	-
Ecumenical work	-	28,567
Methodism's University College	39,836	52,618
IAMSCU	244	6,333
Professional fees – Mount Clare	1,429	9,426
Support costs	45,988	54,260
Governance costs (note 5)	10,307	13,602
	<u>£502,430</u>	<u>£679,443</u>

5. GOVERNANCE COSTS

No trustees received remuneration for their services during the year (2020: £nil).

Reimbursed travel expenses of £202 were paid to 1 trustee during the year (2020: travel expenses of £531 were paid to 3 trustees).

NOTES TO THE FINANCIAL STATEMENTS

FOR THE YEAR ENDED 31 AUGUST 2021

6. ANALYSIS OF TOTAL EXPENDITURE – 2021

	Direct costs £	Grants £	Other costs £	Total £
Raising funds	-	-	3,688	3,688
Charitable activities	215,806	219,798	10,531	446,135
Support costs	45,988	-	-	45,988
Governance	10,307	-	-	10,307
	<u>£272,101</u>	<u>£219,798</u>	<u>£14,219</u>	<u>£506,118</u>

Grants totalling £103,376 were paid to Roehampton University. Support costs have been allocated to direct costs.

ANALYSIS OF TOTAL EXPENDITURE -2020

	Direct costs (including staff costs) £	Grants £	Other costs £	Total £
Raising funds	-	-	4,153	4,153
Charitable activities	232,634	353,085	25,794	611,513
Support costs	54,326	-	-	54,326
Governance	13,604	-	-	13,604
	<u>£300,564</u>	<u>£353,085</u>	<u>£29,947</u>	<u>£693,596</u>

7. STAFF COSTS

	2021 £	2020 £
Salaries	166,174	173,346
Employer's NI	4,447	9,035
Pension costs	9,922	9,653
	<u>£180,543</u>	<u>£192,034</u>

The number of employees during the year was 7 (4.5 full time equivalent employees) (2020 – 4.5) with all employee time involved in charitable activities or providing support services to charitable activities. No employees had emoluments in excess of £60,000 (2020 - none). The charity's key management personnel consist of the Research Director and the Executive Director. Payments to them amounted to £82,337 (2020 - £93,688). The pension scheme is a defined contribution scheme and has no other commitments or obligations beyond the contributions paid.

8. NET MOVEMENT IN FUNDS

	2021 £	2020 £
This is stated after charging:		
Auditor's remuneration	<u>£6,500</u>	<u>£6,300</u>

SOUTHLANDS METHODIST TRUST

NOTES TO THE FINANCIAL STATEMENTS

FOR THE YEAR ENDED 31 AUGUST 2021

9. INVESTMENT PROPERTY

Freehold land
and buildings
£

Valuation:

At 1 September 2020

8,345,000

At 31 August 2021

£8,345,000

Net book value:

At 31 August 2021

£8,345,000

At 31 August 2020

£8,345,000

The property was transferred into Southlands Methodist Trust on 31 July 2010 and was reclassified as an investment property during that year and therefore transferred out of tangible fixed assets and recognised within investments. The property was valued at August 2019 by an independent valuer at £8.345 million. A further valuation carried out in March 2022 indicated that the valuation based on the existing use would be £8.2m. As this amount is not materially different the valuation has not been adjusted.

10. OTHER INVESTMENTS

2021

2020

£

£

At 1 September 2020

1,823,351

1,944,334

Investment additions

43,000

172,494

Investment disposals

(158,439)

(142,433)

Investment gains/(losses)

358,099

(151,044)

Market value at 31 August 2021

£2,066,011

£1,823,351

Equity Fund

1,555,759

1,341,394

Corporate Bond Fund

202,085

167,024

Property Fund

308,167

314,933

£2,066,011

£1,823,351

11. TANGIBLE FIXED ASSETS

Fixtures and
fittings

Cost

At 1 September 2020

26,985

Additions

-

At 31 August 2021

26,985

Depreciation

At 1 September 2020

-

Charge in year

3,855

3,855

Net book value:

At 31 August 2021

£19,275

At 31 August 2020

£23,130

SOUTHLANDS METHODIST TRUST

NOTES TO THE FINANCIAL STATEMENTS

FOR THE YEAR ENDED 31 AUGUST 2021

12. DEBTORS	2021 £	2020 £
Accrued income	2,443	
Prepayments	150	-
	<u>£2,593</u>	<u>£-</u>
13. CREDITORS due within one year	2021 £	2020 £
Deferred income*	66,667	66,667
Accrued expenses	15,715	9,093
Tax and social security	2,661	4,323
Pension payable	1,444	1,448
Accounts payable	8,185	1,230
Grants payable	60,386	107,945
	<u>£155,058</u>	<u>£190,706</u>

*Deferred income is the same value at the beginning and end of the year. It represents rents received in advance.

14. ANALYSIS OF NET ASSETS BETWEEN FUNDS	Endowment Funds * £	General Funds £	Total 2021 £
Fund balances at 31 August 2021 are represented by:			
Fixed assets	800,000	9,630,286	10,430,286
Current assets	-	143,205	143,205
Current liabilities	-	(155,058)	(155,058)
Net assets	<u>£800,000</u>	<u>£9,618,433</u>	<u>£10,418,433</u>

* Endowment funds represent the capital value of donations received from the Southlands College Trust governed by trust deed dated 5 October 2000. The trust fund is an expendable endowment where the capital can only be spent on the express permission of the Methodist Council. Income generated from the fund is credited to the general fund in accordance with the trust deed.

ANALYSIS OF NET ASSETS BETWEEN FUNDS	Endowment Funds * £	General Funds £	Total 2020 £
Fund balances at 31 August 2020 are represented by:			
Fixed assets	800,000	9,391,481	10,191,481
Current assets	-	92,766	92,766
Current liabilities	-	(190,706)	(190,706)
Net assets	<u>£800,000</u>	<u>£9,293,541</u>	<u>£10,093,541</u>

SOUTHLANDS METHODIST TRUST**NOTES TO THE FINANCIAL STATEMENTS****FOR THE YEAR ENDED 31 AUGUST 2021**

15. TAXATION

The Southlands Methodist Trust is a registered charity and therefore is not liable to income tax or corporation tax on income or gains derived from its charitable activities, as they fall within the exemptions available to registered charities.

16. RELATED PARTIES

There were no related party transactions in the year or previous year to be disclosed.

